

SURVEY CONTROL SHEET R-4753

-FINAL-

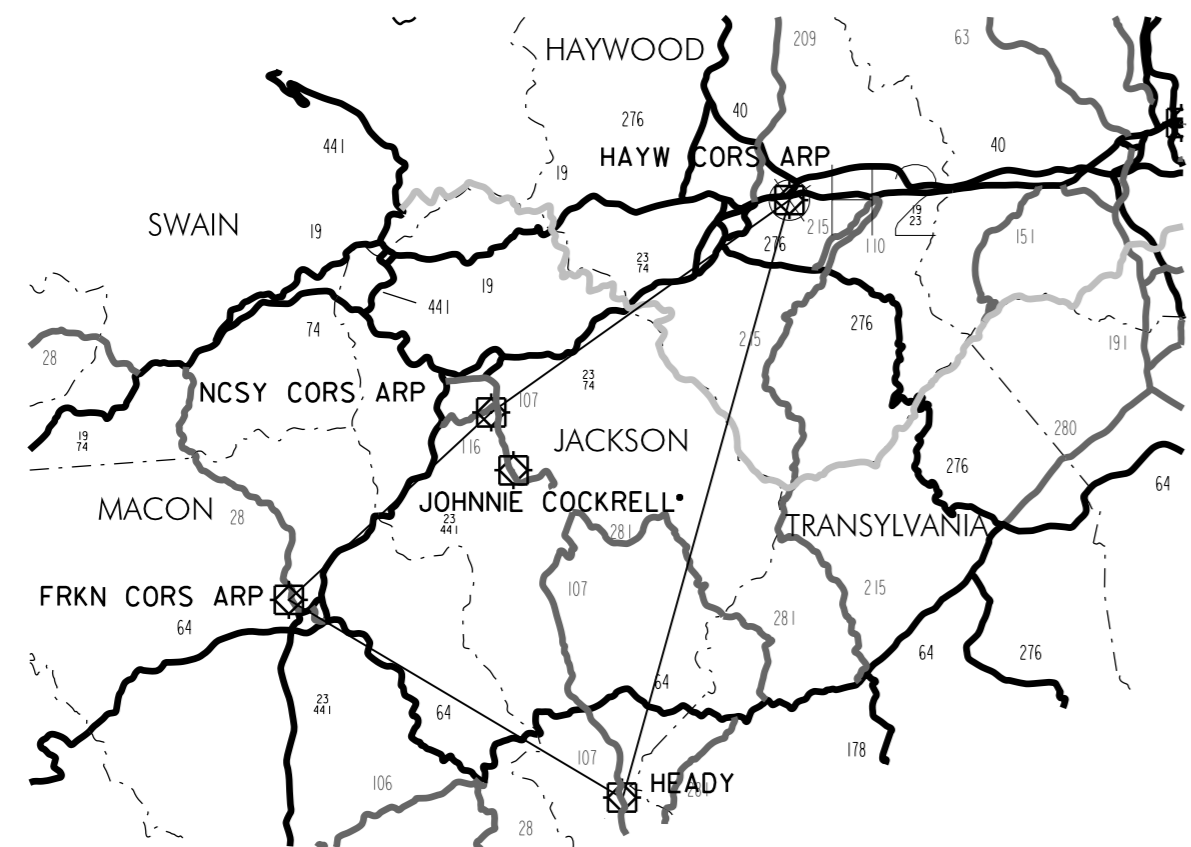

HARN VICINITY MAP

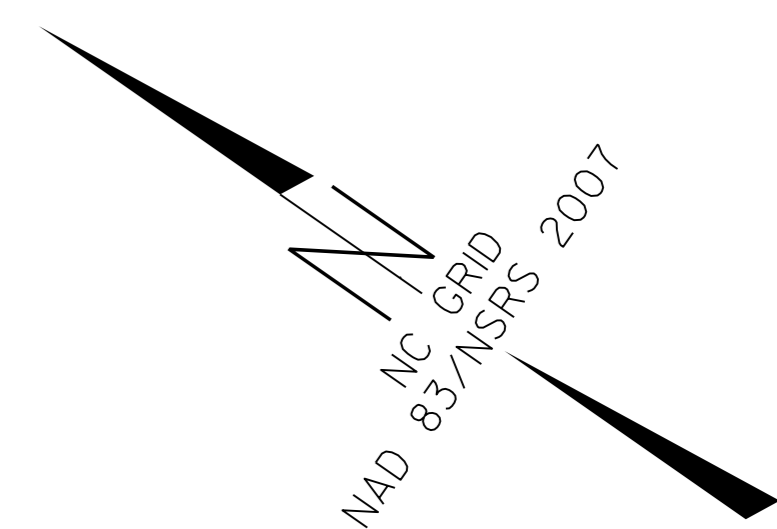

NCDOT GPS STATION R-4753 GPS-103
LOCALIZED PROJECT COORDINATES
N = 589,588.0920
E = 763,215.4660
ELEV. = 2,142.55'

NCDOT GPS STATION R-4753 GPS-104
LOCALIZED PROJECT COORDINATES
N = 589,097.7560
E = 763,367.2580
ELEV. = 2,128.96'

NCDOT GPS STATION R-4753 GPS-107
LOCALIZED PROJECT COORDINATES
N = 584,523.6030
E = 767,352.7520
ELEV. = 2,155.85'

NCDOT GPS STATION R-4753 GPS-108
LOCALIZED PROJECT COORDINATES
N = 584,298.1040
E = 767,738.1110
ELEV. = 2,170.08'

NCDOT GPS STATION R-4753 GPS-109
LOCALIZED PROJECT COORDINATES
N = 581,208.6920
E = 769,271.1110
ELEV. = 2,170.23'

NCDOT GPS STATION R-4753 GPS-110
LOCALIZED PROJECT COORDINATES
N = 580,677.1430
E = 769,355.6380
ELEV. = 2,176.35'

NCDOT GPS STATION R-4753 GPS-106
LOCALIZED PROJECT COORDINATES
N = 585,058.6710
E = 764,400.3340
ELEV. = 2,140.61'

NCDOT GPS STATION R-4753 GPS-111
LOCALIZED PROJECT COORDINATES
N = 577,195.9840
E = 769,667.9650
ELEV. = 2,151.13'

NCDOT GPS STATION R-4753 GPS-101
LOCALIZED PROJECT COORDINATES
N = 588,639.0840
E = 760,234.9210
ELEV. = 2,157.00'

NCDOT GPS STATION R-4753 GPS-101
LOCALIZED PROJECT COORDINATES
N = 588,639.0840
E = 760,234.9210
ELEV. = 2,157.00'

NCDOT GPS STATION R-4753 GPS-105
LOCALIZED PROJECT COORDINATES
N = 585,568.2230
E = 763,921.4440
ELEV. = 2,135.92'

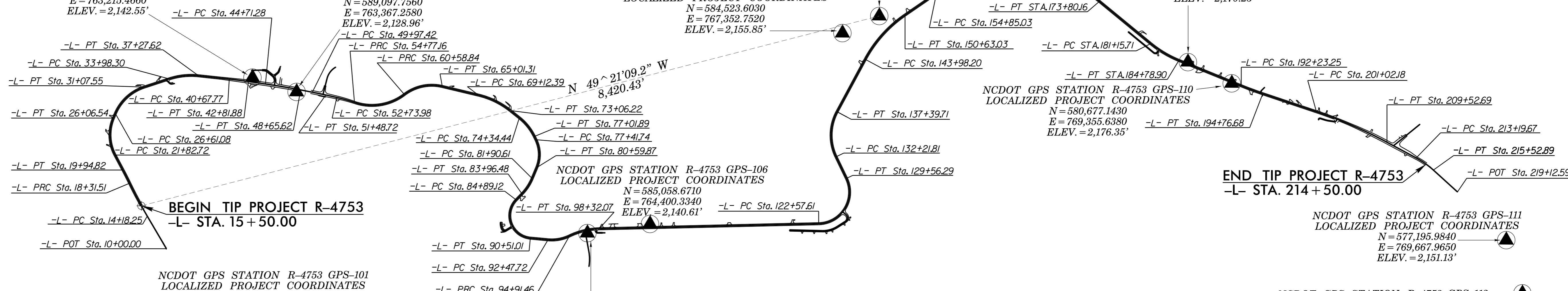

END TIP PROJECT R-4753
-L- STA. 214 + 50.00

DATUM DESCRIPTION

THE LOCALIZED COORDINATE SYSTEM DEVELOPED FOR THIS PROJECT IS BASED ON THE STATE PLANE COORDINATES ESTABLISHED BY NCDOT FOR MONUMENT "R4753 GPS108" WITH NAD 83/NSRS 2007 STATE PLANE GRID COORDINATES OF NORTHING: 584298.1040(ft) EASTING: 767738.1110(ft) THE AVERAGE COMBINED GRID FACTOR USED ON THIS PROJECT (GROUND TO GRID) IS: 0.99977445 THE N.C. LAMBERT GRID BEARING AND LOCALIZED HORIZONTAL GROUND DISTANCE FROM "R4753 GPS108" TO -L- STATION 15+50.00 IS N 49° 21' 09.2" W 8,420.43'

ALL LINEAR DIMENSIONS ARE LOCALIZED HORIZONTAL DISTANCES VERTICAL DATUM IS BASED ON NGS BENCHMARK N508 (ELEV 2144.97 FT.) (NAVD 88)

NOTES:

1. THE SITE CALIBRATION SHOWN IS BASED UPON A NETWORK TIED TO THE HARN (HIGH ACCURACY REFERENCE NETWORK) NAD 83/NSRS 2007 ADJUSTMENT. THIS CALIBRATION WILL ALLOW THE END USER TO WORK WITHIN THE SAME COORDINATE SYSTEM WHEN USING RTK (REAL TIME KINEMATIC) GPS AND A LOCAL BASE STATION. IF ANOTHER SYSTEM SUCH AS VRS (VIRTUAL REFERENCE STATION) IS USED, ADDITIONAL FIELD TIES MAY BE NEEDED TO REDUCE POSSIBLE ERRORS, OR BIASES.

2. THE CONTROL DATA FOR THIS PROJECT CAN BE FOUND ELECTRONICALLY BY SELECTING PROJECT CONTROL DATA AT:
[HTTP://WWW.NCDOT.ORG/DOHPRECONSTRUCTHIGHWAYLOCATION/PROJECT/](http://www.ncdot.org/DOHPRECONSTRUCTHIGHWAYLOCATION/PROJECT/)

THE FILES TO BE FOUND ARE AS FOLLOWS:
R4753_LS_GPSCALIB.HTML
R4753_LS_WGS84.TXT
R4753_LS_LOCAL.TXT
R4753_LS_CONTROL.TXT

THE WGS84 AND LOCAL FILES ARE COMMA DELIMITED AND CAN BE USED TO REPRODUCE THE SITE CALIBRATION FOR THE END USER'S GPS EQUIPMENT. IF FURTHER INFORMATION IS NEEDED, PLEASE CONTACT THE LOCATION AND SURVEYS UNIT.

- © INDICATES GEODETIC CONTROL MONUMENTS USED OR SET FOR HORIZONTAL PROJECT CONTROL BY THE NCDOT LOCATION AND SURVEYS UNIT.
PROJECT CONTROL ESTABLISHED USING GLOBAL POSITIONING SYSTEM.
NETWORK ESTABLISHED FROM EXISTING HARN MONUMENTATION
SEE GPS CALIBRATION SHEET FOR HORIZONTAL AND VERTICAL COORDINATE VALUES.

GEOID MODEL - GEOID03
NOTE: DRAWING NOT TO SCALE

6/2/09

-SYS TIME: 11:55:51 AM 6/2/09
FILE: R4753_LS_101.dgn