

- 1 TEMPORARY SHORING
FROM -L- STA 15+95± 31' RIGHT TO 16+30± 31' RIGHT
AVERAGE HEIGHT: 11'
QUANTITY = 385 SF
- 2 TEMPORARY SHORING
FROM -L- STA 16+90± 31' RIGHT TO 17+15± 31' RIGHT
AVERAGE HEIGHT: 11'
QUANTITY = 275 SF

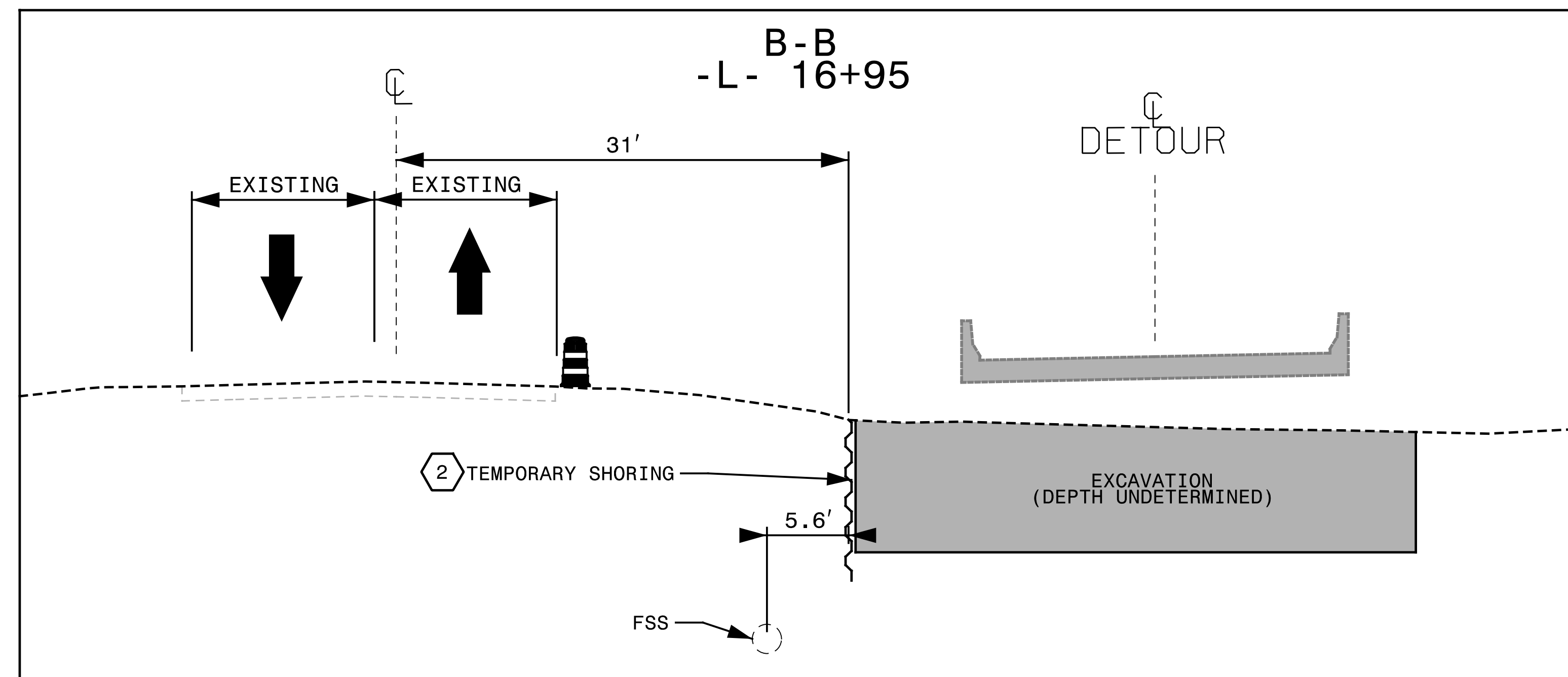
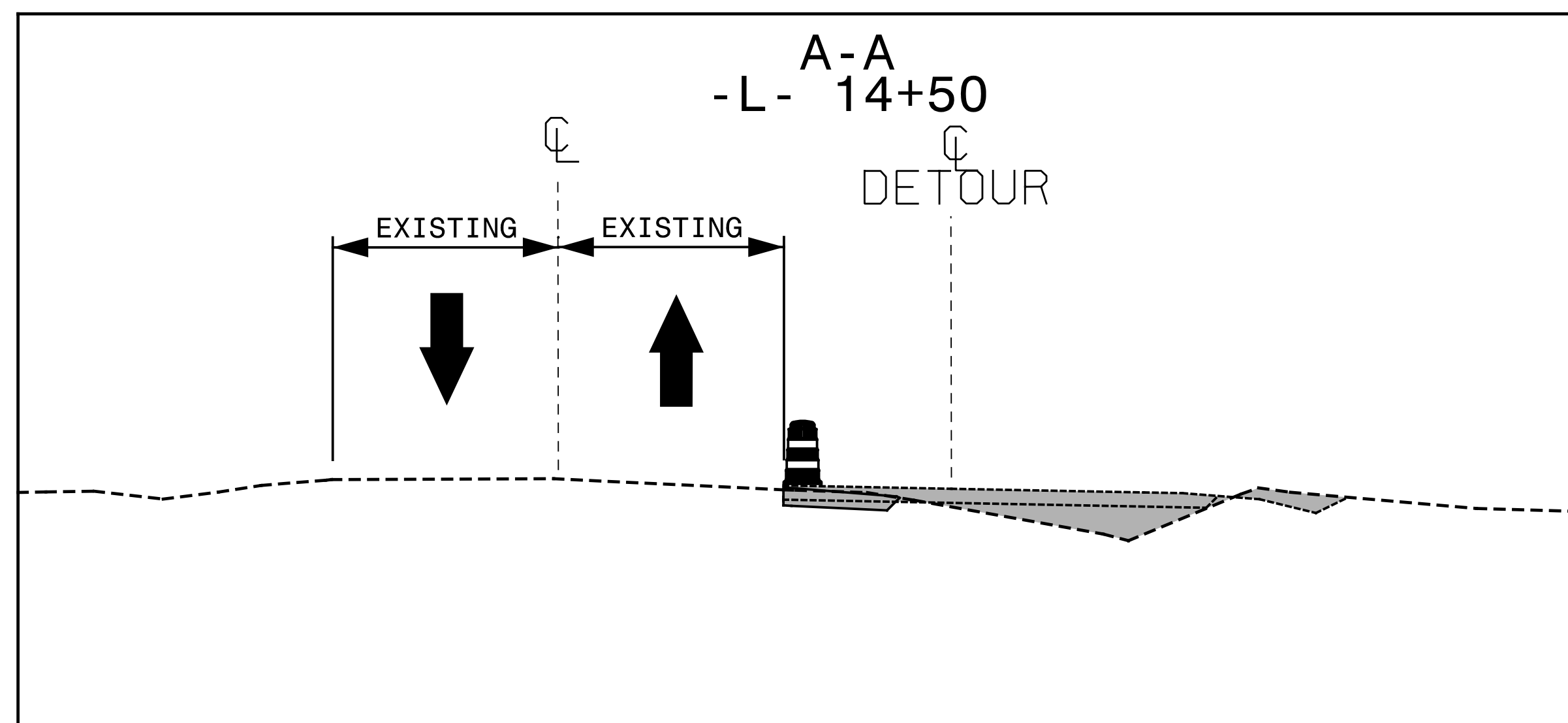
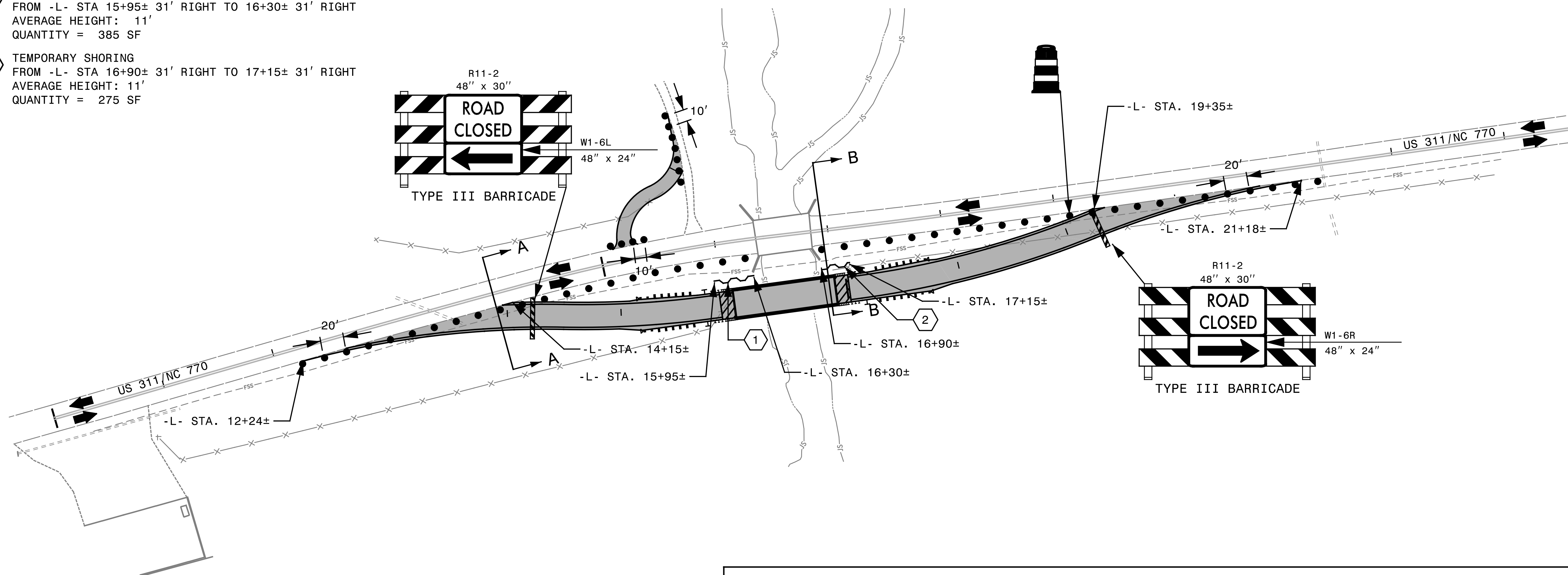

7/18/2016 G:\Transportation\TR13.017.00 NCDOT 2012 Traffic LSA\TR13.017.01 (B-5343)\Traffic\B-5343 TMP-4.dgn miles

SEPI
ENGINEERING & CONSTRUCTION

1025 Wade Avenue
Raleigh, NC 27605
Tel: 919-789-9977
Fax: 919-789-9591
License: C-2197

APPROVED: *Steve Miller*
DATE: 7/20/2016

SEAL
NORTH CAROLINA PROFESSIONAL ENGINEER
SEAL 037026
STEVEN D. MILLER

DOCUMENT NOT CONSIDERED FINAL
UNLESS ALL SIGNATURES COMPLETED

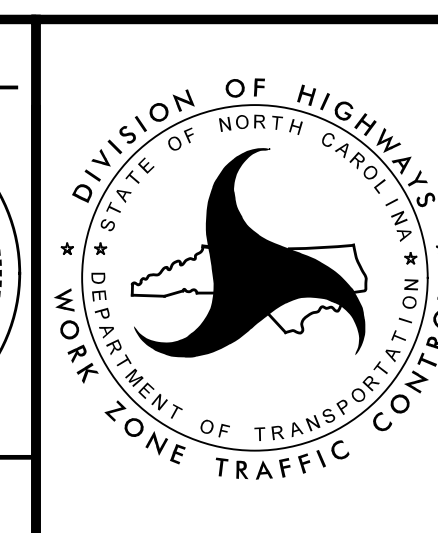

PHASE I