

**RAILING ELEVATION**

NOTES:  
 CONTRACTOR SHALL PROVIDE DESIGN OF 1½" GALVANIZED STEEL RAILING TO MEET DIMENSIONS SHOWN. DESIGN SHALL INCLUDE CONNECTION TO HEADWALL TO RESIST AN APPLIED LOAD OF 200 LBS. AT ANY LOCATION ALONG THE RAILING. SUBMIT FINAL DESIGN TO ENGINEER FOR APPROVAL.

PAINT RAILING WITH ONE COAT OF PRIMER PAINT AND TWO COATS OF APPROVED PAINT (BLACK) TO BE APPROVED BY THE ENGINEER. APPLY FINAL COAT AFTER RAILING INSTALLATION.

RAILING SHOULD BE LOCATED AT BOTH OUTLET AND INLET ENDS OF THE CULVERT.

PAYMENT AT THE CONTRACT UNIT PRICE FOR ALL ITEMS ASSOCIATED WITH THE DESIGN AND INSTALLATION OF 1½" GALVANIZED STEEL PIPE WILL BE FULL COMPENSATION FOR ALL WORK COVERED AS DESCRIBED ABOVE.

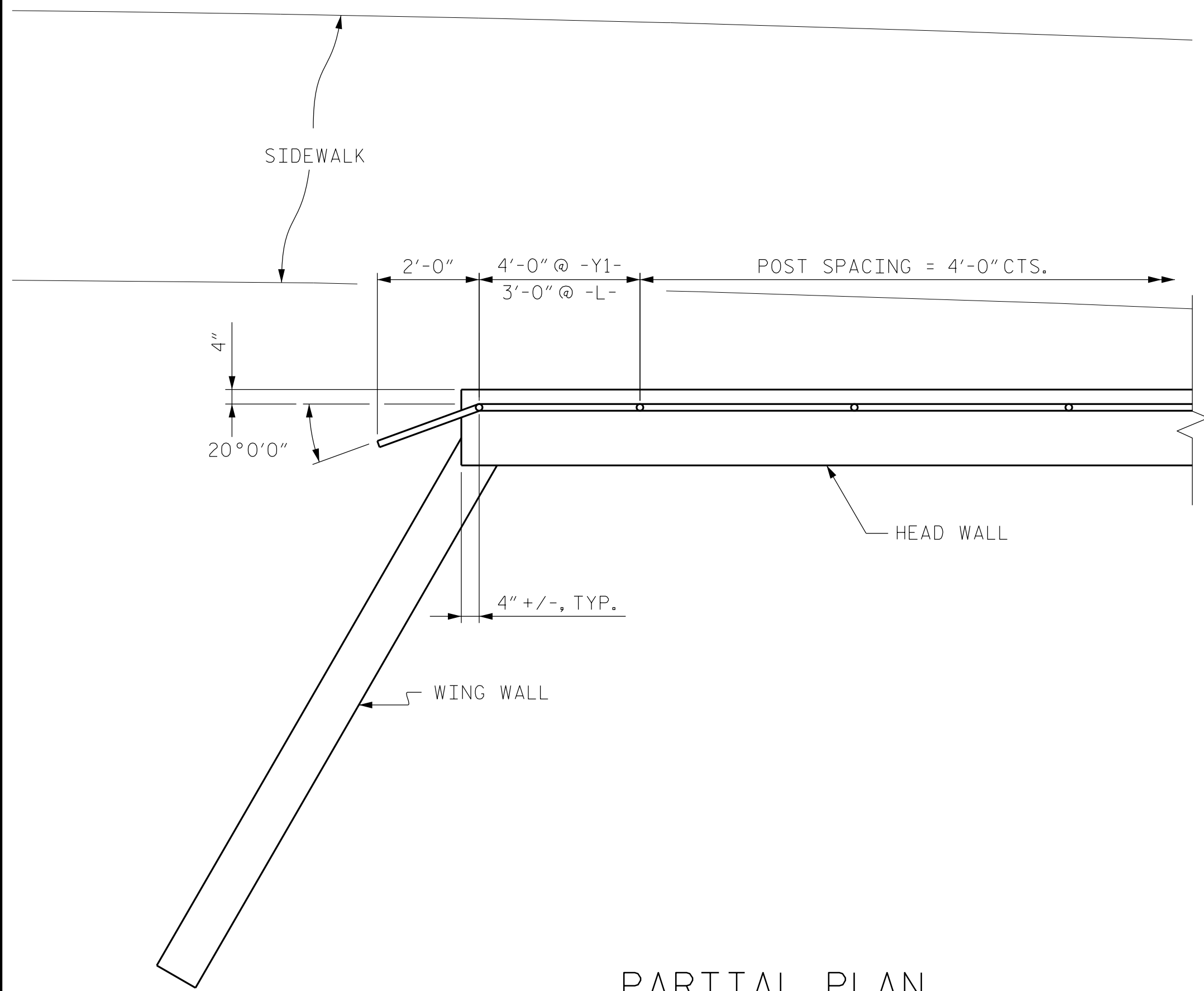

**PARTIAL PLAN**

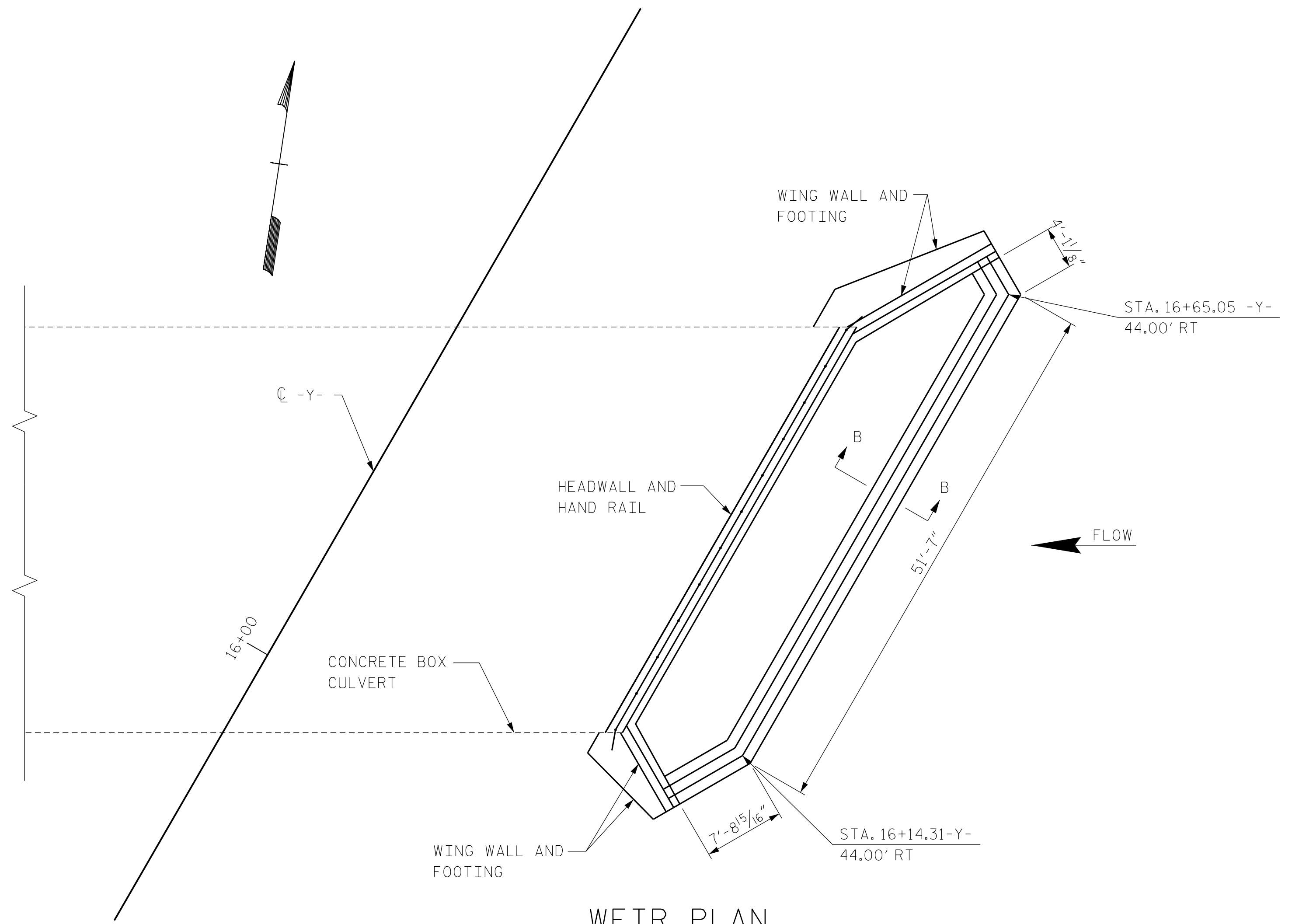

**WEIR PLAN**

NOTE:  
 CONCRETE DRAINAGE WEIR SHALL BE CONSTRUCTED IN ACCORDANCE WITH SECTION 825 OF THE STANDARD SPECIFICATIONS, AND SHALL BE CONSIDERED INCIDENTAL TO CLASS A CONCRETE FOR THE CONCRETE BOX CULVERT PAY ITEM.

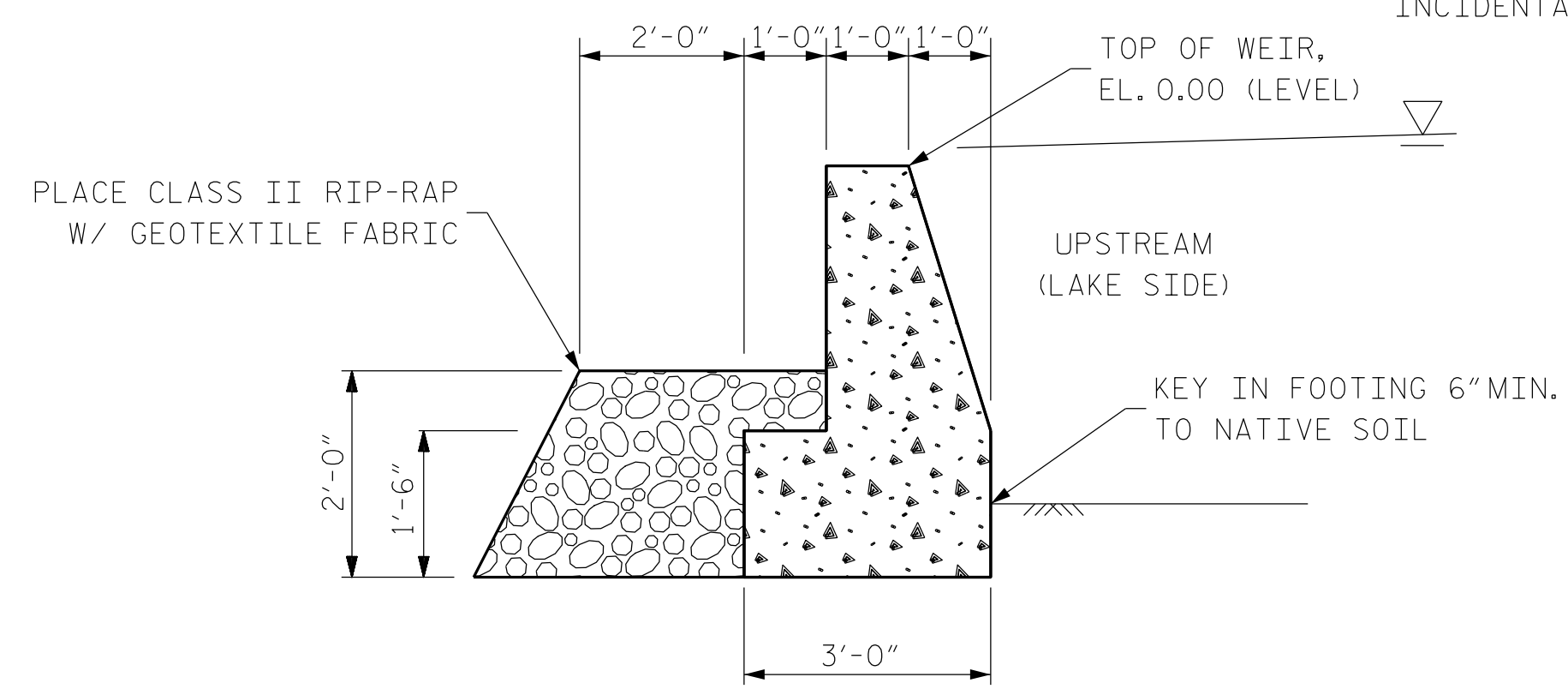

**WEIR SECTION B-B**

DRAWN BY : C. DESROCHERS  
 CHECKED BY : M. PAYNE  
 DATE : MAY 2014  
 DATE : MAY 2014

28-SEP-2016 14:26  
 \*\*\*\*\*DCN\*\*\*\*\*  
 PAYN5628 AT LUS290333

**ATKINS** 1616 E. MILLBROOK ROAD, SUITE #310  
 RALEIGH, NORTH CAROLINA 27609  
 (919) 876-6888 NCBES #F-0326

DOCUMENT NOT CONSIDERED  
 FINAL UNLESS ALL  
 SIGNATURES COMPLETED

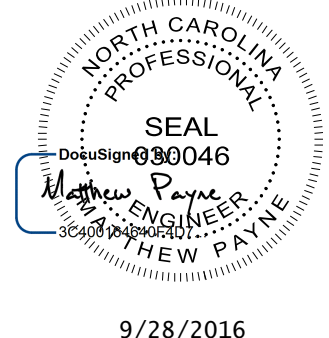

PROJECT NO. 17BP.3.R.28  
 NEW HANOVER COUNTY  
 STATION: 14+60.69 -L-

STATE OF NORTH CAROLINA DEPARTMENT OF TRANSPORTATION RALEIGH					
MISCELLANEOUS DETAILS					
REVISIONS					SHEET NO.
NO.	BY:	DATE:	NO.	BY:	DATE:
1			3		
2			4		
					C-11
					TOTAL SHEETS
					11