

GEOTECHNICAL ENGINEER

ENGINEER

DocuSigned by:
Michael H. Stephens
8/1/2016

DATE: 8/1/2016

DOCUMENT NOT CONSIDERED FINAL UNLESS ALL SIGNATURES COMPLETED

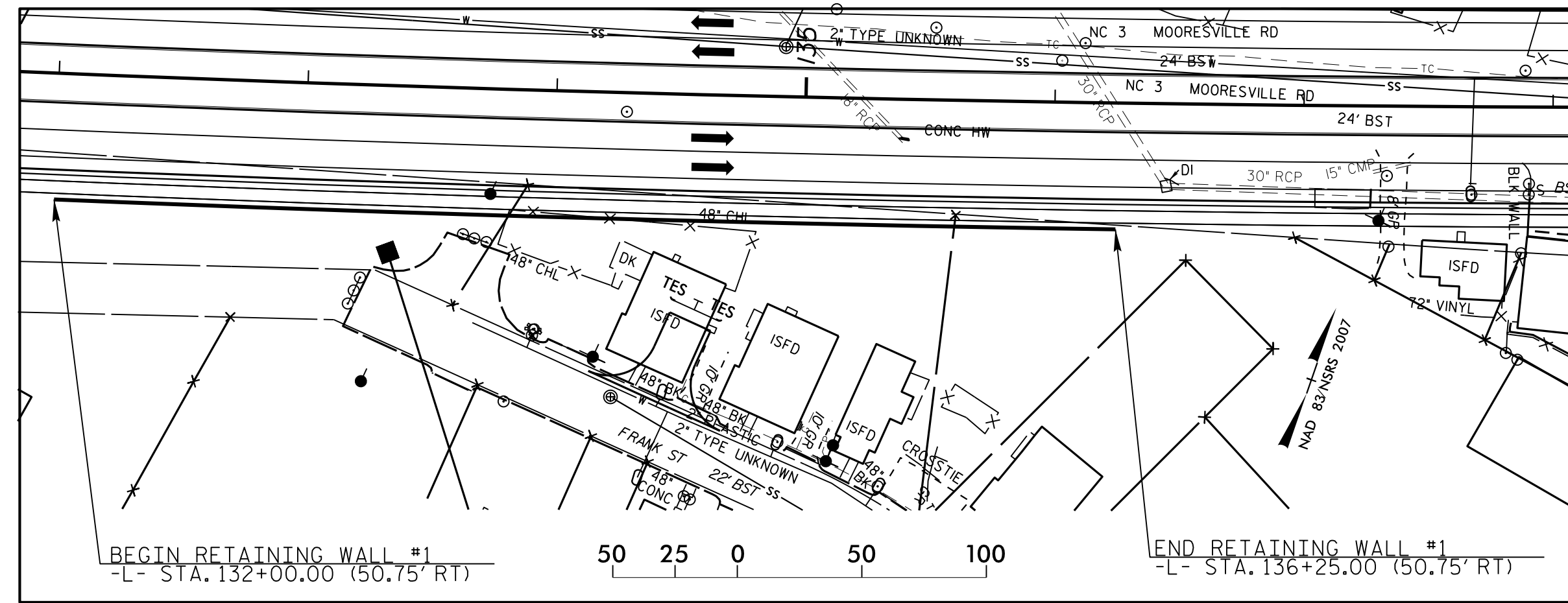

PLAN VIEW - RETAINING WALL NO. 1

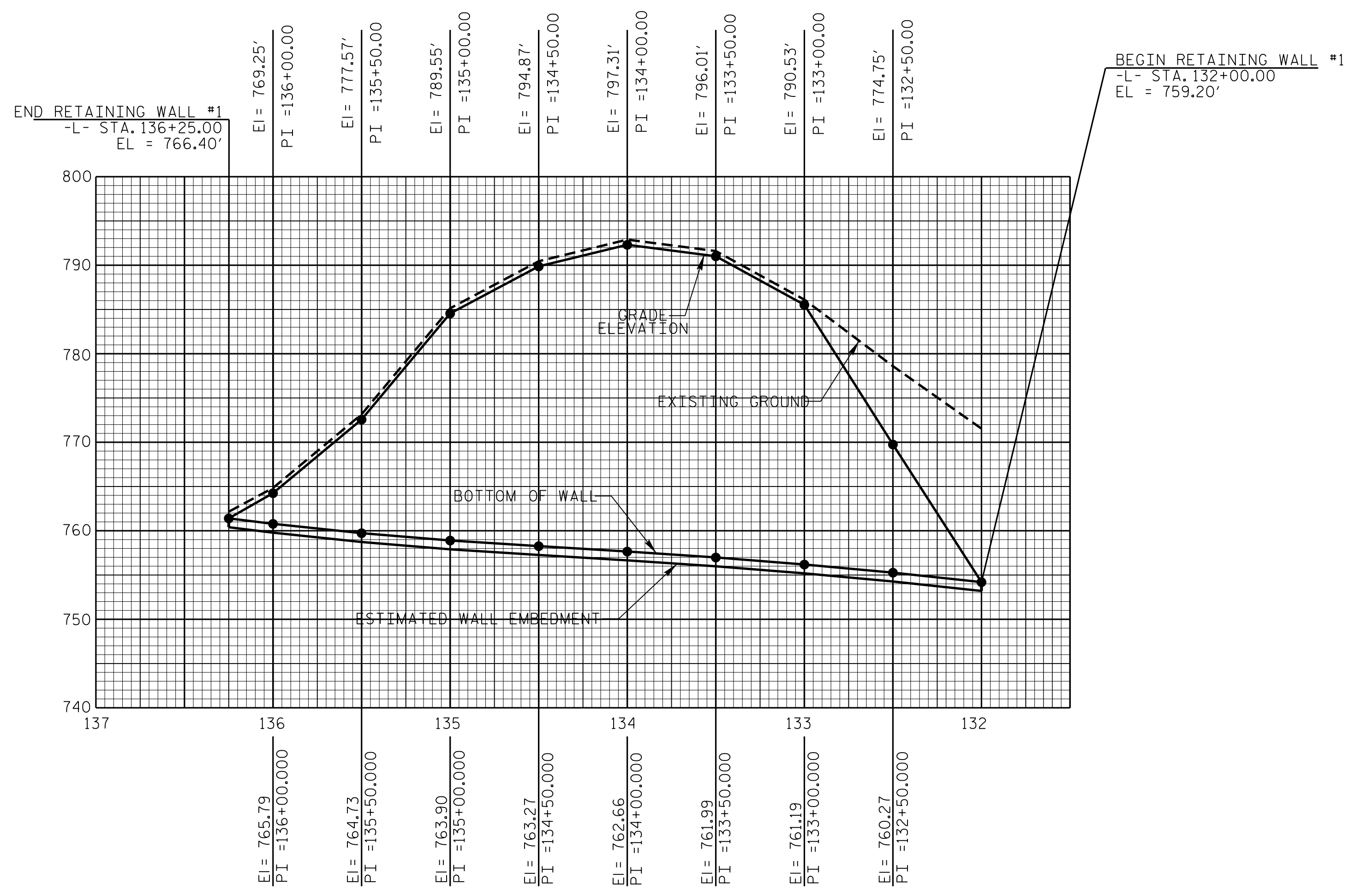

WALL ENVELOPE - RETAINING WALL NO. 1

NOTE: OFFSET DIMENSIONS ARE FROM FACE OF WALL

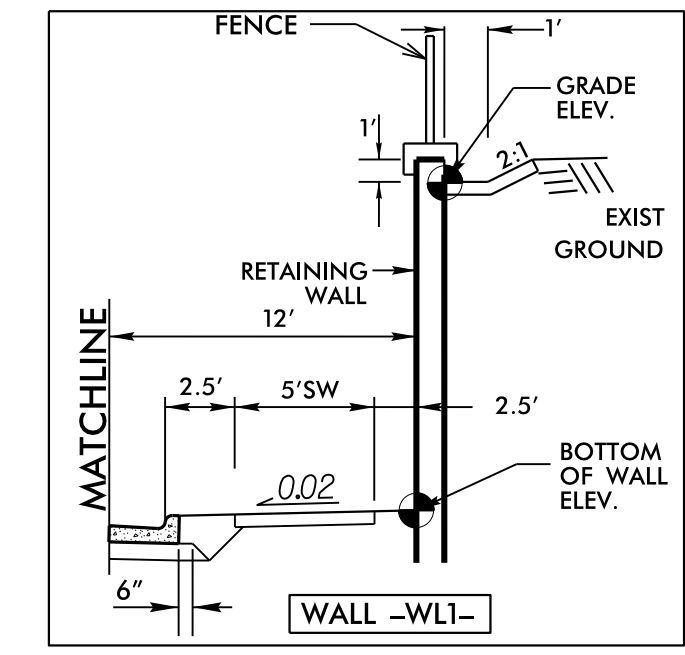

ESTIMATED SOIL NAIL WALL QUANTITIES

RETAINING WALL NO.	SOIL NAIL RETAINING WALLS (SQUARE FEET)	SOIL NAIL VERIFICATION TESTS	SOIL NAIL PROOF TESTS
WALL #1	9,690 SF	2	26

* WALL AREA IS MEASURED USING THE DESIGN HEIGHT "H"

PROJECT NO.: 39010.1.R2 (U-3440)

CABARRUS COUNTY

STATION: 132+00 -L- TO 136+25 -L-

SHEET 1 OF 9

NORTH CAROLINA
DEPARTMENT OF TRANSPORTATION
DIVISION OF HIGHWAYS

**GEOTECHNICAL
ENGINEERING UNIT**

RETAINING WALL NO. 1
SOIL NAIL WALL

REVISIONS					
NO.	BY	DATE	NO.	BY	DATE
1			3		
2			4		

PREPARED BY: MHS DATE: 7/25/2016

REVIEWED BY: SCC DATE: 7/25/2016

SHEET NO.
W1