

BILL OF MATERIAL											
STAGE I						STAGE II					
BAR	NO.	SIZE	TYPE	LENGTH	WEIGHT	BAR	NO.	SIZE	TYPE	LENGTH	WEIGHT
A1	396	#4	1	6'-8"	1764	A1	354	#4	1	6'-8"	1576
A2	396	#4	1	6'-5"	1697	A2	354	#4	1	6'-5"	1517
A100	215	#5	STR.	11'-0"	2467	A100	191	#5	STR.	11'-0"	2191
A101	3	#5	STR.	8'-4"	26	A101	3	#5	STR.	8'-4"	26
A102	3	#5	STR.	5'-9"	18	A102	3	#5	STR.	5'-9"	18
A103	3	#5	STR.	3'-2"	10	A103	3	#5	STR.	3'-2"	10
A104	1	#5	STR.	2'-4"	2	A104	1	#5	STR.	2'-4"	2
A200	242	#5	STR.	11'-0"	2776	A200	215	#5	STR.	11'-0"	2467
A201	3	#5	STR.	8'-8"	27	A201	3	#5	STR.	8'-8"	27
A202	3	#5	STR.	6'-5"	20	A202	3	#5	STR.	6'-5"	20
A203	3	#5	STR.	4'-1"	13	A203	3	#5	STR.	4'-1"	13
A204	2	#5	STR.	2'-7"	5	A204	2	#5	STR.	2'-7"	5
B1	166	#4	STR.	10'-0"	1109	B1	148	#4	STR.	10'-0"	989
B2	396	#4	STR.	8'-4"	2204	B2	354	#4	STR.	8'-4"	1971
C1	176	#4	STR.	23'-3"	2733	C2	132	#4	STR.	26'-9"	2359
D2	10	#6	STR.	2'-5"	36	D2	8	#6	STR.	2'-5"	29
D3	12	#6	STR.	1'-5"	26	D3	9	#6	STR.	1'-5"	19
G1	2	#4	STR.	11'-11"	16	G1	2	#4	STR.	11'-11"	16
S2	6	#8	STR.	11'-11"	191	S2	6	#8	STR.	11'-11"	191
REINFORCING STEEL LBS.					15,140	REINFORCING STEEL LBS.					13,446

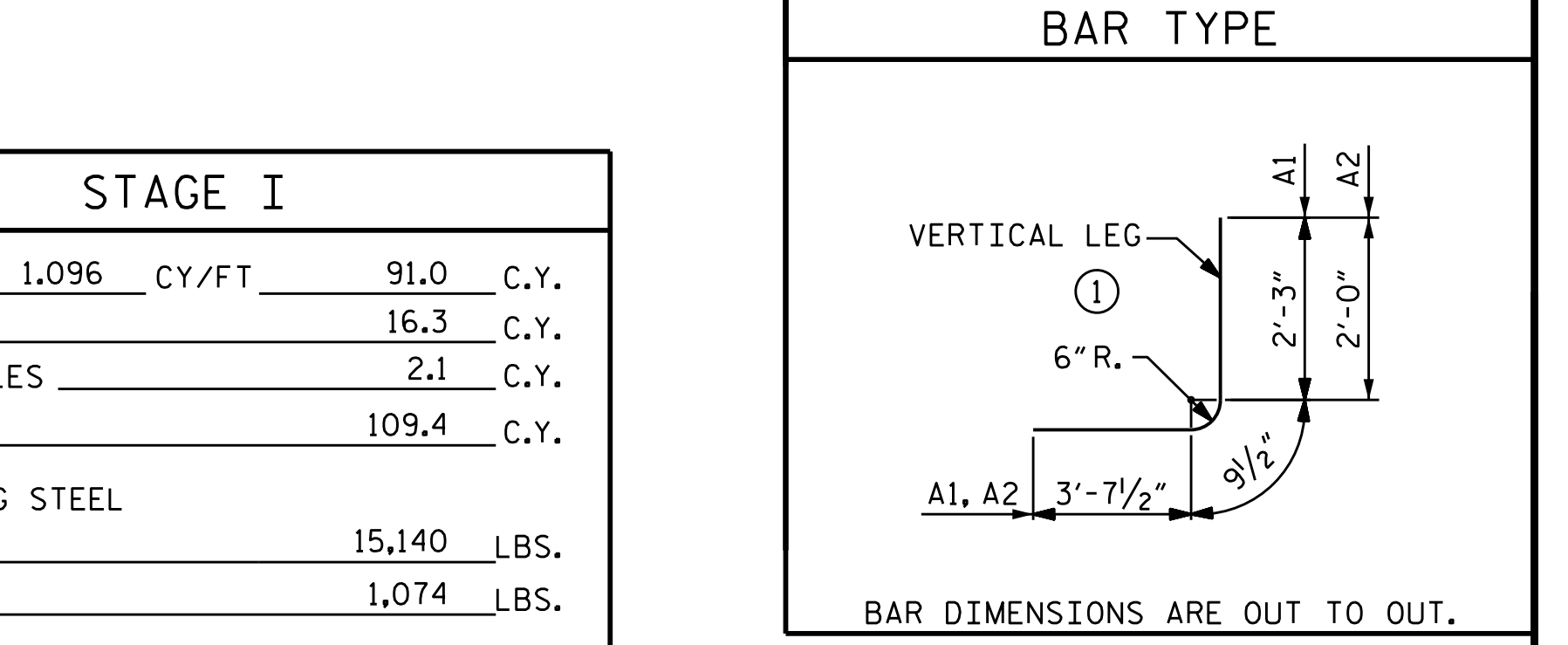

STAGE I

BARREL @	1.096	CY/FT	91.0	C.Y.
WINGS ETC.			16.3	C.Y.
SILLS, BAFFLES			2.1	C.Y.
TOTAL			109.4	C.Y.
REINFORCING STEEL				
BARREL @			15,140	LBS.
WINGS			1,074	LBS.
TOTAL			16,214	LBS.

STAGE II

CLASS A CONCRETE				
BARREL @	1.096	CY/FT	81.1	C.Y.
WINGS ETC.			16.3	C.Y.
SILLS, BAFFLES			1.6	C.Y.
TOTAL			99.0	C.Y.
REINFORCING STEEL				
BARREL @			13,446	LBS.
WINGS			1,074	LBS.
TOTAL			14,520	LBS.

SPLICE LENGTH CHART

BAR	SIZE	SPLICE LENGTH
B1	#4	1'-9"
C1	#4	1'-11"
C2	#4	1'-11"

PROJECT NO. U-3440
CABARRUS COUNTY
 STATION: 40+60.90 -L-
 SHEET 4 OF 5

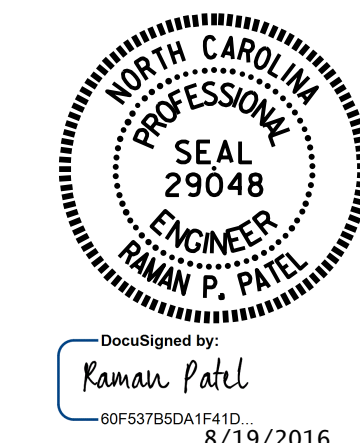

STATE OF NORTH CAROLINA
 DEPARTMENT OF TRANSPORTATION
 RALEIGH

**SINGLE 10 FT. X 9 FT.
 CONCRETE BOX CULVERT**

66°-30'-00" SKEW

REVISIONS						SHEET NO. C1-4
NO.	BY:	DATE:	NO.	BY:	DATE:	
1			3			TOTAL SHEETS 5
2			4			

DOCUMENT NOT CONSIDERED FINAL UNLESS ALL SIGNATURES COMPLETED

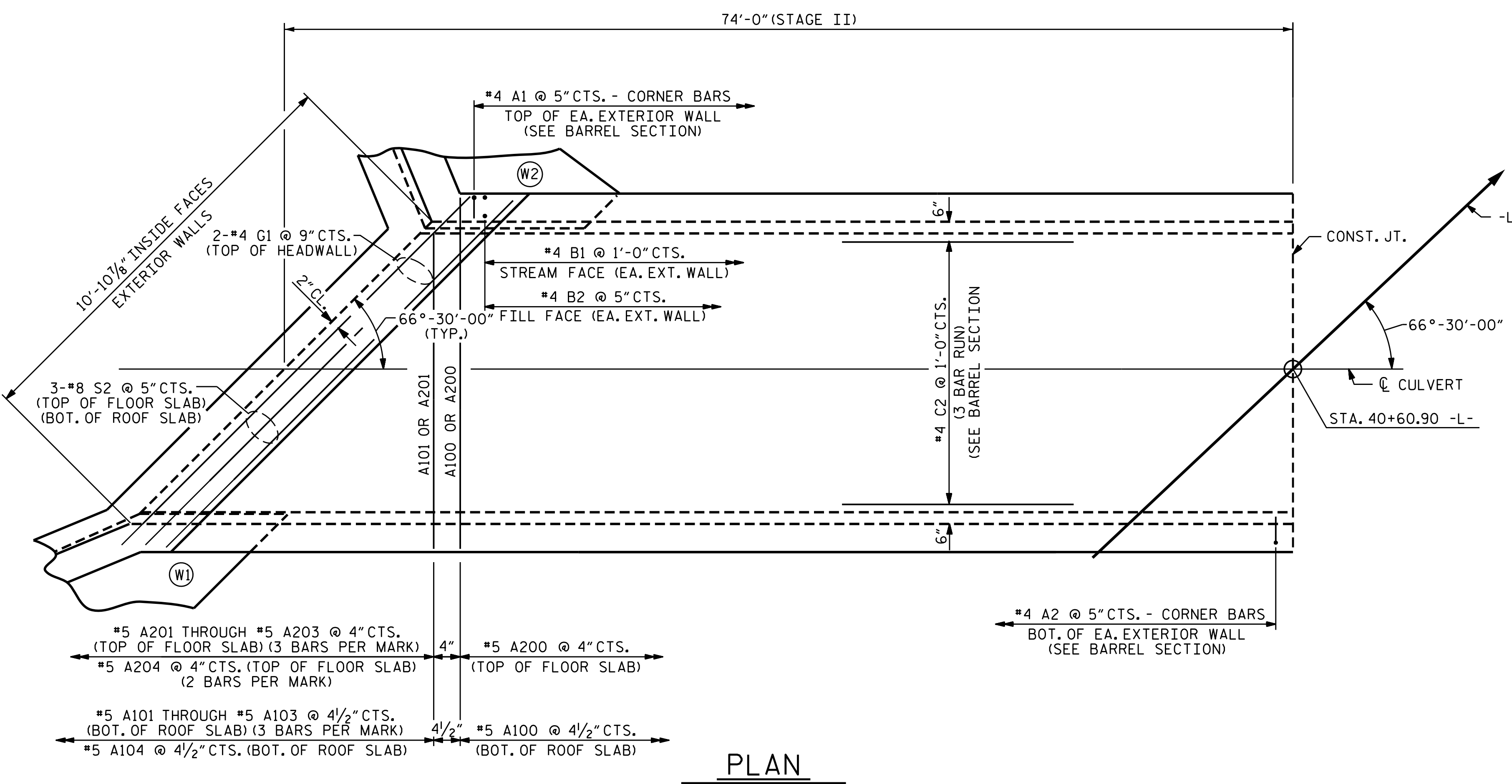
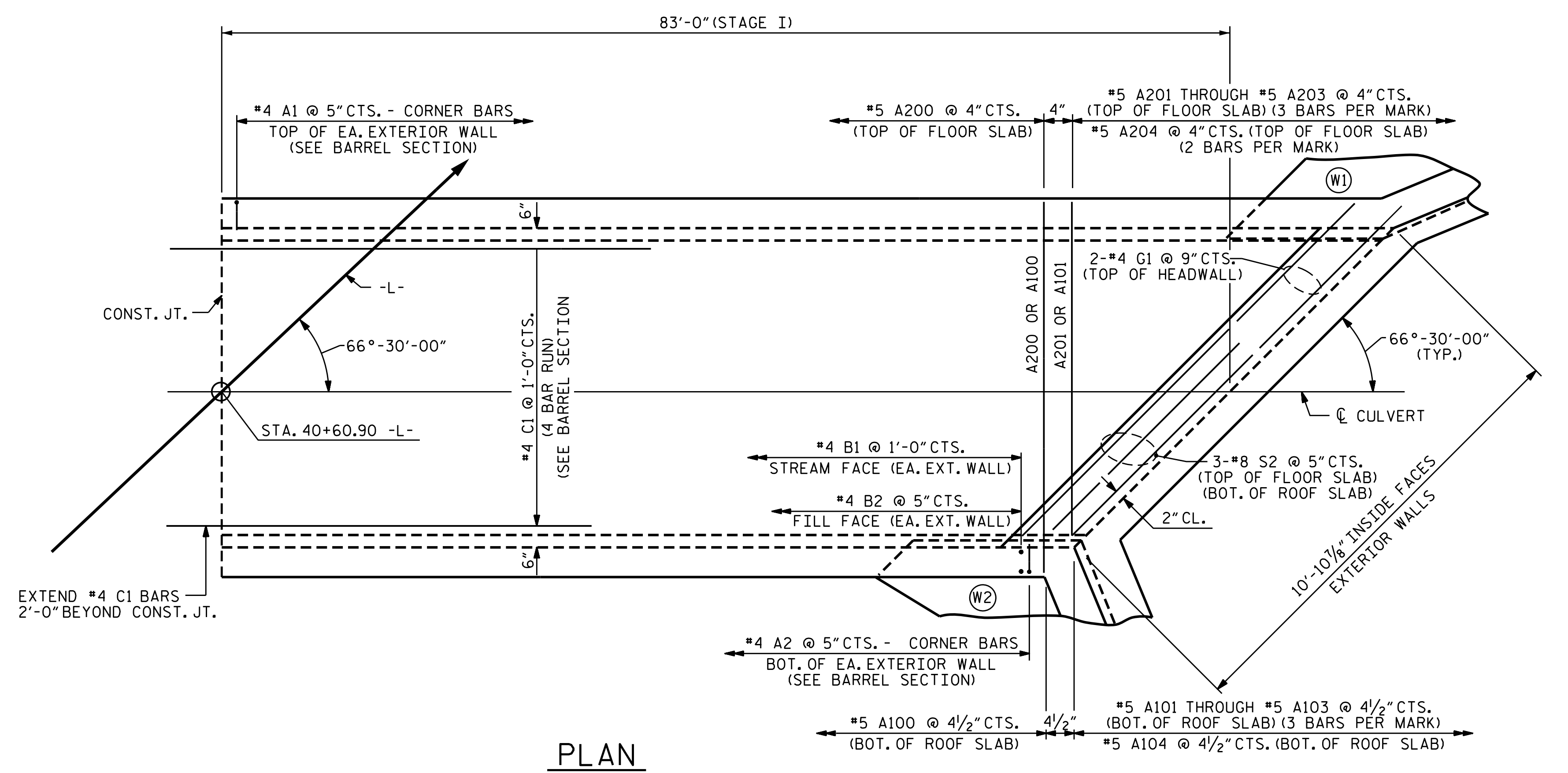

ASSEMBLED BY: N.D. AIUTO DATE: 2/16/16
 CHECKED BY: K.D. LAYNE DATE: 4/6/16
 DESIGN ENGINEER OF RECORD: R.P. PATEL DATE: 5/3/16