

PHASING DIAGRAM

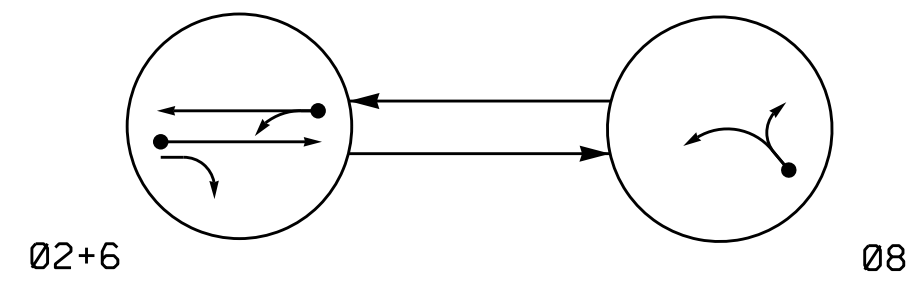

PHASING DIAGRAM DETECTION LEGEND

- DETECTED MOVEMENT
- ← UNDETECTED MOVEMENT (OVERLAP)
- UNSIGNALIZED MOVEMENT
- PEDESTRIAN MOVEMENT

SIGNAL FACE	PHASE		
	2	6	8
21, 22	G	R	Y
61, 62	G	R	Y
81, 82	R	G	R

SIGNAL FACE I.D.

All Heads L.E.D.

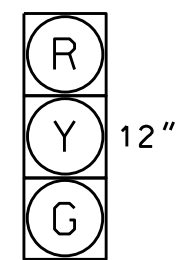

OASIS 2070 LOOP & DETECTOR INSTALLATION CHART												
INDUCTIVE LOOPS				DETECTOR PROGRAMMING								
LOOP	SIZE (FT)	DISTANCE FROM STOPBAR (FT)	TURNS	NEW LOOP	PHASE	CALLING	EXTENSION	FULL TIME DELAY	STRETCH TIME	DELAY TIME	SYSTEM LOOP	NEW CARD
2A	6X6	300	5	Y	2	Y	Y	-	-	-	-	-
6A	6X6	300	5	Y	6	Y	Y	-	-	-	-	-
6B	6X40	0	2-4-2	Y	6	Y	Y	Y	2	5	-	-
8A	6X40	0	2-4-2	Y	8	Y	Y	-	-	3	-	-
8B	6X30	+5	2-4-2	Y	8	Y	Y	-	-	15	-	-

2 Phase Fully Actuated Isolated

NOTES

- Refer to "Roadway Standard Drawings NCDOT" dated January 2012 and "Standard Specifications for Roads and Structures" dated January 2012.
- Do not program signal for late night flashing operation unless otherwise directed by the Engineer.
- Relocate existing signal heads numbered 21, 22, 61, 62, 81 & 82.
- Set all detector units to presence mode.
- Relocate sign "A" and "B" from Previous Temporary Signal.

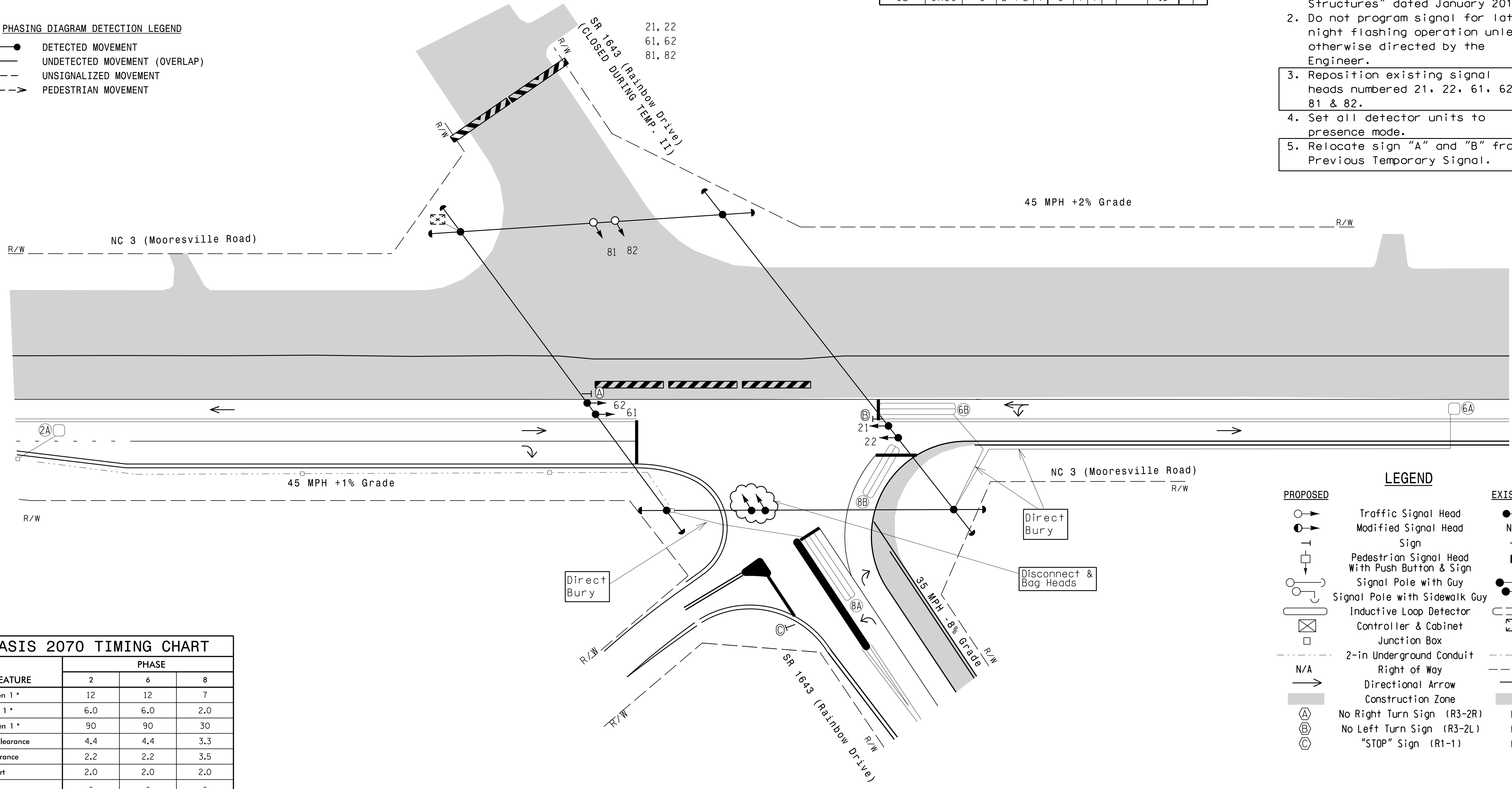

OASIS 2070 TIMING CHART			
FEATURE	PHASE		
	2	6	8
Min Green 1 *	12	12	7
Extension 1 *	6.0	6.0	2.0
Max Green 1 *	90	90	30
Yellow Clearance	4.4	4.4	3.3
Red Clearance	2.2	2.2	3.5
Red Revert	2.0	2.0	2.0
Walk 1 *	-	-	-
Don't Walk 1	-	-	-
Seconds Per Actuation *	2.5	-	-
Max Variable Initial *	34	-	-
Time Before Reduction *	15	15	-
Time To Reduce *	30	30	-
Minimum Gap	3.0	3.0	-
Recall Mode	MIN RECALL	MIN RECALL	-
Vehicle Call Memory	YELLOW	-	-
Dual Entry	-	-	-
Simultaneous Gap	ON	ON	ON

* These values may be field adjusted. Do not adjust Min Green and Extension times for phases 2 and 6 lower than what is shown. Min Green for all other phases should not be lower than 4 seconds.

PROPOSED	EXISTING
○ → Traffic Signal Head	● → Traffic Signal Head
○ → Modified Signal Head	N/A
○ → Pedestrian Signal Head With Push Button & Sign	○ → Sign
○ → Signal Pole with Guy	○ → Signal Pole with Guy
○ → Signal Pole with Sidewalk Guy	○ → Signal Pole with Sidewalk Guy
□ → Inductive Loop Detector	□ → Inductive Loop Detector
□ → Controller & Cabinet	□ → Controller & Cabinet
□ → Junction Box	□ → Junction Box
--- 2-in Underground Conduit	--- 2-in Underground Conduit
N/A	→ Right of Way
→ Directional Arrow	→ Construction Zone
Ⓐ	Ⓐ No Right Turn Sign (R3-2R)
Ⓑ	Ⓑ No Left Turn Sign (R3-2L)
Ⓒ	Ⓒ "STOP" Sign (R1-1)

Signal Upgrade Temporary Design-TMP Phase II

Prepared in the Offices of:

 750 N. Greenfield Pkwy, Garner, NC 27529

NC 3 (Mooresville Road) at SR 1643 (Rainbow Drive)

Division 10 Cabarrus County Kannapolis
 PLAN DATE: April 2016 REVIEWED BY: T. Williams
 PREPARED BY: M. Mahbooba REVIEWED BY:

SCALE 0 30
1"=30'

REVISIONS INIT. DATE

DocuSigned by: J. Williams 6/22/2016
 97AD792EB834CA DATE

SIG. INVENTORY NO. 10-0395 12

DOCUMENT NOT CONSIDERED FINAL UNLESS ALL SIGNATURES COMPLETED

SEAL
 NORTH CAROLINA PROFESSIONAL ENGINEER
 SEAL 024393
 J. WILLIAMS
 DATE 6/22/2016

22-jul-2016 09:53
 R:\Projects\10-0395\Signal\10-0395-TMP-Phase-II\10-0395-TMP-Phase-II.dgn
 mmb00000