

5/2/14

# SURVEY CONTROL SHEET

PROJECT REFERENCE NO.	SHEET NO.
U-3440	1 C-3
Location and Surveys	

BY11 POINT	DESC.	NORTH	EAST	ELEVATION	Y12 STATION	OFFSET
E021	BL-21	638656.3750	1511333.2740	719.50	OUTSIDE PROJECT LIMITS	
41	BY11-41	638687.2250	1511642.2230	753.93	12+67.39	10.39 RT
BY12 POINT	DESC.	NORTH	EAST	ELEVATION	Y13 STATION	OFFSET
42	BY12-42	639334.4300	1511856.9410	719.76	12+27.48	122.15 LT
E023	BL-23	639393.1340	1512174.8620	717.79	OUTSIDE PROJECT LIMITS	
BY13 POINT	DESC.	NORTH	EAST	ELEVATION	STATION	OFFSET
44	BY14-44	639692.2530	1512041.0760	734.75	OUTSIDE PROJECT LIMITS	
E0U23	BL-23	639393.1340	1512174.8620	717.79	Y14 13+03.62	23.66 LT
43	BY13-43	639165.1800	1512252.8700	704.13	Y15 12+14.21	32.77 RT
BY15 POINT	DESC.	NORTH	EAST	ELEVATION	Y16 STATION	OFFSET
45	BY15-45	639763.0730	1512397.1740	744.52	10+45.92	11.13 RT
E024	BL-24	639505.4600	1512413.4740	727.62	13+05.76	6.53 LT
BY16 POINT	DESC.	NORTH	EAST	ELEVATION	Y17 STATION	OFFSET
46	BY16-46	640164.5940	1513741.1380	772.26	10+79.26	12.29 RT
E026	BL-26	640104.3300	1513948.6150	781.93	OUTSIDE PROJECT LIMITS	
BY17 POINT	DESC.	NORTH	EAST	ELEVATION	Y18 STATION	OFFSET
47	BY17-47	640476.3270	1514185.5510	803.84	10+32.80	16.29 LT
E027	BL-27	640310.1460	1514283.8700	799.75	12+25.56	27.43 LT
49	BY17-49	640109.5390	1514378.9950	800.71	OUTSIDE PROJECT LIMITS	

BY18 POINT	DESC.	NORTH	EAST	ELEVATION	Y22 STATION	OFFSET
48	BY18-48	640788.1350	1514644.5920	824.02	10+55.64	43.76 RT
E028	BL-28	640517.4440	1514737.4970	823.19	13+41.47	58.24 RT
50	BY18-50	640140.8970	1514910.2680	813.81	OUTSIDE PROJECT LIMITS	
4	U3440-4	639263.1600	1515311.9950	794.84	OUTSIDE PROJECT LIMITS	
3	U3440-3	638775.9640	1514979.1880	793.95	OUTSIDE PROJECT LIMITS	

NOTES: SEE SHEET 1C-2

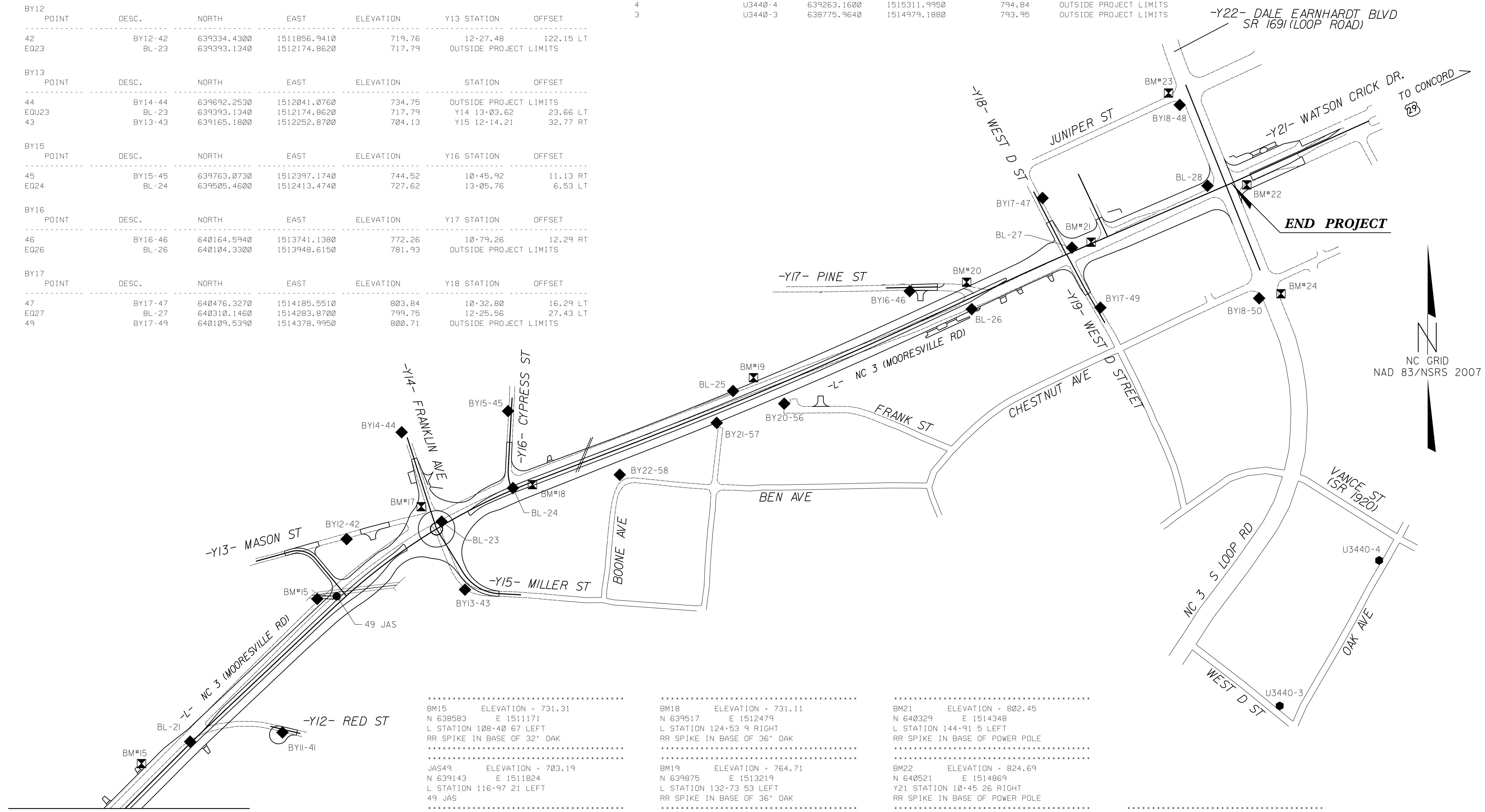

MATCH LINE SHEET 1C-2

.....  
 BM15 ELEVATION = 731.31  
 N 638583 E 1511171  
 L STATION 100+40 67 LEFT  
 RR SPIKE IN BASE OF 32' OAK  
 .....  
 JAS49 ELEVATION = 703.19  
 N 639143 E 1511024  
 L STATION 116+97 21 LEFT  
 49 JAS  
 .....  
 BM17 ELEVATION = 719.88  
 N 639443 E 1512107  
 Y14 STATION 12+35 26 RIGHT  
 RR SPIKE IN BASE OF 20' OAK  
 .....

.....  
 BM18 ELEVATION = 731.11  
 N 639517 E 1512479  
 L STATION 124+53 9 RIGHT  
 RR SPIKE IN BASE OF 36' OAK  
 .....  
 BM19 ELEVATION = 764.71  
 N 639875 E 1513219  
 L STATION 132+73 53 LEFT  
 RR SPIKE IN BASE OF 36' OAK  
 .....  
 BM20 ELEVATION = 782.27  
 N 640195 E 1513932  
 L STATION 140+57 54 LEFT  
 RR SPIKE IN BASE OF POWER POLE  
 .....

.....  
 BM21 ELEVATION = 802.45  
 N 640329 E 1514348  
 L STATION 144+91 5 LEFT  
 RR SPIKE IN BASE OF POWER POLE  
 .....  
 BM22 ELEVATION = 824.69  
 N 640521 E 1514869  
 Y21 STATION 10+45 26 RIGHT  
 RR SPIKE IN BASE OF POWER POLE  
 .....  
 BM23 ELEVATION = 825.48  
 N 640828 E 1514607  
 Y22 STATION 10+05 63 RIGHT  
 RR SPIKE IN BASE OF TEL POLE  
 .....

.....  
 BM24 ELEVATION = 814.52  
 N 640156 E 1514984  
 Y22 STATION 16+70  
 S 41+46+5.8" E DIST 104.80  
 RR SPIKE IN BASE OF POWER POLE  
 .....

NOTE: DRAWING NOT TO SCALE

5/2/2016 10:47:26 AM C:\Users\jcooper\Documents\Projects\U-3440\1c-3.dgn