

**RETAINING WALL 2 -WALL2- ESTIMATED WALL QUANTITY**

MSE RETAINING WALL	*14,365 SQUARE FEET
--------------------	---------------------

\* WALL AREA IS MEASURED USING THE DESIGN HEIGHT "H"

**FRONT SLOPE WALL EMBEDMENT**

SLOPE IN FRONT OF STRUCTURES	MINIMUM EMBEDMENT DEPTH	
	FOR WALLS	FOR ABUTMENTS
HORIZONTAL	H/20	H/10
3.0H:1.0V	H/10	H/10
2.5H:1.0V	H/8.5	H/8.5
2.0H:1.0V	H/7	H/7
1.5H:1.0V	H/5	H/5
1.25H:1.0V	H/4	H/4
1.0H:1.0V	H/3	H/3

NOTE:  
 1) MAINTAIN A MINIMUM BENCH WIDTH OF 4.0 FT IN FRONT OF THE WALL FOR ITS ENTIRE LENGTH.  
 2) MINIMUM EMBEDMENT DEPTH OF 2 FT, UNLESS LARGER DEPTHS DICTATED BY THE ABOVE TABLE.  
 3) MAXIMUM SLOPE OF 1H:1V WILL BE MAINTAINED ON FRONT SLOPES FOR THE ENTIRE LENGTH OF THE WALL.  
 4) SUBMIT WITH THE WALL DESIGN INTERNAL, EXTERNAL, AND GLOBAL STABILITY ANALYSES.

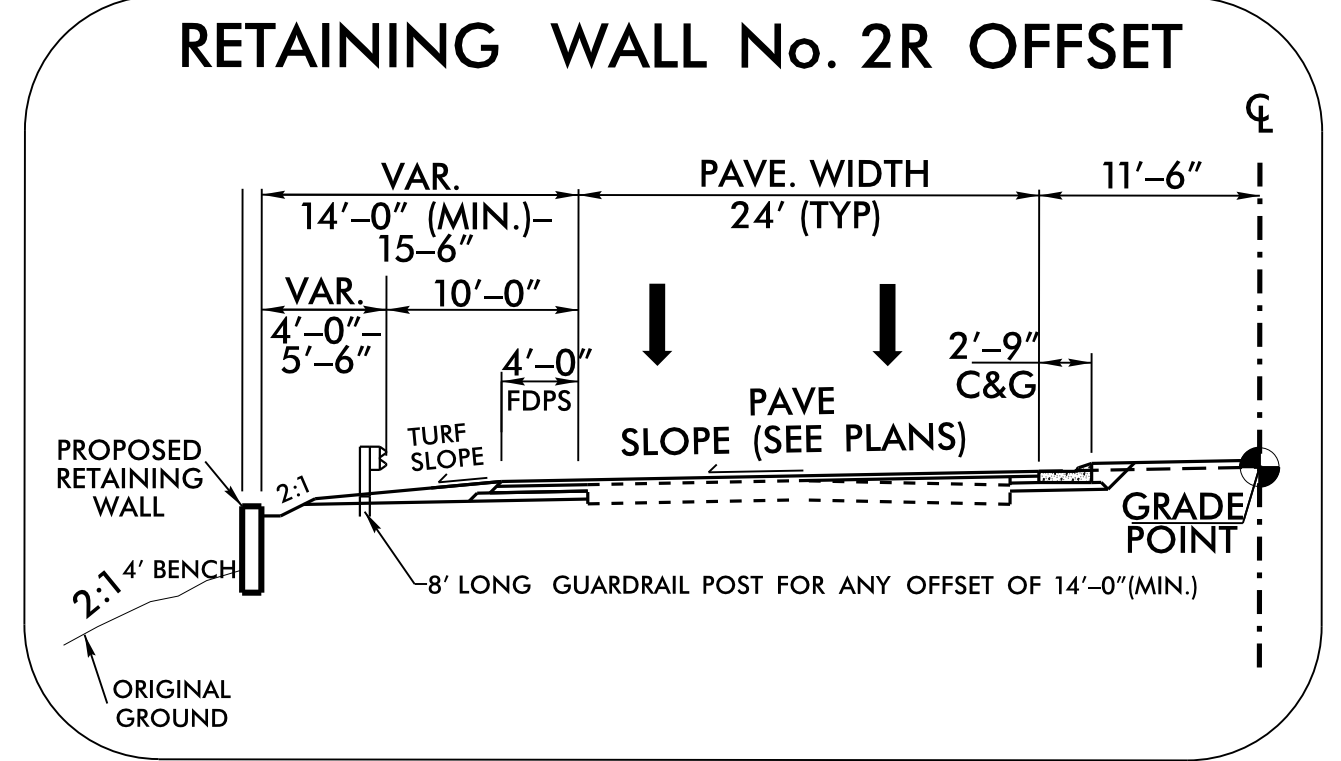
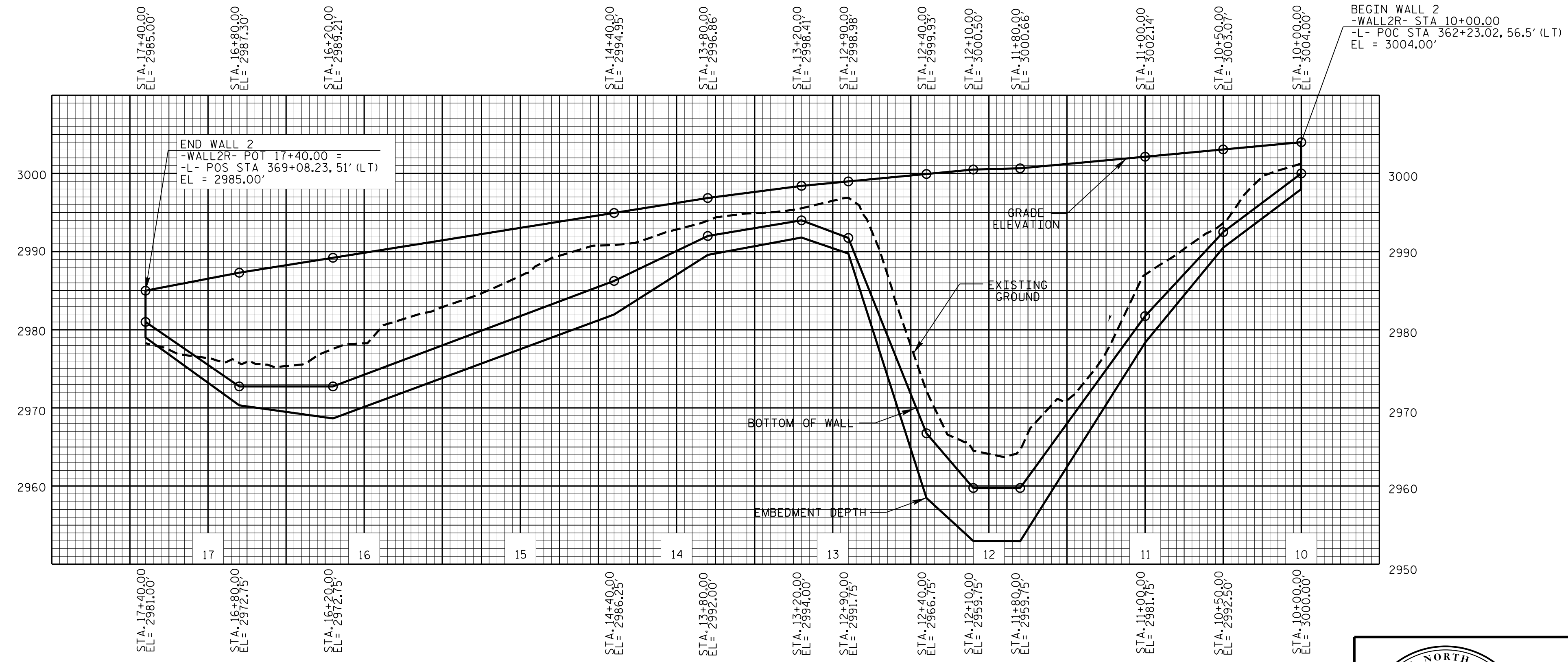

**USE DETAIL AS FOLLOWS:**  
 -L- STA. 362+23.02 TO STA. 369+08.23 LT.

PROJECT NO.: 34518.1.4 (R-2915C)

ASHE COUNTY

STATION: STA 362+23 -L TO 369+08 -L-

SHEET 1 OF 3

NORTH CAROLINA DEPARTMENT OF TRANSPORTATION DIVISION OF HIGHWAYS

GEOTECHNICAL ENGINEERING UNIT

**RETAINING WALL NO. 2 MSE RETAINING WALL**

REVISIONS					
NO.	BY	DATE	NO.	BY	DATE
1			3		
2			4		

SHEET NO. W-3