

T.I.P.: R-2915C

CONTRACT:

**STATE OF NORTH CAROLINA
DEPARTMENT OF TRANSPORTATION**

**SIGNING PLAN
ASHE COUNTY**

**LOCATION: US 221 FROM NORTH OF SOUTH FORK NEW RIVER
TO SOUTH OF NC 194.**

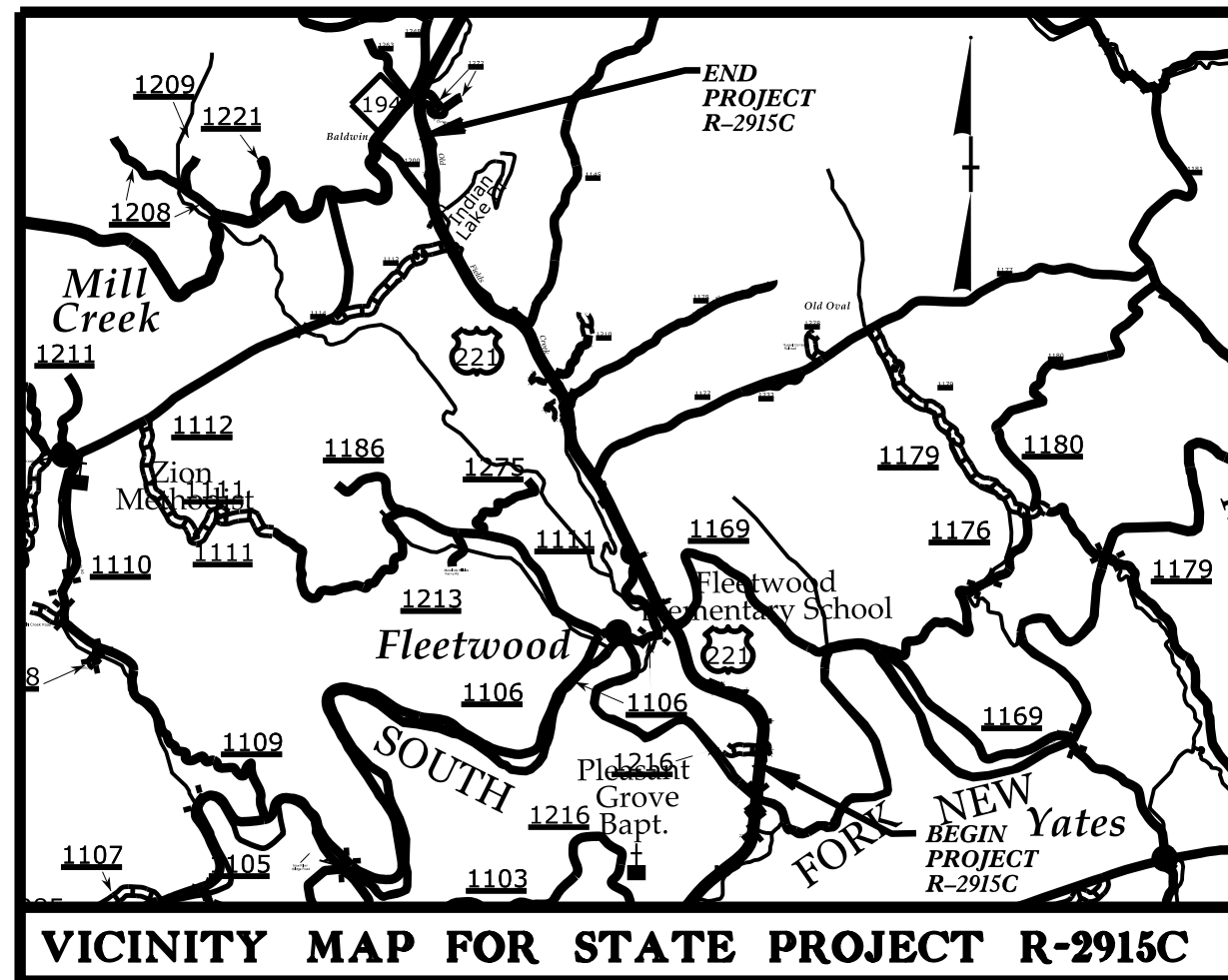

<small>TIP NO.</small> R-2915C	<small>SHEET NO.</small> SIGN-1
<small>APPROVED:</small> <i>Joseph Kopaskie</i>	
<small>DATE:</small> 6/21/2016	
<small>DOCUMENT NOT CONSIDERED FINAL UNLESS ALL SIGNATURES COMPLETED</small>	

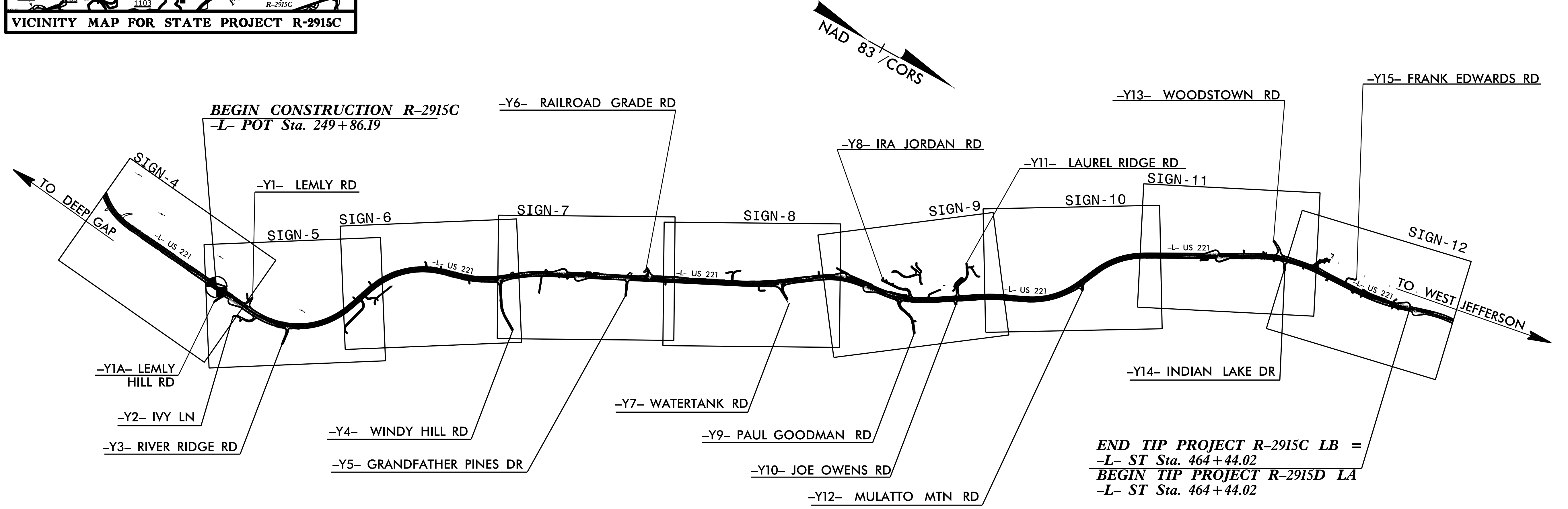

SEPI
ENGINEERING & CONSTRUCTION

1025 Wade Avenue
Raleigh, NC 27605
Tel: 919-789-9977
Fax: 919-789-9591
License: C-2197

<small>PLAN PREPARED FOR: N.C.D.O.T. SIGNING AND DELINEATION UNIT</small>	
<u>KELVIN L. JORDAN</u>	<small>SIGNING & DELINEATION REGIONAL ENGINEER</small>
<u>DERRICK H. BEARD</u>	<small>SIGNING & DELINEATION PROJECT DESIGN ENGINEER/TECHNICIAN</small>

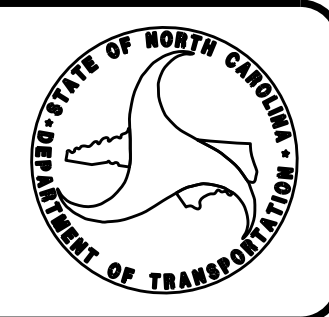

<small>PLAN PREPARED BY: SEPI ENGINEERING & CONSTRUCTION</small>	
<u>JOSEPH B. KOPASKIE, PE</u>	<small>SIGNING & DELINEATION PROJECT ENGINEER</small>
<u>RICHARD DRAYTON</u>	<small>SIGNING & DELINEATION PROJECT DESIGN ENGINEER</small>

<small>SHEET NO.</small>	<small>DESCRIPTION</small>
SIGN-1-1A	TITLE SHEET, NOTES, QUANTITIES AND SPECIFICATIONS
SIGN-2 & 2A	E & F
SIGN-3	SIGN DESIGNS
SIGN-4-12	R-2915C EXISTING & PROPOSED SIGN DETAIL SHEETS