

8/17/99

PROJECT REFERENCE NO. R-2915C	SHEET NO. EC-18/CONST.18
RW SHEET NO.	
ROADWAY DESIGN ENGINEER	HYDRAULICS ENGINEER

MATCH TO SHEET 17 -L- STA. 433+00.00

MATCH TO SHEET 19 -L- STA. 446+00.00

80 x 40 x 3
 2.0 inch Skimmer
 with 1.625 inch
 Orifice Diameter
 16 ft. weir
 ID 18.1

CLEARING AND GRUBBING
 EROSION CONTROL FOR
 CONSTRUCTION SHEET 18

NAD 83
 CORS

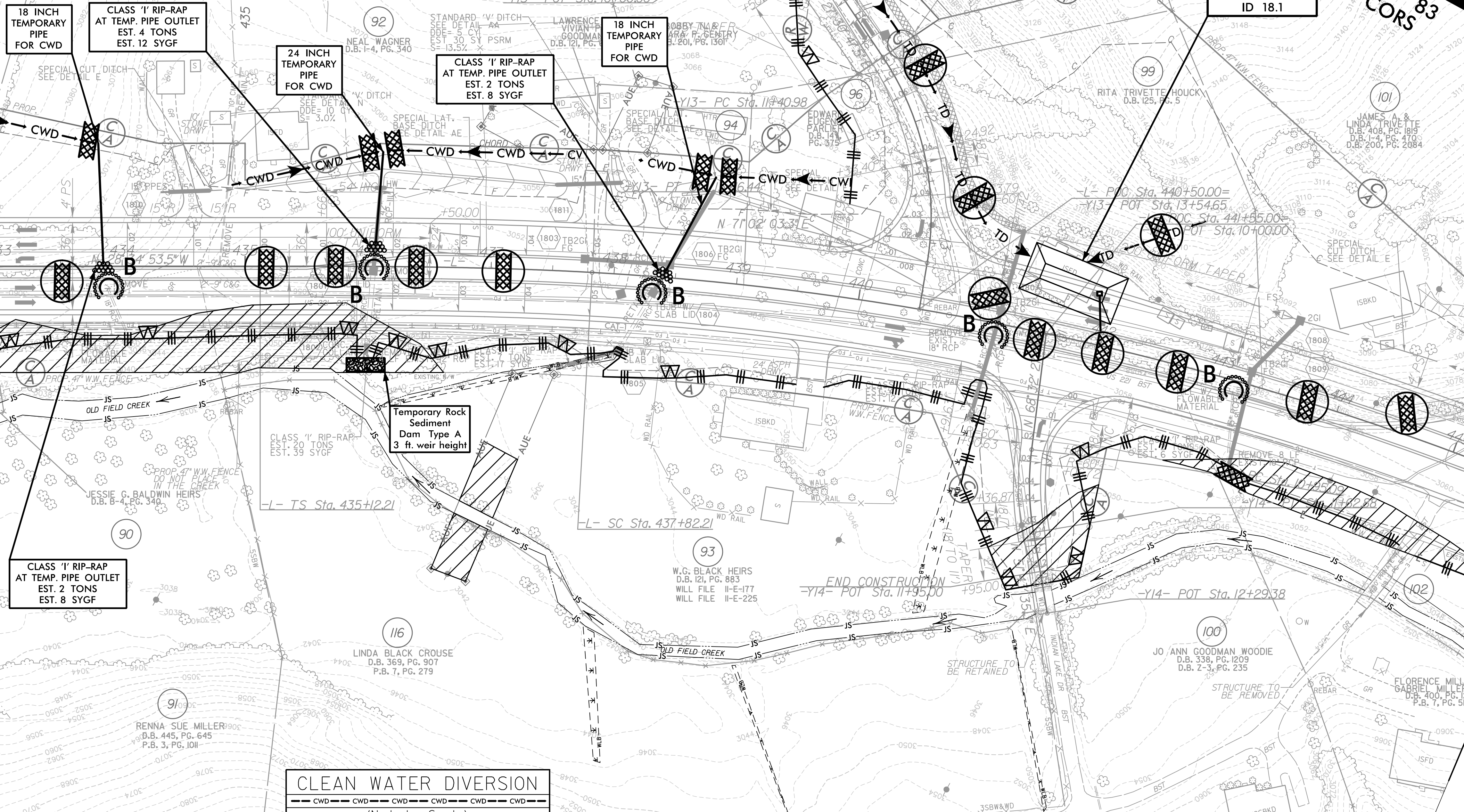

CLEAN WATER DIVERSION
 (Not to Scale)

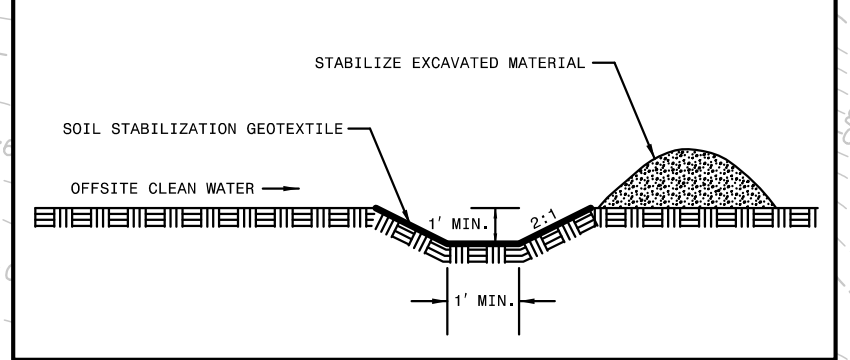

NOTE:
 PLACE TEMPORARY ROCK SEDIMENT DAMS TYPE - B
 AND TEMPORARY ROCK SILT CHECKS TYPE - A AT
 DRAINAGE OUTLETS.

ENVIRONMENTALLY SENSITIVE AREA
 SEE PROJECT SPECIAL PROVISIONS

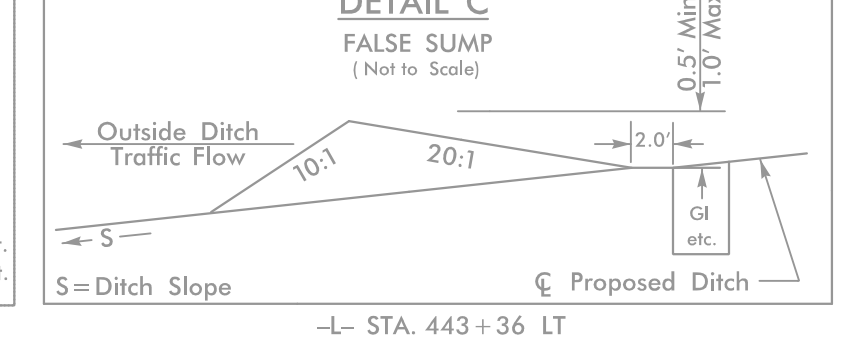
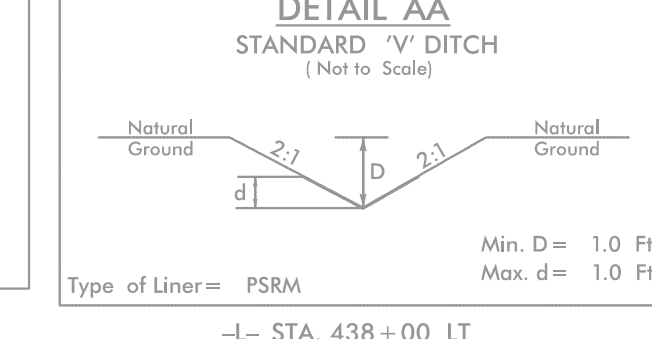
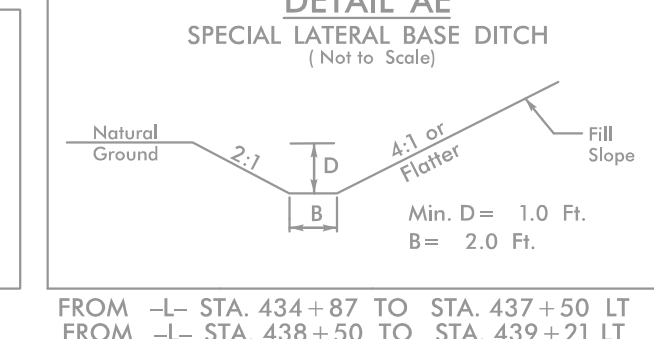
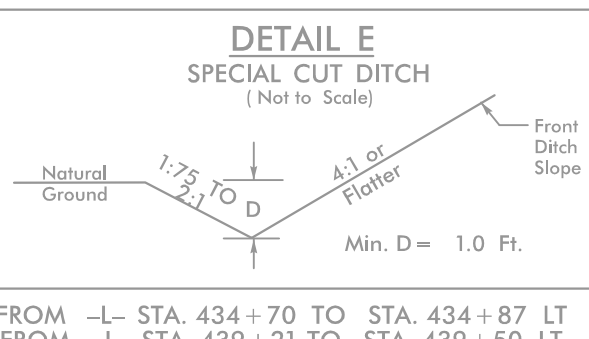
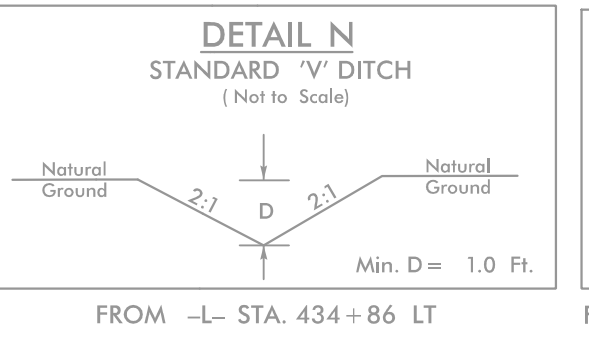
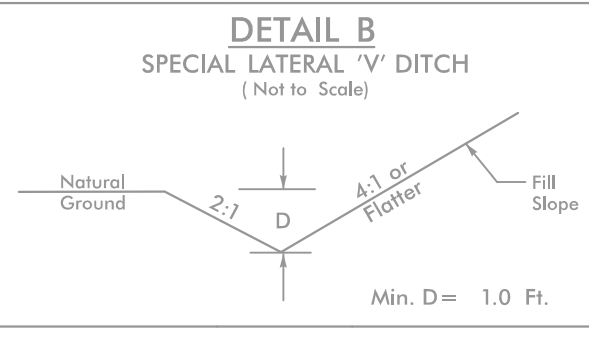

REVISIONS

12/09/2019 REV
 R-2915C_cg_PSH18.dgn
 \$\$\$\$\$\$
 \$\$\$\$\$\$