

SURVEY CONTROL SHEET R-2915C

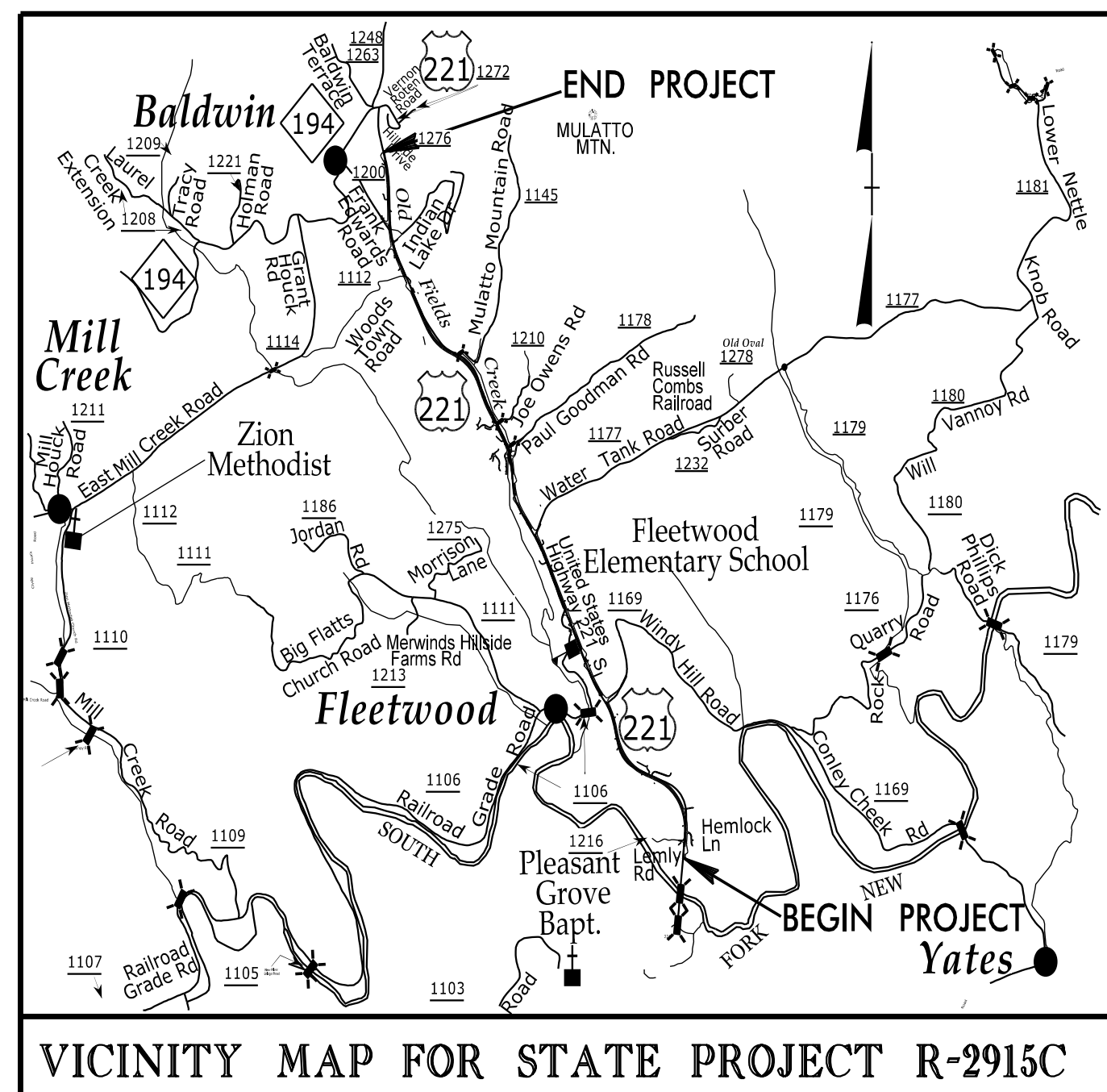

VICINITY MAP FOR STATE PROJECT R-2915C

BLC POINT	DESC.	NORTH	EAST	ELEVATION	L STATION	OFFSET
BL56	BL-56	933971.1908	1263965.8128	2878.83	OUTSIDE PROJECT LIMITS	
BL57	BL-57	934894.1246	1263792.9538	2876.93	248+49.66	7.77 LT
BL58	BL-58	935748.1689	1263880.7456	2884.86	248+95.32	7.88 LT
BL59	BL-59	935429.4463	1263716.1781	2937.49	250+45.26	43.14 LT
BL60	BL-60	937238.1186	1264003.2714	3004.18	266+32.87	118.83 RT
BL61	BL-61	937539.3877	1263895.9569	3024.43	269+28.84	158.39 RT
BL62	BL-62	937098.0994	1263463.6352	3073.87	274+33.28	96.55 RT
BL63	BL-63	938845.8861	1262934.7554	3067.68	279+54.97	4.91 RT
BL64	BL-64	938894.2888	1262287.8787	3024.48	286+42.37	48.37 LT
BL65	BL-65	938615.8929	1261524.6635	2998.75	291+87.58	87.74 LT
BL66	BL-66	939498.8481	1261785.9973	2946.98	299+96.96	8.21 RT
BL67	BL-67	939426.8949	1261398.7052	2968.21	305+29.57	66.38 LT
BL68	BL-68	940461.9594	1261828.1958	2996.85	311+96.87	52.21 LT
BL69	BL-69	940931.7493	1260852.5682	2991.31	316+78.18	2.65 RT
R291518	GPS-R2915-18	941223.4318	1260628.3848	2992.84	328+28.67	78.94 LT
BL70	BL-70	941772.4193	1260448.3632	3005.78	328+82.96	8.85 RT
BL71	BL-71	942281.2144	1260142.1275	3016.34	331+94.52	44.86 LT
BL72	BL-72	942558.2349	1259887.8457	3026.98	338+26.54	41.75 LT
BL73	BL-73	943222.8826	1259684.9683	3025.38	342+39.83	37.52 LT
BL74	BL-74	943678.8751	1259462.3748	3011.12	347+41.48	45.38 LT
BL75	BL-75	944183.2888	1259258.6888	3003.47	352+15.82	7.21 RT
BL76	BL-76	944546.4188	1258886.9836	3008.49	357+88.18	47.16 LT
BL77	BL-77	945061.1548	1258589.7795	2998.62	363+82.98	58.65 LT
BL78	BL-78	945936.8536	1258474.9413	2977.77	371+88.68	33.59 LT
BL79	BL-79	946321.3457	1258401.8927	2969.35	376+45.61	35.85 RT
BL80	BL-80	946928.2772	1258023.1991	2981.88	383+86.83	11.16 RT
BL81	BL-81	947838.1088	1257588.1454	3012.84	394+89.89	2.39 LT
BL82	BL-82	948198.3187	1257397.8311	3012.12	397+89.74	69.24 RT
BL83	BL-83	948486.8528	1257176.7812	3015.63	401+13.28	88.48 RT
BL84	BL-84	948678.8824	1256866.3201	3014.86	404+88.86	89.45 RT
BL85	BL-85	949028.9767	1256295.4791	3026.89	418+85.36	43.27 RT
BL86	BL-86	949524.8882	1255774.3889	3046.72	419+89.29	32.83 RT
BL87	BL-87	950351.1722	1255348.9986	3068.65	429+34.73	51.89 RT
BL88	BL-88	951189.6478	1254958.8685	3054.99	438+86.72	16.89 RT
R291513	GPS-R2915-13	951589.5128	1254826.4558	3052.21	441+85.22	117.52 RT
BL89	BL-89	952461.9985	1254618.6151	3066.84	451+18.11	0.91 LT
BL90	BL-90	953319.5365	1254587.6431	3074.24	459+71.98	38.58 RT
BL91	BL-91	953878.2826	1254459.6825	3078.48	465+41.23	56.84 RT
BL92	BL-92	954796.9943	1254266.4138	3096.24	OUTSIDE PROJECT LIMITS	
BL93	BL-93	955996.2584	1254561.4334	3184.23	OUTSIDE PROJECT LIMITS	
BL94	BL-94	956128.1518	1254343.8913	3117.47	OUTSIDE PROJECT LIMITS	
BL95	BL-95	956571.2982	1255187.4388	3125.38	OUTSIDE PROJECT LIMITS	

BYC3 POINT	DESC.	NORTH	EAST	ELEVATION	Y7 STATION	OFFSET
BYC241	BY-C241	944183.2888	1259258.6888	3003.47	OUTSIDE PROJECT LIMITS	
BYC242	BY-C242	944296.8295	1259389.1852	3088.46	11+72.45	12.89 LT
BYC243	BY-C243	944894.5565	1259656.6887	3017.39	OUTSIDE PROJECT LIMITS	
BYC244	BY-C244	945126.1254	1260134.1979	3026.87	OUTSIDE PROJECT LIMITS	

BYC4 POINT	DESC.	NORTH	EAST	ELEVATION	Y9 STATION	OFFSET
BYC445	BL-C19	944931.3457	1258481.8927	2969.35	12+76.86	219.88 LT
BYC446	GPS-R2915-11	946476.3118	1258539.4528	2961.58	14+19.94	131.89 LT
BYC447	BY-C447	946523.2884	1258772.9117	2977.28	15+82.88	4.18 RT
BYC448	BY-C448	946654.4733	1258976.8454	2986.77	OUTSIDE PROJECT LIMITS	

BYC1 POINT	DESC.	NORTH	EAST	ELEVATION	Y4 STATION	OFFSET
BYC131	BL-C7	939926.8949	1261398.7052	2968.21	OUTSIDE PROJECT LIMITS	
BYC132	BY-C132	940831.1722	1261714.5821	2935.17	12+59.96	181.48 RT
BYC133	BY-C133	940323.4981	1261958.6781	2938.26	16+19.28	16.88 RT
BYC134	BY-C134	940661.8688	1262159.5886	2961.81	28+24.89	16.98 RT
BYC135	BY-C135	940961.6344	1262153.4412	2992.89	OUTSIDE PROJECT LIMITS	

BYC2 POINT	DESC.	NORTH	EAST	ELEVATION	Y6 STATION	OFFSET
BYC236	BY-C236	941232.5836	1260382.7315	2942.73	OUTSIDE PROJECT LIMITS	
BYC237	BY-C237	941784.5531	1260341.2732	2994.48	OUTSIDE PROJECT LIMITS	
BYC238	BY-C238	941818.2625	1260159.6193	3089.53	11+54.29	18.38 LT
BYC239	BY-C239	941992.2283	1260048.6838	3089.53	13+15.87	36.12 LT
BYC240	BY-C240	942281.2144	1260142.1275	3016.34	15+78.27	92.98 LT

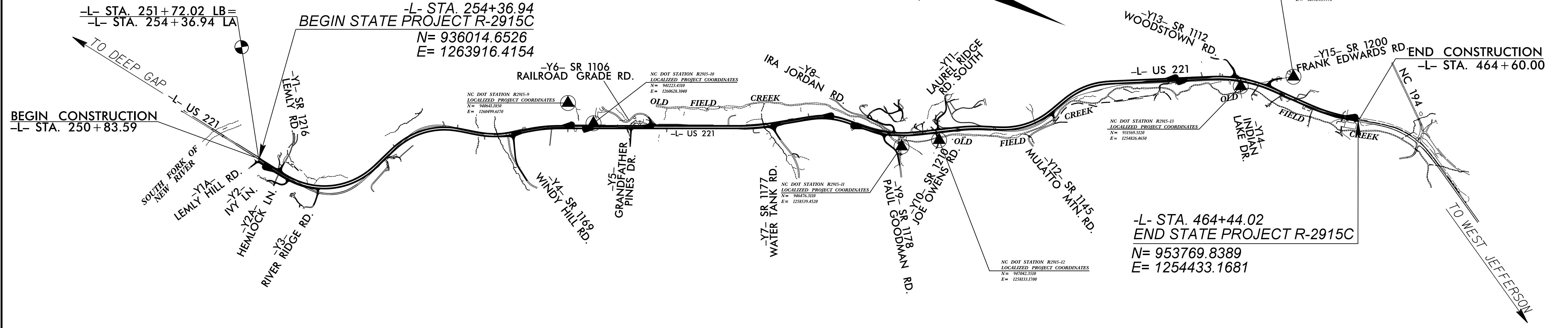

DATUM DESCRIPTION
 THE LOCALIZED COORDINATE SYSTEM DEVELOPED FOR THIS PROJECT IS BASED ON THE STATE PLANE COORDINATES ESTABLISHED BY NCDOT FOR MONUMENT "R2915-15"
 WITH NAD 83/CORS STATE PLANE GRID COORDINATES OF
 NORTHING: 954880.7810(ft) EASTING: 1254012.2870(ft)
 ELEVATION: 3097.5210(ft)
 THE AVERAGE COMBINED GRID FACTOR USED ON THIS PROJECT (GROUND TO GRID) IS: 0.99991292
 THE N.C. LAMBERT GRID BEARING AND LOCALIZED HORIZONTAL GROUND DISTANCE FROM "R2915-15" TO -L- STATION 254+36.94 IS
 S 27°41'53" E 21307.8051
 ALL LINEAR DIMENSIONS ARE LOCALIZED HORIZONTAL DISTANCES
 VERTICAL DATUM USED IS NAVD 88

NOTES:
 1. THE SITE CALIBRATION SHOWN IS BASED UPON A NETWORK TIED TO THE HARN (HIGH ACCURACY REFERENCE NETWORK) NAD 83/CORS ADJUSTMENT. THIS CALIBRATION WILL ALLOW THE END USER TO WORK WITHIN THE SAME COORDINATE SYSTEM WHEN USING RTK (REAL TIME KINEMATIC) GPS AND A LOCAL BASE STATION. IF ANOTHER SYSTEM SUCH AS VRS (VIRTUAL REFERENCE STATION) IS USED, ADDITIONAL FIELD TIES MAY BE NEEDED TO REDUCE POSSIBLE ERRORS, OR BIASES.
 2. THE CONTROL DATA FOR THIS PROJECT CAN BE FOUND ELECTRONICALLY BY SELECTING PROJECT CONTROL DATA AT:
[HTTPS://CONNECT.NCDOT.GOV/RESOURCES/LOCATION/](https://connect.ncdot.gov/resources/location/)
 THE FILES TO BE FOUND ARE AS FOLLOWS:
 R2915C_LS_GPSALIB.TXT
 R2915C_LS_WGS84.TXT
 R2915C_LS_LOCAL.TXT
 R2915C_LS_CONTROL.TXT
 THE WGS84 AND LOCAL FILES ARE COMMA DELIMITED AND CAN BE USED TO REPRODUCE THE SITE CALIBRATION FOR THE END USER'S GPS EQUIPMENT. IF FURTHER INFORMATION IS NEEDED, PLEASE CONTACT THE LOCATION AND SURVEYS UNIT.
 © INDICATES GEODETIC CONTROL MONUMENTS USED OR SET FOR HORIZONTAL PROJECT CONTROL BY THE NCDOT LOCATION AND SURVEYS UNIT.
 PROJECT CONTROL ESTABLISHED USING GLOBAL POSITIONING SYSTEM.
 SEE GPS CALIBRATION SHEET FOR HORIZONTAL AND VERTICAL COORDINATE VALUES.

NOTE: DRAWING NOT TO SCALE