

CONTRACT: C203805 TIP PROJECT: B-5360 & B-5546

STRUCTURES

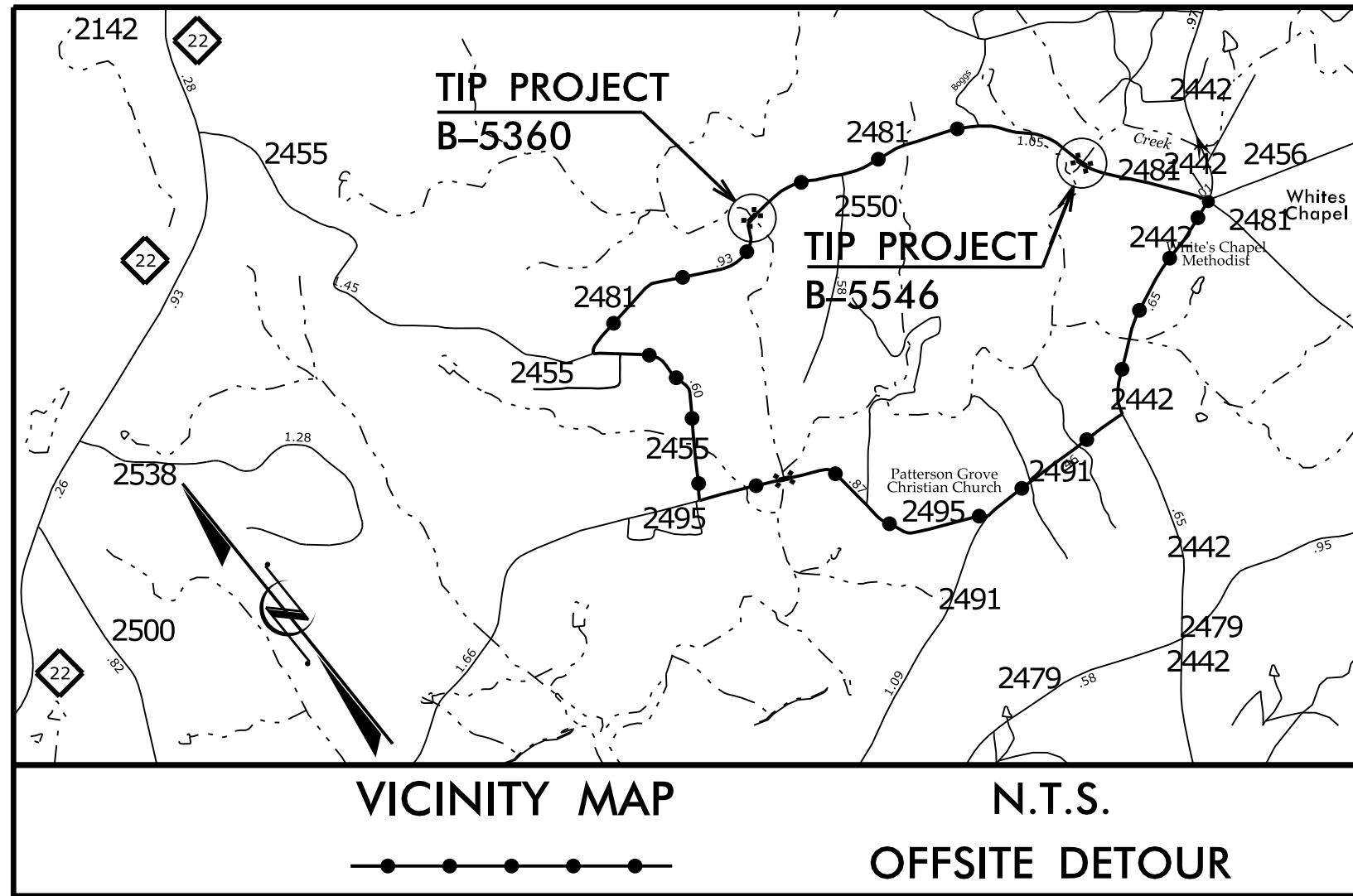

STATE OF NORTH CAROLINA
DIVISION OF HIGHWAYS

RANDOLPH COUNTY

STATE	STATE PROJECT REFERENCE NO.	SHEET NO.	TOTAL SHEETS
N.C.	B-5360 AND B-5546		
STATE PROJ. NO.	F.A. PROJ. NO.	DESCRIPTION	
46074.1.1	BRZ-2481(2)	P.E.	
46074.2.1		RW	
46074.2.2		UTILITIES	
46074.3.1		CONST.	
45538.1.1	BRZ-2481(1)	P.E.	
45538.2.1		RW AND UTIL.	
45538.3.1		CONST.	

**LOCATION: BRIDGE NO. 374 OVER SANDY CREEK ON SR 2481 (LOW BRIDGE RD.)
AND BRIDGE NO. 307 OVER MOUNT PLEASANT CREEK ON SR 2481 (LOW BRIDGE RD.)**
TYPE OF WORK: GRADING, DRAINAGE, PAVING AND STRUCTURES

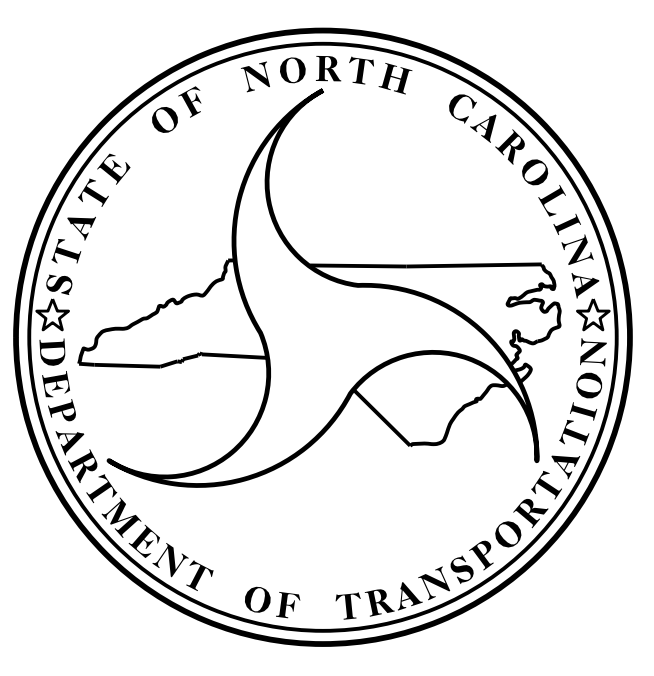
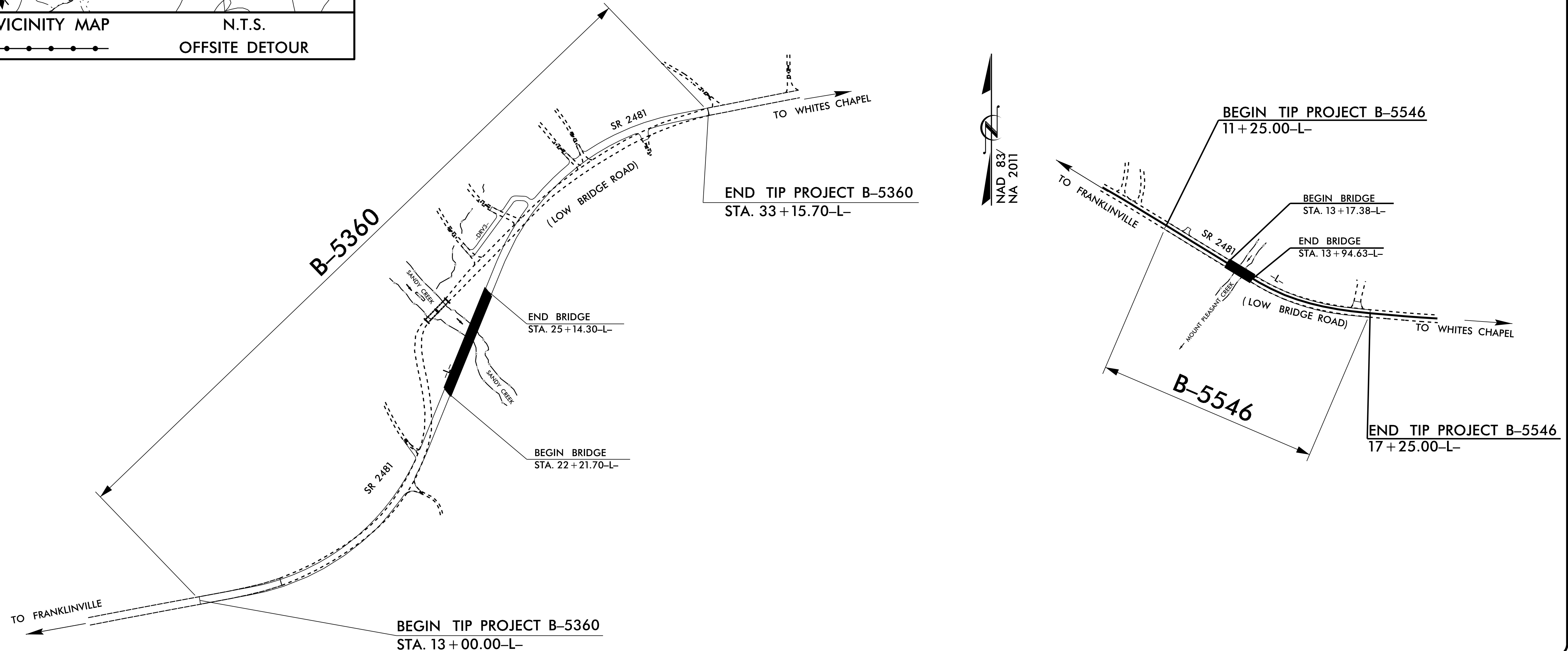

DESIGN DATA
 ADT (2014) = 400
 ADT (2040) = 700
 K = 13 %
 D = 60 %
 T = 9 % **
 V = 40 MPH
 ** (TTST 1 %, DUAL 8 %)
 FUNC CLASS=RURAL, LOCAL
 SUB REGIONAL TIER

PROJECT LENGTH
 LENGTH ROADWAY TIP PROJECT B-5360 = 0.327 MILES
 LENGTH STRUCTURE TIP PROJECT B-5360 = 0.055 MILES
 TOTAL LENGTH TIP PROJECT B-5360 = 0.382 MILES
 LENGTH ROADWAY TIP PROJECT B-5546 = 0.099 MILES
 LENGTH STRUCTURE TIP PROJECT B-5546 = 0.015 MILES
 TOTAL LENGTH TIP PROJECT B-5546 = 0.114 MILES

Prepared in the Office of:
DIVISION OF HIGHWAYS
 STRUCTURES MANAGEMENT UNIT
 1000 BIRCH RIDGE DR.
 RALEIGH, N.C. 27610

2012 STANDARD SPECIFICATIONS

LETTING DATE :
 OCTOBER 18, 2016

J.M. BAILEY, P.E.
 PROJECT ENGINEER
 G.W. DICKEY, PE
 PROJECT DESIGN ENGINEER
 E.E. MURRAY, P.E.
 PROJECT ENGINEER
 D.A. DAVENPORT, JR., PE
 PROJECT DESIGN ENGINEER