

STATE OF NORTH CAROLINA  
DIVISION OF HIGHWAYS

**UTILITIES BY OTHERS PLANS  
RANDOLPH COUNTY**

**LOCATION: BRIDGE NO 374 OVER SANDY CREEK  
ON SR 2481 (LOW BRIDGE RD.)**

**TYPE OF WORK: AERIAL & BURIED UTILITIES**

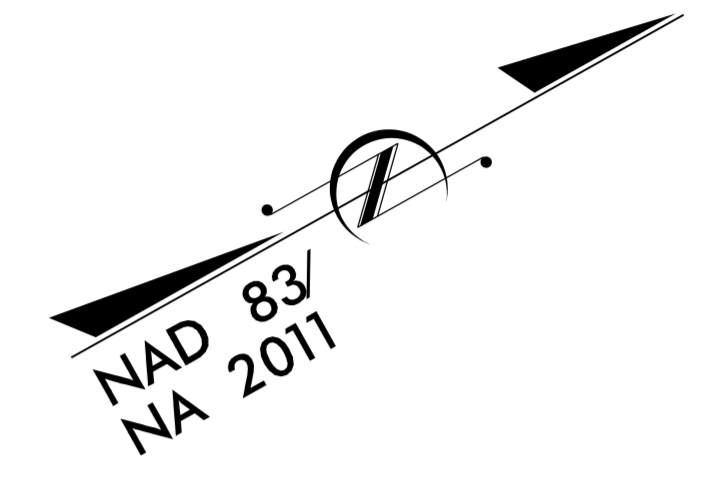

**TIP PROJECT: B-5360**

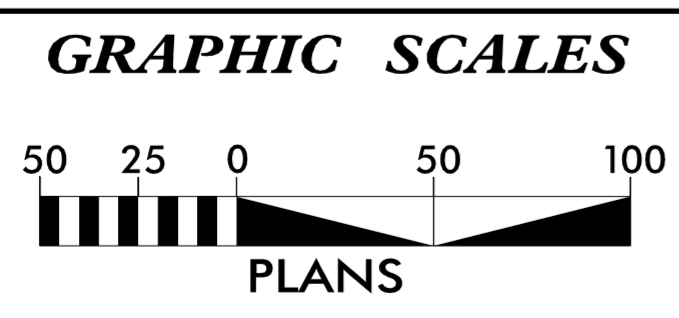
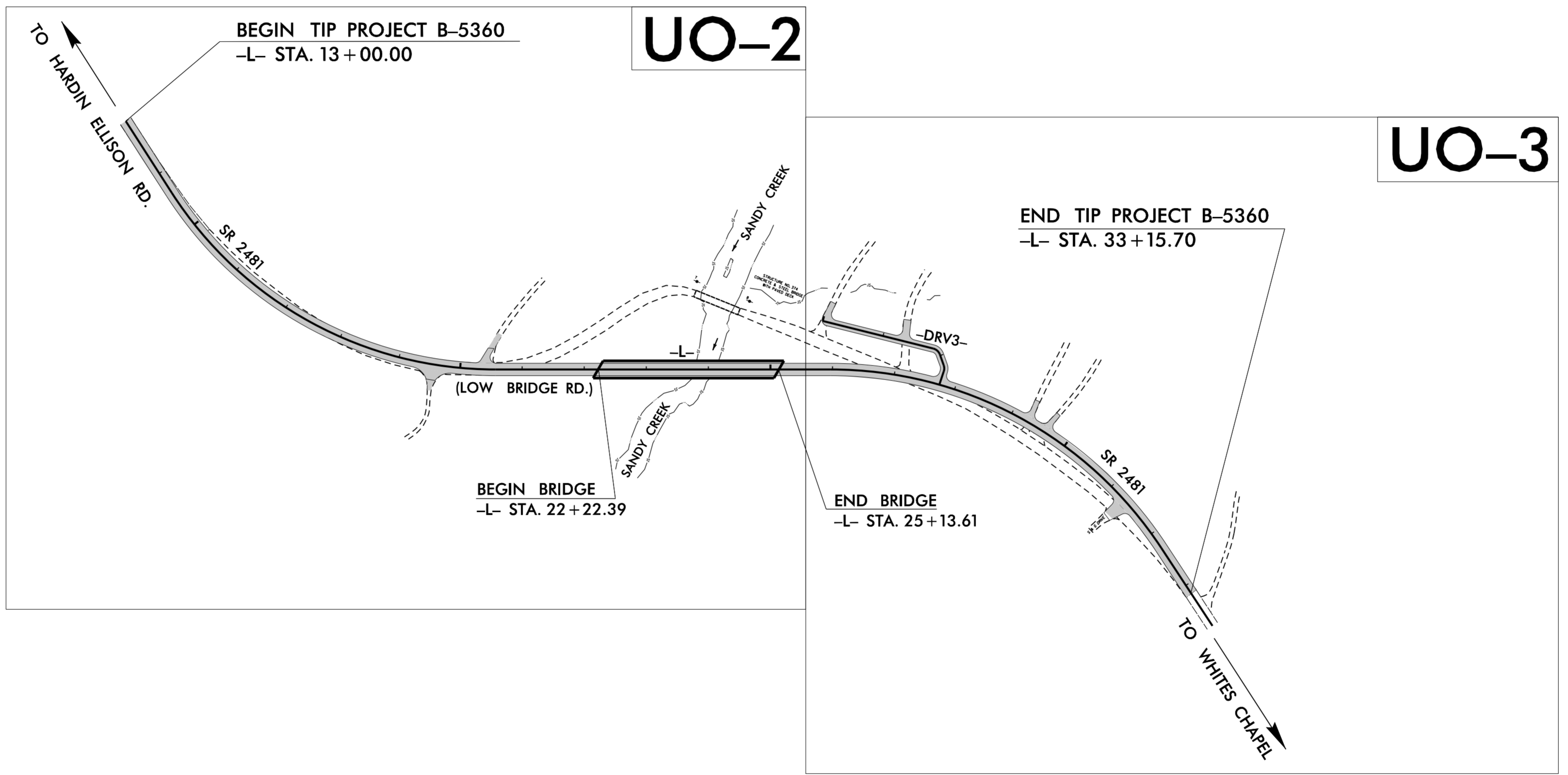
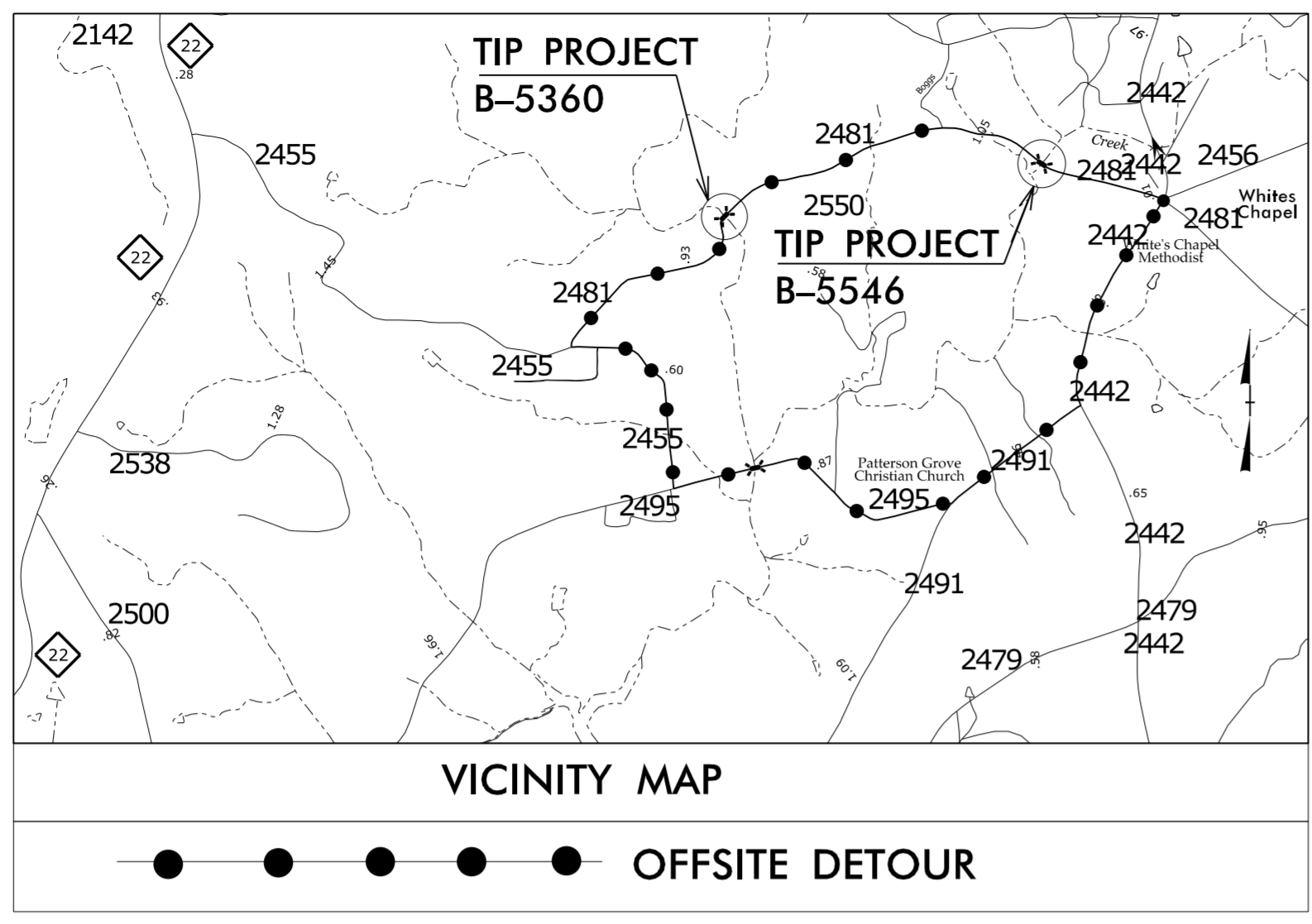

**INDEX OF SHEETS**

SHEET NO.	DESCRIPTION
UO-1	TITLE SHEET
UO-2 THRU UO-3	UTILITY BY OTHERS PLAN SHEETS

**UTILITY OWNERS ON PROJECT**

(A) RANDOLPH EMC - POWER  
(B) CENTURYLINK - TELEPHONE

**PLANS PREPARED BY:**

**CH ENGINEERING**

3220 GLEN ROYAL RD. RALEIGH, NC 27617  
TELE 919.788.0224 FAX 919.788.0232  
NC LICENSE #P-0189

**UTILITIES PROJECT ENGINEER**  
Mary Jo Lee, P.E.



PREPARED FOR:  
**DIVISION OF HIGHWAYS  
UTILITIES UNIT  
UTILITIES ENGINEERING**

1555 MAIL SERVICES CENTER  
RALEIGH NC 27699-1555  
PHONE (919) 707-6690  
FAX (919) 250-4151

**Roger Worthington, P.E.** UTILITIES SECTION ENGINEER  
**Donna Jackson, P.E.** UTILITIES SQUAD LEADER PROJECT ENGINEER  
**Jamshid Hafshejani** UTILITIES PROJECT DESIGNER