

**This electronic collection of documents is provided  
for the convenience of the user  
and is Not a Certified Document –**

**The documents contained herein were originally issued  
and sealed by the individuals whose names and license  
numbers appear on each page, on the dates appearing  
with their signature on that page.**

**This file or an individual page  
shall not be considered a certified document.**

**STATE OF NORTH CAROLINA  
DEPARTMENT OF TRANSPORTATION**

**PAVEMENT MARKING PLAN  
MACON COUNTY**

**LOCATION: BRIDGE NO.22 OVER LITTLE TENNESSEE  
RIVER ON US 441 BUSINESS**

**T.I.P.: B-5125**

**CONTRACT: C203667**

**ROADWAY STANDARD DRAWING**

THE FOLLOWING ROADWAY STANDARDS AS APPEAR IN "ROADWAY STANDARD DRAWINGS" - PROJECT SERVICES UNIT - N.C. DEPARTMENT OF TRANSPORTATION - RALEIGH, N.C., DATED JANUARY 2012 ARE APPLICABLE TO THIS PROJECT AND BY REFERENCE HEREBY ARE CONSIDERED A PART OF THESE PLANS:

STD. NO.	TITLE
1205.01	PAVEMENT MARKINGS - LINE TYPES AND OFFSETS
1205.02	PAVEMENT MARKINGS - TWO-LANE AND MULTILANE ROADWAYS
1205.04	PAVEMENT MARKINGS - INTERSECTIONS
1205.05	PAVEMENT MARKINGS - TURN LANES
1205.08	PAVEMENT MARKINGS - SYMBOLS AND WORD MESSAGES
1205.09	PAVEMENT MARKINGS - PAINTED ISLANDS
1205.12	PAVEMENT MARKINGS - BRIDGES
1253.01	RAISED PAVEMENT MARKERS - SNOWPLOWABLE
1261.01	GUARDRAIL AND BARRIER DELINEATORS - INSTALLATION SPACING
1261.02	GUARDRAIL AND BARRIER DELINEATORS - TYPES AND MOUNTING
1262.01	GUARDRAIL END DELINEATION

**GENERAL NOTES**

- THE FOLLOWING GENERAL NOTES APPLY AT ALL TIMES FOR THE DURATION OF THE CONSTRUCTION PROJECT, EXCEPT WHEN OTHERWISE NOTED IN THE PLAN, OR DIRECTED BY THE ENGINEER.
- A) INSTALL PAVEMENT MARKINGS AND PAVEMENT MARKERS ON THE FINAL SURFACE AS FOLLOWS:
- | ROAD NAME         | MARKING                                | MARKER       |
|-------------------|--|--------------|
| EAST MAIN ST      | POLYUREA W/ HIGHLY REFLECTIVE ELEMENTS | SNOWPLOWABLE |
| NORTHEAST MAIN ST | POLYUREA W/ HIGHLY REFLECTIVE ELEMENTS | SNOWPLOWABLE |
| BRIDGE            | POLYUREA W/ HIGHLY REFLECTIVE ELEMENTS | RAISED       |
- B) TIE PROPOSED PAVEMENT MARKING LINES TO EXISTING PAVEMENT MARKING LINES.
  - C) REMOVE/REPLACE ANY CONFLICTING/DAMAGED PAVEMENT MARKINGS AND MARKERS.
  - D) PASSING ZONES WILL BE DETERMINED IN THE FIELD AND MUST BE APPROVED BY THE ENGINEER.
  - E) STOP BAR LOCATION AT NON-SIGNALIZED INTERSECTIONS MAY BE ADJUSTED AS DIRECTED BY THE ENGINEER.
  - F) REMOVE ALL RESIDUE AND SURFACE LAITANCE BY ACCEPTABLE METHODS ON CONCRETE BRIDGE DECKS PRIOR TO PLACING POLYUREA PAVEMENT MARKING MATERIAL.
  - G) UNLESS OTHERWISE SPECIFIED, HEATED-IN-PLACE THERMOPLASTIC MAY BE USED IN LIEU OF EXTRUDED THERMOPLASTIC FOR STOP BARS, SYMBOLS, CHARACTERS AND DIAGONALS. IF HEATED-IN-PLACE IS USED, IT SHALL BE PAID FOR USING THE EXTRUDED THERMOPLASTIC PAY ITEM.
  - H) SEE ROADWAY PLANS FOR ALTERNATE CURB RAMP DESIGNS WHEN INDICATED ON PAVEMENT MARKING DETAIL SHEETS.

**PAVEMENT  
MARKING SCHEDULE**

SYMBOL	DESCRIPTION	
	FINAL	
	THERMOPLASTIC(8", 90 MILS)	THERMOPLASTICPAVEMENT MARKING SYMBOLS (90 MILS)
T0	WHITE DIAGONAL	UA LEFT TURN ARROW
	THERMOPLASTIC(24", 120 MILS)	UB RIGHT TURN ARROW
T2	WHITE STOPBAR	UC STRAIGHT ARROW
	POLYUREA(4")	UD STRAIGHT LEFT ARROW
		UE STRAIGHT RIGHT ARROW
VA	WHITE EDGELINE	MARKERS
VB	YELLOW EDGELINE	
VC	10 FT. WHITE SKIP	SNOWPLOWABLE PAVEMENT MARKERS
VD	3 FT. - 9 FT/SP WHITE	ME YELLOW & YELLOW
VE	WHITE SOLID LANE LINE	RAISED PAVEMENT MARKERS
VI	YELLOW DOUBLE CENTER	
V8	2 FT. - 6 FT/SP WHITE	MA YELLOW & YELLOW
MINISKIP		

**INDEX**

SHEET NO.	DESCRIPTION
PMP-1	PAVEMENT MARKING PLAN TITLE AND SCHEDULE SHEET
PMP-2	PAVEMENT MARKING DETAIL

PLAN PREPARED BY: N.C.D.O.T. SIGNING AND DELINEATION UNIT

Kelvin Jordan SIGNING & DELINEATION REGIONAL ENGINEER  
J.Navarrete SIGNING & DELINEATION PROJECT DESIGN ENGINEER

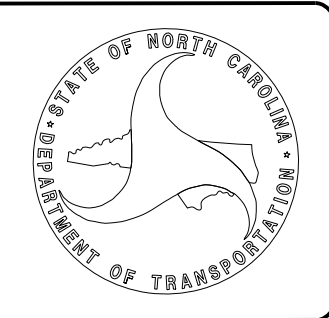

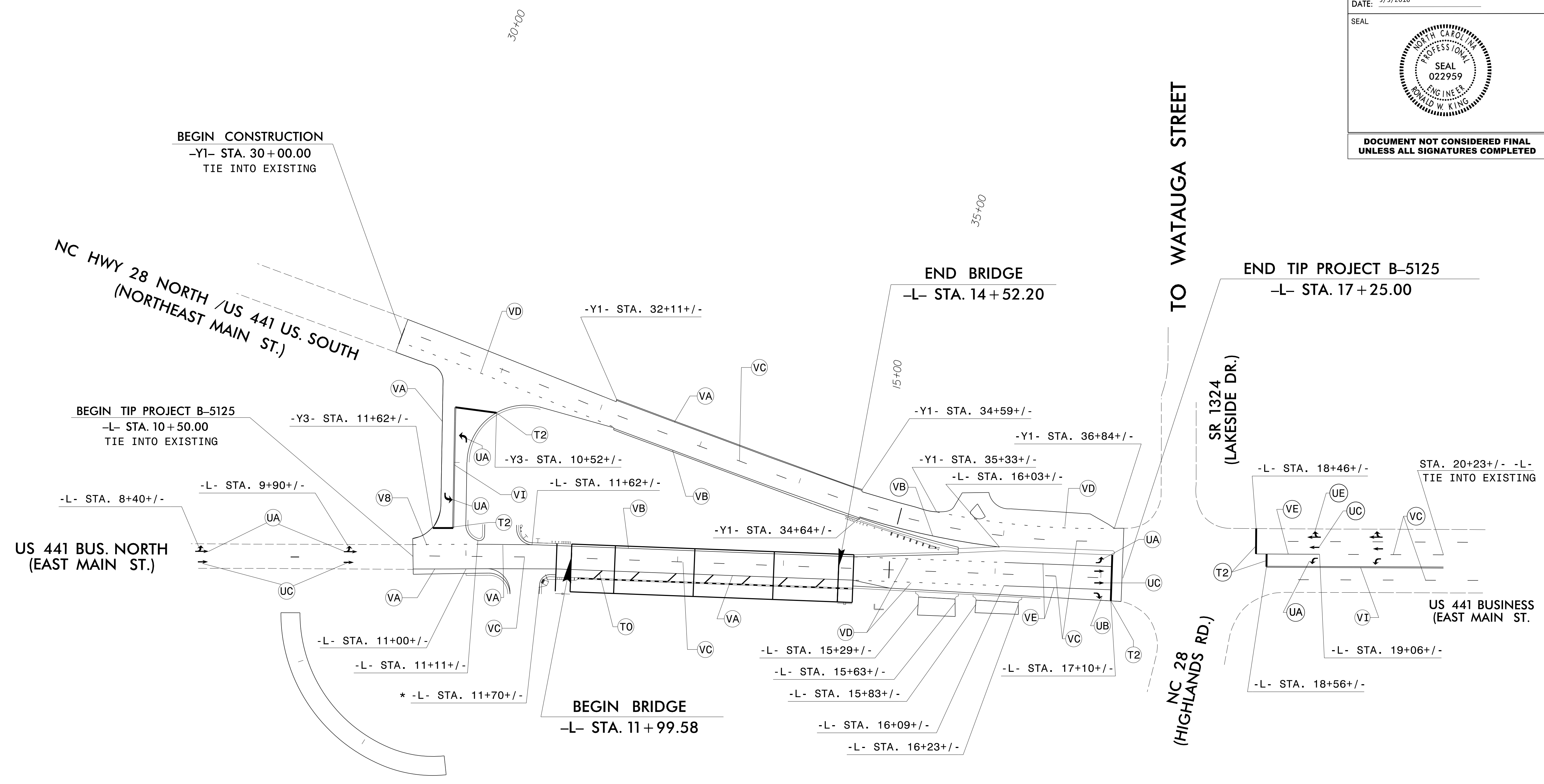

\*TYPE 1 CURB RAMP

**PAVEMENT MARKING DETAIL**

5/3/2016  
 P:\Projects-B\B5125\Traffic\Signing\CADD\Signing Layout Plans\B-5125\_Sgn\_BPMP.dgn  
 User: jnn@carri