

PLAN SHOWING CONCRETE WEARING SURFACE REINFORCING STEEL

NOTES

PLACEMENT OF THE CONCRETE WEARING SURFACE SHALL OCCUR AFTER CASTING THE CONCRETE RAIL AND PARAPETS.
 THE COST OF THE #3 & #4 BARS CAST WITH THE CONCRETE WEARING SURFACE SHALL BE INCLUDED IN THE UNIT PRICE BID FOR CONCRETE WEARING SURFACE.
 FOR CONCRETE WEARING SURFACE, SEE SPECIAL PROVISIONS.
 A GROOVED CONTRACTION JOINT, 1/2" IN DEPTH, SHALL BE TOOLED IN THE TOP OF THE CONCRETE WEARING SURFACE AT THE END BENTS AND BENTS IN ACCORDANCE WITH ARTICLE 825-10(B) OF THE STANDARD SPECIFICATIONS.

GROOVING BRIDGE FLOORS	
CONCRETE WEARING SURFACE	9465 SQ. FT.
APPROACH SLABS	1050 SQ. FT.
TOTALS	10515 SQ. FT.

BILL OF MATERIAL FOR CONCRETE WEARING SURFACE						
BAR	NO.	SIZE	TYPE	LENGTH	WEIGHT	
*A1	1,000	#3	STR	16'-5"	6,173	
*A2	500	#3	STR	12'-1"	2,272	
*R1	792	#3	STR	29'-2"	8,686	
*R2	258	#4	STR	20'-0"	3,447	
* EPOXY COATED REINFORCING STEEL					LBS.	20,578
CONCRETE WEARING SURFACE					SQ. FT.	11,017

SPLICE LENGTH CHART	
BAR SIZE	EPOXY COATED
#3	1'-6"

PROJECT NO. B-5125
MACON COUNTY
 STATION: 13+25.89 -L-

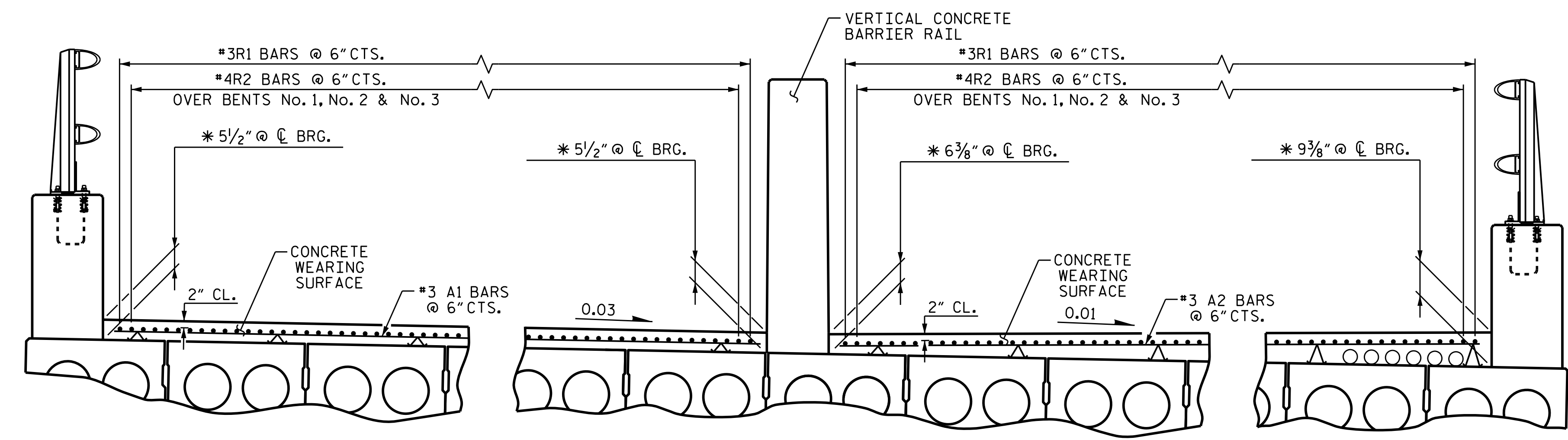

REINFORCING FOR CONCRETE WEARING SURFACE
 (PARTIAL TYPICAL SECTION)
 * THE MAXIMUM CONCRETE WEARING SURFACE IS SHOWN. FOR CONCRETE WEARING SURFACE THICKNESS, SEE "GUTTERLINE CONCRETE THICKNESS & RAIL HEIGHT" CHART.



STATE OF NORTH CAROLINA
 DEPARTMENT OF TRANSPORTATION
 RALEIGH

CONCRETE WEARING SURFACE

DRAWN BY: D. HODGE DATE: 12/15
 CHECKED BY: M.G. CHEEK DATE: 5/5/16
 DESIGN ENGINEER OF RECORD: W.J. HARRIS DATE: 5/16

REVISIONS						SHEET NO.
NO.	BY:	DATE:	NO.	BY:	DATE:	TOTAL SHEETS
1			3			S-15
2			4			43

DOCUMENT NOT CONSIDERED FINAL UNLESS ALL SIGNATURES COMPLETED