

UTILITY BY OTHERS

NOTE:
ALL PROPOSED UTILITY WORK SHOWN ON THIS SHEET WILL BE DONE BY OTHERS. NO PAYMENT WILL BE MADE TO THE CONTRACTOR FOR PROPOSED UTILITY WORK SHOWN ON THIS SHEET.

PROPERTY OWNERS		
② J.H. DUNCAN OIL, INC. DB A-23 PG 343	④ ABDUL M. WALIANY, ET. UX. DB G-14 PG 163	⑧ MACON COUNTY DB A-27 PG 17H
③ MLC, INCORPORATED DB T-24 PG 867	⑤ "NOW OR FORMERLY" TOWN OF FRANKLIN DB K-8 PG 306	ROBERT P. REVIS, ET. UX. DB T-29 PG 2040
MACON COUNTY DB Y-26 PG 1219 PLAT CARD #38H	DUKE ENERGY CORPORATION DB X-26 PG 2125	JAMES H. PARRISH, ET. UX. DB L-14 PG 119

TELEPHONE
VERIZON
ATTN: TINA RUTHERFORD
84 ALLEN STREET
SYLVA, N.C. 28779
828.631.4058

FIBER OPTIC
BALSAM WEST FIBERNET
ATTN: ED TERRY
20 COLONIAL SQUARE
SYLVA, N.C. 28779
828.586.6141

POWER
DUKE ENERGY
ATTN: ROGER BISHOP
301 NPL LOOP
FRANKLIN, N.C. 28734
828.586.6393

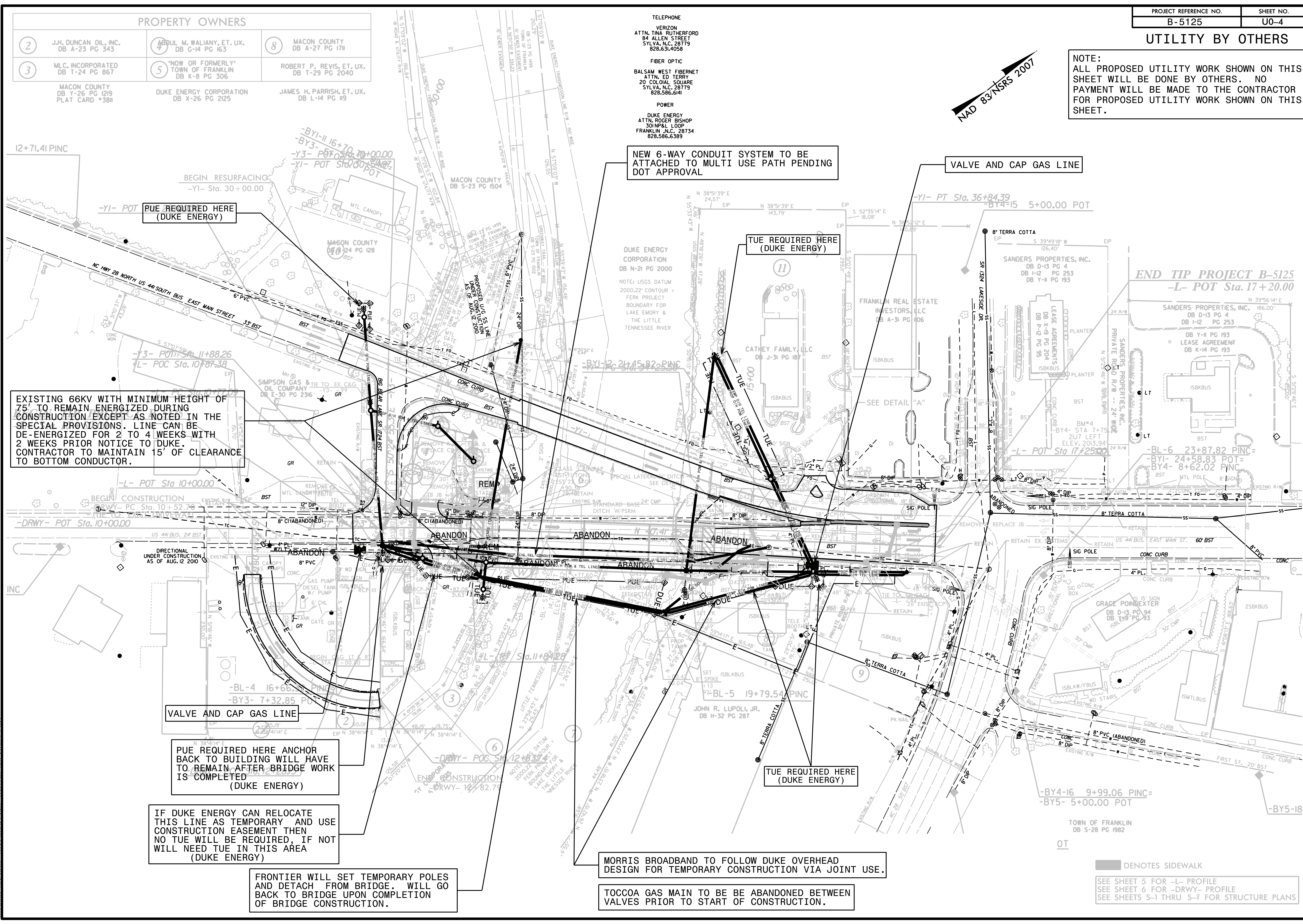
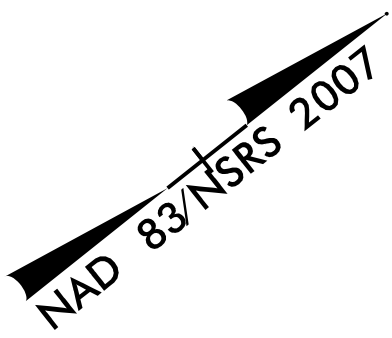

NEW 6-WAY CONDUIT SYSTEM TO BE ATTACHED TO MULTI USE PATH PENDING DOT APPROVAL

VALVE AND CAP GAS LINE

PUE REQUIRED HERE (DUKE ENERGY)

TUE REQUIRED HERE (DUKE ENERGY)

EXISTING 66KV WITH MINIMUM HEIGHT OF 75' TO REMAIN ENERGIZED DURING CONSTRUCTION EXCEPT AS NOTED IN THE SPECIAL PROVISIONS. LINE CAN BE DE-ENERGIZED FOR 2 TO 4 WEEKS WITH 2 WEEKS PRIOR NOTICE TO DUKE. CONTRACTOR TO MAINTAIN 15' OF CLEARANCE TO BOTTOM CONDUCTOR.

VALVE AND CAP GAS LINE

PUE REQUIRED HERE ANCHOR BACK TO BUILDING WILL HAVE TO REMAIN AFTER BRIDGE WORK IS COMPLETED (DUKE ENERGY)

IF DUKE ENERGY CAN RELOCATE THIS LINE AS TEMPORARY AND USE CONSTRUCTION EASEMENT THEN NO TUE WILL BE REQUIRED, IF NOT WILL NEED TUE IN THIS AREA (DUKE ENERGY)

FRONTIER WILL SET TEMPORARY POLES AND DETACH FROM BRIDGE. WILL GO BACK TO BRIDGE UPON COMPLETION OF BRIDGE CONSTRUCTION.

MORRIS BROADBAND TO FOLLOW DUKE OVERHEAD DESIGN FOR TEMPORARY CONSTRUCTION VIA JOINT USE.

TOCCOA GAS MAIN TO BE ABANDONED BETWEEN VALVES PRIOR TO START OF CONSTRUCTION.

■ DENOTES SIDEWALK

SEE SHEET 5 FOR -L- PROFILE
SEE SHEET 6 FOR -DRWY- PROFILE
SEE SHEETS S-1 THRU S-2 FOR STRUCTURE PLANS

8/17/09
 13:20 PM
 250.004_B5125-ut_rdy4_u004_gsh.dgn
 Joshua, Rector - Division: 2007 - Utility Services - Em