

09\_08/09

PROJECT: R-5769

CONTRACT:

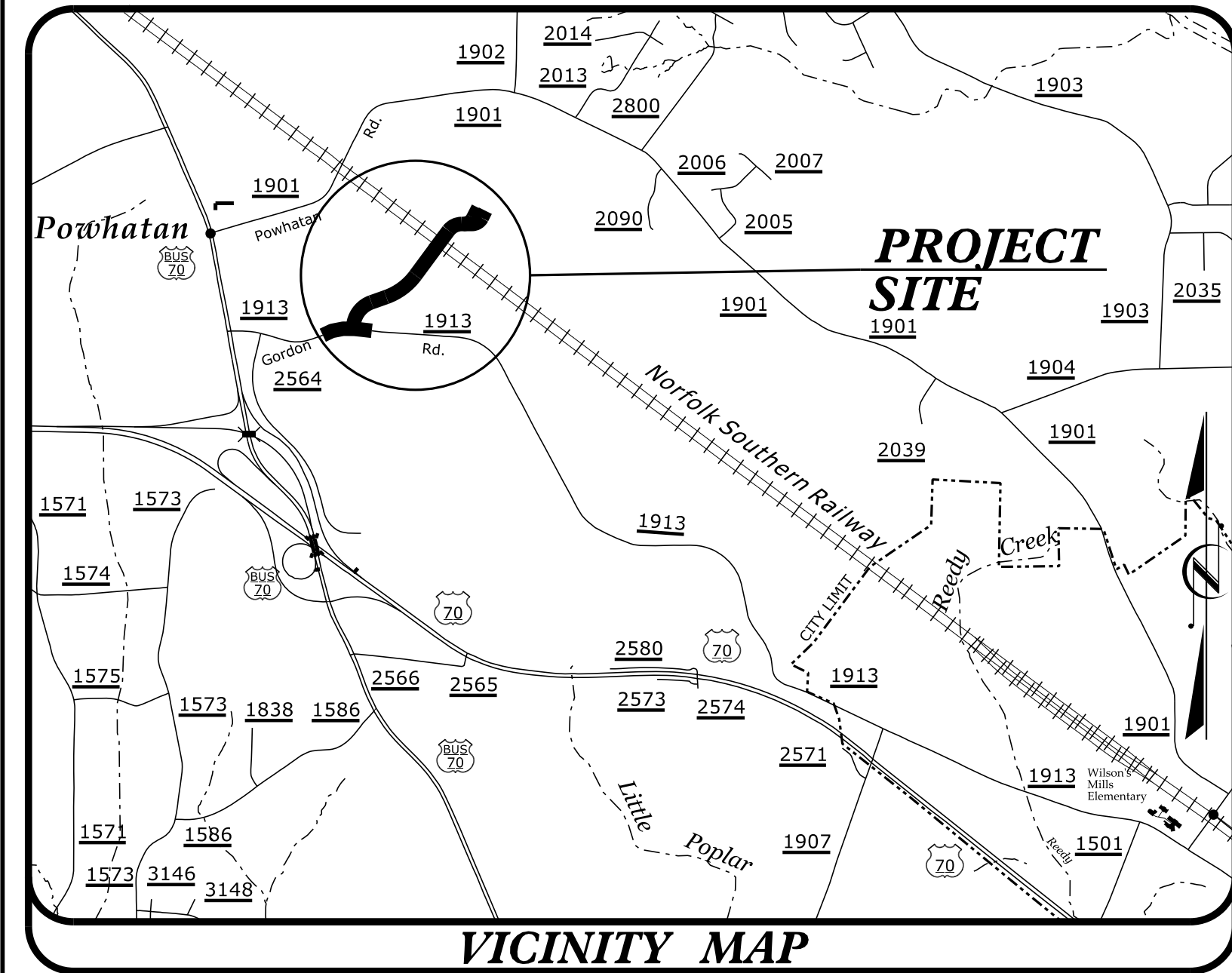

VICINITY MAP

STATE OF NORTH CAROLINA  
DIVISION OF HIGHWAYS  
**JOHNSTON COUNTY**

LOCATION: NOVO NORDISK ACCESS ROAD FROM SR 1913 (GORDON RD.) TO PROPOSED NOVO NORDISK SITE

TYPE OF WORK: GRADING, DRAINAGE, PAVING & STRUCTURE

END NCDOT PROJECT R-5769  
-L- STA. 43 + 57.04

-L2- POT Sta. 11 + 40.00  
=-L- POT STA. 42 + 59.25

END CONSTRUCTION  
-L1- POC STA. 15 + 07.87

-L2- POT Sta. 10 + 00.00  
=-L1- POT STA. 14 + 07.33

BEGIN CONSTRUCTION  
-L1- POC STA. 10 + 00.00

END BRIDGE  
STA. 33 + 75.48

-L- STA. 33 + 26.23  
= -RR1- STA. 15 + 27.86

END CONSTRUCTION  
-YIREV- POC STA. 23 + 17.31

BEGIN NCDOT PROJECT R-5769  
-L- POT STA. 10 + 00.00  
=-YIREV- POC STA. 18 + 34.66

BEGIN BRIDGE  
STA. 32 + 61.98

BEGIN CONSTRUCTION  
-YIREV- POC STA. 10 + 50.00

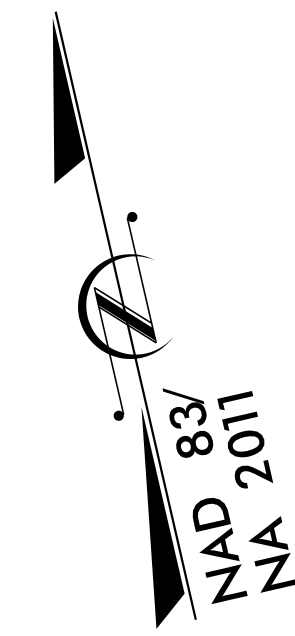

STRUCTURE

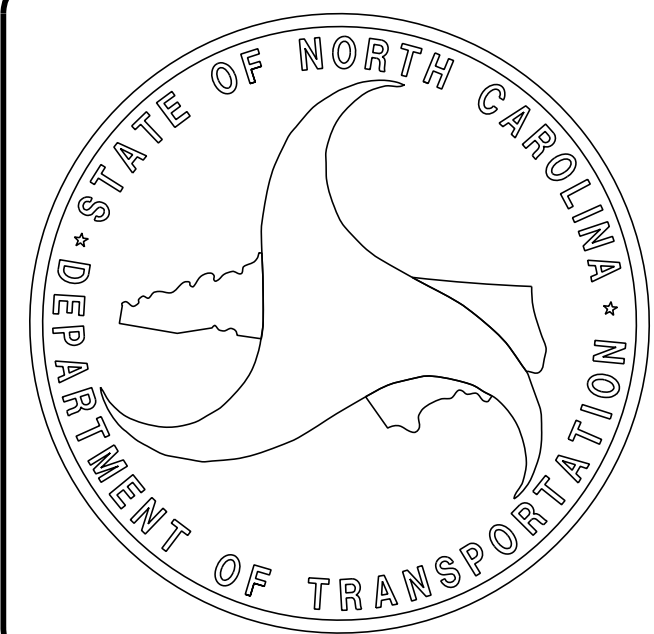

DESIGN DATA

ADT 2040 = 700

T = 4 % \*

V = 40 MPH

\* (TTST = 2% + DUAL = 2%)

FUNC CLASS =

RURAL LOCAL

SUB REGIONAL TIER

PROJECT LENGTH

LENGTH ROADWAY PROJECT R-5769 = 0.615 MILES

LENGTH STRUCTURE PROJECT R-5769 = 0.021 MILES

TOTAL LENGTH PROJECT R-5769 = 0.636 MILES

Prepared For:  
**DIVISION OF HIGHWAYS**  
STRUCTURES MANAGEMENT UNIT  
1000 BIRCH RIDGE DR.  
RALEIGH, N.C. 27610

2012 STANDARD SPECIFICATIONS

LETTING DATE :  
NOVEMBER 15, 2016

**EDWARD G. WETHERILL, PE**  
PROJECT ENGINEER

**GREG S. PURVIS, PE**  
PROJECT DESIGN ENGINEER

DOCUMENT NOT CONSIDERED FINAL UNLESS ALL SIGNATURES COMPLETED

STATE	STATE PROJECT REFERENCE NO.	SHEET NO.	TOTAL SHEETS
N.C.	R-5769		
STATE PROJ. NO.	F.A. PROJ. NO.	DESCRIPTION	
46448.1.1		PE, UTIL., RW CONST.	
		1223 Jones Franklin Rd. Raleigh, N.C. 27606 License No. F-03777 Bus: 919 851 8077 Fax: 919 851 8107	
TRANSPORTATION PLANNING/DESIGN - BRIDGE/STRUCTURE DESIGN CIVIL/SITE DESIGN - GIS/GPS - CONSTRUCTION OBSERVATION			

8/16/2016 10:20:10 AM PA:2016\R-5769\Structures\DCNR\5769\_SD\_STR1\_TITLESHEET.dgn