

**This electronic collection of documents is provided  
for the convenience of the user  
and is Not a Certified Document –**

**The documents contained herein were originally issued  
and sealed by the individuals whose names and license  
numbers appear on each page, on the dates appearing  
with their signature on that page.**

**This file or an individual page  
shall not be considered a certified document.**

STATE OF NORTH CAROLINA  
DIVISION OF HIGHWAYS

**TRANSPORTATION MANAGEMENT PLAN**

**AVERY COUNTY**

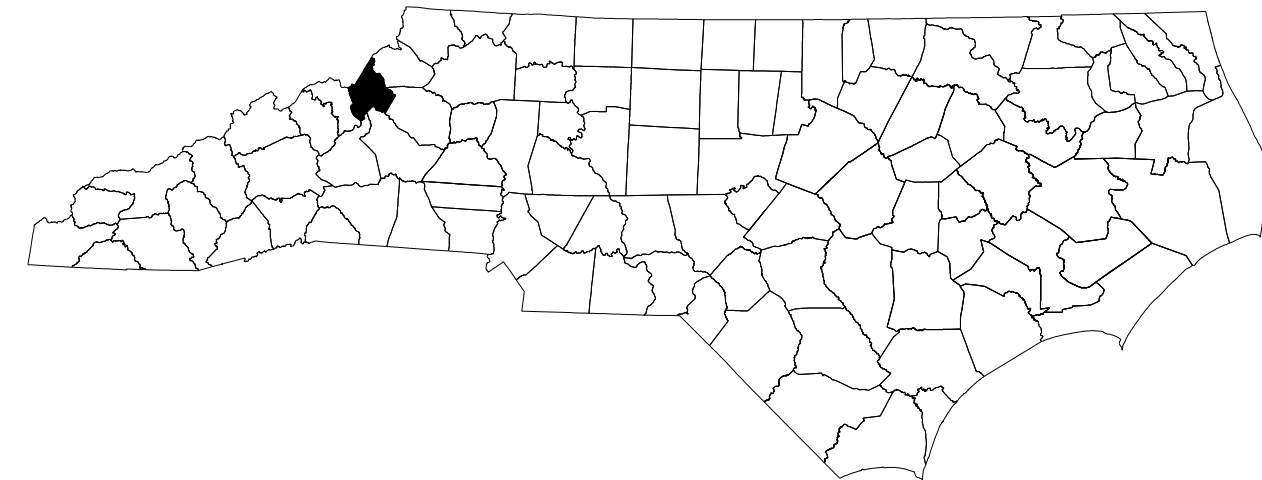

LOCATION: REPLACE BRIDGE NO.141 ON SR 1114 OVER FALL BRANCH

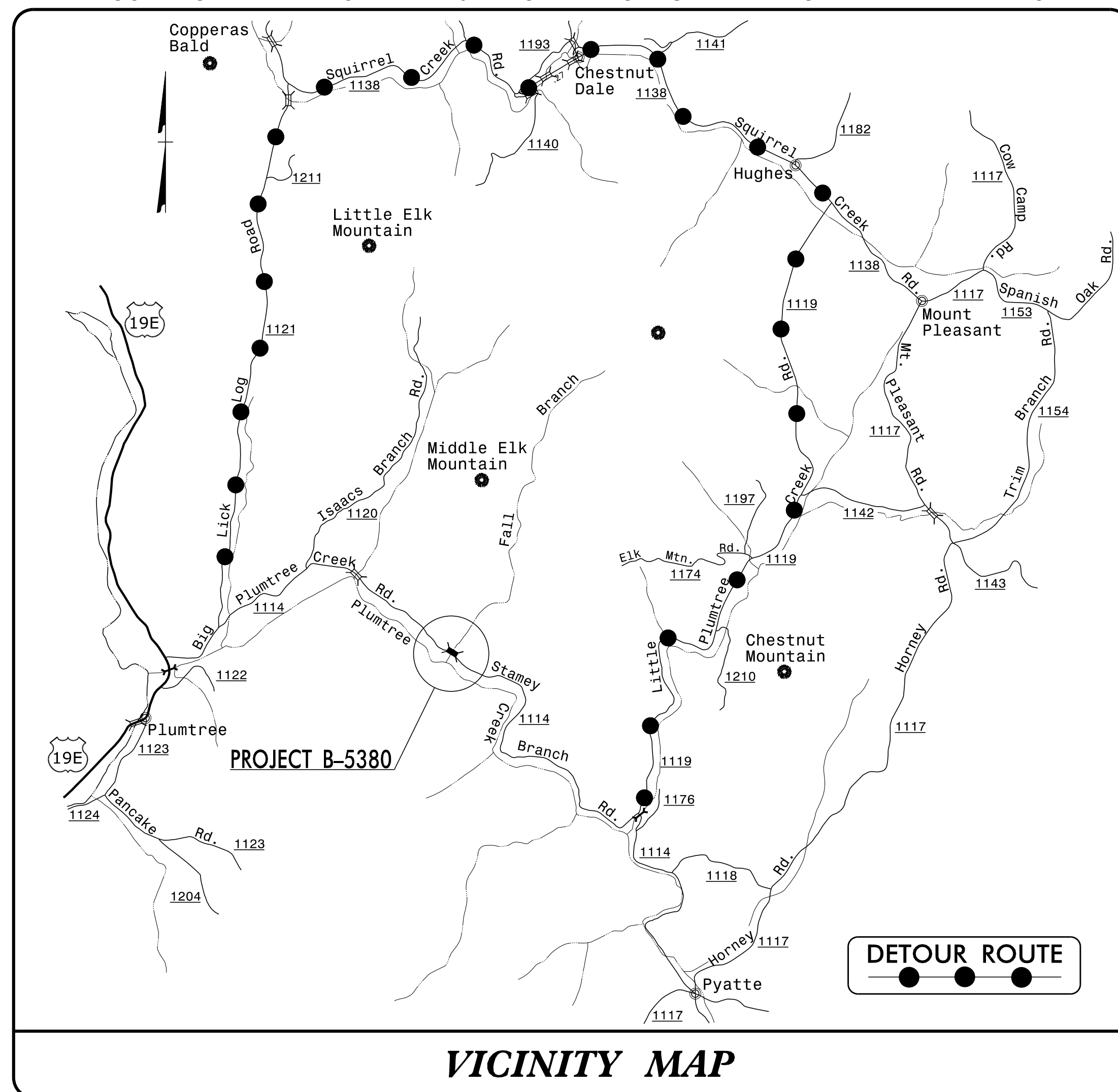

**VICINITY MAP**

**INDEX OF SHEETS**

SHEET NO.	TITLE
TMP-1	TITLE SHEET, AND INDEX OF SHEETS
TMP-1A	LIST OF APPLICABLE ROADWAY STANDARD DRAWINGS, LEGEND, AND TEMPORARY PAVEMENT MARKINGS
TMP-1B	TRANSPORTATION OPERATIONS PLAN: (TRANSPORTATION OPERATIONS AND GENERAL NOTES)
TMP-2	SPECIAL SIGN DESIGN - BIG PLUMTREE CREEK ROAD
TMP-3	TEMPORARY TRAFFIC CONTROL PHASING AND OFF-SITE DETOUR - BIG PLUMTREE CREEK ROAD - SR 1114

SHEET NO.  
TMP-1

**B-5380**

**TIP PROJECT:**

DOCUMENT NOT CONSIDERED FINAL  
UNLESS ALL SIGNATURES COMPLETED

APPROVED: *Lori D. Stouchko*

DATE: 6/28/2016

SEAL

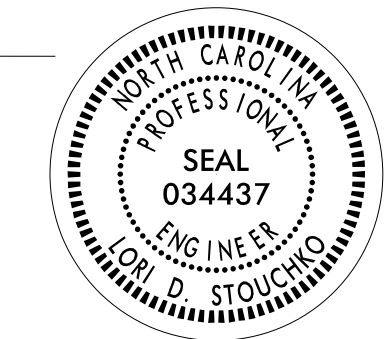

**N.C.D.O.T. WORK ZONE TRAFFIC CONTROL**  
1561 MAIL SERVICE CENTER (MSC) RALEIGH, NC 27699-1561  
750 N. GREENFIELD PARKWAY, GARNER, NC 27529 (DELIVERY)  
PHONE: (919) 773-2800 FAX: (919) 771-2745

J. S. BOURNE, P.E. STATE TRAFFIC MANAGEMENT ENGINEER  
TRAFFIC CONTROL PROJECT ENGINEER

L. D. STOUCHKO, P.E. TRAFFIC CONTROL PROJECT DESIGN ENGINEER

S. B. COATS TRAFFIC CONTROL DESIGN ENGINEER

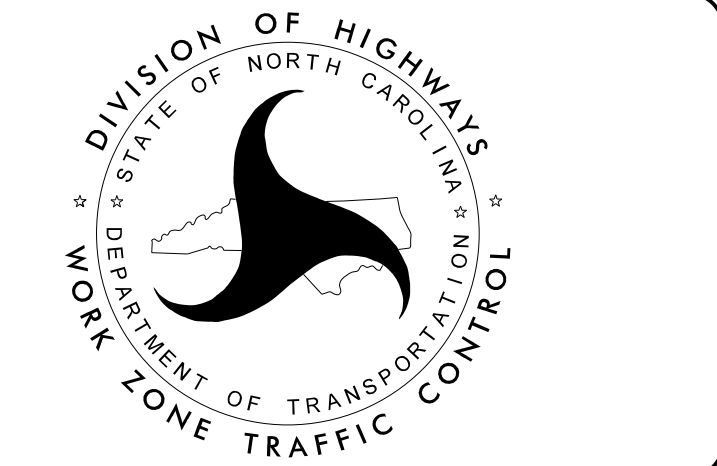

6/28/2016  
p:\tip\projects-b\5380\trafficcontrol\top\B5380\_TC\_TMP01.dgn  
User:scodts

# ROADWAY STANDARD DRAWINGS

THE FOLLOWING ROADWAY STANDARDS AS SHOWN IN "ROADWAY STANDARD DRAWINGS" - PROJECT SERVICES UNIT - N.C. DEPARTMENT OF TRANSPORTATION - RALEIGH, N.C., DATED JANUARY 2012 ARE APPLICABLE TO THIS PROJECT AND BY REFERENCE HEREBY ARE CONSIDERED A PART OF THESE PLANS:

STD. NO.	TITLE
1101.01	WORK ZONE ADVANCE WARNING SIGNS
1101.02	TEMPORARY LANE CLOSURES
1101.03	TEMPORARY ROAD CLOSURES
1101.05	WORK ZONE VEHICLE ACCESSES
1101.11	TRAFFIC CONTROL DESIGN TABLES
1110.01	STATIONARY WORK ZONE SIGNS
1110.02	PORTABLE WORK ZONE SIGNS
1130.01	DRUM
1135.01	CONES
1145.01	BARRICADES
1150.01	FLAGGING DEVICES

# LEGEND

## GENERAL

- DIRECTION OF TRAFFIC FLOW
- DIRECTION OF PEDESTRIAN TRAFFIC FLOW
- EXIST. PVMT.
- NORTH ARROW
- PROPOSED PVMT.
- TEMP. SHORING (LOCATION PURPOSES ONLY)

WORK AREA

REMOVAL

USER DEFINED (IF NEEDED)

USER DEFINED (IF NEEDED)

## SIGNALS

- EXISTING
- PROPOSED
- TEMPORARY

## PAVEMENT MARKINGS

- EXISTING LINES
- TEMPORARY LINES

## TRAFFIC CONTROL DEVICES

- BARRICADE (TYPE III)
- CONE
- DRUM
- SKINNY DRUM
- TUBULAR MARKER
- TEMPORARY CRASH CUSHION
- FLASHING ARROW BOARD
- FLAGGER
- LAW ENFORCEMENT
- TRUCK MOUNTED ATTENUATOR (TMA)
- CHANGEABLE MESSAGE SIGN

## TEMPORARY SIGNING

- PORTABLE SIGN
- STATIONARY SIGN
- STATIONARY OR PORTABLE SIGN

## PAVEMENT MARKERS

- CRYSTAL/CRYSTAL
- CRYSTAL/RED
- YELLOW/YELLOW

## PAVEMENT MARKING SYMBOLS

- PAVEMENT MARKING SYMBOLS

TEMPORARY PAVEMENT MARKING  
N/A

6/28/2016  
ps\jpb\projects\b5380\trafficcontrol\tcp\b5380\_TC\_TMP01A.dgn  
User:scodts

APPROVED: <i>Lori D. Stouchko</i> <small>902280189181462</small> DATE: 6/28/2016 		ROADWAY STANDARD DRAWINGS & LEGEND
<b>DOCUMENT NOT CONSIDERED FINAL UNLESS ALL SIGNATURES COMPLETED</b>		

## TRANSPORTATION OPERATIONS

### CONSTRUCTION

REMOVE AND REPLACE EXISTING STRUCTURE AND ROADWAY APPROACHES ALONG EXISTING ROADWAY ALIGNMENT AS SHOWN IN THE CONSTRUCTION PLANS.

### TMP DESIGN PARAMETERS

TRAFFIC WILL BE DETOURED OFF-SITE DURING THE CONSTRUCTION PERIOD.

THE OFF-SITE DETOUR WILL INCLUDE LICK LOG ROAD (SR 1121), SQUIRREL CREEK ROAD (SR 1138), AND LITTLE PLUMTREE CREEK ROAD (SR 1119).

## GENERAL NOTES

CHANGES MAY BE REQUIRED WHEN PHYSICAL DIMENSIONS IN THE DETAIL DRAWINGS, STANDARD DETAILS, AND ROADWAY DETAILS ARE NOT ATTAINABLE TO MEET FIELD CONDITIONS OR RESULT IN DUPLICATE OR UNDESIRE OVERLAPPING OF DEVICES. MODIFICATION MAY INCLUDE: MOVING, SUPPLEMENTING, COVERING, OR REMOVAL OF DEVICES AS DIRECTED BY THE ENGINEER.

THE FOLLOWING GENERAL NOTES APPLY AT ALL TIMES FOR THE DURATION OF THE CONSTRUCTION PROJECT EXCEPT WHEN OTHERWISE NOTED IN THE PLAN OR DIRECTED BY THE ENGINEER.

#### TRAFFIC PATTERN ALTERATIONS

A) NOTIFY THE ENGINEER TWENTY ONE (21) CALENDAR DAYS PRIOR TO ANY TRAFFIC PATTERN ALTERATION.

#### SIGNING

B) PROVIDE SIGNING AND DEVICES REQUIRED TO CLOSE THE ROAD ACCORDING TO THE ROADWAY STANDARD DRAWINGS AND TRAFFIC CONTROL PLANS.

PROVIDE SIGNING REQUIRED FOR THE OFF-SITE DETOUR ROUTE AS SHOWN IN THE TRAFFIC CONTROL PLANS.

C) COVER OR REMOVE ALL SIGNS AND DEVICES REQUIRED TO CLOSE THE ROAD WHEN ROAD CLOSURE IS NOT IN OPERATION.

COVER OR REMOVE ALL SIGNS REQUIRED FOR THE OFF-SITE DETOUR WHEN THE DETOUR IS NOT IN OPERATION.

D) ENSURE ALL NECESSARY SIGNING IS IN PLACE PRIOR TO ALTERING ANY TRAFFIC PATTERN.

#### TRAFFIC CONTROL DEVICES



E) PLACE TYPE III BARRICADES, WITH "ROAD CLOSED" SIGN R11-2 ATTACHED, OF SUFFICIENT LENGTH TO CLOSE ENTIRE ROADWAY.

#### PAVEMENT MARKINGS AND MARKERS

F) INSTALL PAVEMENT MARKINGS AND PAVEMENT MARKERS ON THE FINAL SURFACE AS SHOWN IN FINAL PAVEMENT MARKING PLAN.

G) TIE PROPOSED PAVEMENT MARKING LINES TO EXISTING PAVEMENT MARKING LINES.

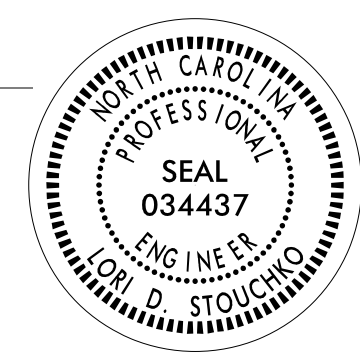
6/28/2016  
p:\tjpr\projects-b\5380\traffic\trafficcontrol\tcp\B5380\_TC\_TMP01B.dgn  
User:scodts

APPROVED: <i>Lori D. Stoucho</i> <small>902CB1B918149C...</small> DATE: 6/28/2016			<h1 style="margin: 0;">TRANSPORTATION OPERATIONS PLAN</h1>
<b>DOCUMENT NOT CONSIDERED FINAL UNLESS ALL SIGNATURES COMPLETED</b>			



**\*\* SEE RSD 1101.03, SHEET 1 OF 9, FOR ADDITIONAL WORK ZONE SIGNS AND LOCATIONS**

# TEMPORARY TRAFFIC CONTROL PHASING

## PHASE I

- STEP 1. INSTALL ALL OFF-SITE DETOUR SIGNING (SEE TMP-3).  
 - USING RSD 1101.03 (SHEET 1 OF 9), CLOSE SR 1114 (BIG PLUMTREE CREEK ROAD) FROM STA. 11+00+/- -L- TO STA. 13+65+/- -L-.

## PHASE II

- STEP 1. AWAY FROM TRAFFIC, REMOVE EXISTING BRIDGE. CONSTRUCT NEW BRIDGE AND ROADWAY APPROACHES, DRAINAGE, GUARDRAIL, AND PAVE UP TO BUT NOT INCLUDING THE FINAL LAYER OF SURFACE COURSE AS FOLLOWS (SEE CONSTRUCTION PLANS):  
 - STA. 11+00+/- -L- TO STA. 13+65+/- -L-.
- STEP 2. AWAY FROM TRAFFIC, PAVE THE FINAL LAYER OF SURFACE COURSE AS FOLLOWS (SEE CONSTRUCTION PLANS):  
 - STA. 11+00+/- -L- TO STA. 13+65+/- -L-.
- STEP 3. REMOVE ALL TYPE III BARRICADES AND DETOUR SIGNING. REOPEN SR 1114 (BIG PLUMTREE CREEK ROAD) TO A 2-LANE, 2-WAY TRAFFIC PATTERN.

**\* SEE SHEET TMP-2 FOR SIGN DESIGN**

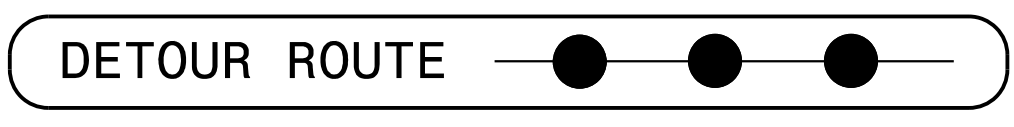
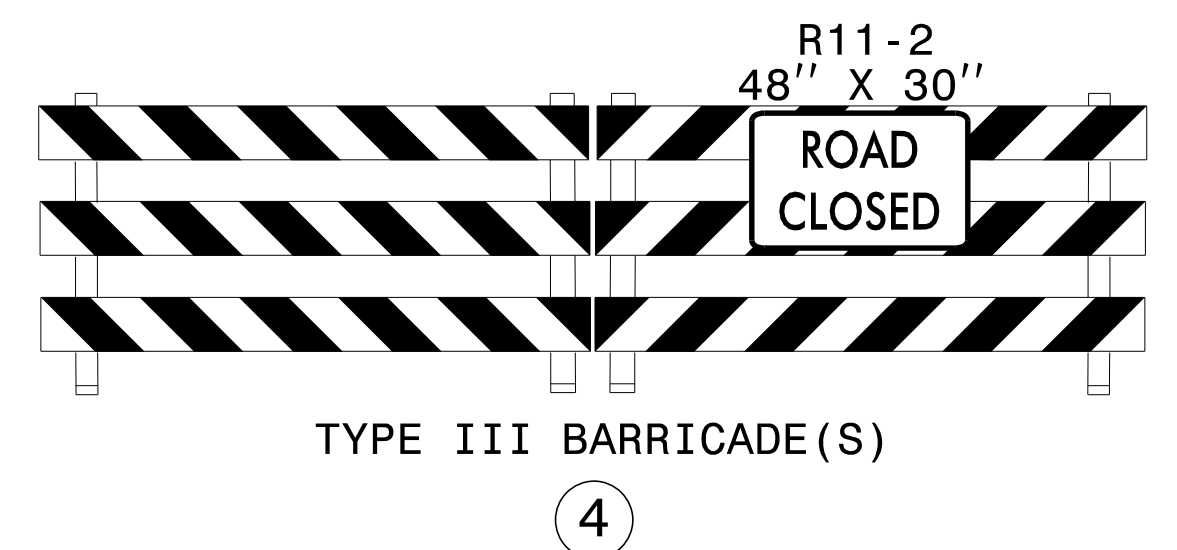
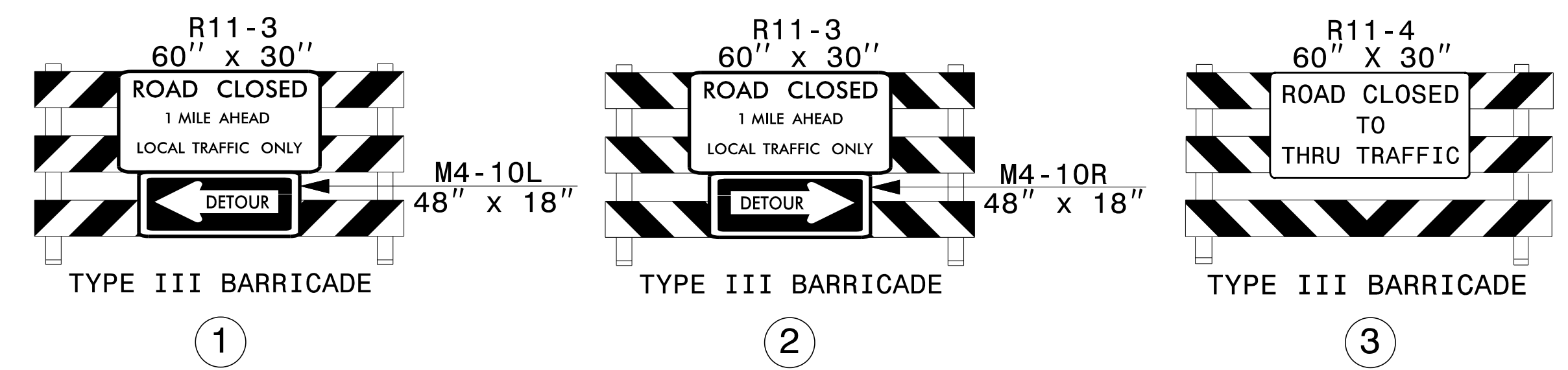
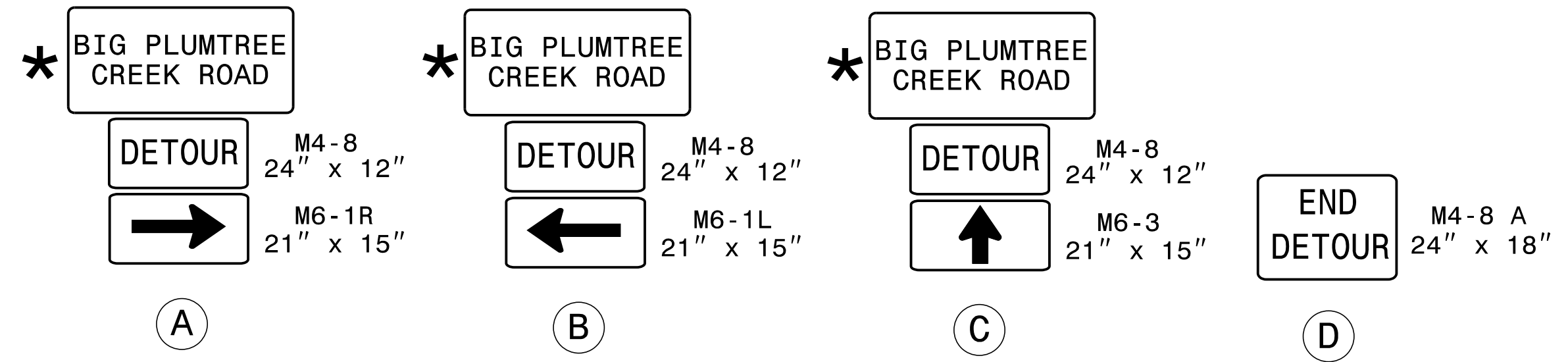
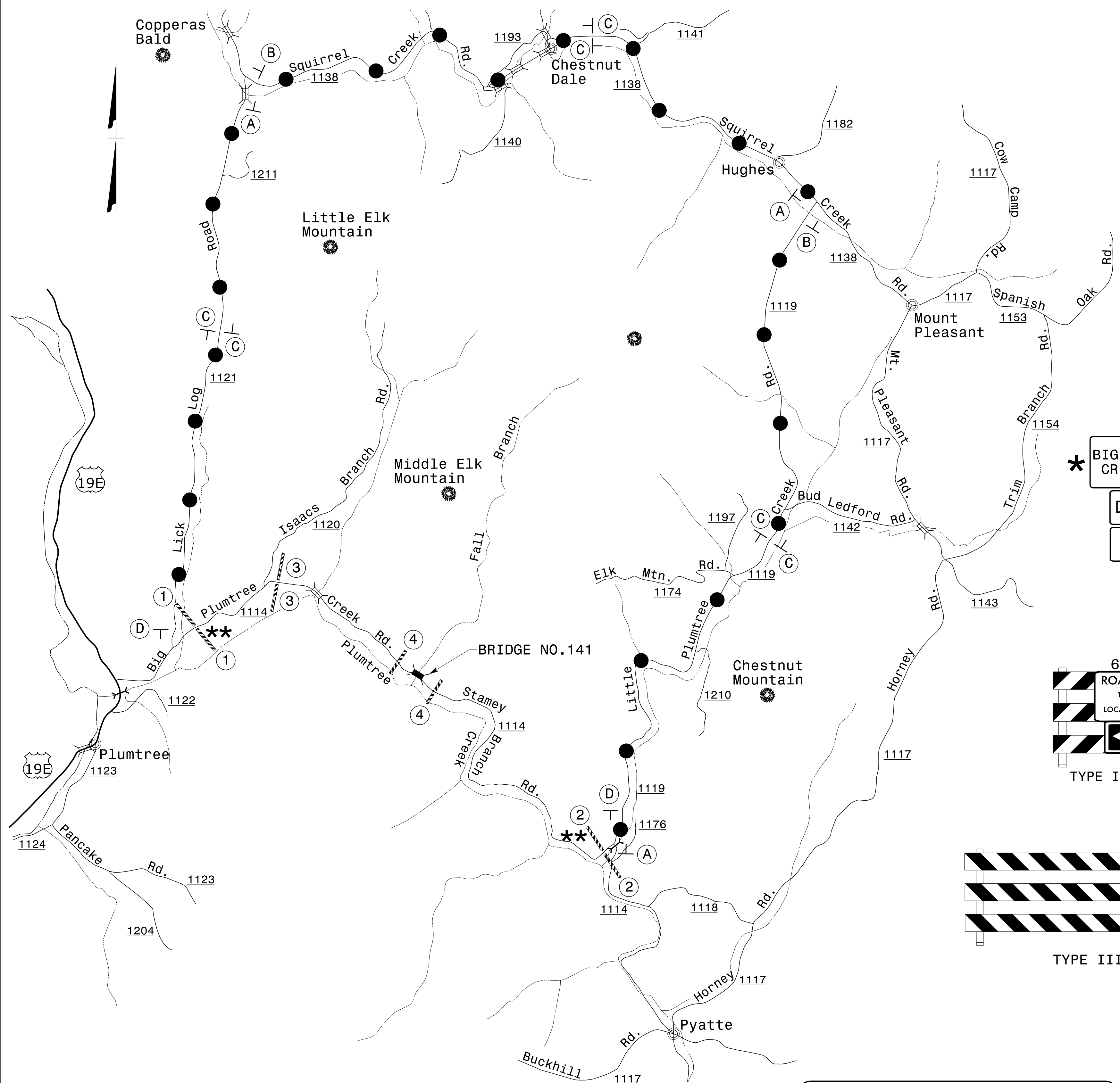

APPROVED: *Lori D. Stoucho*  
 DATE: 6/28/2016

**DOCUMENT NOT CONSIDERED FINAL UNLESS ALL SIGNATURES COMPLETED**

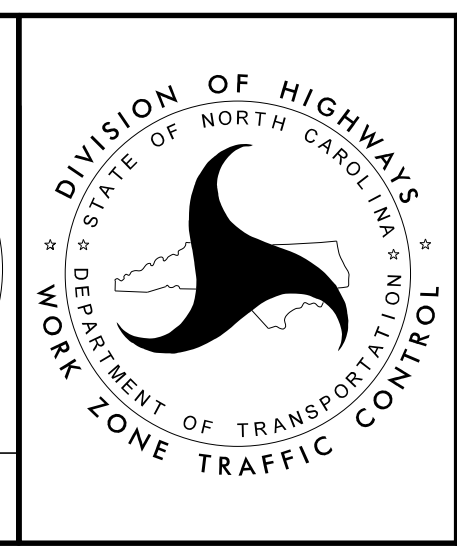

**TEMPORARY TRAFFIC CONTROL PHASING AND OFF-SITE DETOUR BIG PLUMTREE CREEK RD. SR 1114**