

\*\* SEE RSD 1101.03, SHEET 1 OF 9, FOR ADDITIONAL WORK ZONE SIGNS AND LOCATIONS

# TEMPORARY TRAFFIC CONTROL PHASING

## PHASE I

- STEP 1. INSTALL ALL OFF-SITE DETOUR SIGNING (SEE TMP-3).  
 - USING RSD 1101.03 (SHEET 1 OF 9), CLOSE SR 1114 (BIG PLUMTREE CREEK ROAD) FROM STA. 11+00+/- -L- TO STA. 13+65+/- -L-.

## PHASE II

- STEP 1. AWAY FROM TRAFFIC, REMOVE EXISTING BRIDGE. CONSTRUCT NEW BRIDGE AND ROADWAY APPROACHES, DRAINAGE, GUARDRAIL, AND PAVE UP TO BUT NOT INCLUDING THE FINAL LAYER OF SURFACE COURSE AS FOLLOWS (SEE CONSTRUCTION PLANS):  
 - STA. 11+00+/- -L- TO STA. 13+65+/- -L-.
- STEP 2. AWAY FROM TRAFFIC, PAVE THE FINAL LAYER OF SURFACE COURSE AS FOLLOWS (SEE CONSTRUCTION PLANS):  
 - STA. 11+00+/- -L- TO STA. 13+65+/- -L-.
- STEP 3. REMOVE ALL TYPE III BARRICADES AND DETOUR SIGNING. REOPEN SR 1114 (BIG PLUMTREE CREEK ROAD) TO A 2-LANE, 2-WAY TRAFFIC PATTERN.

\* SEE SHEET TMP-2 FOR SIGN DESIGN

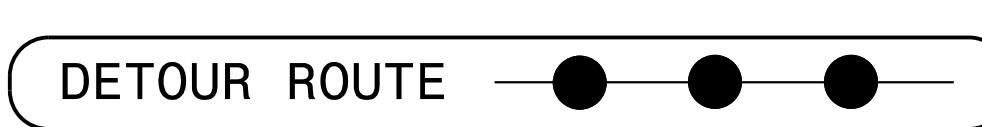
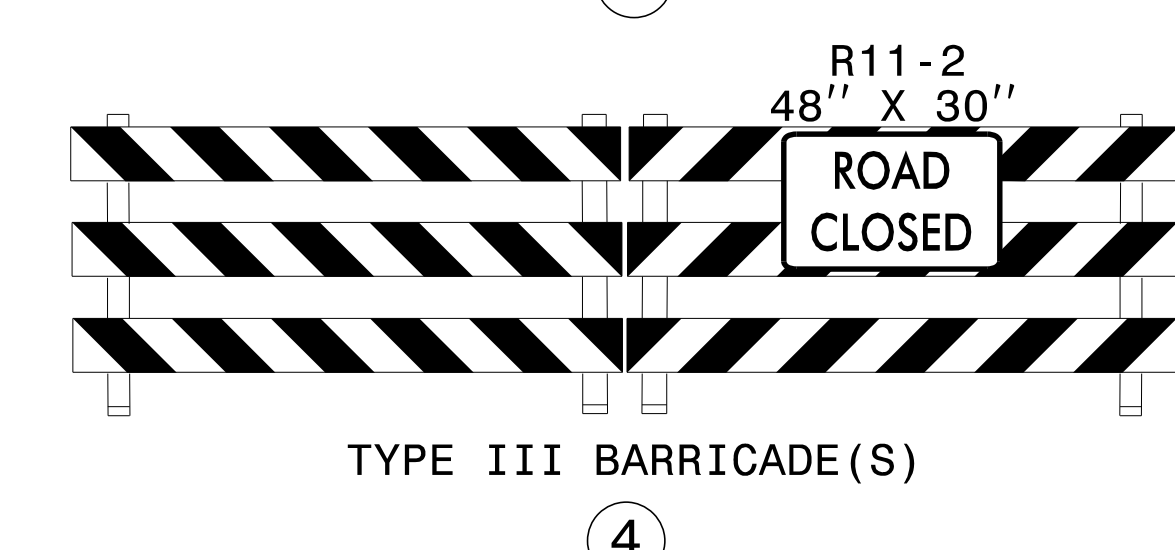
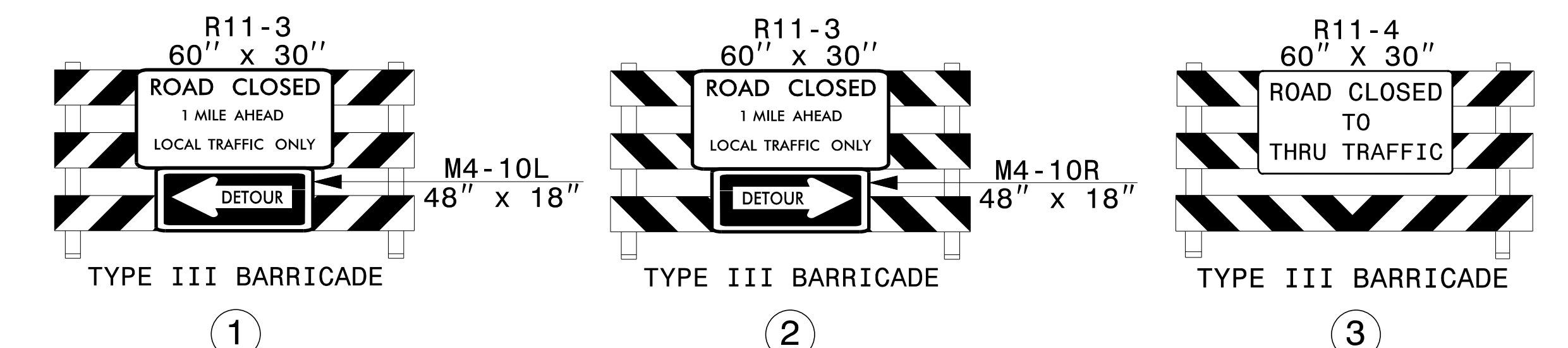
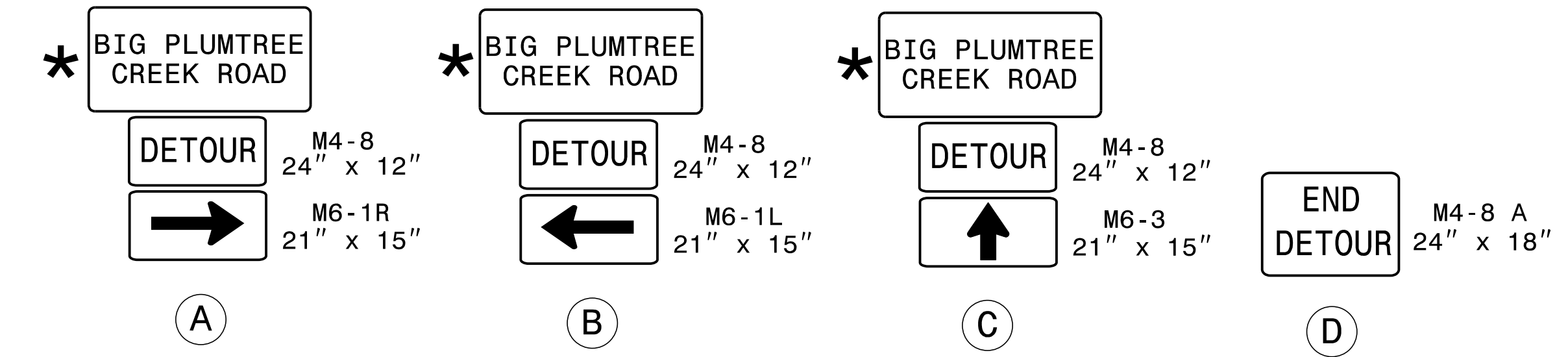
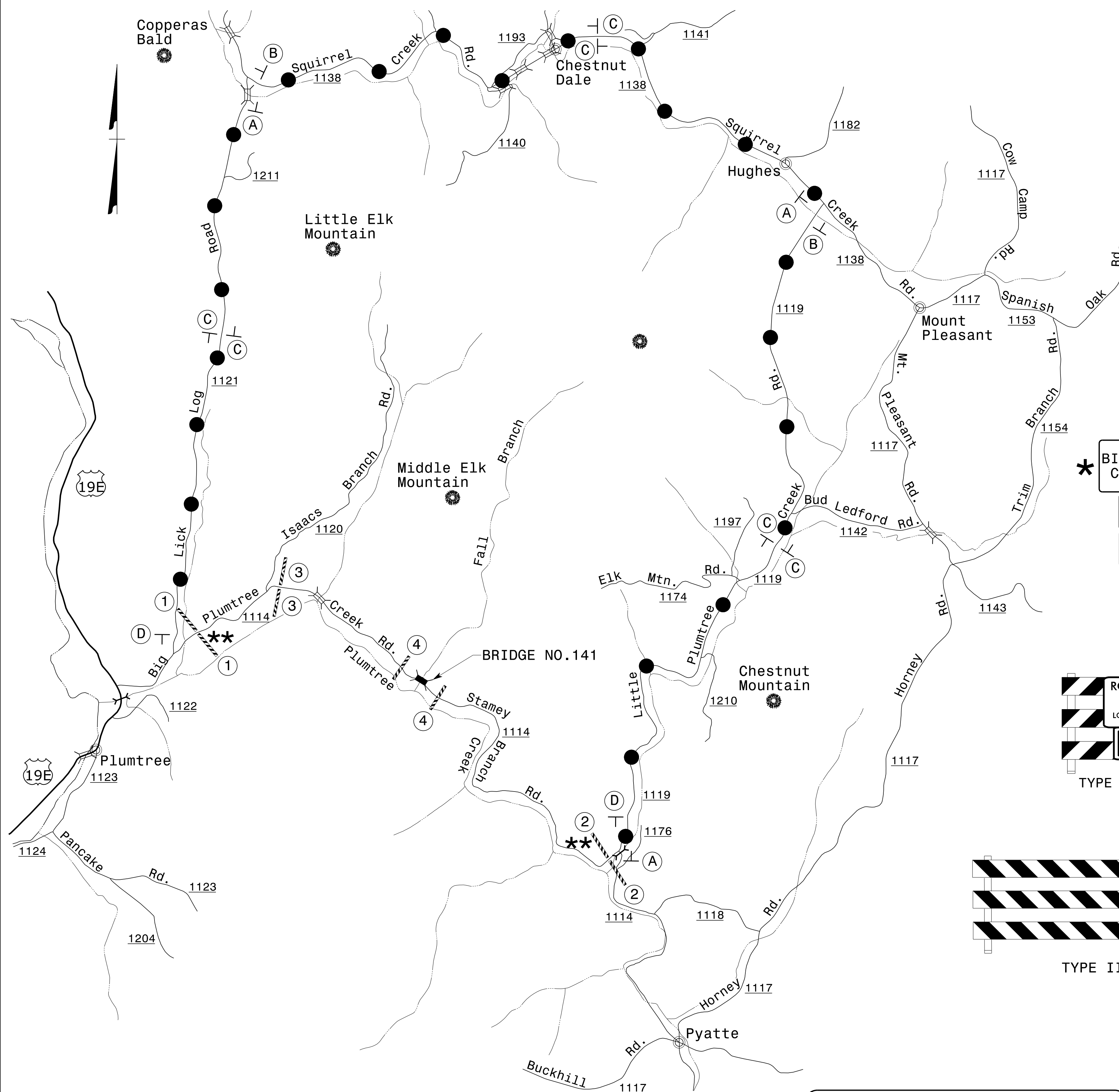

APPROVED: *Lori D. Stoucho*  
 DATE: 6/28/2016

DOCUMENT NOT CONSIDERED FINAL  
 UNLESS ALL SIGNATURES COMPLETED

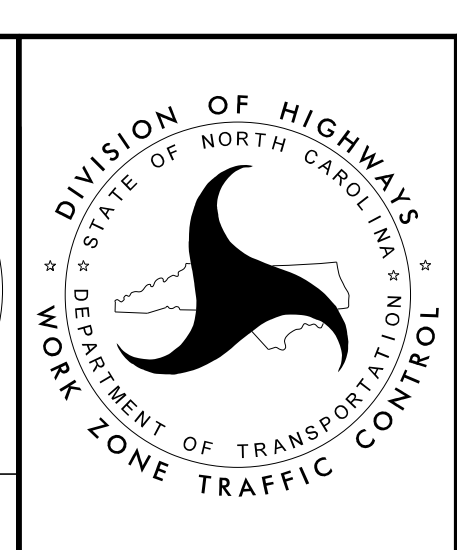

TEMPORARY TRAFFIC CONTROL PHASING AND OFF-SITE DETOUR  
 BIG PLUMTREE CREEK RD.  
 SR 1114

6/28/2016  
 p:\tjpr\projects-b\5380\trafficcontrol\top\B5380\_TC\_TMP03.dgn  
 User:scodts