

**This electronic collection of documents is provided  
for the convenience of the user  
and is Not a Certified Document –**

**The documents contained herein were originally issued  
and sealed by the individuals whose names and license  
numbers appear on each page, on the dates appearing  
with their signature on that page.**

**This file or an individual page  
shall not be considered a certified document.**

REFERENCE: I-5710

PROJECT: 50125

STATE OF NORTH CAROLINA  
DEPARTMENT OF TRANSPORTATION  
DIVISION OF HIGHWAYS  
GEOTECHNICAL ENGINEERING UNIT

**STRUCTURE**  
**SUBSURFACE INVESTIGATION**

COUNTY WAKE  
PROJECT DESCRIPTION WESTBOUND RAMPS ALONG  
I-540 AT SR 1839 (LEESVILLE ROAD), NC 50  
(CREEDMOOR ROAD), SR 1005 (SIX FORKS ROAD),  
AND SR 2000 (FALLS OF NEUSE ROAD)  
SITE DESCRIPTION WESTBOUND RAMP ALONG I-540  
AND SR 2000 (FALLS OF NEUSE ROAD)

**CONTENTS**

<u>SHEET NO.</u>	<u>DESCRIPTION</u>
1	TITLE SHEET
2	LEGEND
3	SITE PLAN/PROFILE
4	LAB SUMMARY SHEET

STATE	STATE PROJECT REFERENCE NO.	SHEET NO.	TOTAL SHEETS
N.C.	I-5710	1	4

**CAUTION NOTICE**

THE SUBSURFACE INFORMATION AND THE SUBSURFACE INVESTIGATION ON WHICH IT IS BASED WERE MADE FOR THE PURPOSE OF STUDY, PLANNING AND DESIGN, AND NOT FOR CONSTRUCTION OR PAY PURPOSES. THE VARIOUS FIELD BORING LOGS, ROCK CORES AND SOIL TEST DATA AVAILABLE MAY BE REVIEWED OR INSPECTED IN RALEIGH BY CONTACTING THE N. C. DEPARTMENT OF TRANSPORTATION, GEOTECHNICAL ENGINEERING UNIT AT (919) 707-6850. THE SUBSURFACE PLANS AND REPORTS, FIELD BORING LOGS, ROCK CORES AND SOIL TEST DATA ARE NOT PART OF THE CONTRACT.

GENERAL SOIL AND ROCK STRATA DESCRIPTIONS AND INDICATED BOUNDARIES ARE BASED ON A GEOTECHNICAL INTERPRETATION OF ALL AVAILABLE SUBSURFACE DATA AND MAY NOT NECESSARILY REFLECT THE ACTUAL SUBSURFACE CONDITIONS BETWEEN BORINGS OR BETWEEN SAMPLED STRATA WITHIN THE BOREHOLE. THE LABORATORY SAMPLE DATA AND THE IN SITU (IN-PLACE) TEST DATA CAN BE RELIED ON ONLY TO THE DEGREE OF RELIABILITY INHERENT IN THE STANDARD TEST METHOD. THE OBSERVED WATER LEVELS OR SOIL MOISTURE CONDITIONS INDICATED IN THE SUBSURFACE INVESTIGATIONS ARE AS RECORDED AT THE TIME OF THE INVESTIGATION. THESE WATER LEVELS OR SOIL MOISTURE CONDITIONS MAY VARY CONSIDERABLY WITH TIME ACCORDING TO CLIMATIC CONDITIONS INCLUDING TEMPERATURES, PRECIPITATION AND WIND, AS WELL AS OTHER NON-CLIMATIC FACTORS.

THE BIDDER OR CONTRACTOR IS CAUTIONED THAT DETAILS SHOWN ON THE SUBSURFACE PLANS ARE PRELIMINARY ONLY AND IN MANY CASES THE FINAL DESIGN DETAILS ARE DIFFERENT. FOR BIDDING AND CONSTRUCTION PURPOSES, REFER TO THE CONSTRUCTION PLANS AND DOCUMENTS FOR FINAL DESIGN INFORMATION ON THIS PROJECT. THE DEPARTMENT DOES NOT WARRANT OR GUARANTEE THE SUFFICIENCY OR ACCURACY OF THE INVESTIGATION MADE, NOR THE INTERPRETATIONS MADE, OR OPINION OF THE DEPARTMENT AS TO THE TYPE OF MATERIALS AND CONDITIONS TO BE ENCOUNTERED. THE BIDDER OR CONTRACTOR IS CAUTIONED TO MAKE SUCH INDEPENDENT SUBSURFACE INVESTIGATIONS AS HE DEEMS NECESSARY TO SATISFY HIMSELF AS TO CONDITIONS TO BE ENCOUNTERED ON THE PROJECT. THE CONTRACTOR SHALL HAVE NO CLAIM FOR ADDITIONAL COMPENSATION OR FOR AN EXTENSION OF TIME FOR ANY REASON RESULTING FROM THE ACTUAL CONDITIONS ENCOUNTERED AT THE SITE DIFFERING FROM THOSE INDICATED IN THE SUBSURFACE INFORMATION.

- NOTES:
1. THE INFORMATION CONTAINED HEREIN IS NOT IMPLIED OR GUARANTEED BY THE N. C. DEPARTMENT OF TRANSPORTATION AS ACCURATE NOR IS IT CONSIDERED PART OF THE PLANS, SPECIFICATIONS OR CONTRACT FOR THE PROJECT.
  2. BY HAVING REQUESTED THIS INFORMATION, THE CONTRACTOR SPECIFICALLY WAIVES ANY CLAIMS FOR INCREASED COMPENSATION OR EXTENSION OF TIME BASED ON DIFFERENCES BETWEEN THE CONDITIONS INDICATED HEREIN AND THE ACTUAL CONDITIONS AT THE PROJECT SITE.

PERSONNEL

ALEXANDER, M. J.  
EKLUND, M. A.  
CORY, K. W.

INVESTIGATED BY TERRACON CONSULTANTS  
DRAWN BY FIELDS, W. D.  
CHECKED BY ALEXANDER, M. J.  
SUBMITTED BY TERRACON CONSULTANTS  
DATE MAY 2016



DocuSigned by:  
Matthew J. Alexander 10/2016  
AC113DDE6101413  
SIGNATURE DATE

**DOCUMENT NOT CONSIDERED FINAL  
UNLESS ALL SIGNATURES COMPLETED**





# RETAINING WALL DETAIL -WALL1-

PROJECT REFERENCE NO.	SHEET NO.
1-5710	3
RW SHEET NO.	HYDRAULICS ENGINEER
ROADWAY DESIGN ENGINEER	
<b>INCOMPLETE PLANS</b> DO NOT USE FOR A/W ACQUISITION	
<b>DOCUMENT NOT CONSIDERED FINAL</b> UNLESS ALL SIGNATURES COMPLETED	

NAD 83/2011

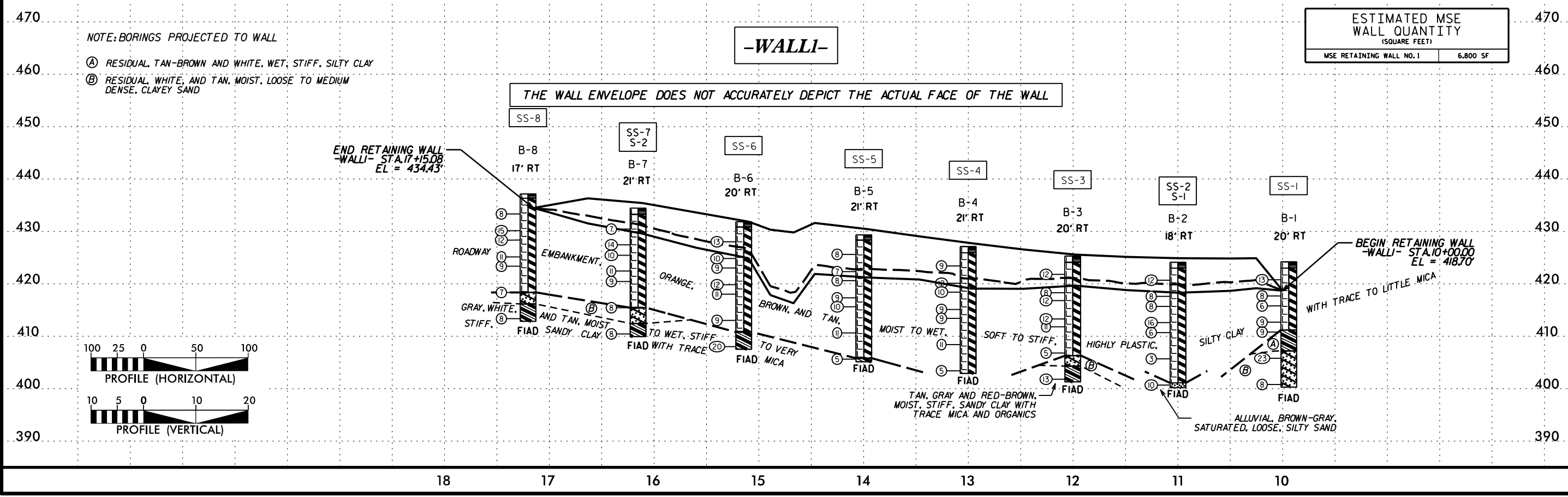
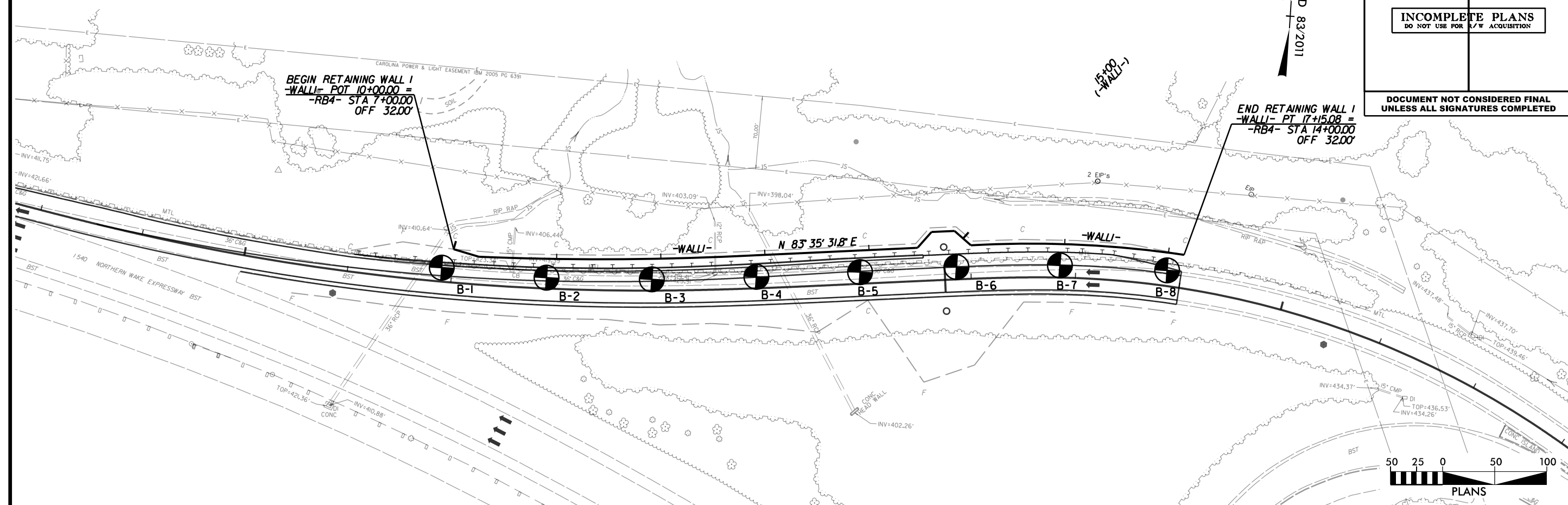

### SOIL LABORATORY TESTING SUMMARY

**PROJECT NUMBER:** 50125.1.FS1

**ID (TIP):** I-5710

**COUNTY:** Wake

**DESCRIPTION:** Retaining Wall 1 along Ramp -RB4- from SR 2000 (Falls of Neuse Road) to Westbound I-540

Boring No.	Sample No.	Alignment	Station	Offset (feet)	Depth Interval (feet)	AASHTO Class.	L.L.	P.I.	% by Weight				% Retained #4 Sieve	% Passing (sieves)			% Moisture	% Organic
									Coarse Sand	Fine Sand	Silt	Clay		#10	#40	#200		
B-1	SS-1	-WALL1-	10+00	13 RT	10.5 - 12.0	A-7-6 (24)	63	37	8.2	26.9	16.5	48.4	2	97	92	67	31.5	-
B-2	SS-2	-WALL1-	11+00	18 RT	7.4 - 8.9	A-7-6(24)	64	39	6.7	31.3	13.6	48.4	1	98	95	65	29.0	-
B-3	SS-3	-WALL1-	12+00	19 RT	11.0 - 12.5	A-7-5 (26)	74	39	12.5	20.7	12.2	54.6	3	93	85	66	32.8	-
B-4	SS-4	-WALL1-	13+00	21 RT	7.7 - 9.2	A-7-6 (15)	55	26	8.0	29.9	19.4	42.7	5	92	88	63	27.4	-
B-5	SS-5	-WALL1-	14+00	21 RT	12.7 - 14.2	A-7-6 (23)	64	41	11.1	28.0	11.7	49.2	1	95	88	61	29.6	-
B-6	SS-6	-WALL1-	15+15	21 RT	22.8 - 24.3	A-6 (3)	38	25	13.8	54.6	7.5	24.1	4	96	93	36	17.0	-
B-7	SS-7	-WALL1-	16+15	21 RT	6.0 - 7.5	A-7-6 (25)	66	42	7.3	28.0	16.2	48.5	5	94	90	64	28.8	-
B-8	SS-8	-WALL1-	17+20	17 RT	11.0 - 12.5	A-7-6 (14)	55	30	13.2	33.6	11.4	41.8	2	95	88	55	21.4	-
B-2	S-1	-WALL1-	11+00	18 RT	3.0 - 9.0	A-7-5 (8)	50	16	11.5	32.1	25.5	30.9	7	93	87	57	30.5	-
B-7	S-2	-WALL1-	16+15	21 RT	3.0 - 8.0	A-7-6 (12)	51	22	10.7	28.6	18.5	42.2	6	94	88	60	28.2	-

S-1 AND S-2 TESTED BY GEOTECHNICS.

*Stephanie H. Huffman*

Certified Lab Technician Signature

114-01-1203  
Certification Number