

SURVEY CONTROL SHEET I-5710

RB4			
TYPE	STATION	NORTH	EAST
PC	0+00.00	782698.9924	2113943.1172
TS	2+11.24	782664.1733	2114151.4307
SC	4+01.24	782629.4465	2114338.2142
CS	8+93.36	782608.2435	2114828.8475
ST	10+83.36	782626.7271	2115017.9305
TS	11+55.99	782634.8334	2115090.1109
SC	13+00.99	782646.9575	2115234.5572
CS	17+76.41	782531.3431	2115689.4834
ST	19+21.41	782451.7254	2115810.6145
POT	20+48.90	782378.7347	2115915.1420

FALLS OF THE NEUSE ROAD

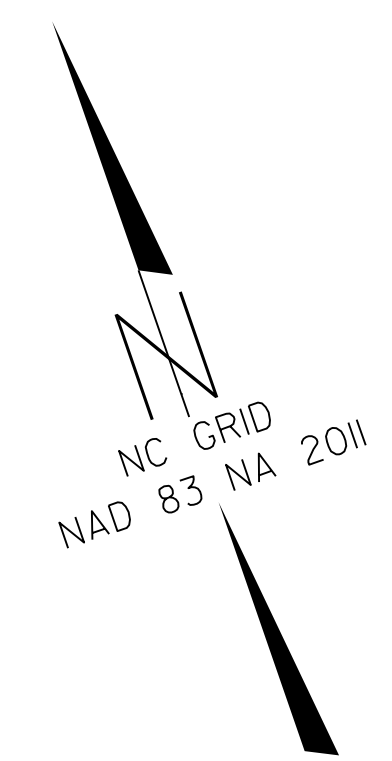
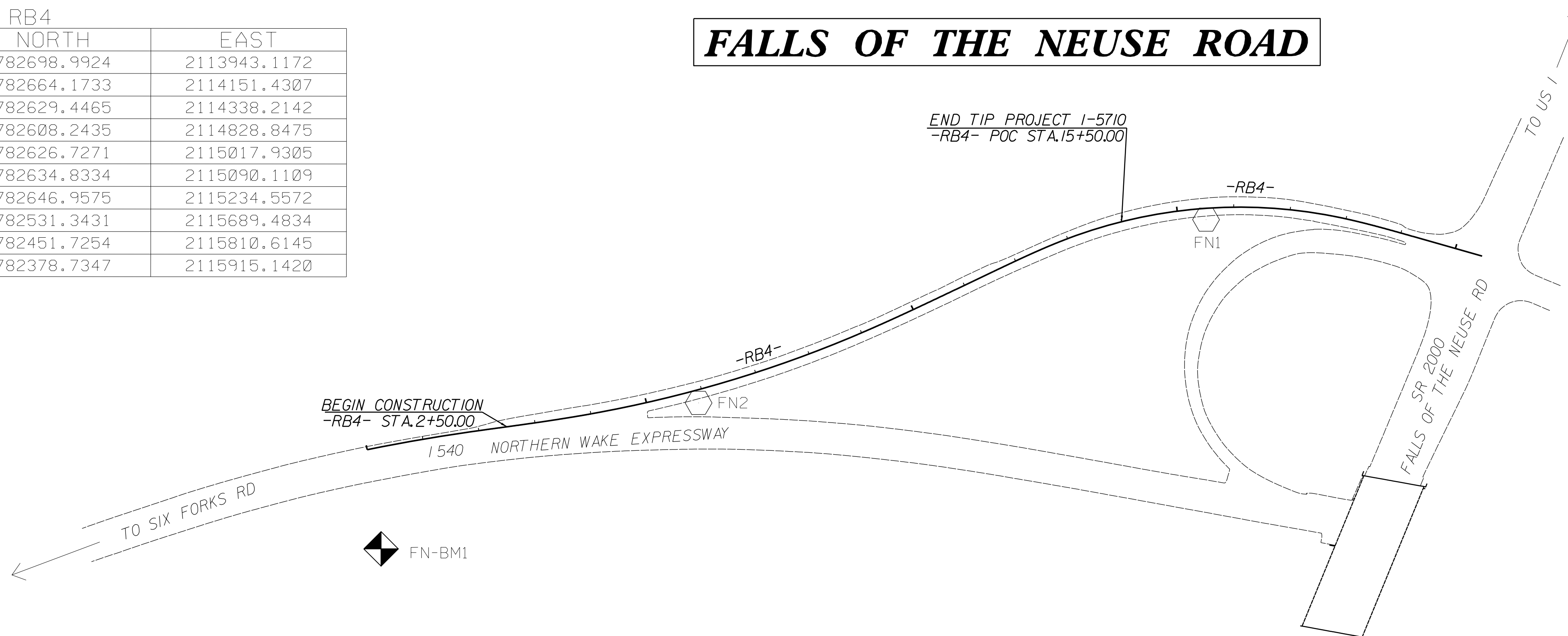

CONTROL POINT	DESC.	NORTH	EAST	ELEVATION	RB4 STATION	OFFSET
201	FN1	782598.847	2115475.569	437.54	15+49.70	19.84 RT
202	FN2	782585.825	2114523.061	426.53	5+88.91	22.64 RT

DATUM DESCRIPTION

THE LOCALIZED COORDINATE SYSTEM DEVELOPED FOR THIS PROJECT IS BASED ON THE STATE PLANE COORDINATES ESTABLISHED BY NCDOT FOR MONUMENT "SF1" WITH NAD 83/NA 2011 STATE PLANE GRID COORDINATES OF NORTHING: 787201.655(++) EASTING: 2103250.412(++) ELEVATION: 466.509(++)

THE AVERAGE COMBINED GRID FACTOR USED ON THIS PROJECT (GROUND TO GRID) IS: 0.99992221

THE N.C. LAMBERT GRID BEARING AND LOCALIZED HORIZONTAL GROUND DISTANCE FROM "SF1" TO -RB4- STATION 2+50.00 IS S 67°26'14.79" E 11845.69'

ALL LINEAR DIMENSIONS ARE LOCALIZED HORIZONTAL DISTANCES VERTICAL DATUM USED IS NAVD 88

NOTES:

- SITE CALIBRATION INFORMATION HAS NOT BEEN PROVIDED FOR THIS PROJECT. IF FURTHER INFORMATION IS NEEDED, PLEASE CONTACT THE LOCATION AND SURVEYS UNIT.
- INDICATES GEODETIC CONTROL MONUMENTS USED OR SET FOR HORIZONTAL PROJECT CONTROL BY THE NCDOT LOCATION AND SURVEYS UNIT.
- PROJECT CONTROL ESTABLISHED USING GLOBAL POSITIONING SYSTEM.

BENCH MARK DATA

FN-BM1 ELEVATION = 417.97
 N 782525 E 2113909
 FROM STATION 2+50.00 -RB4-
 S 64°56'25.40" W DIST 309.47'
 BENCH NAIL W/TAG SET IN CAMERA POLE

GEOID G12NC
 NOTE: DRAWING NOT TO SCALE