

GEOTECHNICAL ENGINEER

ENGINEER

DocuSigned by:
Donald W. Brown Jr. 5/12/2016

SIGNATURE DATE SIGNATURE DATE

DOCUMENT NOT CONSIDERED FINAL UNLESS ALL SIGNATURES COMPLETED

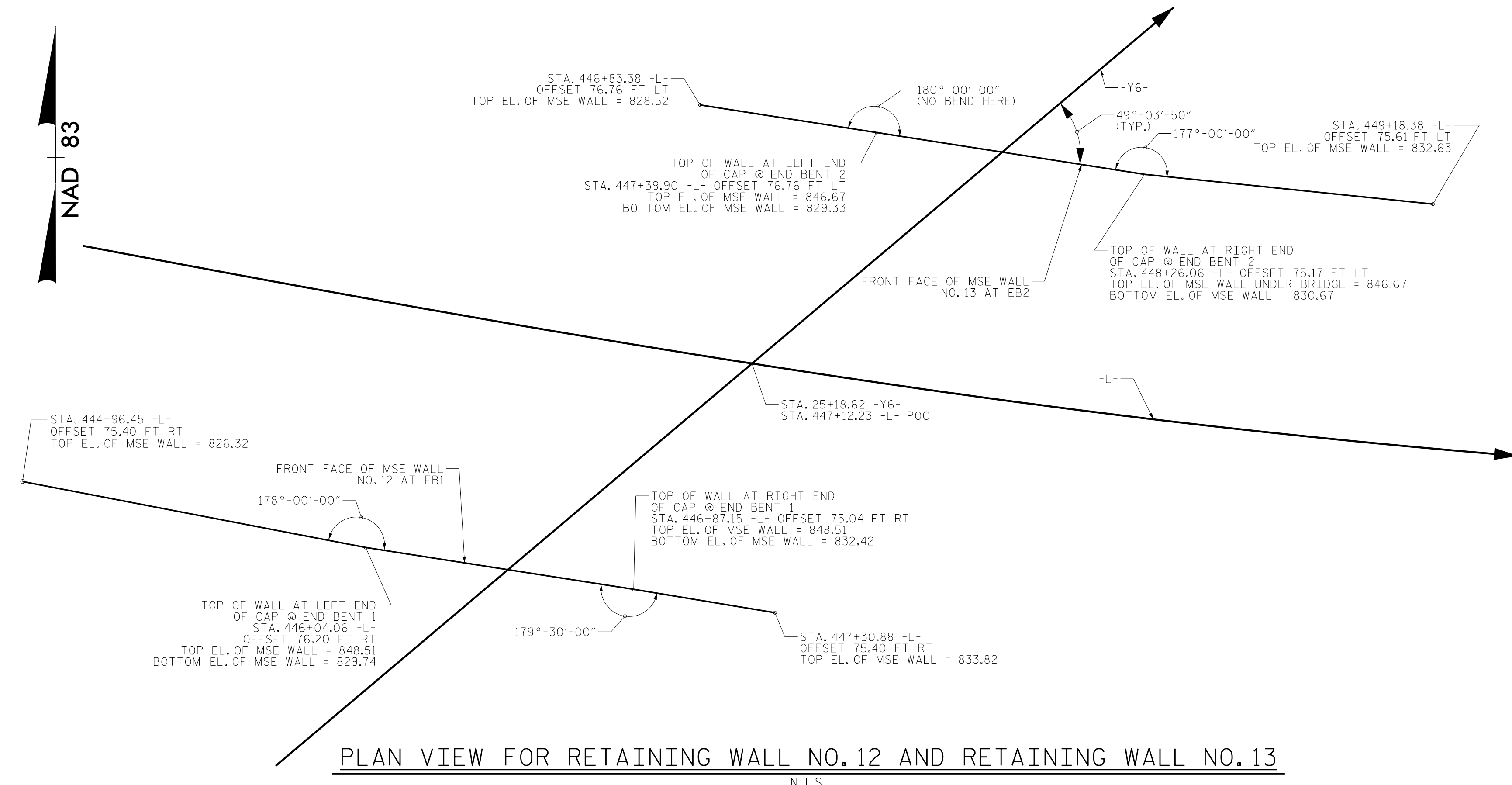

PLAN VIEW FOR RETAINING WALL NO. 12 AND RETAINING WALL NO. 13
N.T.S.

ESTIMATED SOIL NAIL WALL QUANTITIES			
RETAINING WALL NO.	SOIL NAIL RETAINING WALLS (SQ. FEET)	SOIL NAIL VERIFICATION TESTS	SOIL NAIL PROOF TESTS
12	3090	2	6
13	2840	2	6
TOTAL QUANTITIES	5930	4	12

ALTERNATE ESTIMATED MSE WALL QUANTITIES (SQ. FEET)	
MSE RETAINING WALL NO. 12	3330
MSE RETAINING WALL NO. 13	3080

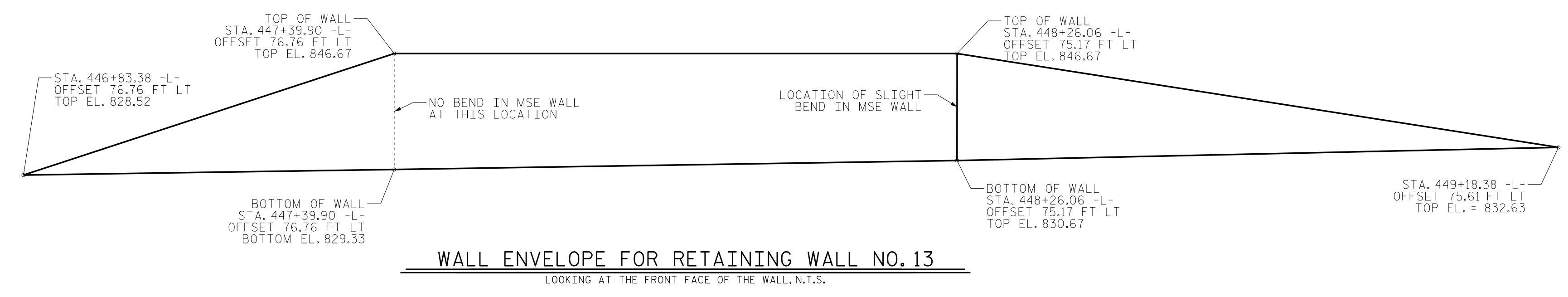

WALL ENVELOPE FOR RETAINING WALL NO. 13
LOOKING AT THE FRONT FACE OF THE WALL, N.T.S.

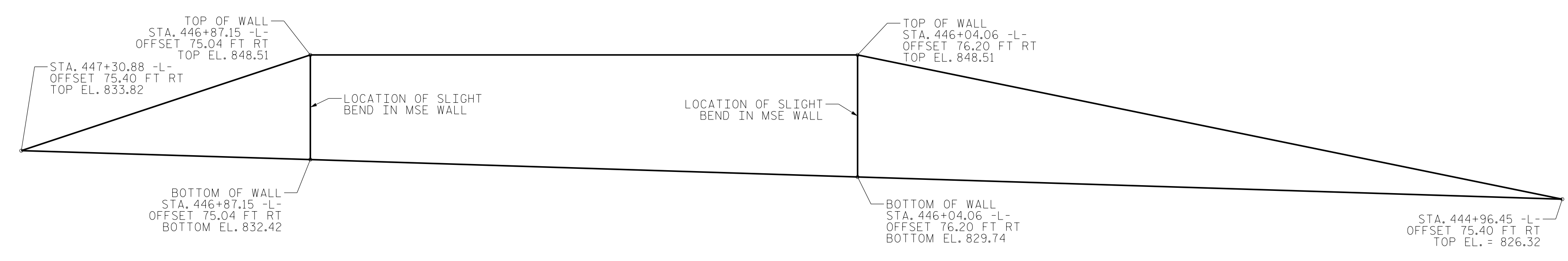

WALL ENVELOPE FOR RETAINING WALL NO. 12
LOOKING AT THE FRONT FACE OF THE WALL, N.T.S.

PROJECT NO.: U-2524D (34820.1.2)
GUILFORD COUNTY
STATION: -Y6- 25+18.62
SHEET 1 OF 5

PREPARED BY: N. MOHS DATE: 5/02/2016
REVIEWED BY: D. BROWN DATE: 5/10/2016

NORTH CAROLINA DEPARTMENT OF TRANSPORTATION DIVISION OF HIGHWAYS

GEOTECHNICAL ENGINEERING UNIT

REVISIONS						SHEET NO.
NO.	BY	DATE	NO.	BY	DATE	
1			3			W-4
2			4			