

+

+

nbspecks  
7/18/2016 12:23:37 PM  
Filename: Y:\Projects\NCDDOT\U-2524D\Site\2\DWG\Right\Final\404\_034\_U2524D\_SML\MSE01.dgn

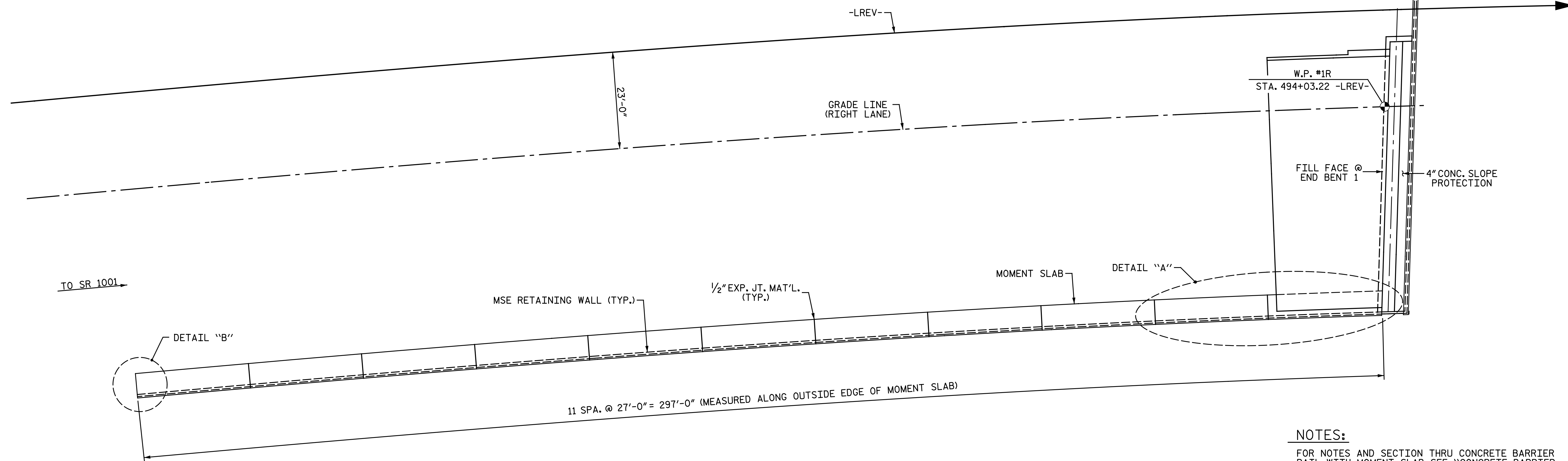

PLAN - END BENT 1

- NOTES:**
- FOR NOTES AND SECTION THRU CONCRETE BARRIER RAIL WITH MOMENT SLAB, SEE "CONCRETE BARRIER RAIL WITH MOMENT SLAB", SHEET 3 OF 3.
  - FOR DETAIL "B", SEE "CONCRETE BARRIER RAIL WITH MOMENT SLAB", SHEET 2 OF 3.
  - FOR GENERAL END OF RAIL DETAILS, SEE "CONCRETE BARRIER RAIL WITH MOMENT SLAB", SHEET 3 OF 3.
  - FOR MSE WALL LAYOUT AND DETAILS, SEE RETAINING WALL SHEETS.

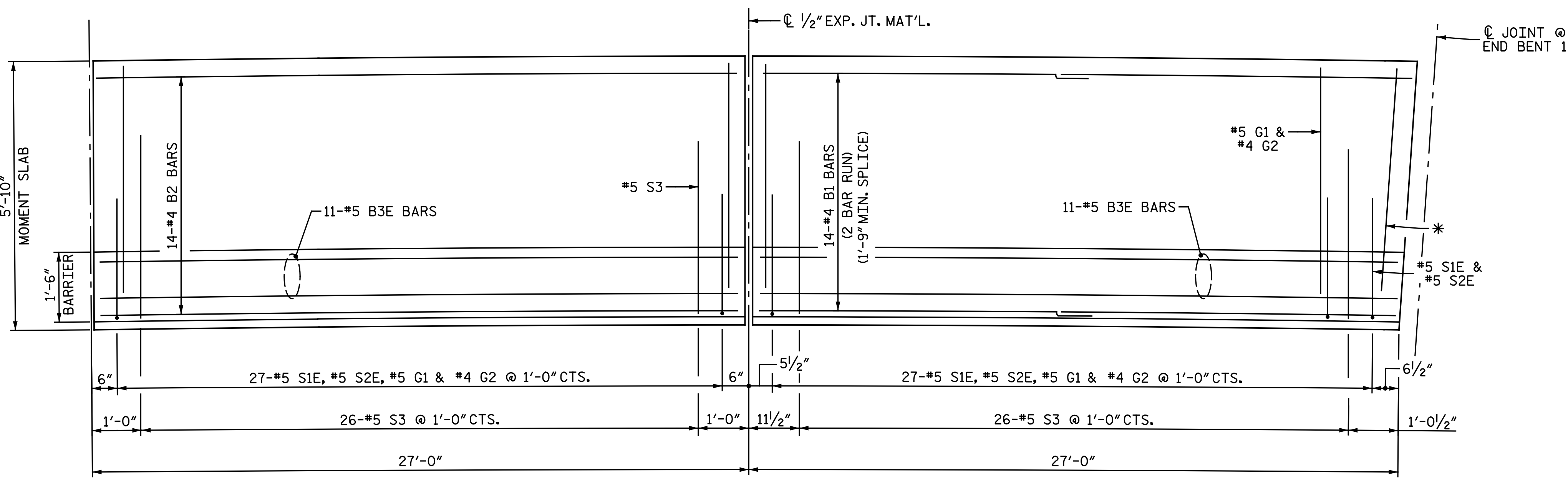

DETAIL "A"

\* PLACE FIRST G1 & G2 BARS PARALLEL TO JOINT

PROJECT NO. U-2524D  
GUILFORD COUNTY  
 STATION: 495+22.00 -LREV-  
 SHEET 1 OF 3

|                                                               |                                                                                                                      |     |                                                                    |     |     |                 |
|---------------------------------------------------------------|----------------------------------------------------------------------------------------------------------------------|-----|--------------------------------------------------------------------|-----|-----|-----------------|
| DOCUMENT NOT CONSIDERED FINAL UNLESS ALL SIGNATURES COMPLETED |                                                                                                                      |     | STATE OF NORTH CAROLINA<br>DEPARTMENT OF TRANSPORTATION<br>RALEIGH |     |     |                 |
|                                                               | <b>Michael Baker</b><br>INTERNATIONAL                                                                                |     | CONCRETE BARRIER RAIL<br>WITH MOMENT SLAB<br>RIGHT LANES           |     |     |                 |
|                                                               | Michael Baker Engineering<br>8000 Regency Parkway, Suite 600<br>Cary, North Carolina 27518<br>NC License No.: F-1084 |     | REVISIONS                                                          |     |     |                 |
|                                                               | NO.                                                                                                                  | BY: | DATE:                                                              | NO. | BY: | DATE:           |
| 1                                                             |                                                                                                                      |     | 3                                                                  |     |     | S4-33           |
| 2                                                             |                                                                                                                      |     | 4                                                                  |     |     | TOTAL SHEETS 35 |

DRAWN BY : C. E. MAYHEW DATE : 3-21-16  
 CHECKED BY : B. J. BELL DATE : 3-25-16