

**UTILITIES BY OTHERS**

**NOTE:**  
 ALL PROPOSED UTILITY WORK SHOWN ON THIS SHEET WILL BE DONE BY OTHERS. NO PAYMENT WILL BE MADE TO THE CONTRACTOR FOR PROPOSED UTILITY WORK SHOWN ON THIS SHEET.

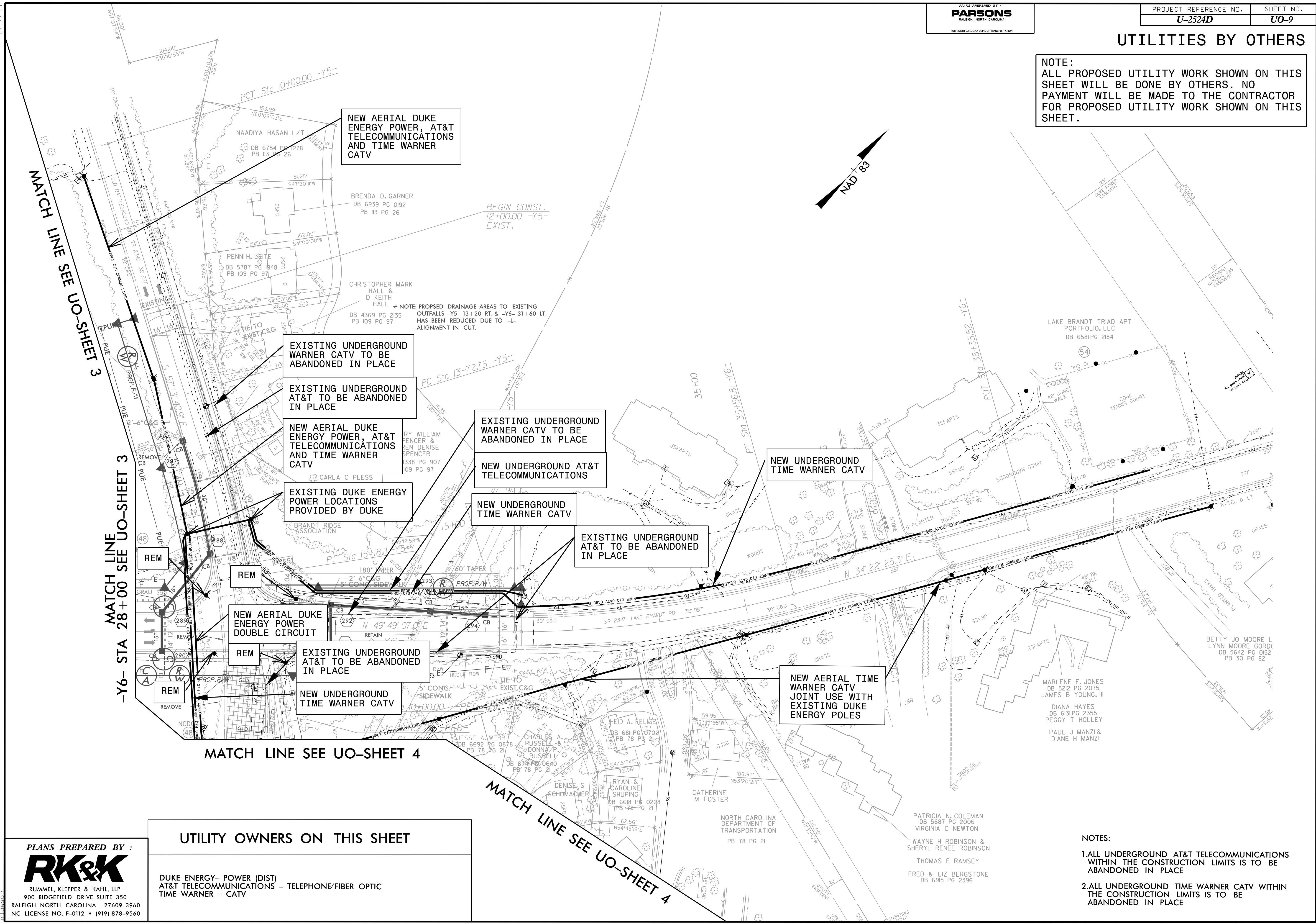

**NEW AERIAL DUKE ENERGY POWER, AT&T TELECOMMUNICATIONS AND TIME WARNER CATV**

**EXISTING UNDERGROUND WARNER CATV TO BE ABANDONED IN PLACE**

**EXISTING UNDERGROUND AT&T TO BE ABANDONED IN PLACE**

**NEW AERIAL DUKE ENERGY POWER, AT&T TELECOMMUNICATIONS AND TIME WARNER CATV**

**EXISTING UNDERGROUND WARNER CATV TO BE ABANDONED IN PLACE**

**NEW UNDERGROUND AT&T TELECOMMUNICATIONS**

**NEW UNDERGROUND TIME WARNER CATV**

**EXISTING DUKE ENERGY POWER LOCATIONS PROVIDED BY DUKE**

**NEW UNDERGROUND TIME WARNER CATV**

**EXISTING UNDERGROUND AT&T TO BE ABANDONED IN PLACE**

**NEW AERIAL DUKE ENERGY POWER DOUBLE CIRCUIT**

**EXISTING UNDERGROUND AT&T TO BE ABANDONED IN PLACE**

**NEW UNDERGROUND TIME WARNER CATV**

**NEW AERIAL TIME WARNER CATV JOINT USE WITH EXISTING DUKE ENERGY POLES**

**UTILITY OWNERS ON THIS SHEET**

DUKE ENERGY- POWER (DIST)  
 AT&T TELECOMMUNICATIONS - TELEPHONE/FIBER OPTIC  
 TIME WARNER - CATV

PLANS PREPARED BY:  
**RK&K**  
 RUMMEL, KLEPPER & KAHL, LLP  
 900 RIDGEFIELD DRIVE SUITE 350  
 RALEIGH, NORTH CAROLINA 27609-3960  
 NC LICENSE NO. F-0112 • (919) 878-9560

**NOTES:**  
 1. ALL UNDERGROUND AT&T TELECOMMUNICATIONS WITHIN THE CONSTRUCTION LIMITS IS TO BE ABANDONED IN PLACE  
 2. ALL UNDERGROUND TIME WARNER CATV WITHIN THE CONSTRUCTION LIMITS IS TO BE ABANDONED IN PLACE

8/17/99  
 U:\Projects\2013\13111\_Utility\_Coordination\_(NC DOT)\C01\_U-2524D\Utilities\Engineering\UB0\Proj\Option\_2\U2524D.dwg - Raji2\_U009\_psh.dgn  
 5/11/2016 10:00:00 AM