

-Y6A_DET-

HNTB

HNTB NORTH CAROLINA, P.C.
 343 E. Six Forks Road, Suite 200
 Raleigh, North Carolina 27609
 NC License No: C-1554

PROJECT REFERENCE NO.	SHEET NO.
U-2524D	EC-17/CONV.2B-6
RW SHEET NO.	
ROADWAY DESIGN ENGINEER	HYDRAULICS ENGINEER

$D = 38.11499$
 $L = 115.98'$
 $T = 61.07'$
 $R = 150.00'$
 $DS = 25 \text{ MPH}$

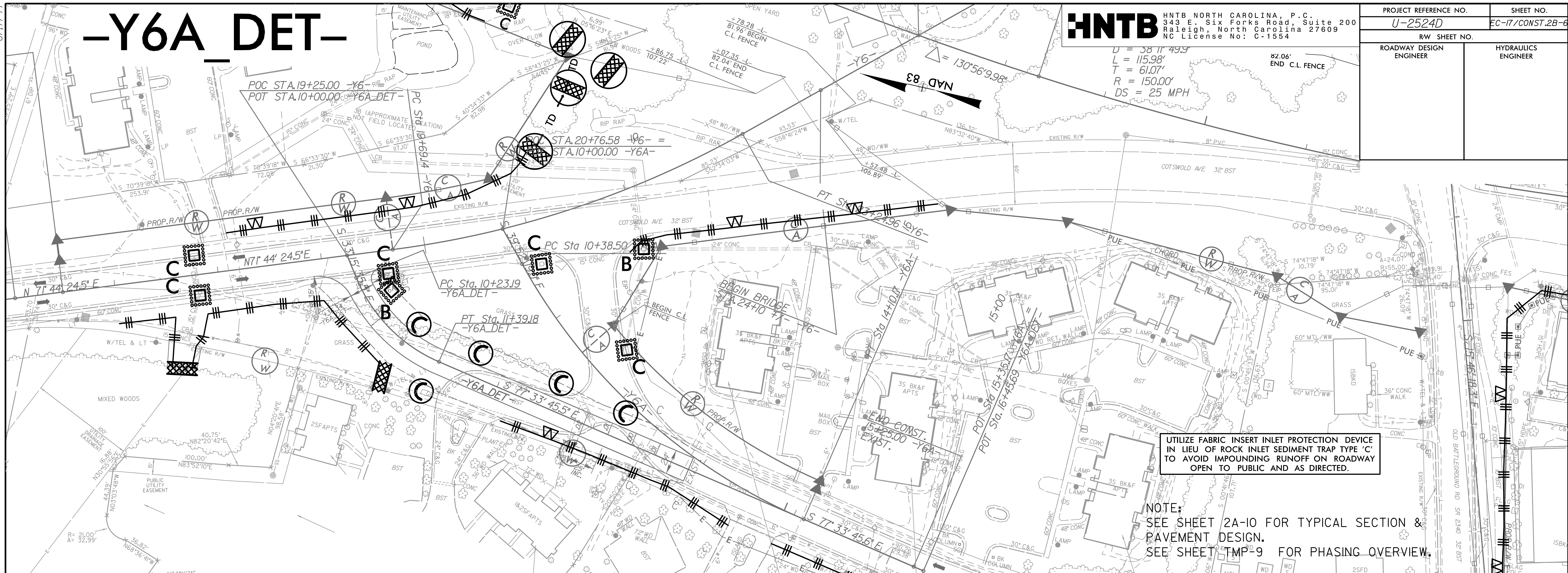

UTILIZE FABRIC INSERT INLET PROTECTION DEVICE IN LIEU OF ROCK INLET SEDIMENT TRAP TYPE 'C' TO AVOID IMPOUNDING RUNOFF ON ROADWAY OPEN TO PUBLIC AND AS DIRECTED.

NOTE:
 SEE SHEET 2A-10 FOR TYPICAL SECTION & PAVEMENT DESIGN.
 SEE SHEET TMP-9 FOR PHASING OVERVIEW.

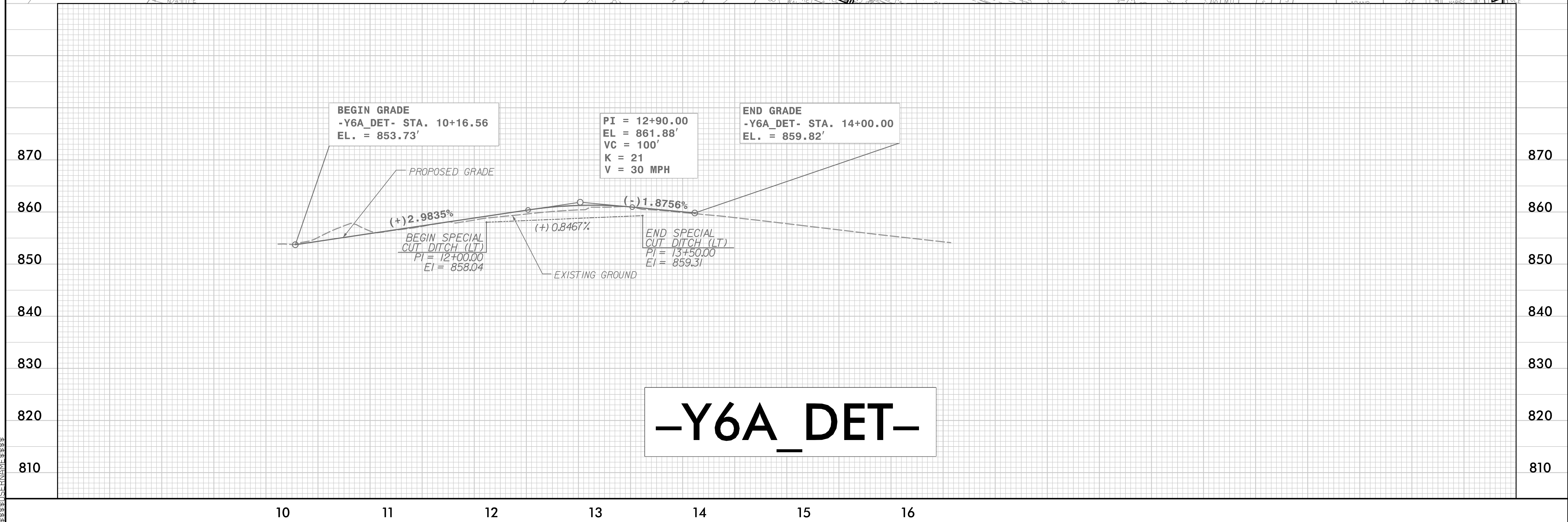

-Y6A_DET-

9:54:58 AM U:\2524D_EC_PSH_02B-6.dgn
 11/15/2011 11:11:11 AM
 11/15/2011 11:11:11 AM