

8/17/99

PROJECT REFERENCE NO. U-2524D	SHEET NO. EC-10A/CONST.10
RW SHEET NO.	
ROADWAY DESIGN ENGINEER	HYDRAULICS ENGINEER

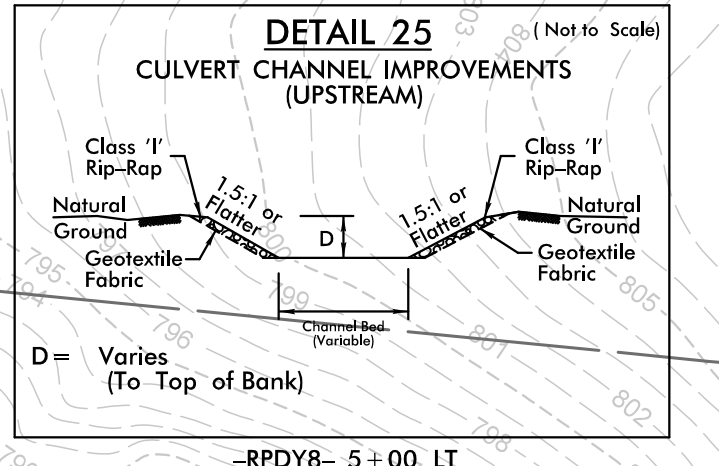
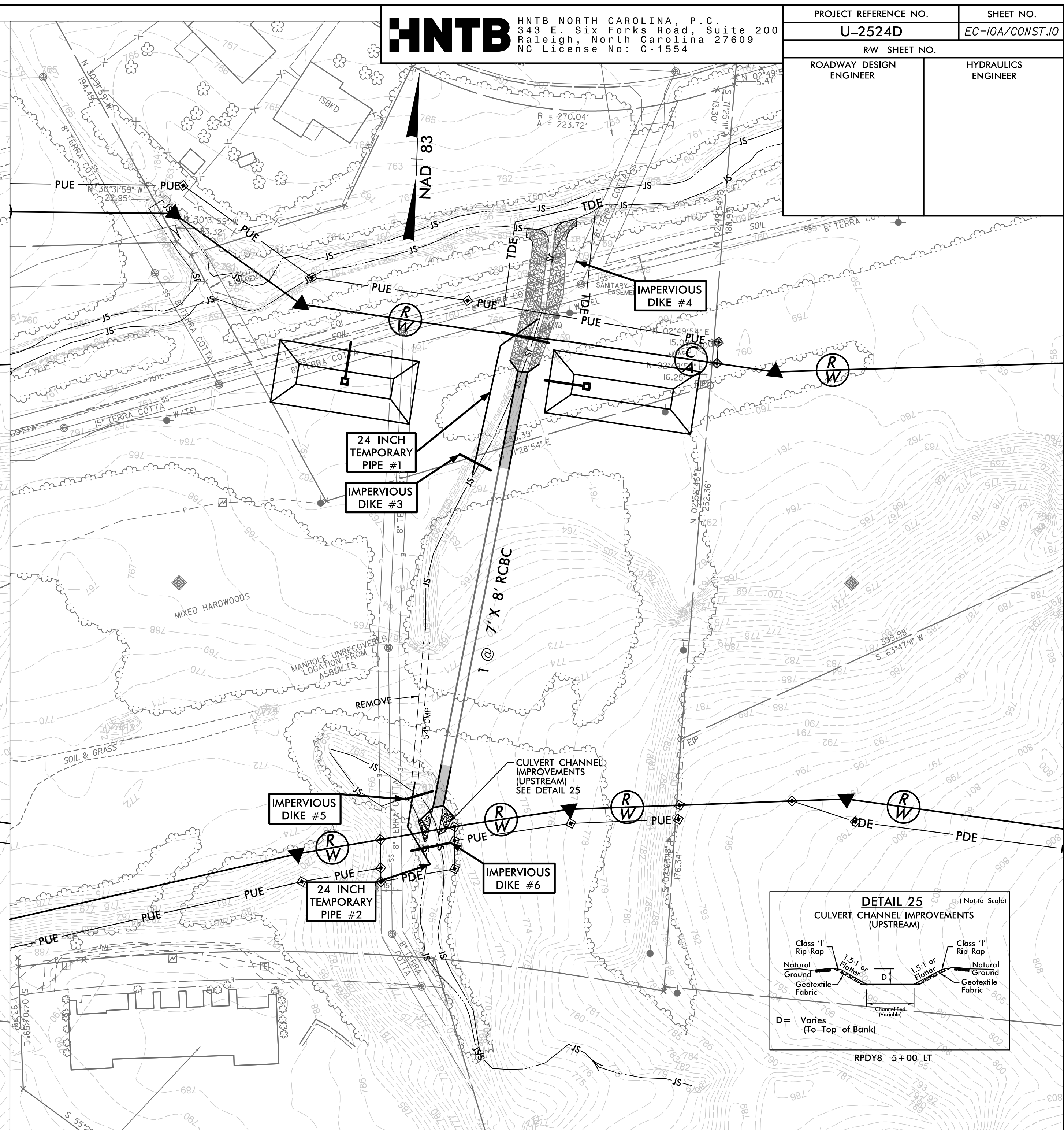
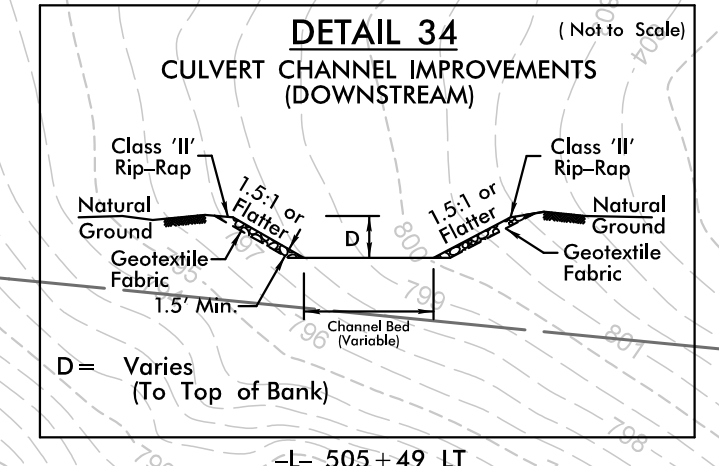
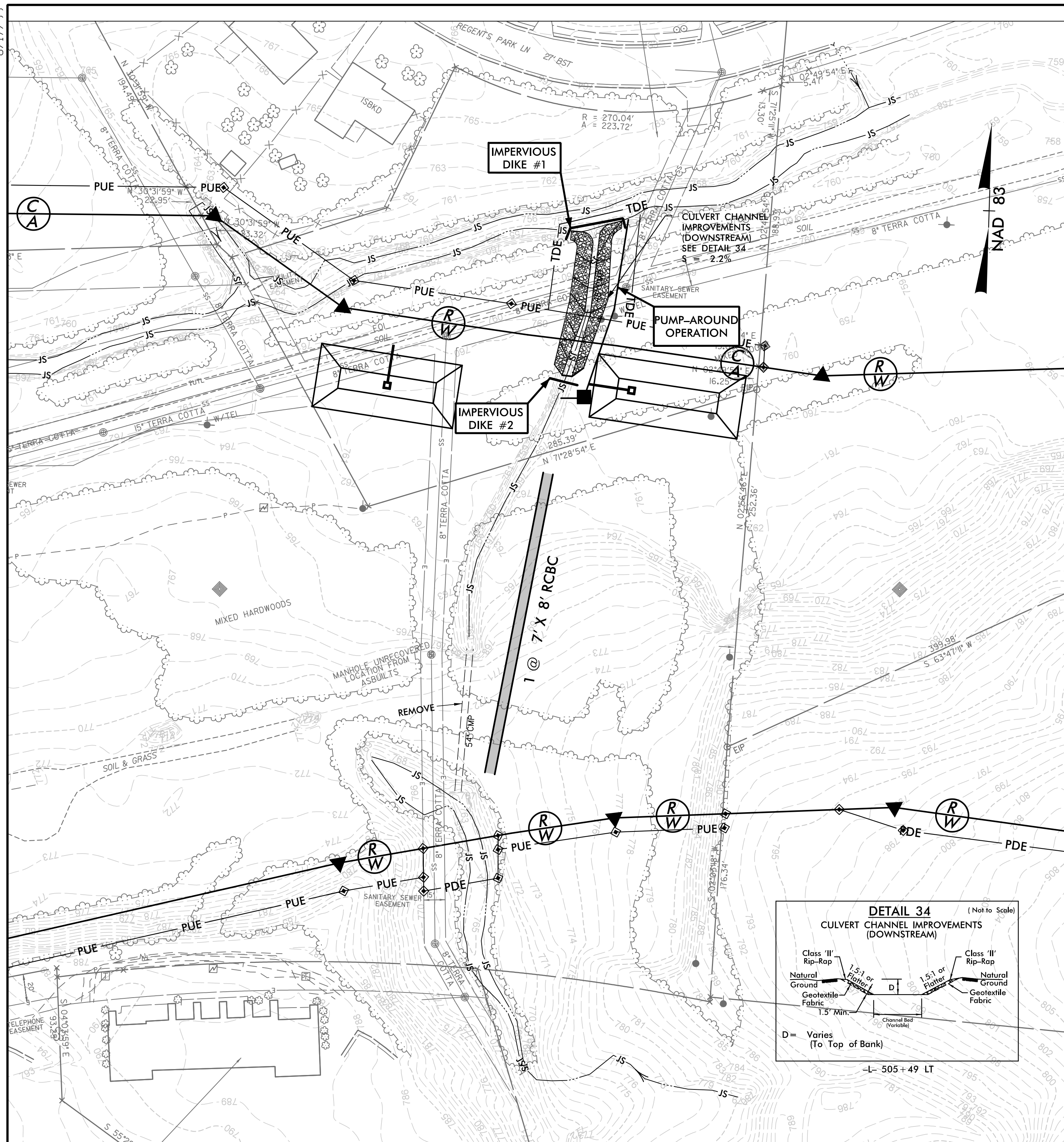

CULVERT CONSTRUCTION SEQUENCE

PHASE 1

1. CONSTRUCT APPROX. 215 LF OF THE 1 @ 7' X 8' RCBC AS SHOWN APPROX. 20 LF DOWNSTREAM OF THE INLET.
 2. INSTALL IMPERVIOUS DIKES 1 & 2 & PUMP-AROUND OPERATION AS SHOWN.
 3. REMOVE EXISTING 48" CMP & CONSTRUCT DOWNSTREAM CHANNEL IMPROVEMENTS AS SHOWN.
 4. REMOVE IMPERVIOUS DIKE 1 & 2 & PUMP-AROUND OPERATION.
- DEWATER CONSTRUCTION AREAS INTO SURROUNDING BASINS AND SPECIAL STILLING BASINS AS NEED.

CULVERT CONSTRUCTION SEQUENCE

PHASE 2

1. INSTALL IMPERVIOUS DIKES 3 & 4 & TEMPORARY 24" PIPE #1 AS SHOWN.
 2. CONSTRUCT REMAINING DOWNSTREAM PORTION OF THE 1 @ 7' X 8' RCBC.
 3. INSTALL IMPERVIOUS DIKES 5 & 6 AND TEMPORARY 24" PIPE #2 AS SHOWN.
 4. CONSTRUCT REMAINING UPSTREAM PORTION OF THE 1 @ 7' X 8' RCBC AND CHANNEL IMPROVEMENTS.
 5. REMOVE IMPERVIOUS DIKES 3, 4, 5, & 6 & TEMPORARY 24" PIPES #1 & #2. ALSO REMOVE ANY SPECIAL STILLING BASINS USED &/OR CLEAN OUT ANY SURROUNDING BASINS IF USED AS STILLING BASIN FOR CULVERT CONSTRUCTION.
 6. CONSTRUCT THE REMAINDER OF THE PROPOSED ROADWAY.
- DEWATER CONSTRUCTION AREAS INTO SURROUNDING BASINS AND SPECIAL STILLING BASINS AS NEED.

9:30:56 AM hntb_CSR4_phase.dgn
 USER: hntb