

PROJECT REFERENCE NO.	SHEET NO.
U-2524D	EC-9C/CONST.9
RW SHEET NO.	
ROADWAY DESIGN ENGINEER	HYDRAULICS ENGINEER

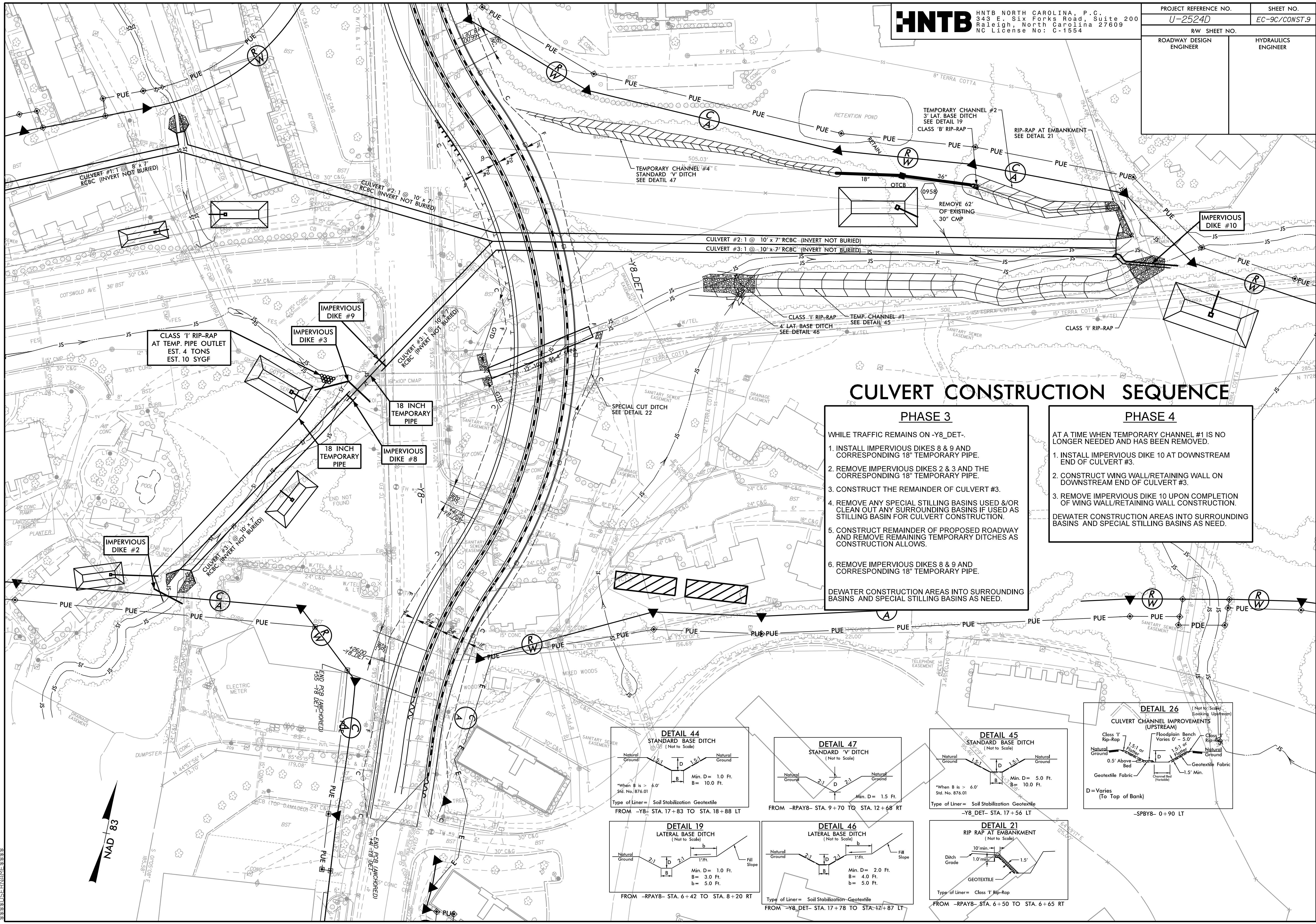

CULVERT CONSTRUCTION SEQUENCE

PHASE 3

WHILE TRAFFIC REMAINS ON -Y8_DET-

1. INSTALL IMPERVIOUS DIKES 8 & 9 AND CORRESPONDING 18" TEMPORARY PIPE.
2. REMOVE IMPERVIOUS DIKES 2 & 3 AND THE CORRESPONDING 18" TEMPORARY PIPE.
3. CONSTRUCT THE REMAINDER OF CULVERT #3.
4. REMOVE ANY SPECIAL STILLING BASINS USED &/OR CLEAN OUT ANY SURROUNDING BASINS IF USED AS STILLING BASIN FOR CULVERT CONSTRUCTION.
5. CONSTRUCT REMAINDER OF PROPOSED ROADWAY AND REMOVE REMAINING TEMPORARY DITCHES AS CONSTRUCTION ALLOWS.
6. REMOVE IMPERVIOUS DIKES 8 & 9 AND CORRESPONDING 18" TEMPORARY PIPE.

DEWATER CONSTRUCTION AREAS INTO SURROUNDING BASINS AND SPECIAL STILLING BASINS AS NEED.

PHASE 4

AT A TIME WHEN TEMPORARY CHANNEL #1 IS NO LONGER NEEDED AND HAS BEEN REMOVED.

1. INSTALL IMPERVIOUS DIKE 10 AT DOWNSTREAM END OF CULVERT #3.
2. CONSTRUCT WING WALL/RETAINING WALL ON DOWNSTREAM END OF CULVERT #3.
3. REMOVE IMPERVIOUS DIKE 10 UPON COMPLETION OF WING WALL/RETAINING WALL CONSTRUCTION.

DEWATER CONSTRUCTION AREAS INTO SURROUNDING BASINS AND SPECIAL STILLING BASINS AS NEED.

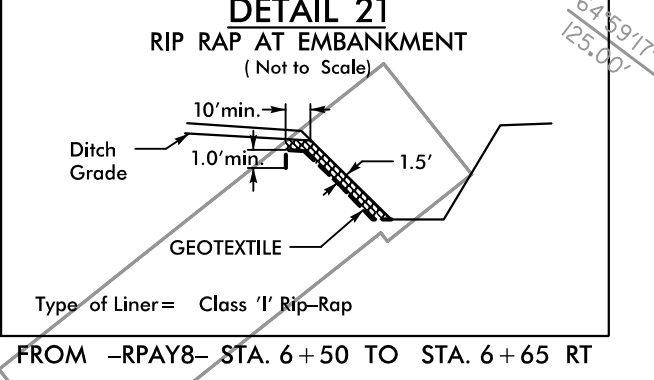
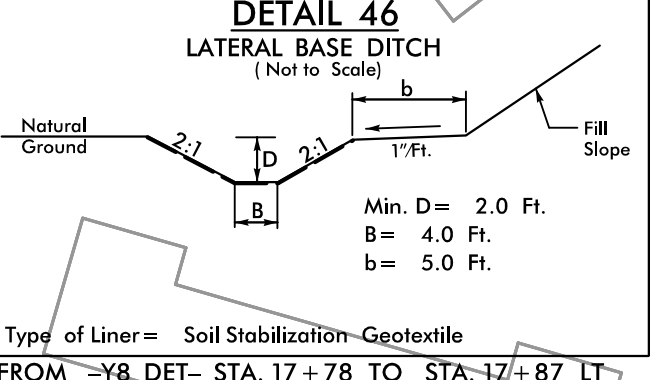
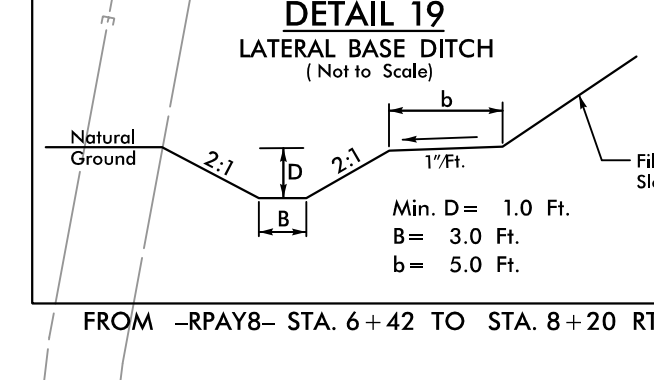
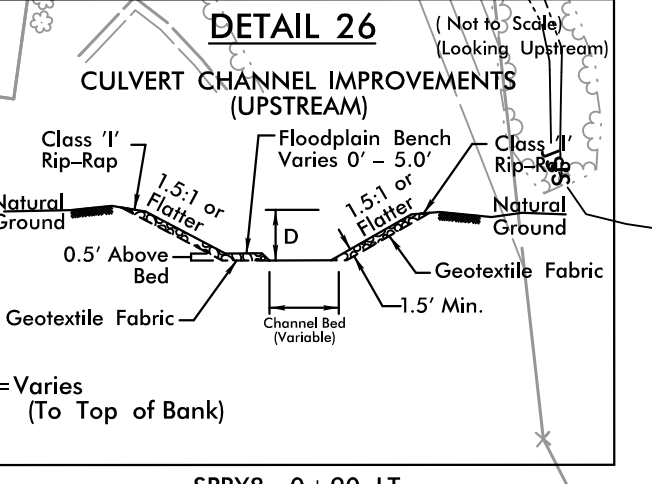
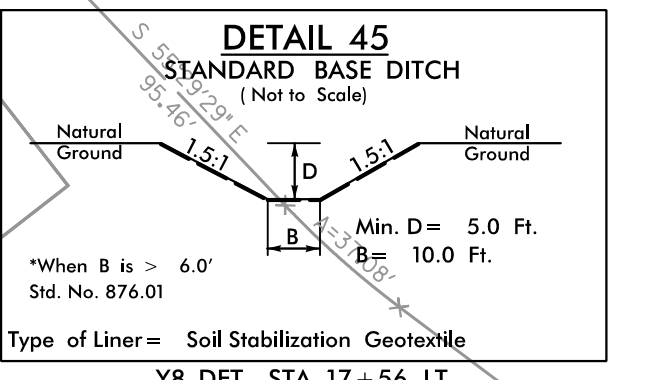
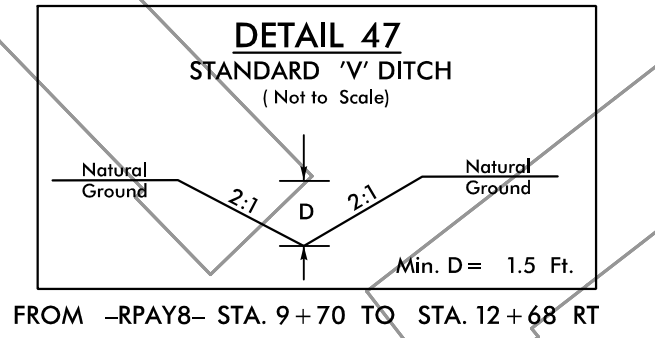
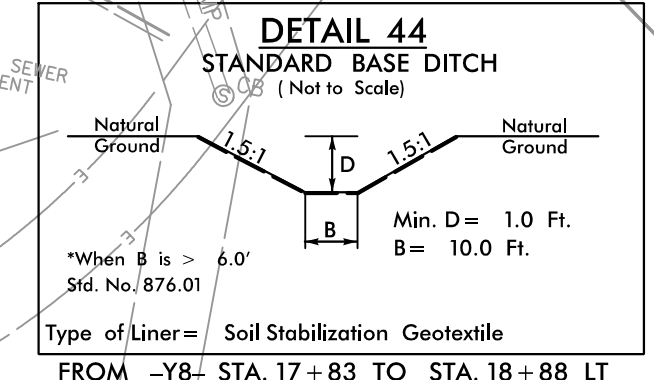

10:52:49 AM htd_CSRI-3_phase.dgn

