

5/28/19

PI = 25+85.00
EL = 802.21'
VC = 40'
K = 54
V = 40 MPH

PI = 26+30.00
EL = 805.50'
VC = 50'
K = 71
V = 45 MPH

PI = 25+20.00
EL = 796.98'
VC = 75'
K = 250
V = 70 MPH

PI = 27+10.00
EL = 810.78'
VC = 60'
K = 44
V = 40 MPH

END GRADE
-Y8_DET- SOUTHBOUND SHIFT
STA. 27+63.55 =
-Y8- STA. 27+00.00 (14.75' RT.)
EL. = 813.60'

-Y8_DET_SHIFT-

HNTB HNTB NORTH CAROLINA, P.C.
263 E. WILKIE ROAD, SUITE 200
RALEIGH, NORTH CAROLINA 27608
PHONE NO. 919.854.1345

PLANS PREPARED BY:
PARSONS
RALEIGH, NORTH CAROLINA, (919) 854-1345
NC LICENSE NO. F-0246
FOR NORTH CAROLINA DEPT. OF TRANSPORTATION

PROJECT REFERENCE NO. U-2524D	SHEET NO. 2B-7
ROADWAY DESIGN ENGINEER	HYDRAULICS ENGINEER

DOCUMENT NOT CONSIDERED FINAL
UNLESS ALL SIGNATURES COMPLETED

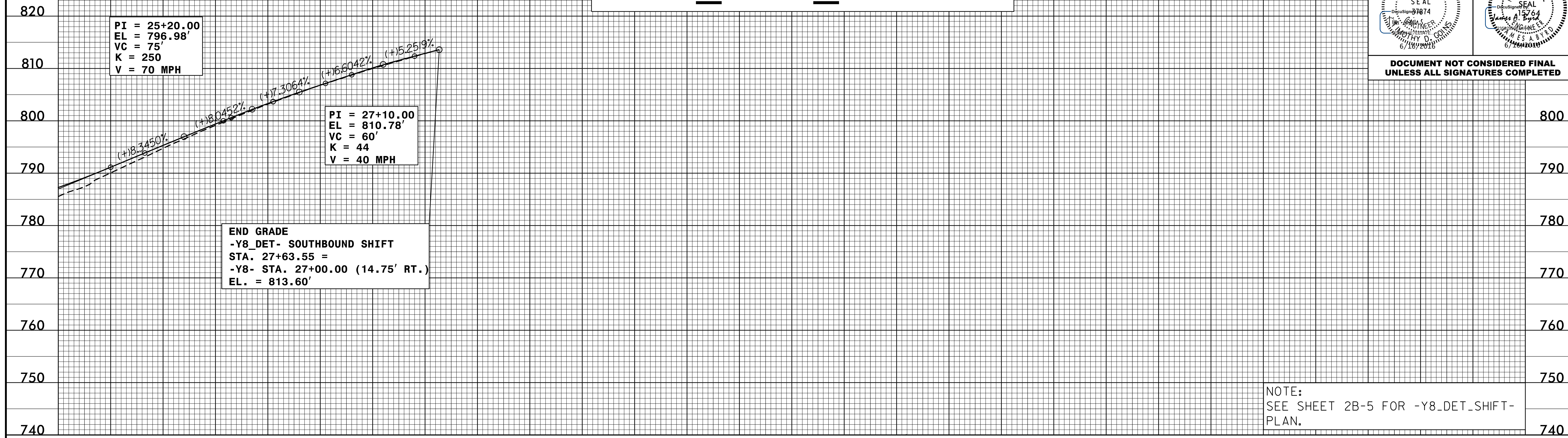

24 MAY 2016 2:35 PM
C:\Users\jgibson\Documents\Projects\U2524D\RDY_PSH_02B-7.dgn