

09/08/99

11-AUG-2016 10:44
S:\3-Guilford\I-5854_Renab\CADD\I-5854 Title.dgn
cwiles AT D7CADD271375

TIP PROJECT: I-5854

CONTRACT: C203872

VICINITY

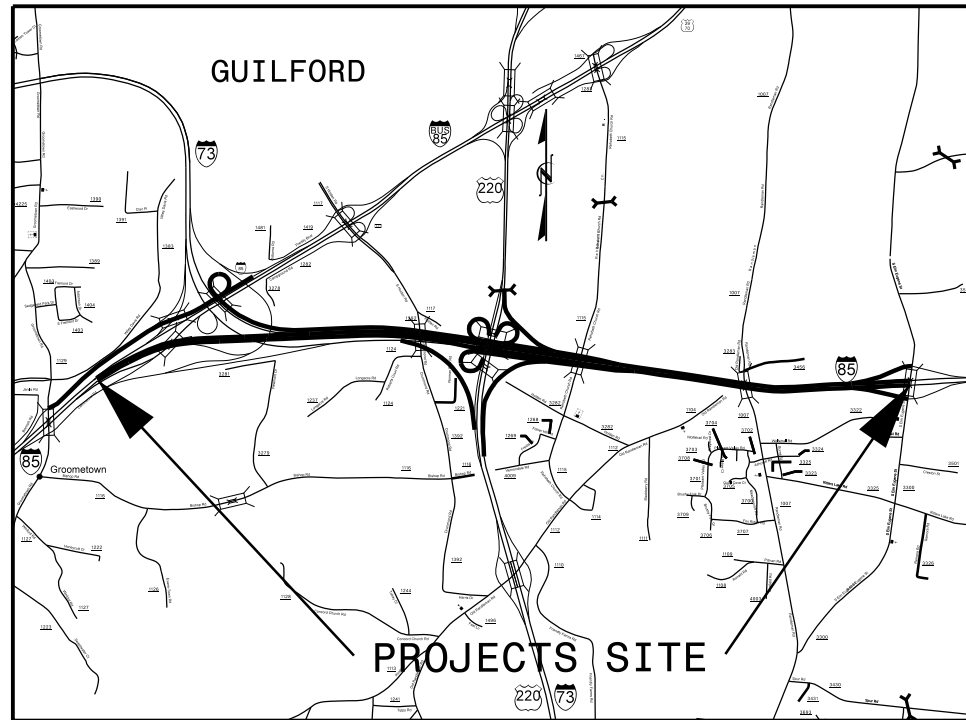

STATE OF NORTH CAROLINA
DIVISION OF HIGHWAYS

GUILFORD COUNTY

LOCATION: I-85 FROM 0.3 MILE NORTH OF BUSINESS
85 TO SR 3300 (SOUTH ELM EUGENE
STREET) IN GREENSBORO

TYPE OF WORK: PAVEMENT REHABILITATION

STATE	STATE PROJECT REFERENCE NO.	SHEET NO.	TOTAL SHEETS
N.C.	I-5854	1	
STATE PROJ. NO.	F.A. PROJ. NO.	DESCRIPTION	
53058.1.1	NHPIM-0085(9)123	PE	
53058.3.1	NHPIM-0085(9)123	CONST	

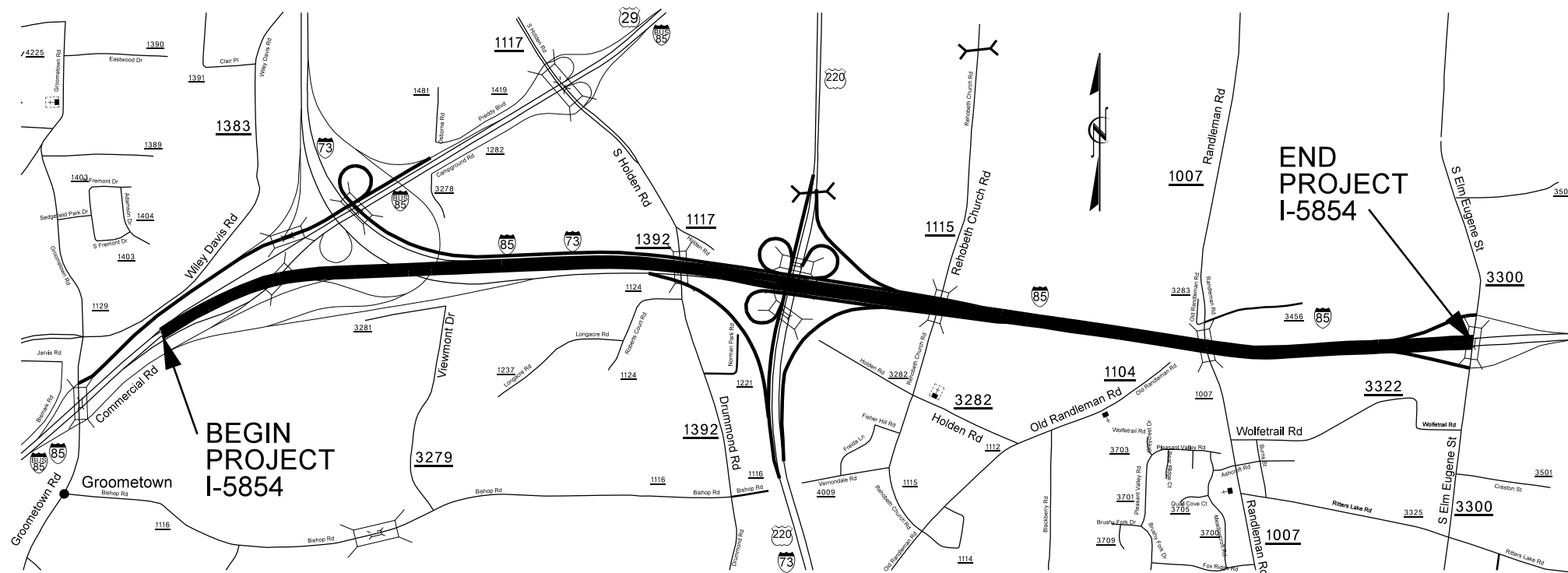

GRAPHIC SCALES

NOT TO SCALE

DESIGN DATA

NA

PROJECT LENGTH

I-5854 = 3.713 miles

Prepared In the Office of:
DIVISION OF HIGHWAYS

1584 Yanceyville St. Greensboro NC, 27405

2012 STANDARD SPECIFICATIONS

C. B. SMITHERMAN, P.E.

PROJECT ENGINEER

CLINTON A. WILES

ENGINEERING TECHNICIAN

LETTING DATE:

September 20, 2016

