

**This electronic collection of documents is provided  
for the convenience of the user  
and is Not a Certified Document –**

**The documents contained herein were originally issued  
and sealed by the individuals whose names and license  
numbers appear on each page, on the dates appearing  
with their signature on that page.**

**This file or an individual page  
shall not be considered a certified document.**

TIP NO.	SHEET NO.
B-4490	PMP-1
Designed by: <i>Ron King</i> APPROVED: _____ <small>06607A877C4DC...</small>	
DATE: 5/13/2016	
SEAL	

**STATE OF NORTH CAROLINA  
DEPARTMENT OF TRANSPORTATION**

**PAVEMENT MARKING PLAN  
CUMBERLAND COUNTY**

**LOCATION: BRIDGES NO. 116 OVER CSX RR, NORFOLK SOUTHERN RR,  
AND HILLSBORO STREET ON NC 24/210**

**T.I.P.: B-4490**

**CONTRACT:**

**ROADWAY STANDARD DRAWING**

THE FOLLOWING ROADWAY STANDARDS AS APPEAR IN "ROADWAY STANDARD DRAWINGS" - PROJECT SERVICES UNIT - N.C. DEPARTMENT OF TRANSPORTATION - RALEIGH, N.C., DATED JANUARY 2012 ARE APPLICABLE TO THIS PROJECT AND BY REFERENCE HEREBY ARE CONSIDERED A PART OF THESE PLANS:

STD. NO.	TITLE
1205.01	PAVEMENT MARKINGS - LINE TYPES AND OFFSETS
1205.02	PAVEMENT MARKINGS - 2 LANE AND MULTILANE ROADWAYS
1205.04	PAVEMENT MARKINGS - INTERSECTIONS
1205.05	PAVEMENT MARKINGS - TURN LANES
1205.07	PAVEMENT MARKINGS - PEDESTRIAN CROSSINGS
1205.08	PAVEMENT MARKINGS - SYMBOL AND WORD MESSAGES
1205.12	PAVEMENT MARKINGS - BRIDGES
1250.01	PAVEMENT MARKER SPACING
1251.01	RAISED PAVEMENT MARKERS - TEMPORARY AND PERMANENT
1261.01	GUARDRAIL AND BARRIER DELINEATOR SPACING
1261.02	GUARDRAIL AND BARRIER DELINEATOR TYPES
1262.01	GUARDRAIL END DELINEATION

**GENERAL NOTES**

THE FOLLOWING GENERAL NOTES APPLY AT ALL TIMES FOR THE DURATION OF THE CONSTRUCTION PROJECT, EXCEPT WHEN OTHERWISE NOTED IN THE PLAN, OR DIRECTED BY THE ENGINEER.

- A) INSTALL PAVEMENT MARKINGS AND PAVEMENT MARKERS ON THE FINAL SURFACE AS FOLLOWS:
 

ROAD NAME	MARKING	MARKER
NC 24/210	THERMOPLASTIC	RAISED
CONCRETE BRIDGE DECK	COLD APPLIED PLASTIC TYPE II OR III	RAISED
- B) TIE PROPOSED PAVEMENT MARKING LINES TO EXISTING PAVEMENT MARKING LINES.
- C) REMOVE/REPLACE ANY CONFLICTING/DAMAGED PAVEMENT MARKINGS AND MARKERS.
- D) REMOVE ALL RESIDUE AND SURFACE LAITANCE BY ACCEPTABLE METHODS ON THE BRIDGE DECK(S) PRIOR TO PLACING COLD APPLIED PLASTIC PAVEMENT MARKING.
- E) TYPE III COLD APPLIED PLASTIC MAY BE USED IN LIEU OF TYPE II COLD APPLIED PLASTIC. IF TYPE III COLD APPLIED PLASTIC IS USED, IT SHALL BE PAID FOR USING THE TYPE II COLD APPLIED PLASTIC PAY ITEM.

**PAVEMENT MARKING SCHEDULE**

SYMBOL	DESCRIPTION
CC	10FT. WHITE SKIP (4")
CD	3 FT. - 9 FT./SP WHITE MINISKIP(4")
T8	THERMO 2 FT. - 6 FT. WHITE MINISKIP(4", 120 MIL)
T2	THERMO WHITE STOPBAR(24", 120 MIL)
T3	THERMO WHITE CROSSWALK LINE (24", 120 MIL)
TA	WHITE EDGELINE (4", 90 MIL)
TC	10 FT WHITE SKIP(4", 120 MIL)
TD	3 FT - 9 FT/SP WHITE MINISKIP(4", 120 MIL)
TE	WHITE SOLID LANE LINE (4", 120 MIL)
TI	YELLOW DOUBLE CENTER (4", 120 MIL)
TN	WHITE DIAGONAL(8", 90 MIL)
UA	LEFT TURN ARROW ( 90 MIL)
UB	RIGHT TURN ARROW ( 90 MIL)
UC	STRAIGHT ARROW (90 MIL)
UE	COMBO. STRIGHT/RIGHT (90 MIL)

**PLAN PREPARED BY: N.C.D.O.T. SIGNING AND DELINEATION UNIT**

Ronald W. King, PE, \_\_\_\_\_ SIGNING & DELINEATION REGIONAL ENGINEER  
BARRY NOWLIN \_\_\_\_\_ SIGNING & DELINEATION PROJECT DESIGN TECHNICIAN

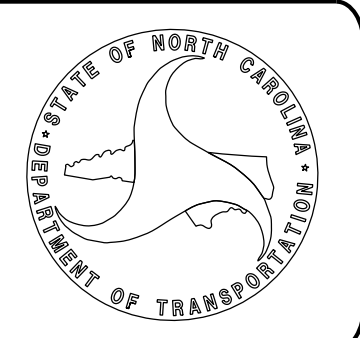

**INDEX**

SHEET NO.	DESCRIPTION
PMP-1	PAVEMENT MARKING PLAN TITLE SHEET
PMP-2	CROSSWALK PAVEMENT MARKING GUIDANCE DETAIL
PMP-3-4	PAVEMENT MARKING DETAIL

I:\MAY-2016\_10\40  
 B:\TIP-Projects\B-4490\TIP-offrnc\Signing\CADD\PM\New\TIP TITLE SHEET\B-4490\_sgn\_Seal\_PMP.dgn  
 AT TE274922  
 meaton

UNLESS OTHERWISE SPECIFIED,  
HI-VISIBILITY CROSSWALK  
MARKINGS SHALL BE USED AT  
MID-BLOCK CROSSINGS

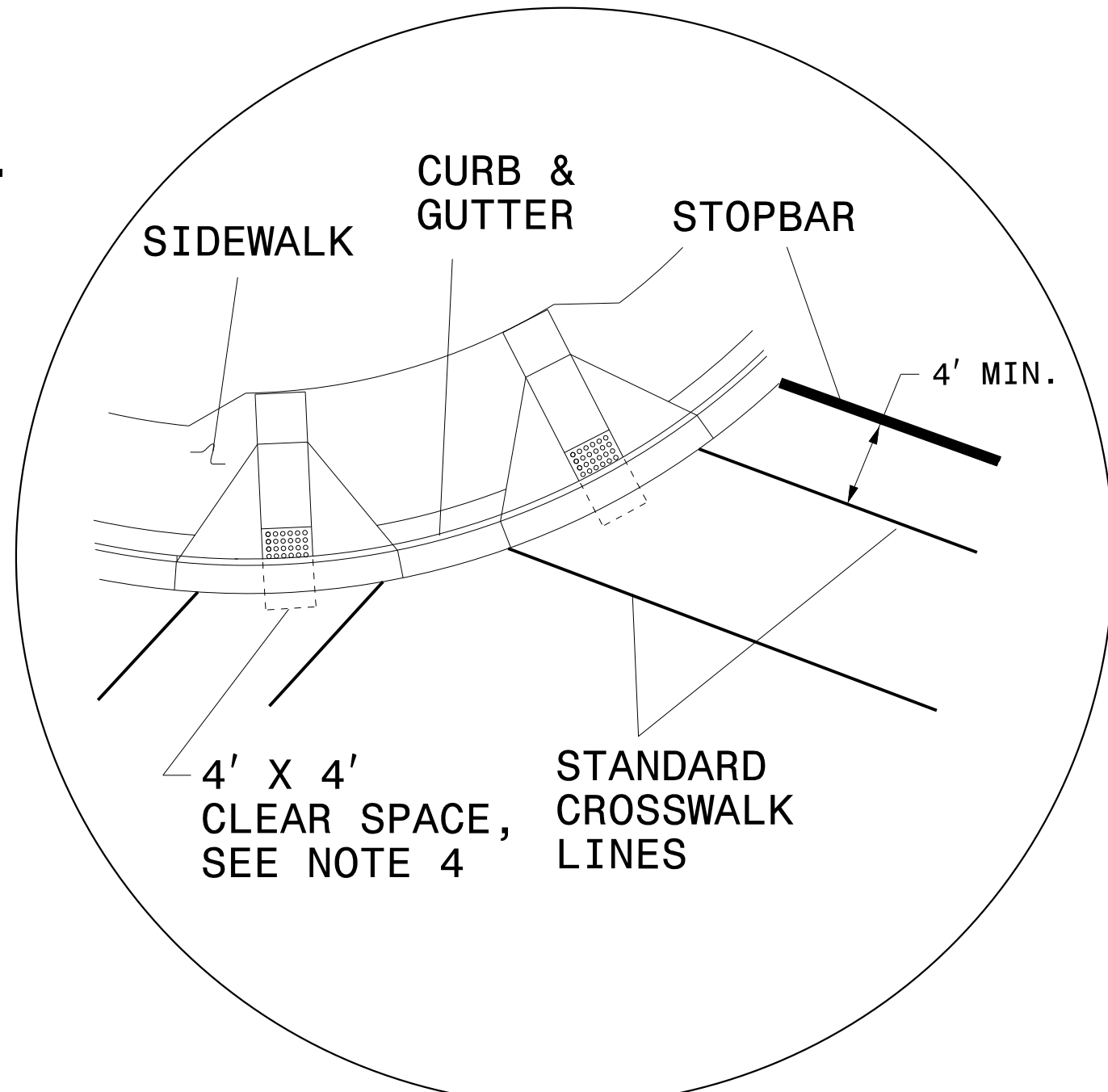
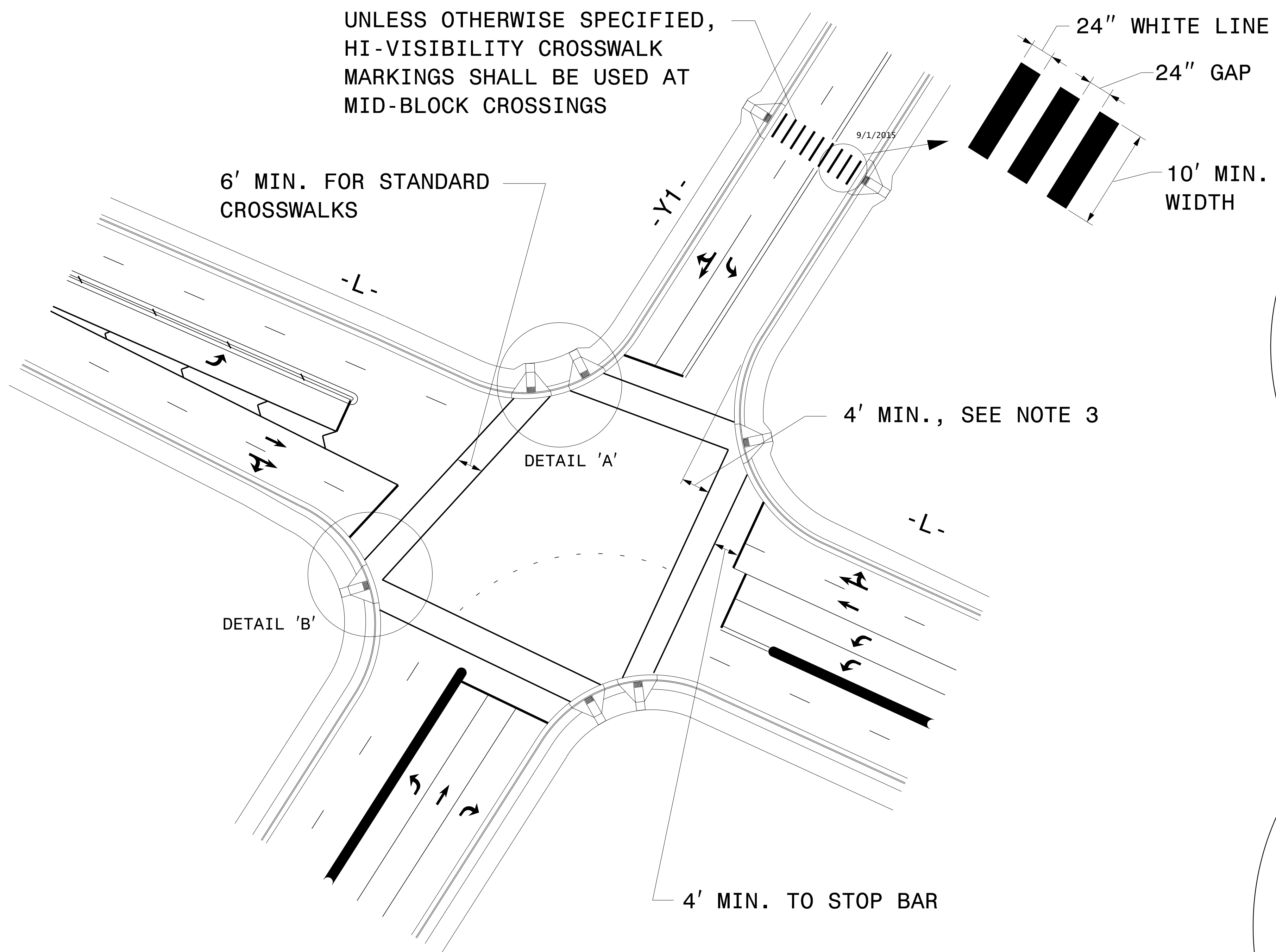

DETAIL 'A'- DUAL CURB RAMPS

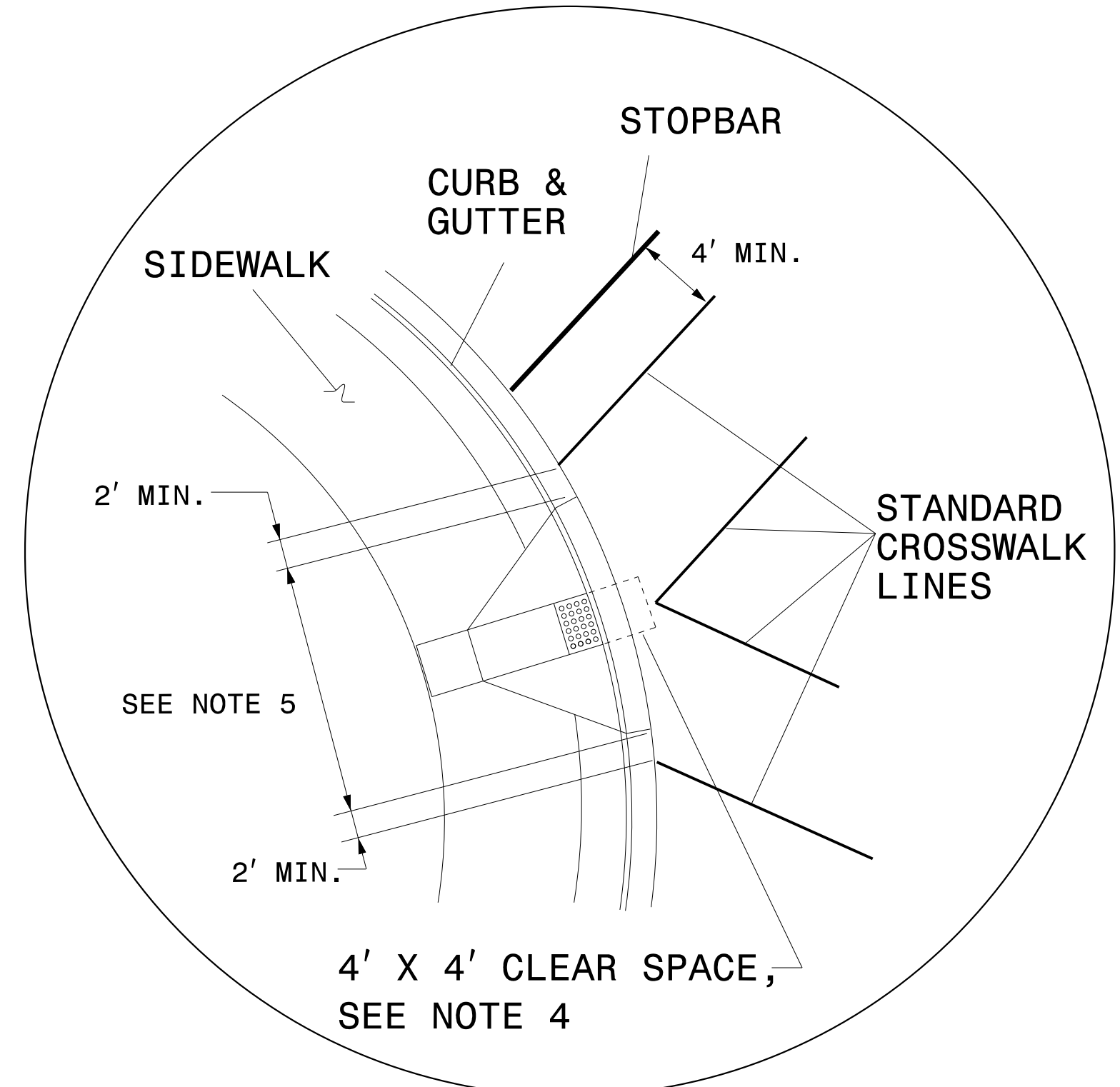

DETAIL 'B'- SINGLE DIAGONAL CURB RAMP

**GUIDANCE DETAIL FOR CROSSWALK MARKINGS**

**NOTES:**

1. USE THE DETAILS ABOVE AND THE FOLLOWING NOTES FOR GUIDANCE IN PLACING CROSSWALK MARKINGS NOT STATIONED ON THE DETAIL SHEETS OR WHEN FIELD ADJUSTMENTS REQUIRED MOVING STATIONED MARKINGS AS DIRECTED BY THE ENGINEER. REFER TO NCDOT ROADWAY STANDARD DRAWINGS, MUTCD AND ADA STANDARDS FOR ADDITIONAL GUIDANCE.
2. THE CROSSWALK MARKINGS SHOWN ON THE ABOVE DETAILS ARE FOR REFERENCE ONLY. ONLY INSTALL CROSSWALK MARKINGS WHERE SHOWN ON THE DETAIL SHEETS OR AS DIRECTED BY THE ENGINEER. THE CROSSWALK MARKING TYPE, STANDARD OR HI-VISIBILITY, SHALL BE INSTALL AS SPECIFIED ON THE DETAIL SHEETS OR AS DIRECTED BY THE ENGINEER.
3. SET BACK DISTANCE FROM INSIDE CROSSWALK MARKING TO NEAREST EDGE OF TRAVEL IS 4' MIN.
4. BEYOND THE BOTTOM GRADE BRAKE, A CLEAR SPACE OF 4' X 4' MINIMUM SHALL BE PROVIDED WITHIN THE MARKINGS.
5. SINGLE DIAGONAL CURB RAMPS WITH FLARED SIDES SHALL HAVE A SEGMENT OF CURB 2 FEET LONG MINIMUM LOCATED ON EACH SIDE OF THE CURB RAMP AND WITHIN THE MARKED CROSSING, SEE DETAIL 'B'.
6. CURB RAMPS SHALL BE CONSTRUCTED IN ACCORDANCE TO THE LATEST NCDOT ROADWAY STANDARD DRAWINGS.

**CROSSWALK PAVEMENT MARKING  
GUIDANCE DETAIL**

8/31/2015 P:\office\Signing\CADD\PMP\B-4490\_pmp\_907.dgn\_files\B-4490\_sgn\_5eed\_PMP.dgn User: bncw111

TIP NO. B-4490	SHEET NO. PMP-3
Drawn by: <i>Ayman Alqudwa</i> F32AC5CAF985472 9/1/2015	
SEAL	

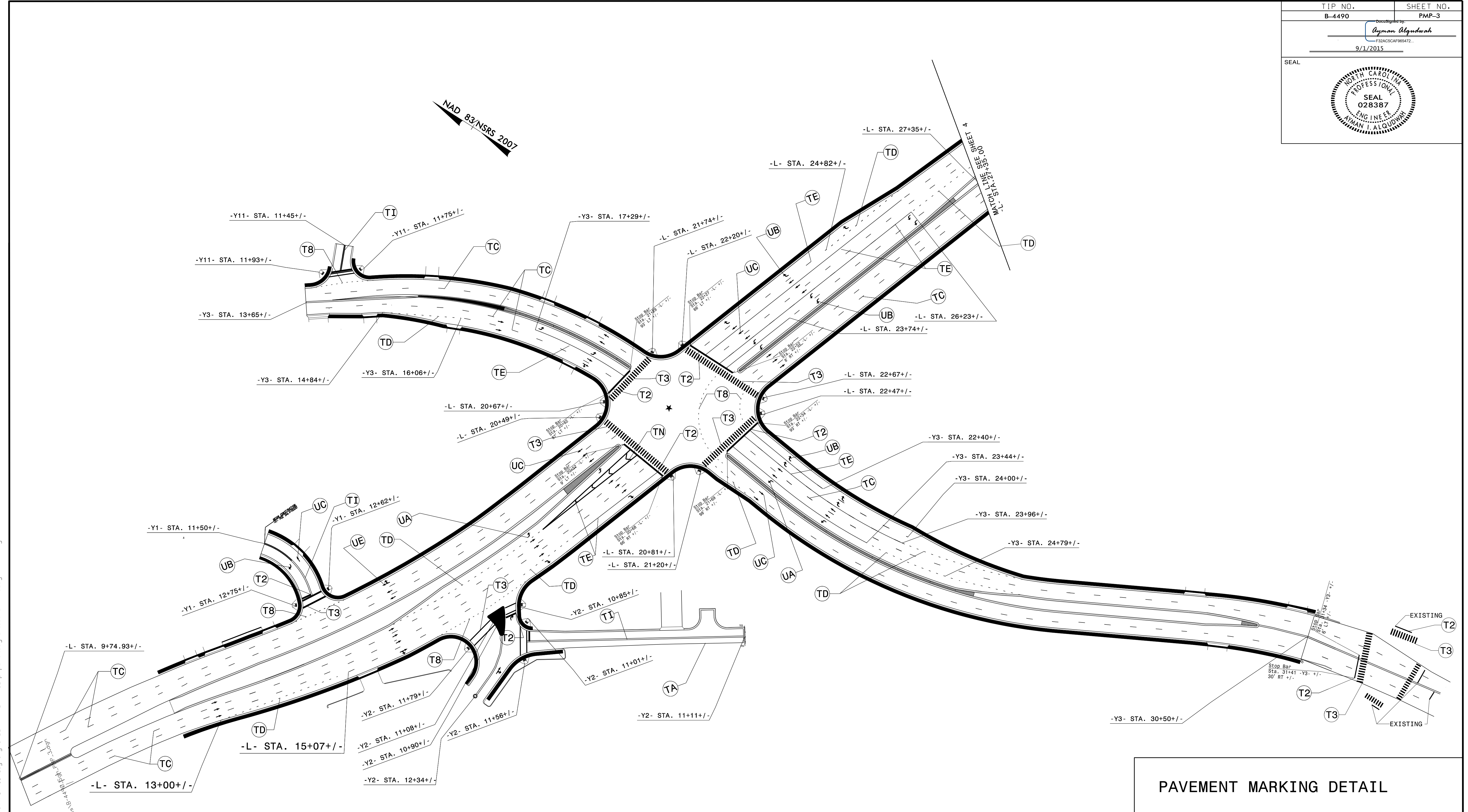

**PAVEMENT MARKING DETAIL**

R:\Traffic\Signing\CADD\PMF\B-4490\_pmp\_302.dgn, files\B-4490\_Sgn\_PMP\_3.dgn

TIP NO.	SHEET NO.
B-4490	PMP-4
APPROVED:	<i>Ayman Aljoudah</i>
DATE:	9/1/2015
SEAL	

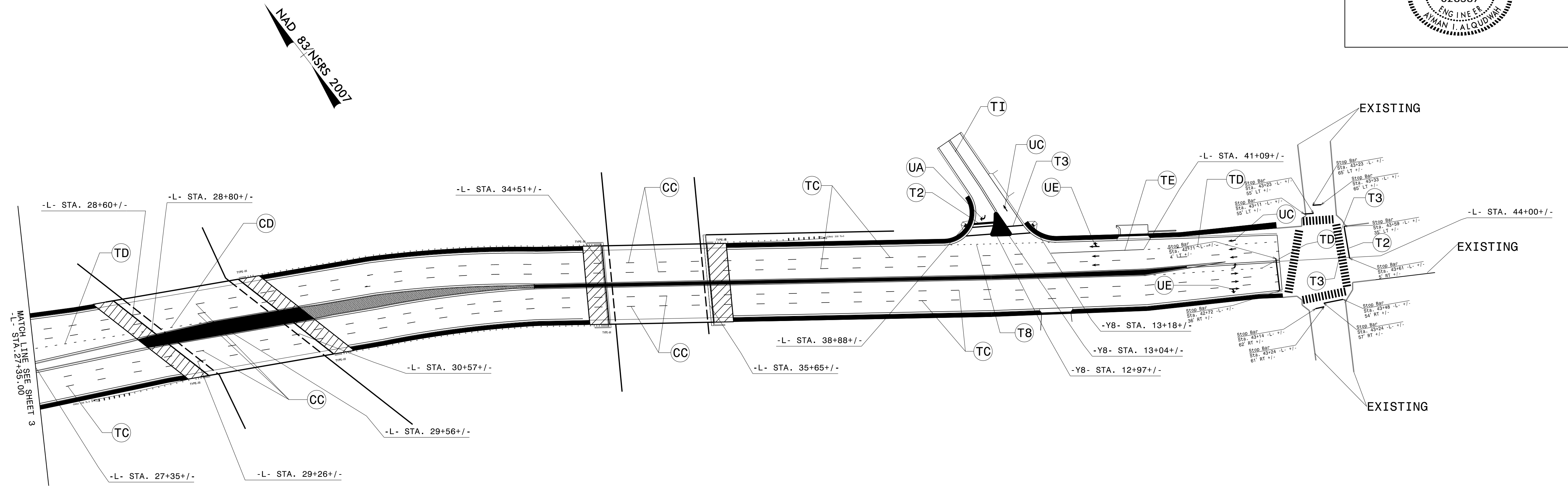

PAVEMENT MARKING DETAIL

8/31/2015  
 C:\Users\bnw\OneDrive\Documents\CADD\Projects\44430\_PMP-4.dgn  
 User:bnw