

GEOTECHNICAL ENGINEER

ENGINEER

DocuSigned by: *[Signature]* 9/25/2015

SIGNATURE DATE SIGNATURE DATE

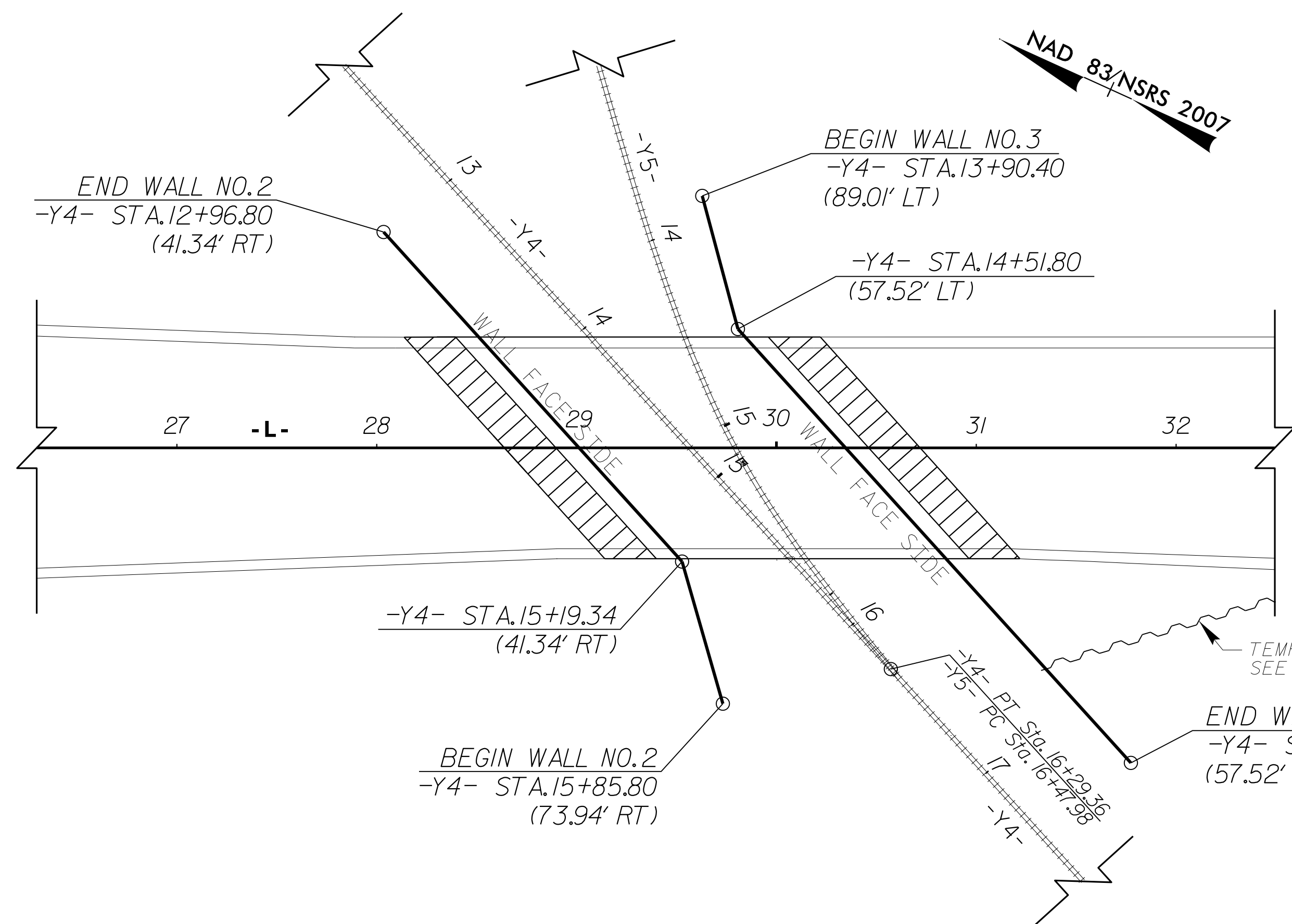

PLAN VIEW FOR RETAINING WALL NO. 2 & NO. 3
N.T.S.

ESTIMATED RETAINING WALL NO. 2 QUANTITIES	
MSE RETAINING WALL NO. 2	5,500 SF
CIP MSE RETAINING WALL NO. 2 (ALTERNATE)	

ESTIMATED RETAINING WALL NO. 3 QUANTITIES	
MSE RETAINING WALL NO. 3	8,550 SF
CIP MSE RETAINING WALL NO. 3 (ALTERNATE)	

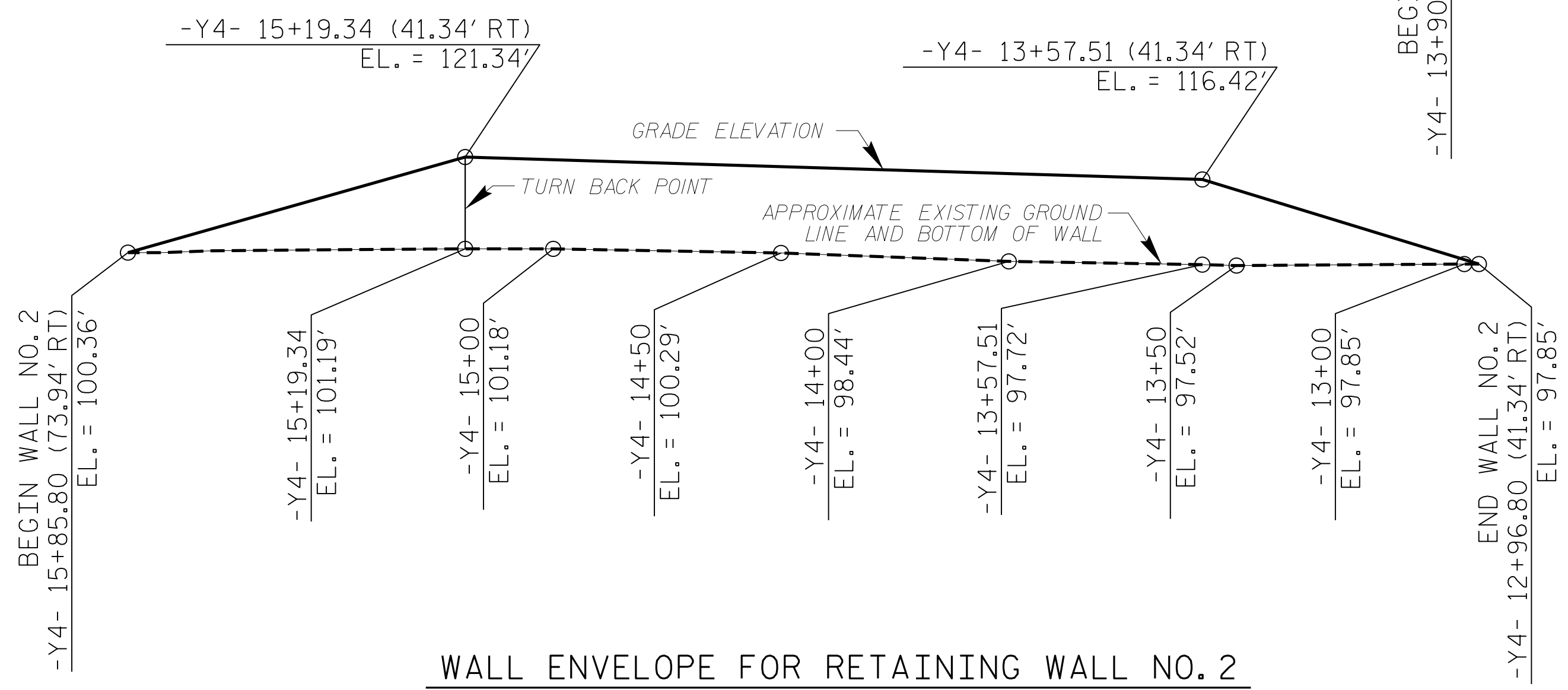

WALL ENVELOPE FOR RETAINING WALL NO. 2
EXPOSED WALL FACE VIEW, N.T.S.
THE WALL ENVELOPE DOES NOT ACCURATELY DEPICT THE ACTUAL FACE OF THE WALL

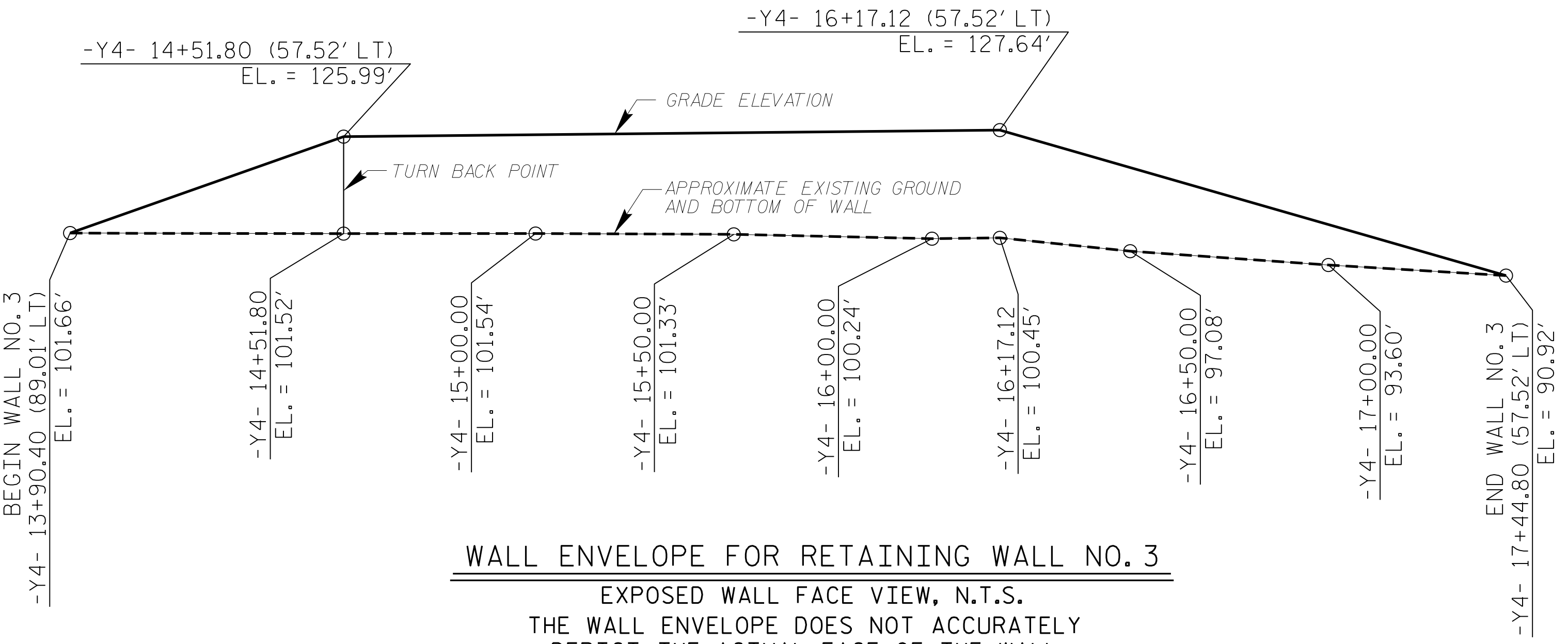

WALL ENVELOPE FOR RETAINING WALL NO. 3
EXPOSED WALL FACE VIEW, N.T.S.
THE WALL ENVELOPE DOES NOT ACCURATELY DEPICT THE ACTUAL FACE OF THE WALL

PREPARED BY: J. PARK DATE: 09 / 2015
REVIEWED BY: J. BATTS DATE: 09 / 2015

NORTH CAROLINA
DEPARTMENT OF TRANSPORTATION
DIVISION OF HIGHWAYS

**GEOTECHNICAL
ENGINEERING UNIT**

PROJECT NO.: B-4490 (33727.1.1)
CUMBERLAND COUNTY
STATION: 12+97.00 -Y4- / 13+91.00 -Y4-
SHEET 3 OF 11

REVISIONS						
NO.	BY	DATE	NO.	BY	DATE	SHEET NO.
1	-	3	-	-	-	W-3
2	-	4	-	-	-	