

PHASING DIAGRAM

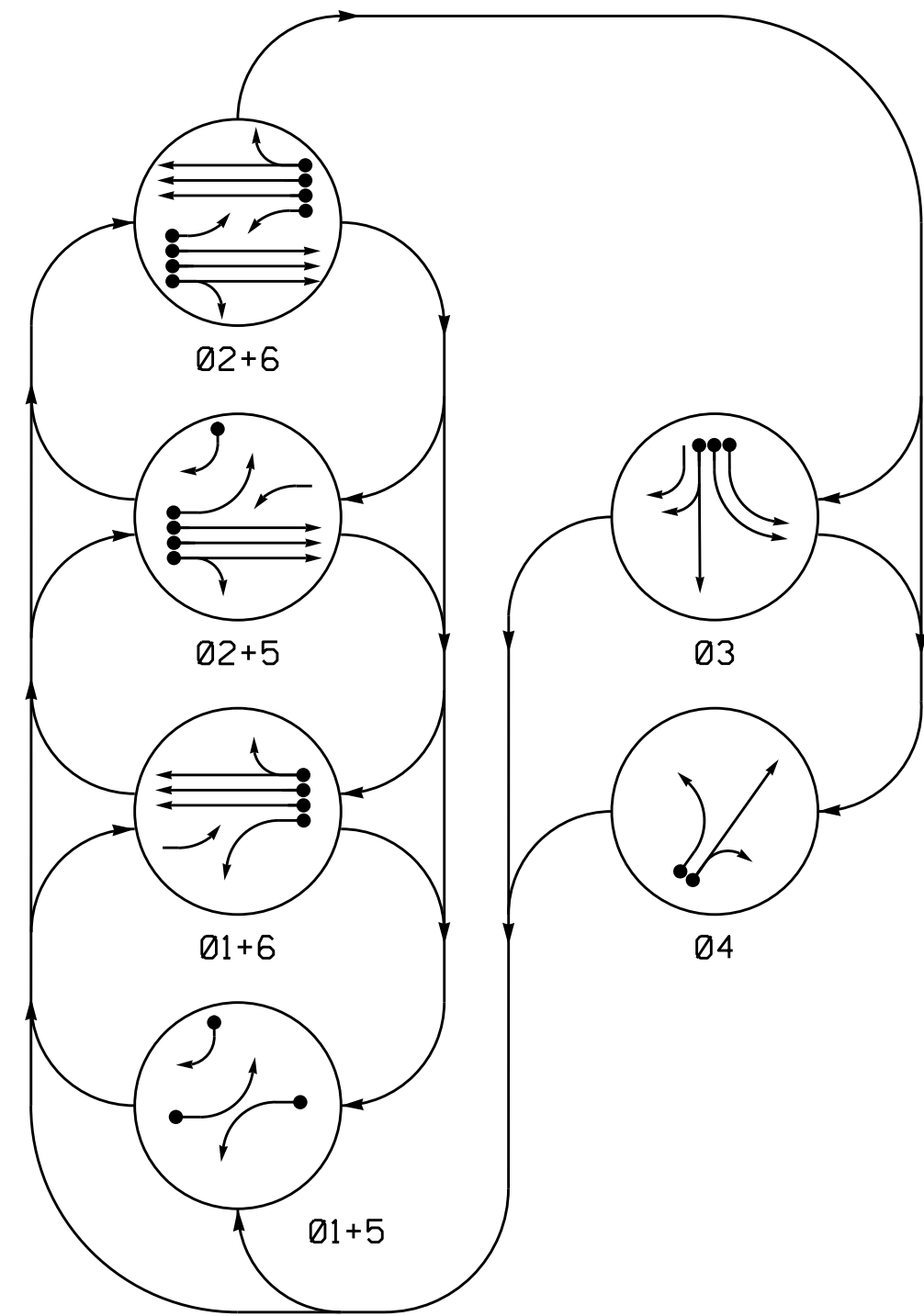

PHASING DIAGRAM DETECTION LEGEND

- ←●→ DETECTED MOVEMENT
- ←○→ UNDETECTED MOVEMENT (OVERLAP)
- ←- - -→ UNSIGNALIZED MOVEMENT
- ←- - -> PEDESTRIAN MOVEMENT

SIGNAL FACE	PHASE					
	01+5	01+6	02+5	02+6	03	04
11	←	←	←	←	←	←
21,22	R	R	G	G	R	R
31,32	R	R	R	R	←	←
33	R	R	R	R	G	R
34	R	R	R	R	G	R
41	R	R	R	R	R	G
42	R	R	R	R	R	G
51	←	←	←	←	←	←
61,62	R	G	R	G	R	Y

SIGNAL FACE I.D.

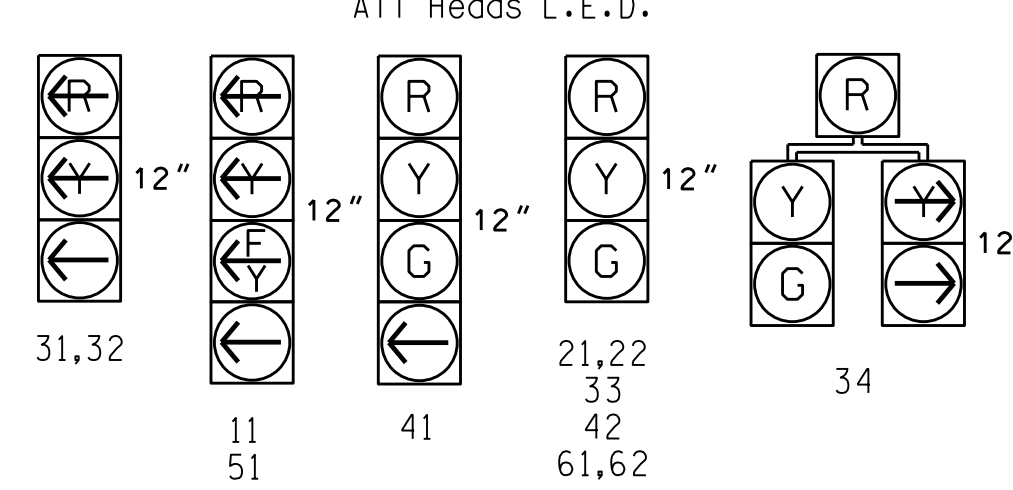

OASIS 2070 LOOP & DETECTOR INSTALLATION CHART											
LOOP	SIZE (FT)	DISTANCE FROM STOPBAR (FT)	TURNS	NEW LOOP	DETECTOR PROGRAMMING			STRETCH TIME	DELAY TIME	SYSTEM LOOP	NEW CARD
					PHASE	CALLING	EXTENSION				
1A	6x40	0	2-4-2	Y	1	Y	Y	-	15	-	-
2A	6x6	70	4	-	2	Y	Y	-	-	-	-
2B	6x6	70	4	-	2	Y	Y	-	-	-	-
2C	6x6	70	4	-	2	Y	Y	-	-	-	-
3A	6x40	0	2-4-2	Y	3	Y	Y	-	3	-	-
3B	6x40	0	2-4-2	Y	3	Y	Y	-	3	-	-
3C	6x40	0	2-4-2	Y	3	Y	Y	-	10	-	-
4A	6x60	0	2-4-2	-	4	Y	Y	-	3	-	-
4B	6x60	0	2-4-2	-	4	Y	Y	-	10	-	-
5A	6x60	0	2-4-2	-	5	Y	Y	-	15	-	-
5B	6x40	0	2-4-2	Y	5	Y	Y	-	-	-	-
6A,B,C	6x6	70	4	Y	6	Y	Y	-	-	-	-

6 Phase Fully Actuated Fayetteville Signal System

NOTES

- Refer to "Roadway Standard Drawings NCDOT" dated January 2012 and "Standard Specifications for Roads and Structures" dated January 2012.
- Do not program signal for late night flashing operation unless otherwise directed by the Engineer.
- Phase 1 and/or phase 5 may be lagged.
- The order of phase 3 and phase 4 may be reversed.
- Set all detector units to presence mode.
- Maximum times shown in timing chart are for free-run operation only. Coordinated signal system timing values supersede these values.

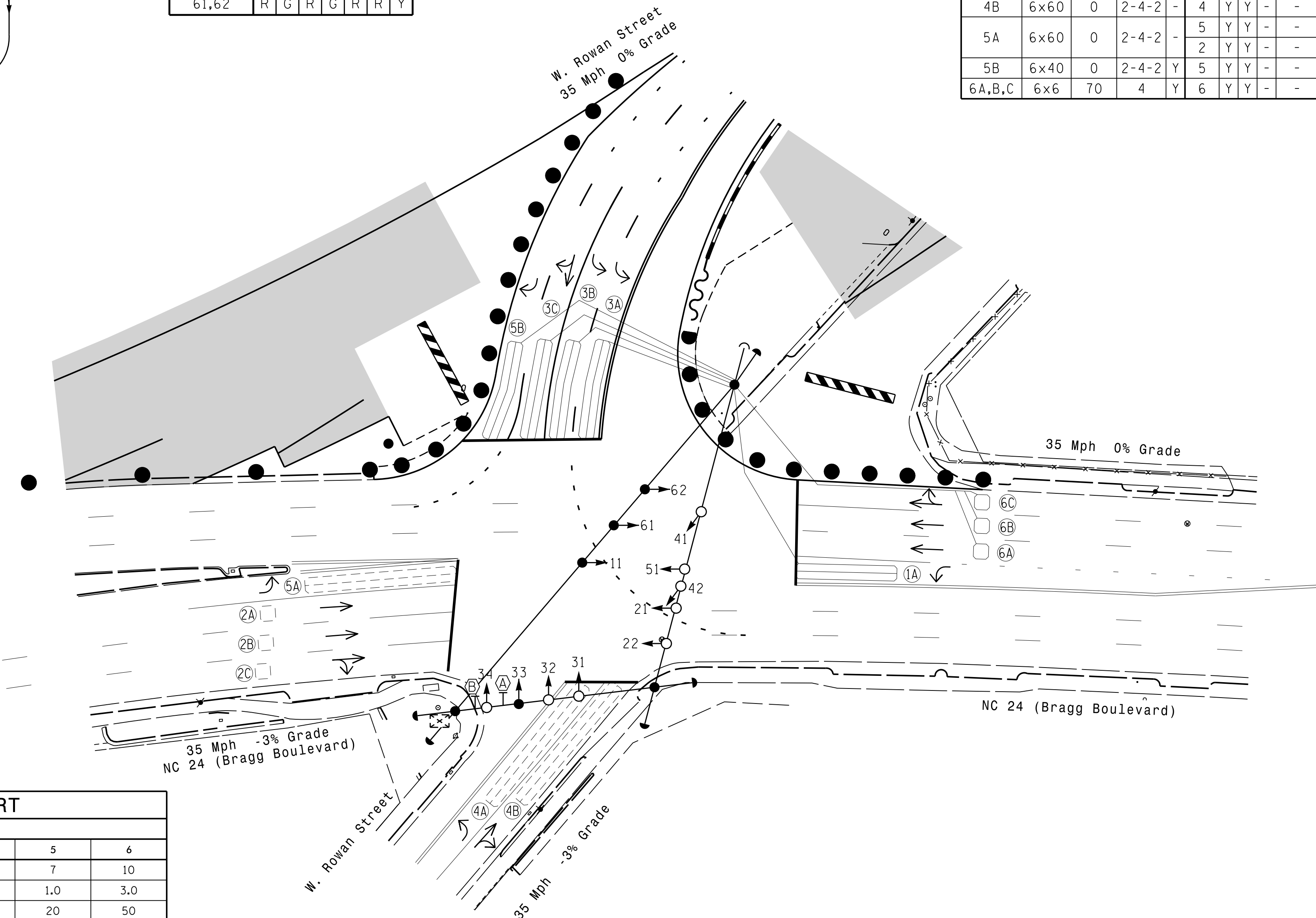

LEGEND

- | PROPOSED | EXISTING |
|----------|----------|
| ○→ | ●→ |
| ○→ | N/A |
| ⊥ | ⊥ |
| ⊥ | ⊥ |
| ○→ | ○→ |
| ○→ | ○→ |
| ⊗ | ⊗ |
| □ | □ |
| ⊔ | ⊔ |
| N/A | N/A |
| → | → |
| ⊗ | ⊗ |
| ⊗ | ⊗ |

FEATURE	PHASE					
	1	2	3	4	5	6
Min Green 1 *	7	10	7	7	7	10
Extension 1	1.0	3.0	2.0	1.0	1.0	3.0
Max Green 1 *	20	50	30	30	20	50
Yellow Clearance	3.0	4.1	3.8	4.1	3.0	4.1
Red Clearance	3.3	2.9	2.3	2.2	2.4	2.9
Walk 1 *	-	-	-	-	-	-
Don't Walk 1	-	-	-	-	-	-
Seconds Per Actuation *	-	-	-	-	-	-
Max Variable Initial *	-	-	-	-	-	-
Time Before Reduction *	-	-	-	-	-	-
Time To Reduce *	-	-	-	-	-	-
Minimum Gap	-	-	-	-	-	-
Recall Mode	-	MIN RECALL	-	-	-	MIN RECALL
Vehicle Call Memory	-	YELLOW	-	-	-	YELLOW
Dual Entry	-	-	-	-	-	-
Simultaneous Gap	ON	ON	ON	ON	ON	ON

* These values may be field adjusted. Do not adjust Min Green and Extension times for phases 2 and 6 lower than what is shown. Min Green for all other phases should not be lower than 4 seconds.

Signal Upgrade - Temp 2 Phase 1 Steps 6-8

750 N. Greenfield Pkwy, Garner, NC 27529

NC 24 (Bragg Boulevard) at West Rowan Street

Division 6 Cumberland County Fayetteville

PLAN DATE: July 2015 REVIEWED BY: JPG

PREPARED BY: Jeff Spence REVIEWED BY:

SEAL

NORTH CAROLINA PROFESSIONAL ENGINEER

JASON P. GALLAWAY

SEAL 029904

8/25/2015

SIGNATURE DATE

SIG. INVENTORY NO. 06-0037 T2

27-AUG-2015 08:53
 R:\Projects\2015\06-0037\Signal\06-0037.dgn
 J:\011\cmcy