

PROJECT REFERENCE NO.	SHEET NO.
B-4490	EC-29/CONST.10
RW SHEET NO.	
ROADWAY DESIGN ENGINEER	HYDRAULICS ENGINEER

8/17/99
 31-AUG-2015 15:54
 I:\Projects\102\B4490-EC.psh.10.dgn
 BENVENISTE

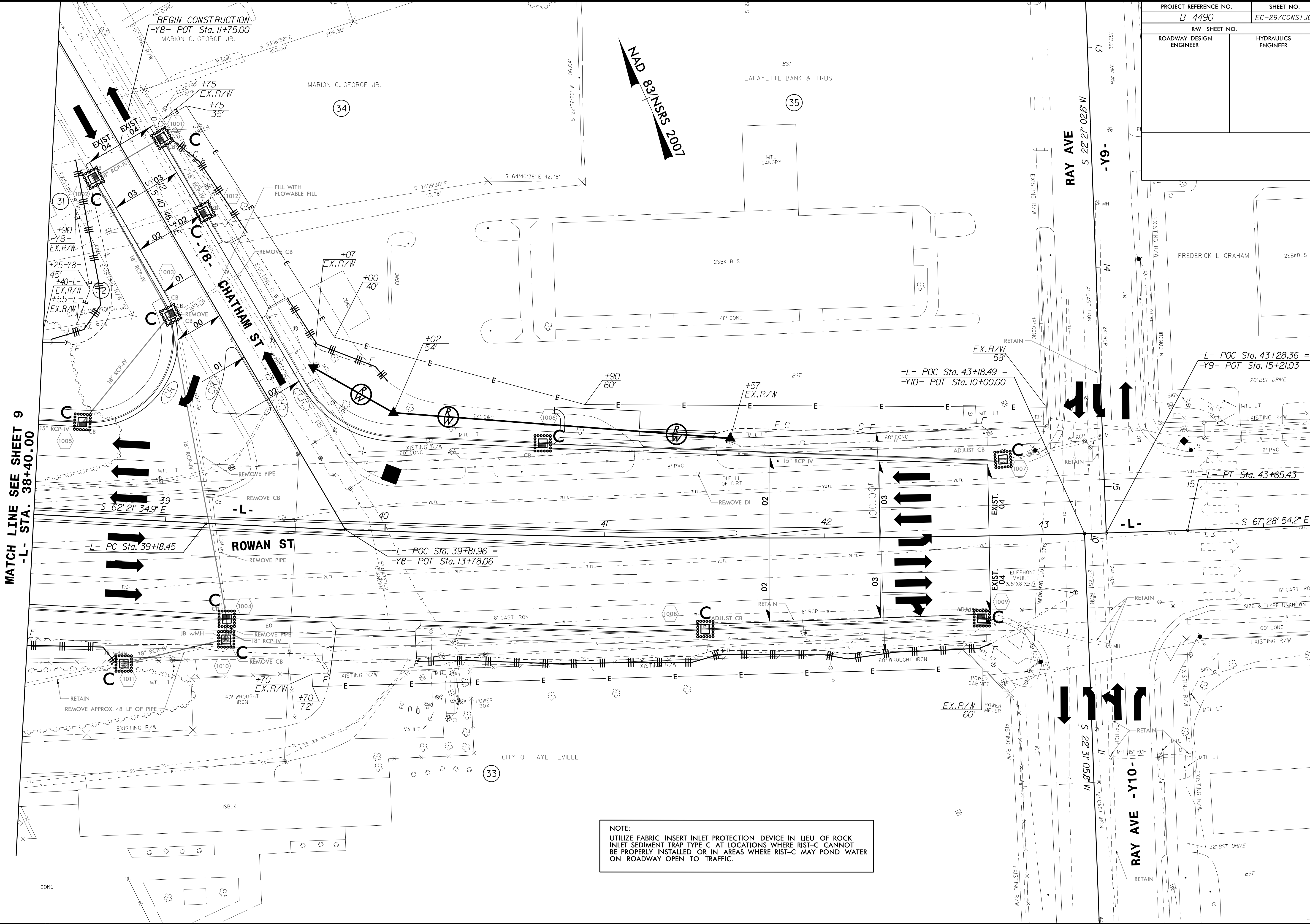

MATCH LINE SEE SHEET 9
 -L- STA. 38+40.00

NOTE:
 UTILIZE FABRIC INSERT INLET PROTECTION DEVICE IN LIEU OF ROCK INLET SEDIMENT TRAP TYPE C AT LOCATIONS WHERE RIST-C CANNOT BE PROPERLY INSTALLED OR IN AREAS WHERE RIST-C MAY POND WATER ON ROADWAY OPEN TO TRAFFIC.