

**This electronic collection of documents is provided  
for the convenience of the user  
and is Not a Certified Document –**

**The documents contained herein were originally issued  
and sealed by the individuals whose names and license  
numbers appear on each page, on the dates appearing  
with their signature on that page.**

**This file or an individual page  
shall not be considered a certified document.**

PROJECT NO.	SHEET NO.	TOTAL SHEETS
2017CPT.13.07.11001, 2017CPT.13.07.21001 2017CPT.13.07.21002	1	

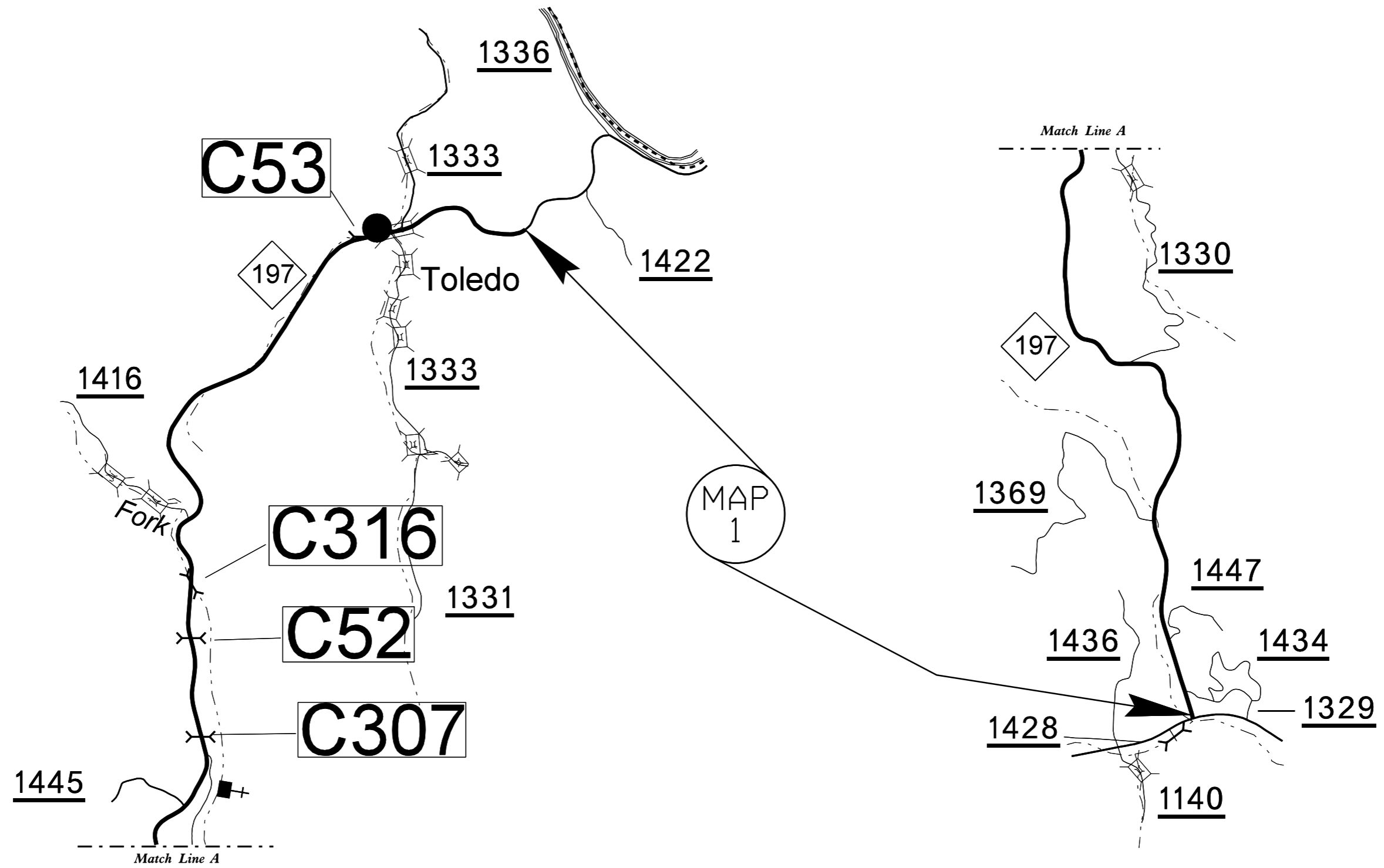

**YANCEY COUNTY**

PROJECT NO.	SHEET NO.	TOTAL SHEETS
2017CPT.13.07.11001, 2017CPT.13.07.21001 2017CPT.13.07.21002	2	

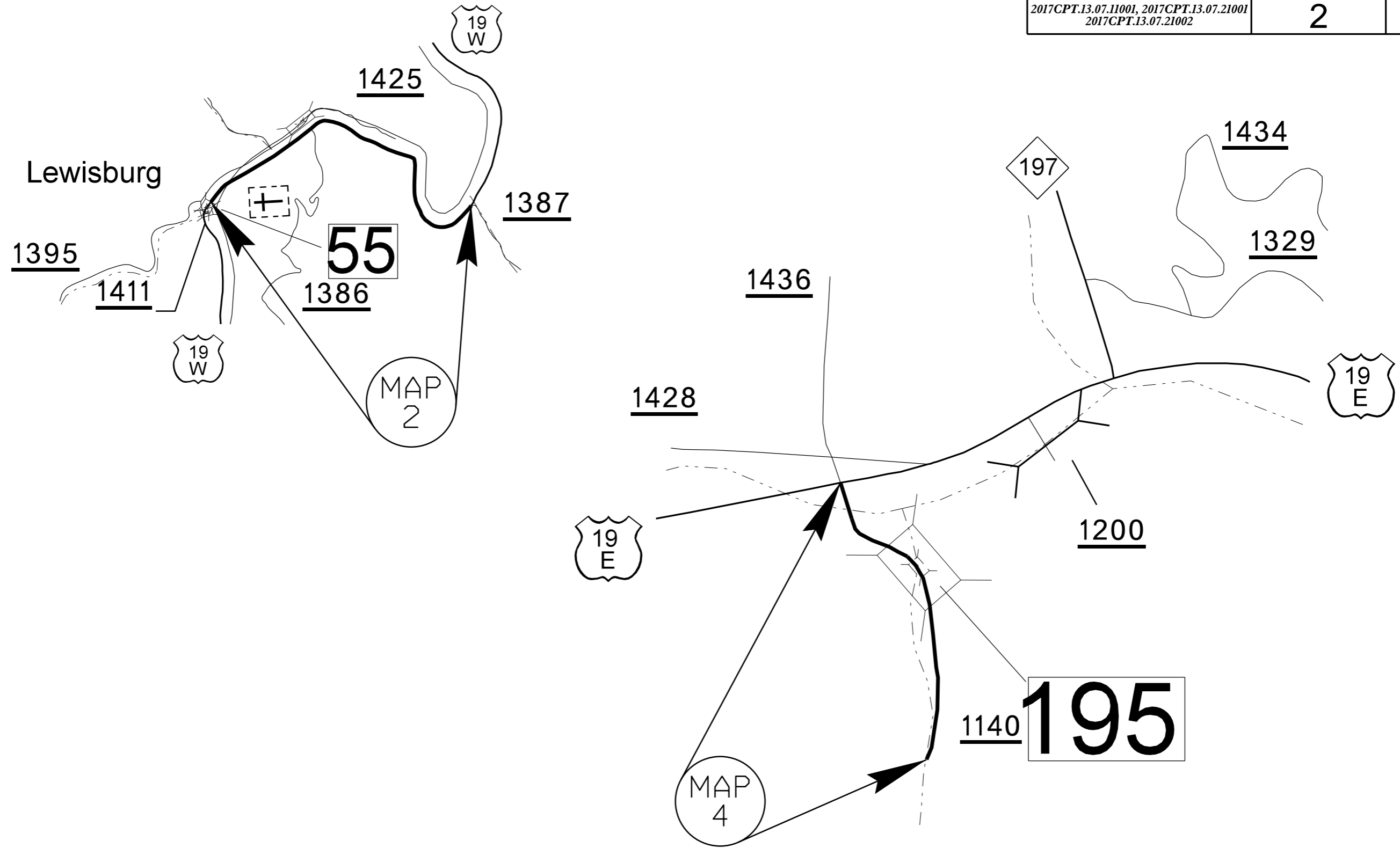

**YANCEY COUNTY**

PROJECT NO.	SHEET NO.	TOTAL SHEETS
2017CPT.13.07.11001, 2017CPT.13.07.21001 2017CPT.13.07.21002	3	

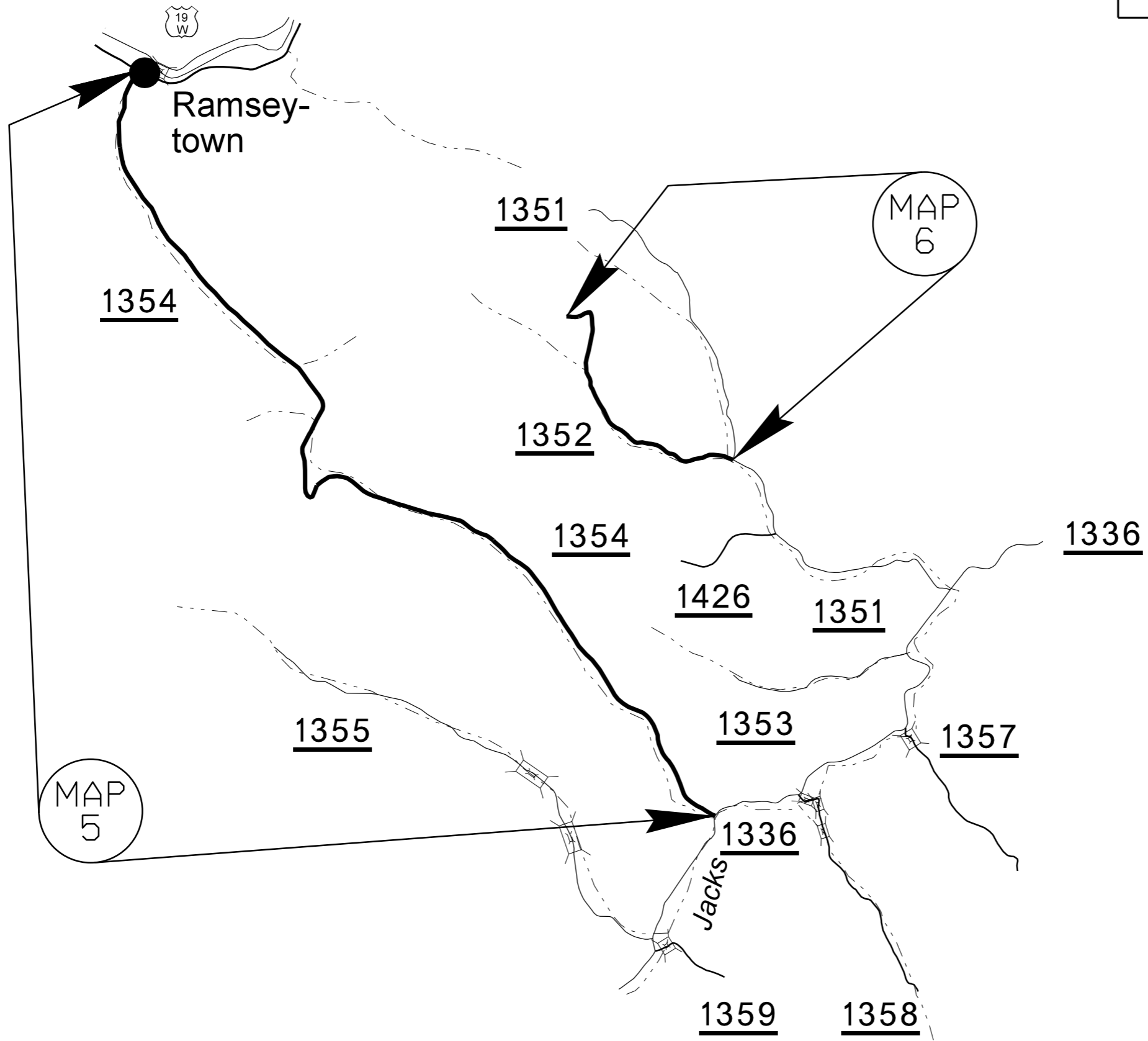

**YANCEY COUNTY**

PROJECT NO.	SHEET NO.	TOTAL SHEETS
2017CPT.13.07.11001, 2017CPT.13.07.21001 2017CPT.13.07.21002	4	

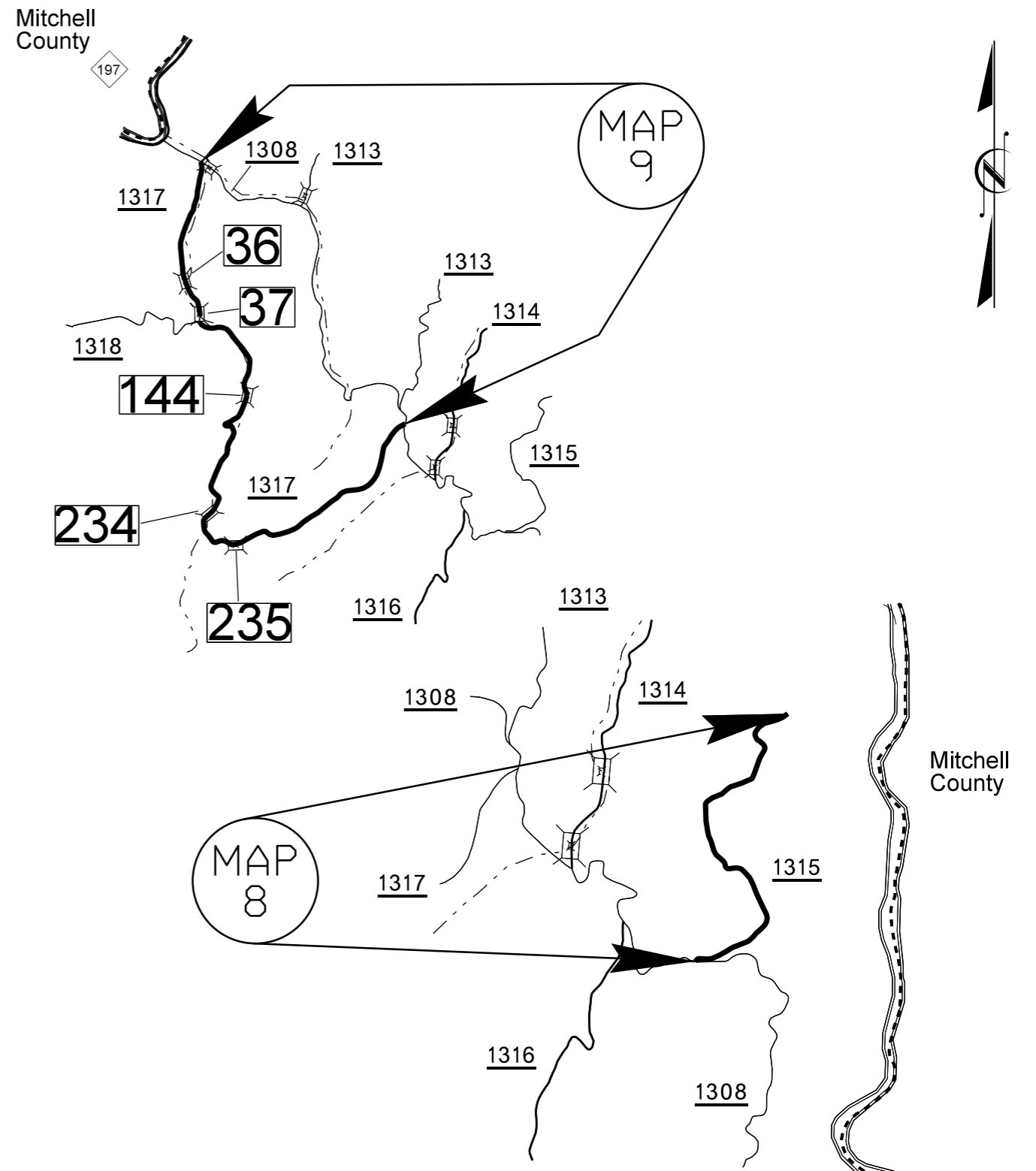
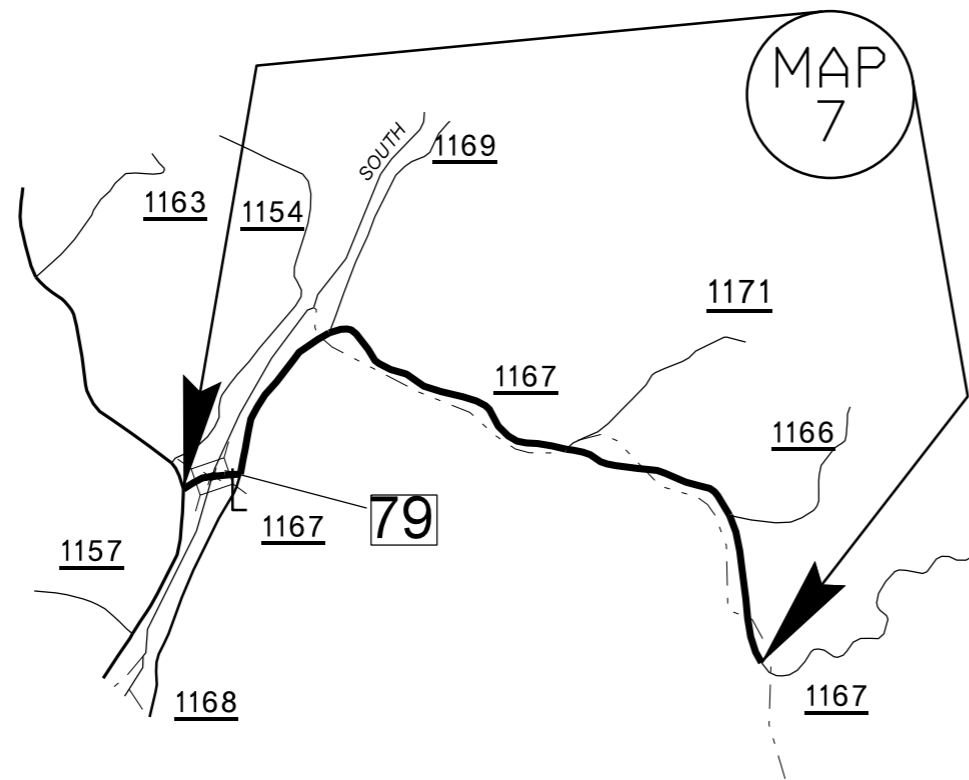
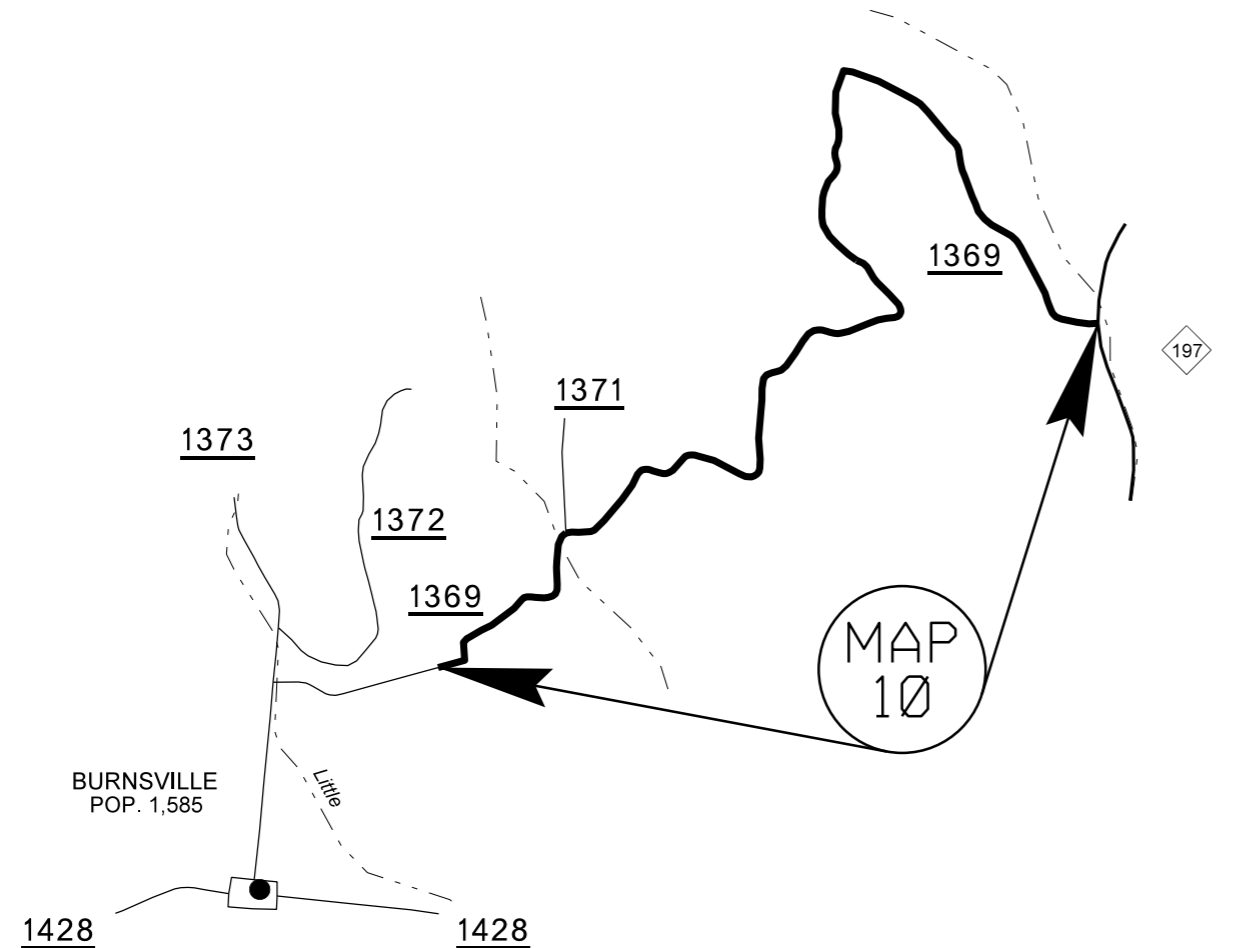

**YANCEY COUNTY**

PROJECT NO.	SHEET NO.	TOTAL SHEETS
2017CPT.13.07.11001, 2017CPT.13.07.21001 2017CPT.13.07.21002	5	

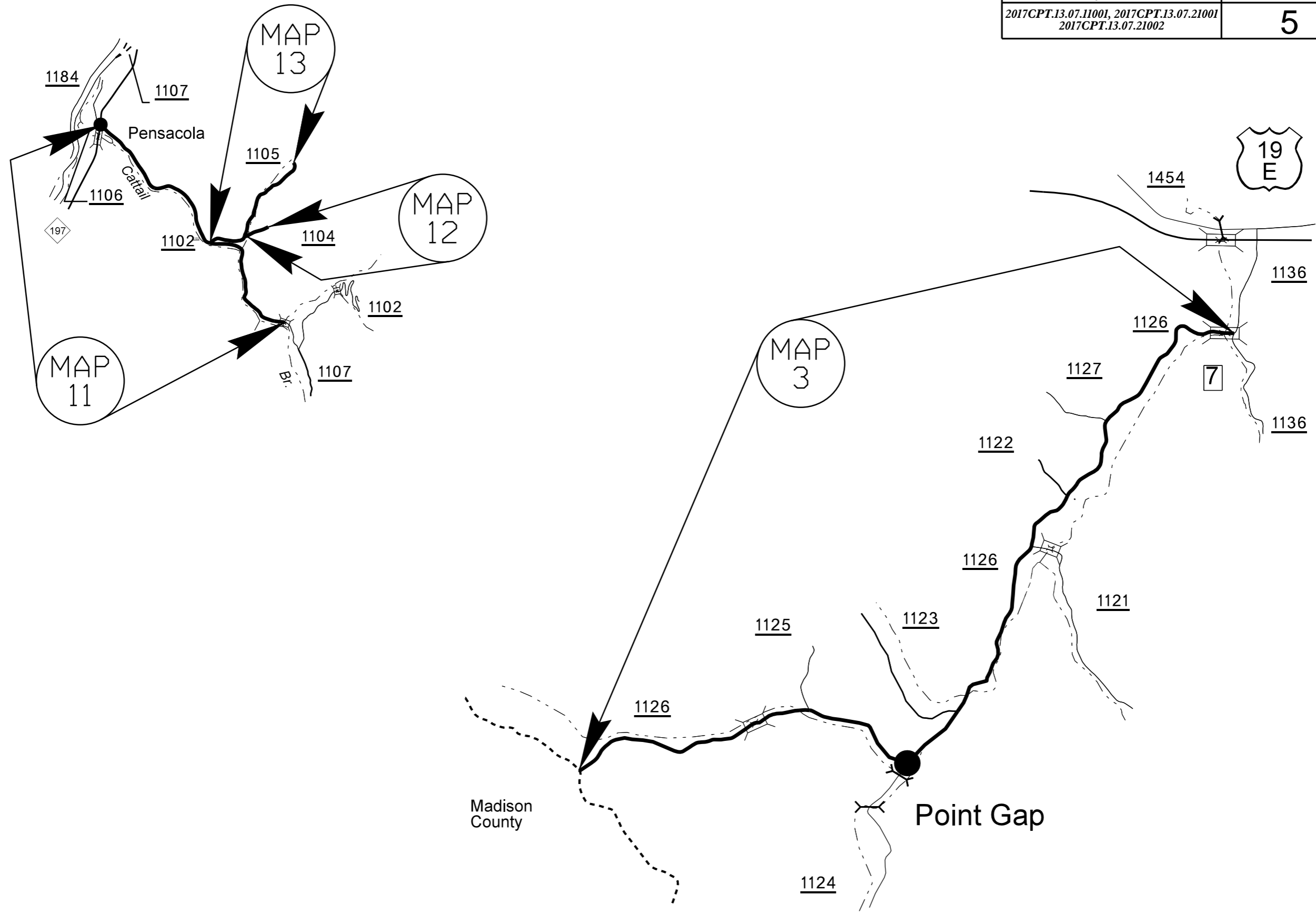

**YANCEY COUNTY**

PROJECT NO.	SHEET NO.	TOTAL SHEETS
2017CPT.13.07.11001, 2017CPT.13.07.21001 2017CPT.13.07.21002	6	

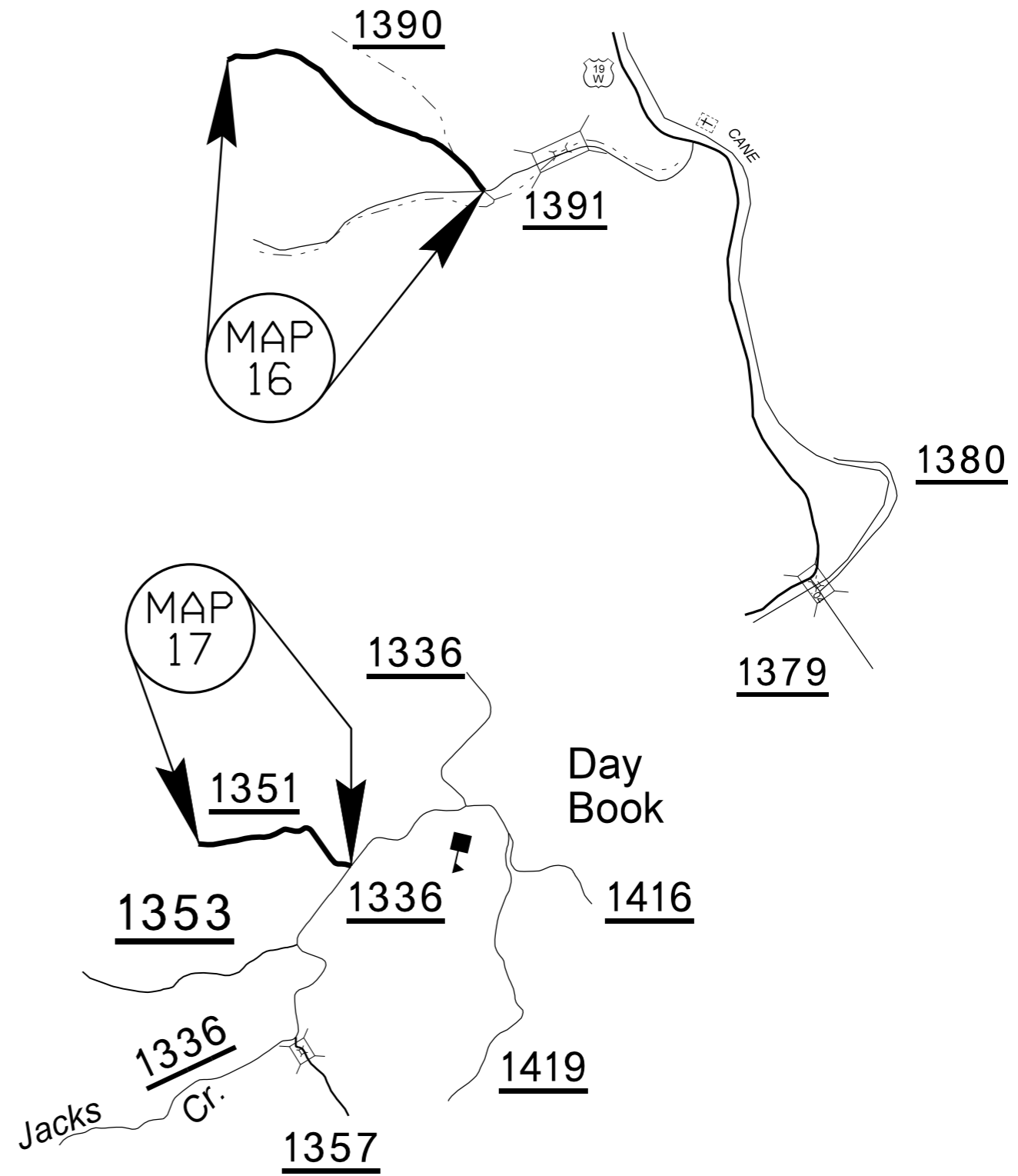
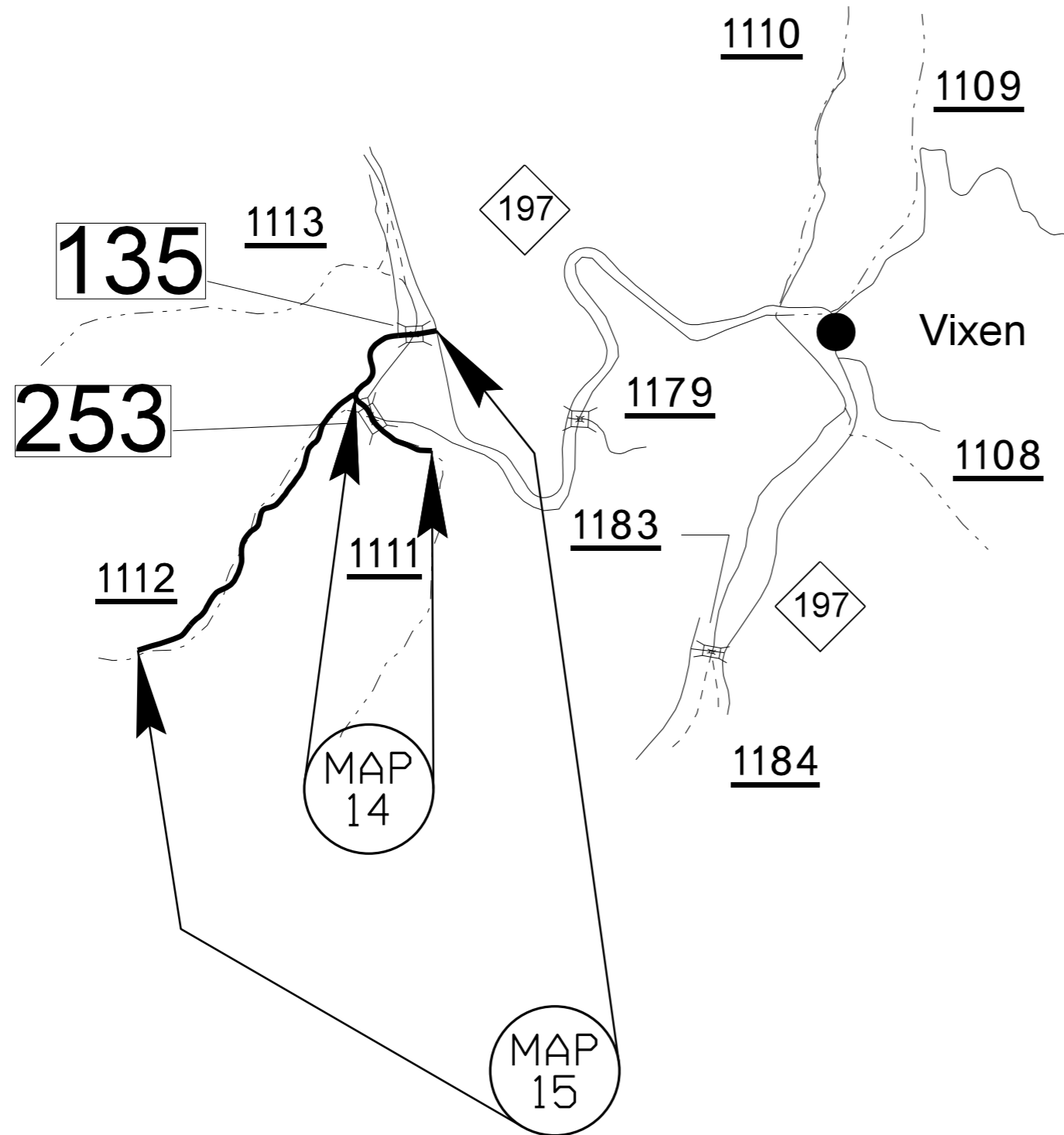

**YANCEY COUNTY**

PROJECT NO. 2017CPT.13.07.11001, 2017CPT.13.07.21001, 2017CPT.13.07.21002,	SHEET NO. <b>7</b>	TOTAL SHEETS
---	-----------------------	--------------

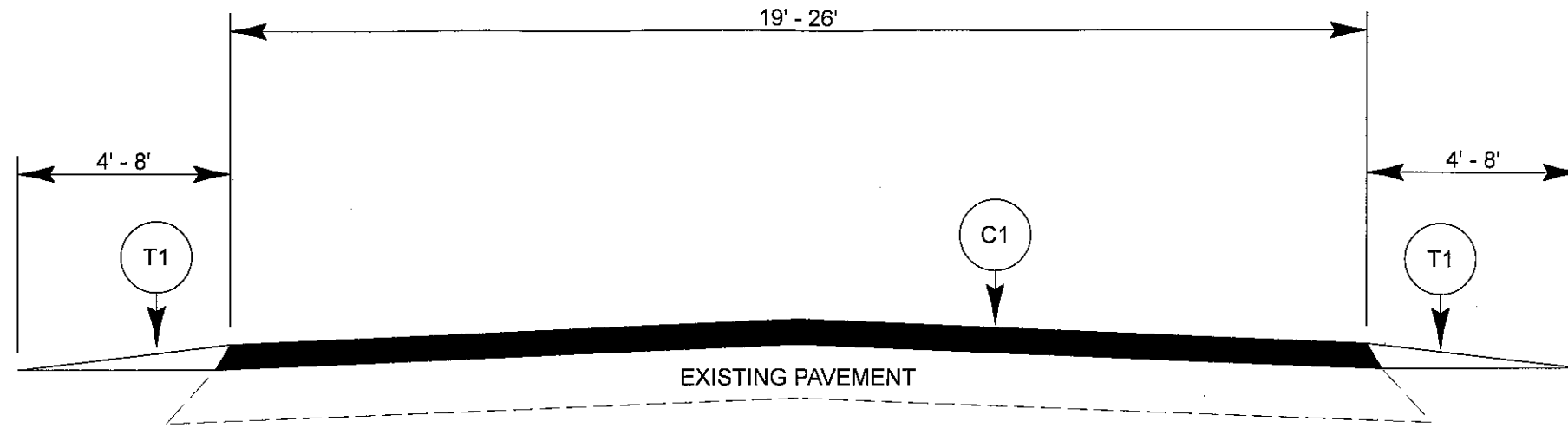

TYPICAL SECTION NO. 1

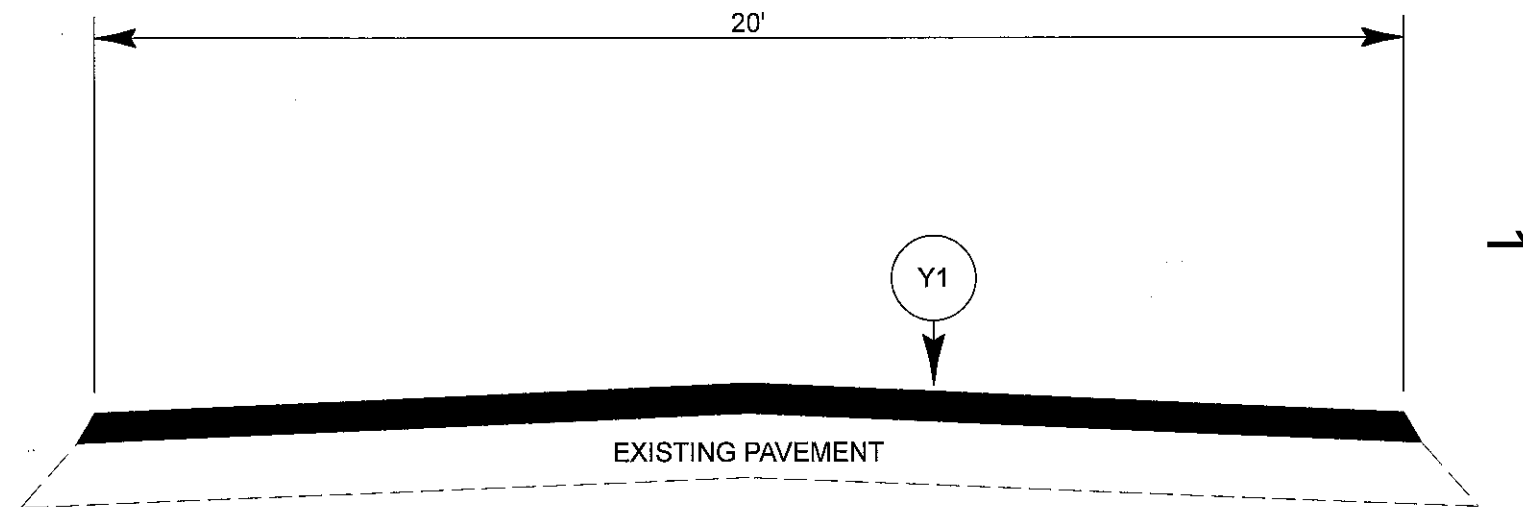
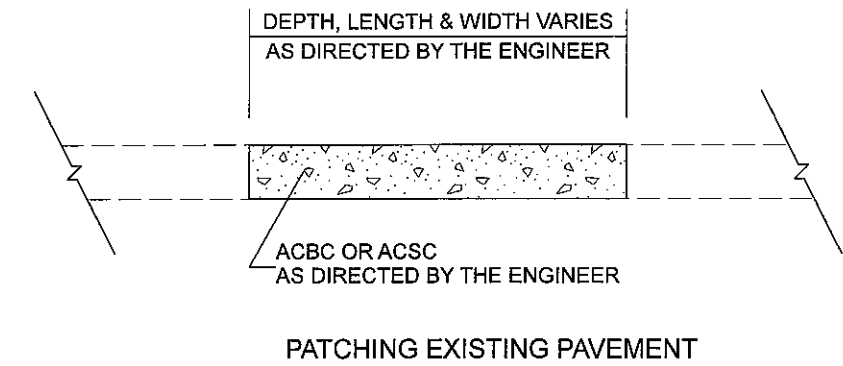

TYPICAL SECTION NO. 2

PAVEMENT SCHEDULE	
C1	PROP. APPROX. 1-1/2" ASPHALT CONCRETE SURFACE COURSE, TYPE S9.5B, AT AN AVERAGE RATE OF 168 LBS. PER SQ. YARD
C2	PROP. APPROX. 1-1/2" ASPHALT CONCRETE SURFACE COURSE, TYPE SF9.5A, AT AN AVERAGE RATE OF 165 LBS. PER SQ. YARD
F1	ASPHALT SURFACE TREATMENT, DOUBLE SEAL
F2	ASPHALT SURFACE TREATMENT, FOG SEAL
T1	SHOULDER RECONSTRUCTION
V1	INCIDENTAL MILLING
Y1	LATEX MODIFIED MICRO-SURFACING, TYPE III



PROJECT NO.	SHEET NO.	TOTAL SHEETS
2017CPT.13.07.11001, 2017CPT.13.07.21001, 2017CPT.13.07.21002,	8	

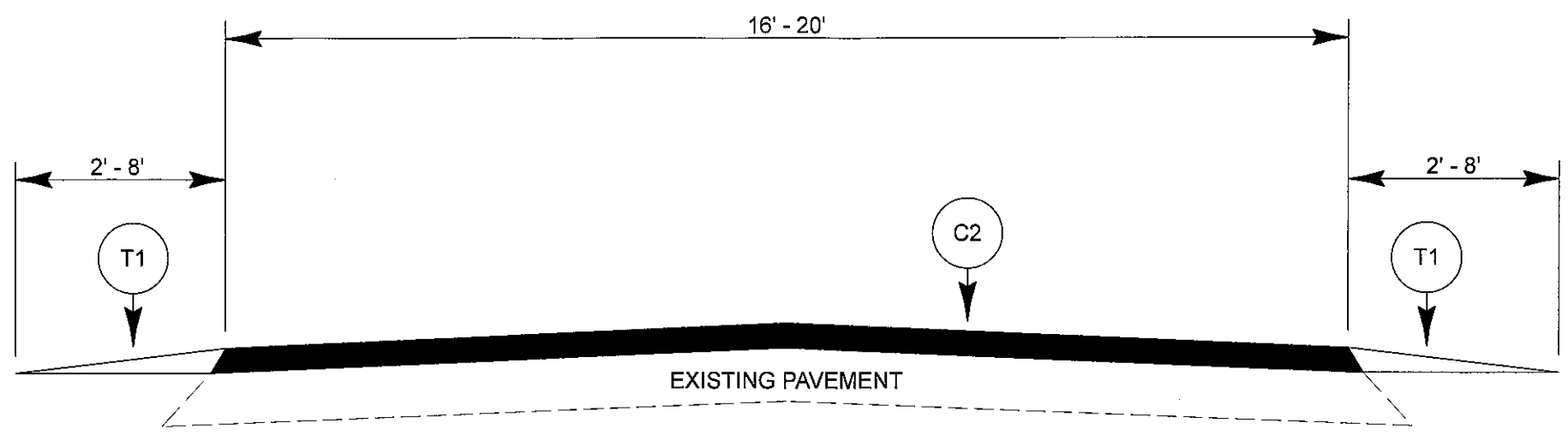

TYPICAL SECTION NO. 3

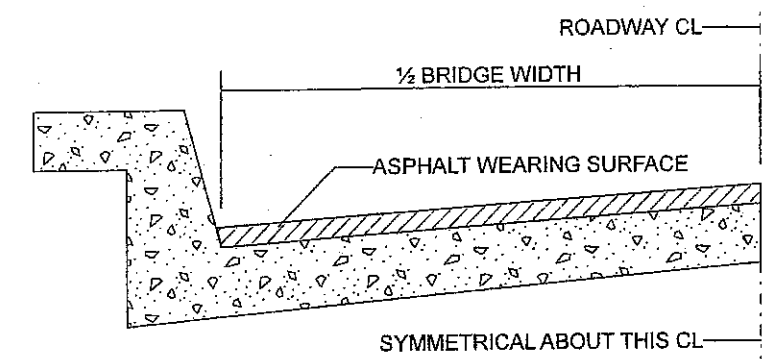

**BRIDGE HALF TYPICAL SECTION**  
 FOR BRIDGES WITH FLOOR DRAINS, CARE SHALL BE EXERCISED IN PLACING THE WEARING SURFACE AROUND FLOOR DRAINS SO AS NOT TO HINDER EFFECTIVE DRAINAGE. ALL DRAINS SHALL BE LEFT OPEN

THE PROPOSED WEARING SURFACE SHALL VARY IN THICKNESS AS NECESSARY TO PROVIDE A SMOOTH RIDING SURFACE. THE MINIMUM THICKNESS SHOULD DEPEND ON PAVEMENT TYPE AS FOLLOWS: S4.75A 1/4", SF9.5A 1.0", S9.5X 1.5", S12.5X 2.0", ULTRATHIN HOT MIX ASPHALT-TYPE A 3/4", ULTRATHIN HOT MIX ASPHALT-TYPE B 5/8", ULTRATHIN HOT MIX ASPHALT-TYPE C 1/2". THE MAXIMUM THICKNESS SHOULD DEPEND ON PAVEMENT TYPE AS FOLLOWS: S4.75A 1.0", SF9.5A 1.5", S9.5X 2.0", S12.5X 2.0", ULTRATHIN HOT MIX ASPHALT-TYPE A 3/4", ULTRATHIN HOT MIX ASPHALT-TYPE B 5/8", ULTRATHIN HOT MIX ASPHALT-TYPE C 1/2".

**NOTES**

ALL UNPAVED ROADS TO BE RESURFACED 50' FROM EDGE OF PAVEMENT OF MAIN PROJECT.  
 ALL PAVED S.R. ROADS TO BE RESURFACED TO THE ENDS OF THE RADII, OR AS DIRECTED BY THE ENGINEER.  
 EDGES, PAVEMENT WIDENING, INTERSECTIONS AND BRIDGE FLARES ARE INCLUDED IN THE TABLE OF QUANTITIES.  
 SHOULDERS AND DITCHES ARE TO BE CONSTRUCTED BY OTHERS UNLESS OTHERWISE INDICATED.  
 BRIDGES ARE TO BE RESURFACED AT LOCATIONS AND TO DEPTH AS DIRECTED BY THE ENGINEER.

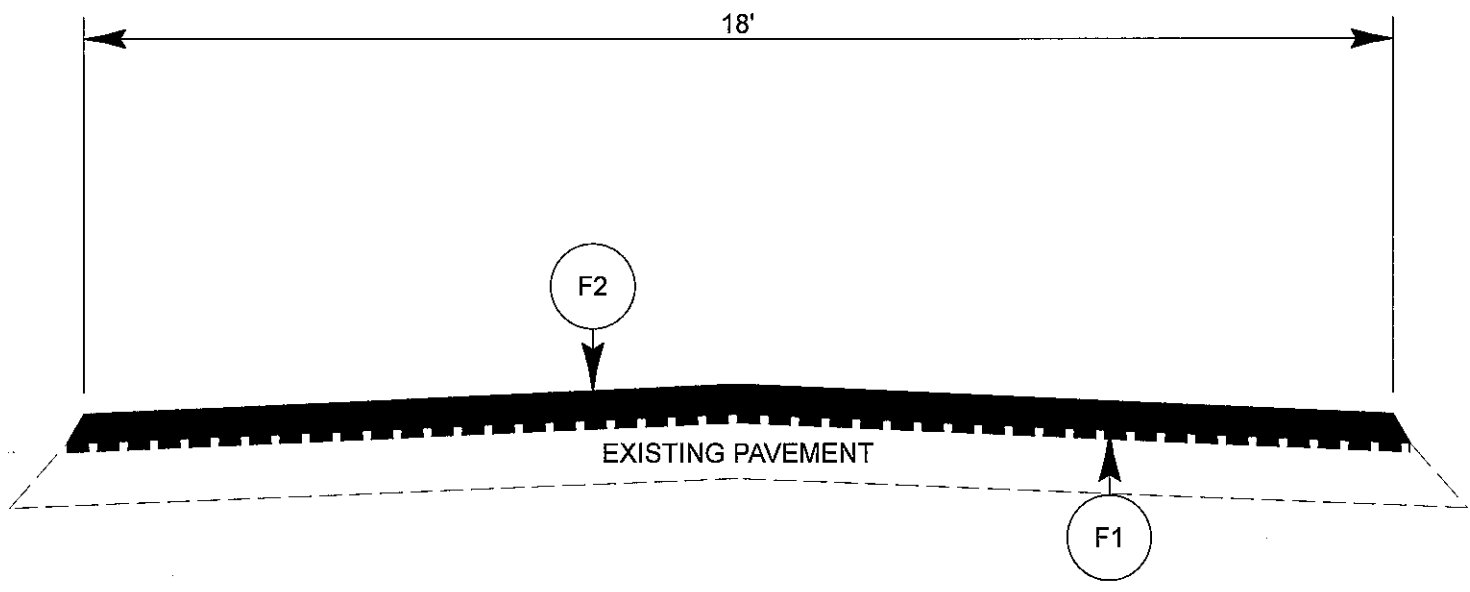

TYPICAL SECTION NO. 4

PROJECT NO.	SHEET NO.	TOTAL SHEETS
2017CPT.13.07.11001, 2017CPT.13.07.21001, 2017CPT.13.07.21002	9	

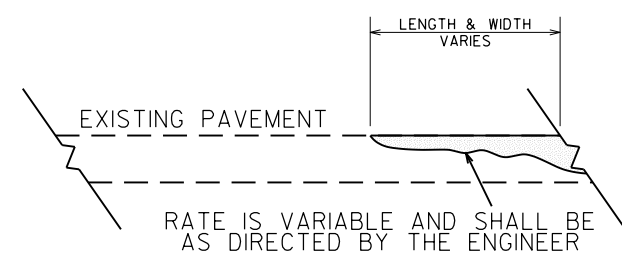
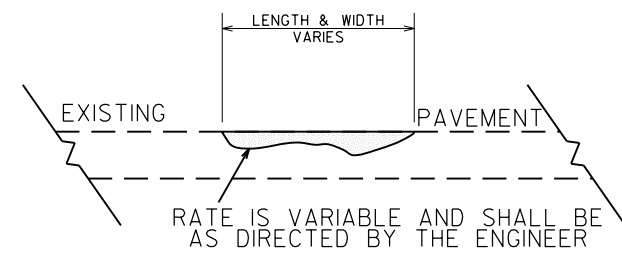

**DETAIL SHOWING  
METHOD OF WEDGING**

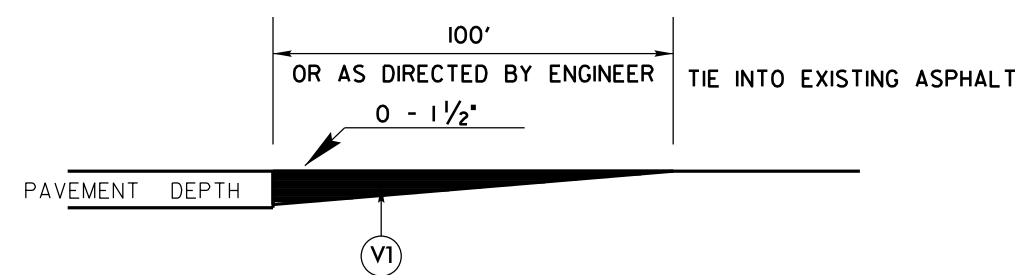

**DETAIL TO TIE INTO EXIST PAVEMENT**

**THE CONTRACTOR'S ATTENTION IS DIRECTED TO THE FACT THAT HE WILL BE REQUIRED TO MILL THE EXISTING ASPHALT PAVEMENT TO ENSURE A PROPER TIE-IN WITH THE EXISTING SURFACE AT THE BEGINNING, END AND Y LINES OF EACH MAP TO BE RESURFACED WITH ASPHALT CONC SURFACE COURSE, TYPE S9.5B. THIS WILL BE PAID FOR AS INCIDENTAL MILLING.**

etc

**NOTES:**

- 1) DETAIL DOES NOT APPLY TO OGAFB AND ULTRA-THIN BONDED WEARING COURSE.
- 2) BACKFILL SHOULDER WITH APPROVED MATERIAL.
- 3) THE SHOULDER WEDGE DEVICE MAY BE DISENGAGED AT PAVED DRIVEWAYS, SIDE STREETS, HIGH SHOULDERS, AND OTHER LOCATIONS NOT FEASIBLE TO CONSTRUCT AS APPROVED BY THE ENGINEER.

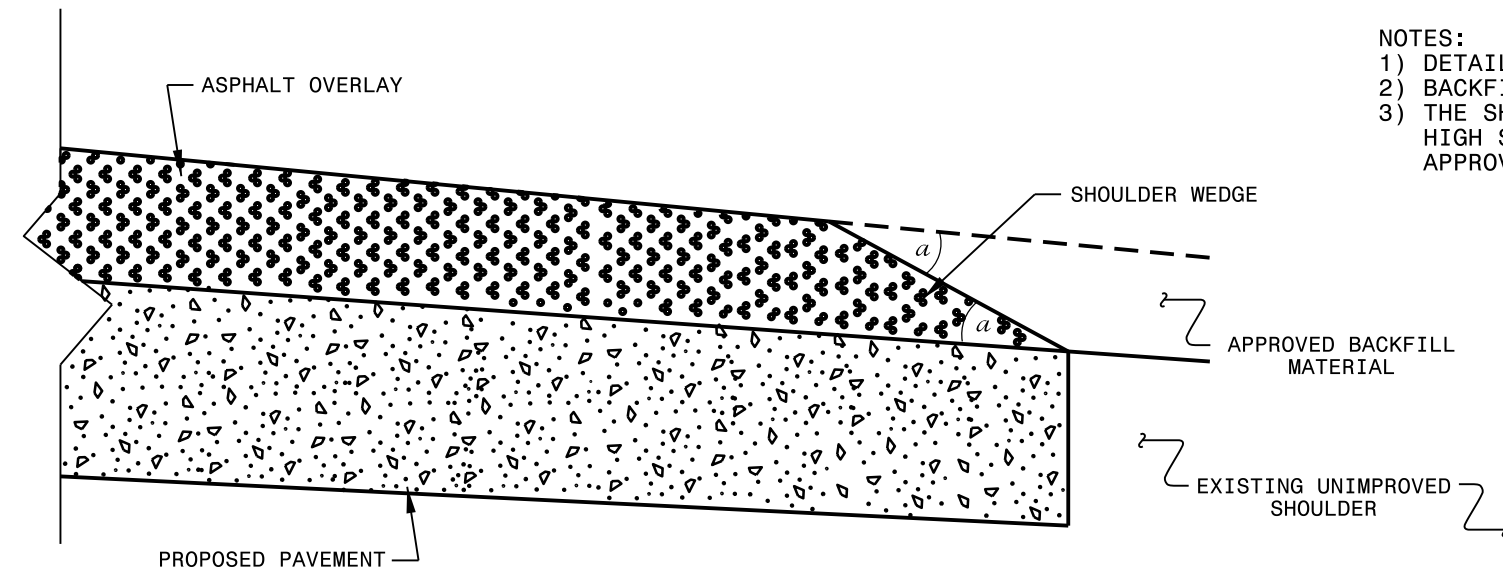

**SHOULDER WEDGE DETAIL**  
 (Resurfacing Projects w/ Widening or  
 with Existing Paved Shoulder having no dropoffs)

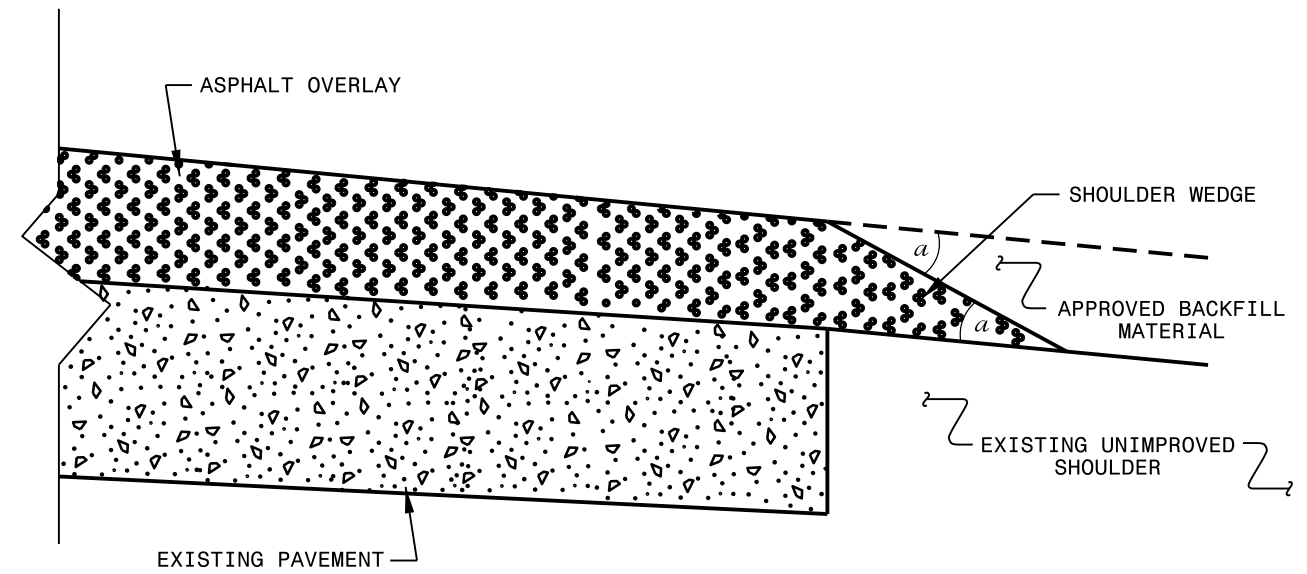

**SHOULDER WEDGE DETAIL**  
 (Resurfacing Projects w/ NO Widening)

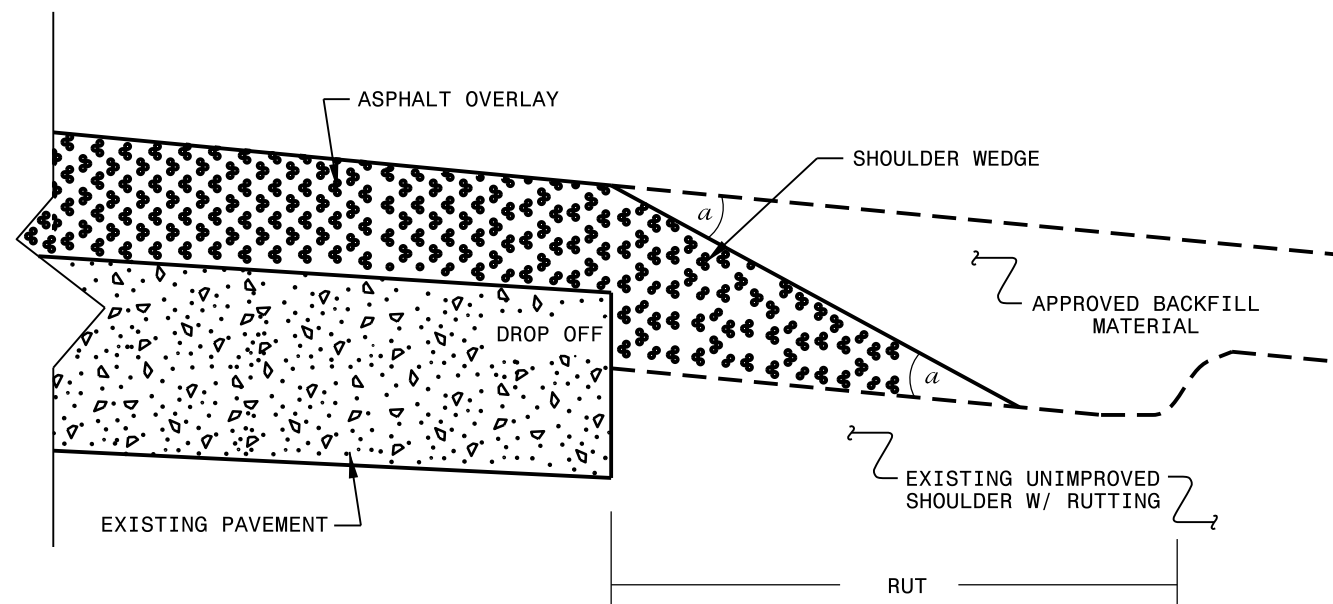

**SHOULDER WEDGE DETAIL**  
 (Resurfacing Adjacent to  
 Rutted Shoulder)

- SHOULDER WEDGE ANGLE = 30°

<b>CONTRACT STANDARDS AND DEVELOPMENT UNIT</b>			
Office 919-707-6950		FAX 919-250-4119	
<b>SHOULDER WEDGE DETAILS</b>			
ORIGINAL BY: T.SPELL	DATE: 7-19-11		
MODIFIED BY:	DATE: 2/2/16		
CHECKED BY:	DATE:		
FILE SPEC.: szusr/details/stand/shoulderwedgedetail.dgn			

24-MAR-2016 11:45  
 S:\Contracts\Resurfacing Projects\Shoulder Wedge Details\Revised Shoulder Wedge Detail.dgn  
 \$\$\$USERNAME\$\$\$

PROJECT NO.	SHEET NO.	TOTAL NO.
2017CPT.13.07.11001, 2017CPT.13.07.21001, 2017CPT.13.07.21002	11	

## SUMMARY OF QUANTITIES

PROJECT NO	COUNTY	MAP NO	ROUTE	DESCRIPTION	TYP	LANES	LANE TYPE	FINAL SURFACE TESTING REQUIRED	WARM MIX ASPHALT REQUIRED	LENGTH MI	WIDTH FT	INCIDENTAL STONE BASE TON	SHOULDER RECONSTRUCTION SMI	INCIDENTAL MILLING SY	ASPHALT CONC SURFACE COURSE, TYPE S9.5B TON	ASPHALT CONC SURFACE COURSE, TYPE SF9.5A TON	ASPHALT BINDER FOR PLANT MIX TON	PATCHING EXISTING PAVEMENT TON	ASPHALT SURFACE TREATMENT, DOUBLE SEAL SY	ASPHALT SURFACE TREATMENT, FOG SEAL SY	EMULSION FOR ASPHALT SURFACE TREATMENT GAL	LATEX MODIFIED MICRO-SURFACING, TYPE III SY		
2017CPT.13.07.11001	Yancey	1	NC 197N	FROM US 19E TO 0.35 MILES WEST OF SR 1422 (MP 16.57 - MP 22.67)	1	2	2WU	NO	NO	6.1	24.5	305	12.20	1,100	8,143		489	65						
		2	US 19W	FROM BRIDGE NO. 55 TO SR 1387 (MP 8.89 - MP 10.44)	2	2	2WU	NO	NO	1.55	20								25				18,187	
<b>TOTAL FOR PROJ NO. 2017CPT.13.07.11001</b>										<b>7.65</b>		<b>305</b>	<b>12.20</b>	<b>1,100</b>	<b>8,143</b>		<b>489</b>	<b>90</b>				<b>18,187</b>		
2017CPT.13.07.21001	Yancey	3	SR 1126	FROM MADISON COUNTY LINE TO SR 1136 (MP 0.00 - MP 4.10)	3	2	2WU	NO	NO	4.1	20	205	8.20			4,393	294	40						
		4	SR 1140	FROM US 19E TO EOP (MP 0.00 - MP 0.41)	1	2	2WU	NO	NO	0.41	19	21	0.82		425		26	30						
		5	SR 1354	FROM SR 1336 TO US 19W (MP 0.00 - MP 4.00)	3	2	2WU	NO	NO	4	18	200	8.00				3,860	259	35					
		6	SR 1352	FROM SR 1351 TO EOP (MP 0.00 - MP 0.70)	4	2	2WU	NO	NO	0.7	18								10	7,392	7,392	4,066		
		7	SR 1167	FROM NC 80 TO PVMT CHANGE (MP 0.00 - MP 1.50)	3	2	2WU	NO	NO	1.5	18	75	3.00				1,447	97	30					
		8	SR 1315	FROM SR 1308 TO EOP (MP 0.00 - MP 1.14)	4	2	2WU	NO	NO	1.14	18								25	12,038	12,038	6,622		
		9	SR 1317	FROM SR 1308 TO SR 1308 (MP 0.00 - MP 3.73)	3	2	2WU	NO	NO	3.73	16	187	7.46				3,202	215	35					
		10	SR 1369	FROM NC 197 TO SCHOOL CIRCLE (MP 0.00 - MP 1.91)	2	2	2WU	NO	NO	1.91	18									20			20,170	
		11	SR 1102	FROM NC 197 TO EOP (MP 0.00 - MP 2.70)	4	2	2WU	NO	NO	2.7	18									30	28,512	28,512	15,682	
<b>TOTAL FOR PROJ NO. 2017CPT.13.07.21001</b>										<b>20.19</b>		<b>688</b>	<b>27.48</b>		<b>425</b>	<b>12,902</b>	<b>891</b>	<b>255</b>	<b>47,942</b>	<b>47,942</b>	<b>26,370</b>	<b>20,170</b>		
2017CPT.13.07.21002	Yancey	12	SR 1104	FROM SR 1105 TO EOP (MP 0.00 - MP 0.15)	4	2	2WU	NO	NO	0.15	18							2	1,584	1,584	872			
		13	SR 1105	FROM SR 1102 TO EOP (MP 0.00 - MP 0.80)	4	2	2WU	NO	NO	0.8	18								2	8,448	8,448	4,647		
		14	SR 1111	FROM SR 1112 TO EOP (MP 0.00 - MP 0.07)	4	2	2WU	NO	NO	0.07	18								2	739	739	407		
		15	SR 1112	FROM NC 197 TO EOP (MP 0.00 - MP 1.11)	4	2	2WU	NO	NO	1.11	18								8	11,722	11,722	6,447		
		16	SR 1390	FROM SR 1391 TO EOP (MP 0.00 - MP 0.53)	4	2	2WU	NO	NO	0.53	18									2	5,597	5,597	3,079	
		17	SR 1351	FROM SR 1336 TO EOP (MP 0.00 - MP 2.00)	4	2	2WU	NO	NO	2	18									15	21,120	21,120	11,616	
<b>TOTAL FOR PROJ NO. 2017CPT.13.07.21002</b>										<b>4.66</b>								<b>31</b>	<b>49,210</b>	<b>49,210</b>	<b>27,068</b>			
<b>GRAND TOTAL</b>										<b>32.5</b>		<b>993</b>	<b>39.68</b>	<b>1,100</b>	<b>8,568</b>	<b>12,902</b>	<b>1,380</b>	<b>376</b>	<b>97,152</b>	<b>97,152</b>	<b>53,438</b>	<b>38,357</b>		

PROJECT NO.	SHEET NO.	TOTAL NO.
2017CPT.13.07.11001, 2017CPT.13.07.21001, 2017CPT.13.07.21002	12	

## THERMOPLASTIC AND PAINT QUANTITIES

PROJECT NO	COUNTY	MAP NO	ROUTE	DESCRIPTION	TYP NO	LANES	LANE TYPE	LENGTH	WIDTH	4413000000-E	4457000000-N	4725000000-E	4810000000-E		4850000000-E	4905000000-N
										WORK ZONE ADVANCE/ GENERAL WARNING SIGNING SF	TEMPORARY TRAFFIC CONTROL LS	THERMOPLASTIC PAVEMENT MARKING SYMBOL (90 MILS) LT ARROW EA	PAINT PAVEMENT MARKING LINES (4") WHITE LF	PAINT PAVEMENT MARKING LINES (4") YELLOW LF	REMOVAL OF PAVEMENT MARKING LINES (4") LF	SNOWPLOWABLE PAVEMENT MARKERS EA
2017CPT.13.07.11001	Yancey	1	NC 197N	FROM US 19E TO 0.35 MILES WEST OF SR 1422 (MP 16.57 - MP 22.67)	1	2	2WU	6.1	24.5	858	*	3	128,832	128,832		410
		2	US 19W	FROM BRIDGE NO. 55 TO SR 1387 (MP 8.89 - MP 10.44)	2	2	2WU	1.55	20			32,736	32,736	32,736	102	
<b>TOTAL FOR PROJ NO. 2017CPT.13.07.11001</b>							<b>7.65</b>			<b>858</b>	<b>1</b>	<b>3</b>	<b>161,568</b>	<b>161,568</b>	<b>32,736</b>	<b>512</b>
													<b>323,136</b>			
2017CPT.13.07.21001	Yancey	3	SR 1126	FROM MADISON COUNTY LINE TO SR 1136 (MP 0.00 - MP 4.10)	3	2	2WU	4.1	20	2,294	*		86,592	86,592		
		4	SR 1140	FROM US 19E TO EOP (MP 0.00 - MP 0.41)	1	2	2WU	0.41	19			8,659	8,659			
		5	SR 1354	FROM SR 1336 TO US 19W (MP 0.00 - MP 4.00)	3	2	2WU	4	18			84,480	84,480			
		6	SR 1352	FROM SR 1351 TO EOP (MP 0.00 - MP 0.70)	4	2	2WU	0.7	18			14,784	14,784			
		7	SR 1167	FROM NC 80 TO PVMT CHANGE (MP 0.00 - MP 1.50)	3	2	2WU	1.5	18			31,680	31,680			
		8	SR 1315	FROM SR 1308 TO EOP (MP 0.00 - MP 1.14)	4	2	2WU	1.14	18			24,077	24,077			
		9	SR 1317	FROM SR 1308 TO SR 1308 (MP 0.00 - MP 3.73)	3	2	2WU	3.73	16			78,778	78,778			
		10	SR 1369	FROM NC 197 TO SCHOOL CIRCLE (MP 0.00 - MP 1.91)	2	2	2WU	1.91	18			40,339	40,339	40,339		
		11	SR 1102	FROM NC 197 TO EOP (MP 0.00 - MP 2.70)	4	2	2WU	2.7	18			57,024	57,024			
		<b>TOTAL FOR PROJ NO. 2017CPT.13.07.21001</b>							<b>20.19</b>					<b>2,294</b>	<b>1</b>	
													<b>852,826</b>			
2017CPT.13.07.21002	Yancey	12	SR 1104	FROM SR 1105 TO EOP (MP 0.00 - MP 0.15)	4	2	2WU	0.15	18	440	*					
		13	SR 1105	FROM SR 1102 TO EOP (MP 0.00 - MP 0.80)	4	2	2WU	0.8	18			16,896	16,896			
		14	SR 1111	FROM SR 1112 TO EOP (MP 0.00 - MP 0.07)	4	2	2WU	0.07	18							
		15	SR 1112	FROM NC 197 TO EOP (MP 0.00 - MP 1.11)	4	2	2WU	1.11	18			23,443	23,443			
		16	SR 1390	FROM SR 1391 TO EOP (MP 0.00 - MP 0.53)	4	2	2WU	0.53	18							
		17	SR 1351	FROM SR 1336 TO EOP (MP 0.00 - MP 2.00)	4	2	2WU	2	18			42,240	42,240			
<b>TOTAL FOR PROJ NO. 2017CPT.13.07.21002</b>							<b>4.66</b>			<b>440</b>	<b>1</b>		<b>82,579</b>	<b>82,579</b>		
													<b>165,158</b>			
<b>GRAND TOTAL</b>							<b>32.5</b>			<b>3,592</b>	<b>1</b>	<b>3</b>	<b>670,560</b>	<b>670,560</b>	<b>73,075</b>	<b>512</b>
													<b>1,341,120</b>			

# SIGNING FOR RESURFACING PROJECTS

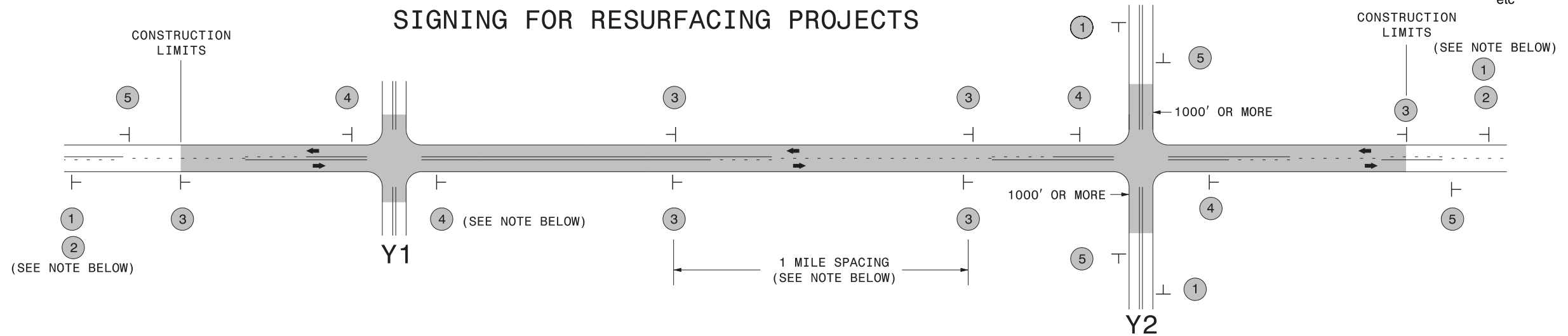

LEGEND	
┆	STATIONARY SIGN
←	DIRECTION OF TRAFFIC FLOW

## MAINLINE (-L-) SIGNING

## -Y- LINE SIGNING

SIGNING NOTES AND PLACEMENT PER DIRECTION	MAINLINE (-L-) SIGNING		-Y- LINE SIGNING	
	1	 W20-1 48" X 48"	PLACE 1000' PRIOR TO BEGINNING OF CONSTRUCTION LIMITS. ONLY USED ON -Y- LINES IF RESURFACING LIMITS EXTEND 1000' ALONG -Y- LINE.	<p>NO REQUIRED STATIONARY SIGNING FOR THE FOLLOWING -Y- LINE CONDITIONS:</p> <ol style="list-style-type: none"> <li>1) LESS THAN 1000' OF RESURFACING ALONG -Y- LINE</li> <li>2) SUBDIVISION ROADS</li> <li>3) DEAD END ROADS</li> </ol> <p>WHEN PAVING/CONSTRUCTION ACTIVITIES PROCEED ACROSS AN UNSIGNED -Y- LINE, ADVANCE WARNING PORTABLE SIGNS SHALL BE USED ALONG THE -Y- LINE AS SHOWN BELOW. REMOVE UPON COMPLETION OF WORK.</p> <div style="display: flex; justify-content: space-around;"> <div style="text-align: center;">             W20-1            48" X 48"         </div> <div style="text-align: center;">             W20-7 A            48" X 48"         </div> </div> <p>PLACED 500' IN ADVANCE OF FLAGGER. PLACED 250' IN ADVANCE OF FLAGGER.</p>
	2	 W7-3aP 24" X 18"	#2 SIGN ONLY USED WHEN RESURFACING LIMITS ARE 2 OR MORE MILES IN LENGTH. ROUND UP TO NEXT WHOLE NUMBER. (NO FRACTIONAL OR DECIMAL NUMBERS)	
	3	 SP 13107 48" X 48"	PLACE INITIALLY AT THE CONSTRUCTION LIMITS AND SPACED 1 MILE APART THEREAFTER. IF NO -Y- LINES EXIST, PLACE 2ND SET 1/2 MILE FROM THE CONSTRUCTION LIMITS AND THEN SPACE 1 MILE THEREAFTER.	
	4	 SP 13106 48" X 48"	THESE ARE FOR -Y- LINES THAT ARE "THROUGH" ROADWAYS. DEAD END AND SUBDIVISION ROADS ARE NOT "THROUGH" ROADWAYS. INSTALL 500' +/- FROM EACH -Y- LINE APPROACH AS SHOWN ABOVE. FOR MULTIPLE -Y- LINES THAT ARE SEPARATED BY 0.25 MILES OR LESS, TREAT AS A SINGLE UNIT AND INSTALL WITHIN 500' OF EACH APPROACH. A MAXIMUM OF 2 SIGN SETS PER MILE. DO NOT INSTALL WHEN -Y- LINES ARE WITHIN 0.5 MILES FROM "END ROAD WORK" SIGN.	
5	 G20-2 A 48" X 24"	PLACE 500' FOLLOWING THE END OF CONSTRUCTION LIMITS.		

3/19/2015  
 C:\Users\rmgarrett\Downloads\Resurfacing\_AdvWarn\_2Ln (2).dgn  
 User:rmgarrett

**RESURFACING  
ADVANCE WARNING SIGNS  
FOR  
RURAL AND SUBURBAN  
2 LANE ROADWAYS**

## SIGNING FOR ASPHALT SURFACE TREATMENT

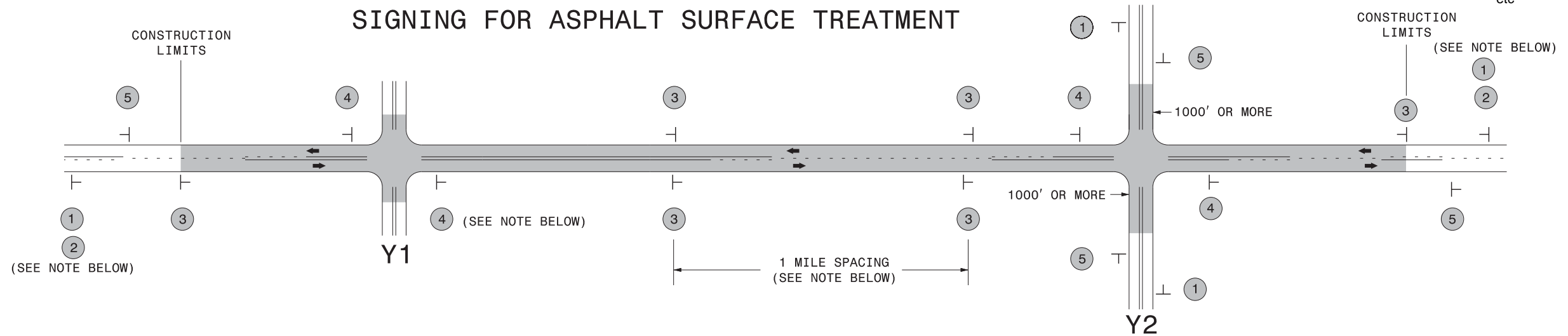

LEGEND	
┆	STATIONARY SIGN
←	DIRECTION OF TRAFFIC FLOW

### MAINLINE (-L-) SIGNING

### -Y- LINE SIGNING

SIGNING NOTES AND PLACEMENT PER DIRECTION		
1 2	 W20-1 48" X 48" W7-3aP 24" X 18"	<p>PLACE 1000' PRIOR TO BEGINNING OF CONSTRUCTION LIMITS. ONLY USED ON -Y- LINES IF RESURFACING LIMITS EXTEND 1000' ALONG -Y- LINE.</p> <p>#2 SIGN ONLY USED WHEN RESURFACING LIMITS ARE 2 OR MORE MILES IN LENGTH. ROUND UP TO NEXT WHOLE NUMBER. (NO FRACTIONAL OR DECIMAL NUMBERS)</p>
3	 W8-7 48" X 48" SP 48" X 48"	<p>ALTERNATE THE FOLLOWING TWO SIGNS: STARTING WITH "LOOSE GRAVEL" (W8-7) FOLLOWED BY "UNMARKED PAVEMENT".</p> <p>PLACE INITIALLY AT THE CONSTRUCTION LIMITS AND SPACED 1 MILE APART THEREAFTER. IF NO -Y- LINES EXIST, PLACE 2ND SET 1/2 MILE FROM THE CONSTRUCTION LIMITS AND THEN SPACE 1 MILE THEREAFTER.</p>
4	 SP 13106 48" X 48"	<p>THESE ARE FOR -Y- LINES THAT ARE "THROUGH" ROADWAYS. DEAD END AND SUBDIVISION ROADS ARE NOT "THROUGH" ROADWAYS. INSTALL 500' +/- FROM EACH -Y- LINE APPROACH AS SHOWN ABOVE. FOR MULTIPLE -Y- LINES THAT ARE SEPARATED BY 0.25 MILES OR LESS, TREAT AS A SINGLE UNIT AND INSTALL WITHIN 500' OF EACH APPROACH. A MAXIMUM OF 2 SIGN SETS PER MILE. DO NOT INSTALL WHEN -Y- LINES ARE WITHIN 0.5 MILES FROM "END ROAD WORK" SIGN.</p>
5	 G20-2 A 48" X 24"	<p>PLACE 500' FOLLOWING THE END OF CONSTRUCTION LIMITS.</p>

NO REQUIRED STATIONARY SIGNING FOR THE FOLLOWING -Y- LINE CONDITIONS:

- 1) LESS THAN 1000' OF RESURFACING ALONG -Y- LINE
- 2) SUBDIVISION ROADS
- 3) DEAD END ROADS

WHEN PAVING/CONSTRUCTION ACTIVITIES PROCEED ACROSS AN UNSIGNED -Y- LINE, ADVANCE WARNING PORTABLE SIGNS SHALL BE USED ALONG THE -Y- LINE AS SHOWN BELOW. REMOVE UPON COMPLETION OF WORK.



PLACED 500' IN ADVANCE OF FLAGGER. PLACED 250' IN ADVANCE OF FLAGGER.

**ADVANCE WARNING SIGNS  
FOR  
ASPHALT SURFACE TREATMENTS  
2 LANE ROADWAYS**

12/22/2014 S:\TMU\WZTC\apps\work\zonegeneral\external\webpage\desres\resurfacing\resurfacing\advwarn\_2Ln - AST.dgn User:rmgarratt