

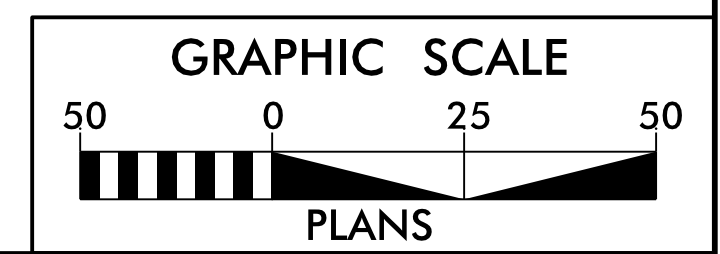

ENGINEER

DocuSigned by:
 Gary R. Taylor
 3/18/2016
 SIGNATURE DATE

**DOCUMENT NOT CONSIDERED FINAL
 UNLESS ALL SIGNATURES COMPLETED**

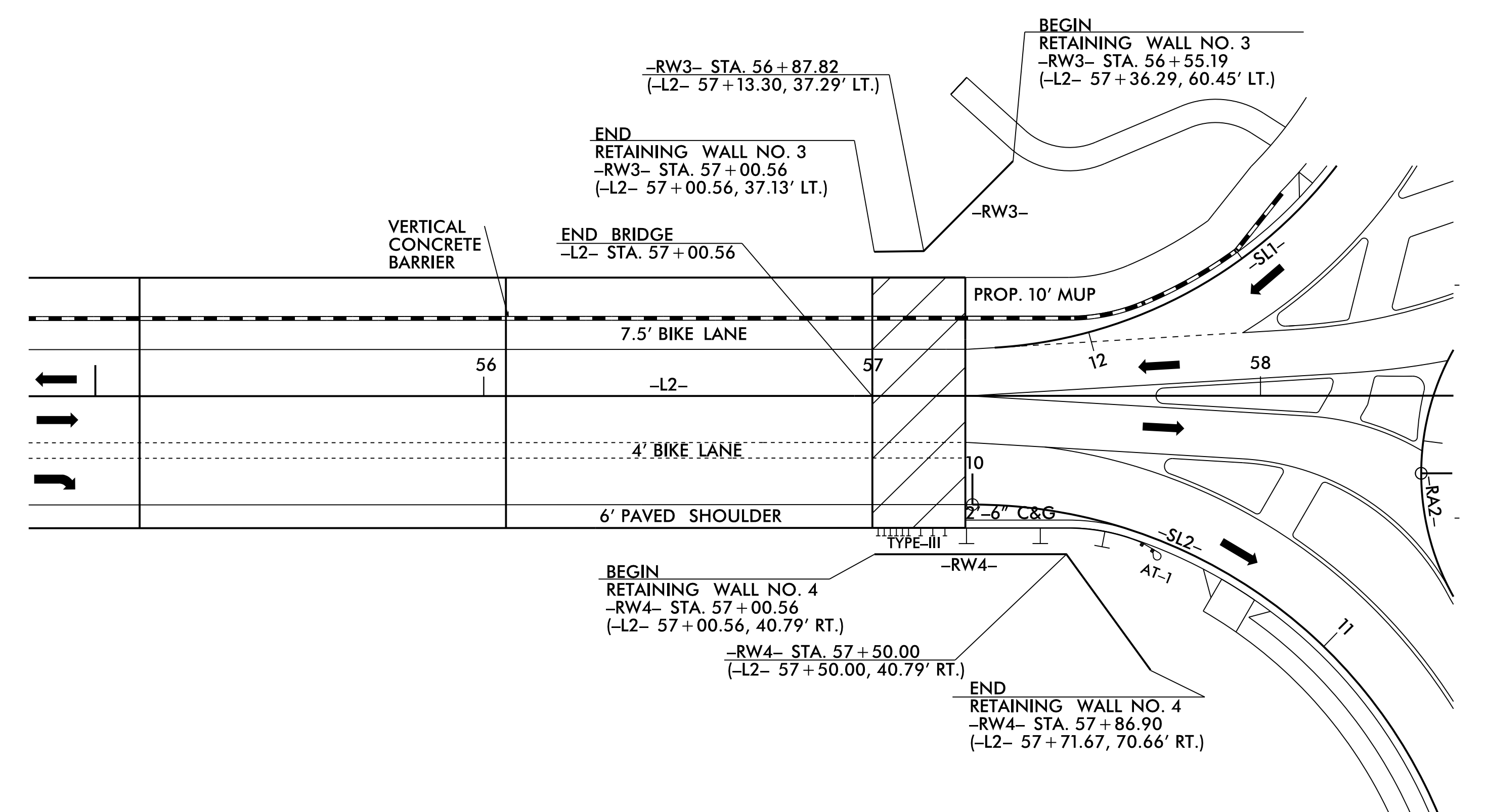

WALL ENVELOPE FOR RETAINING WALL NO. 3

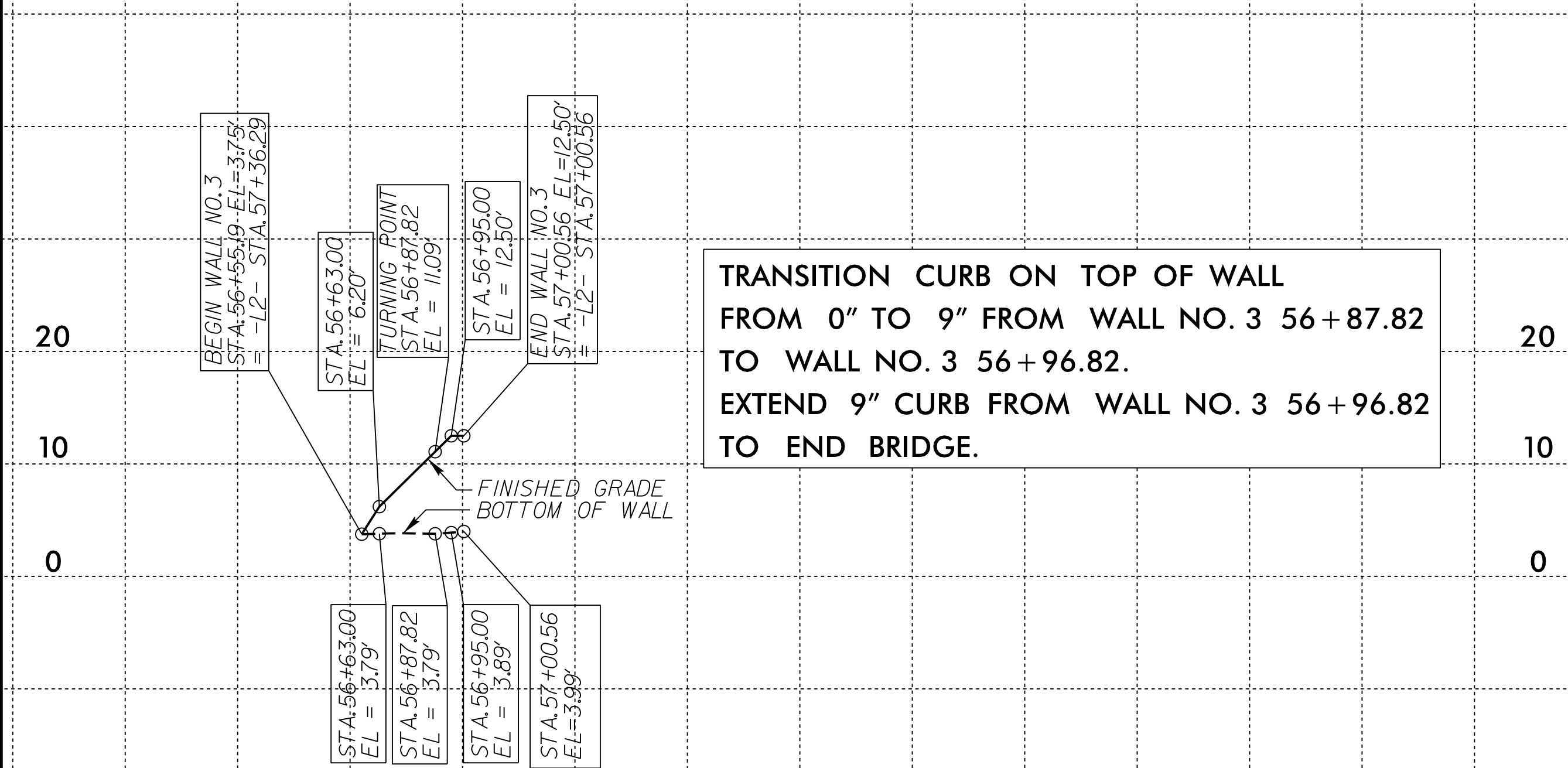

WALL ENVELOPE FOR RETAINING WALL NO. 4

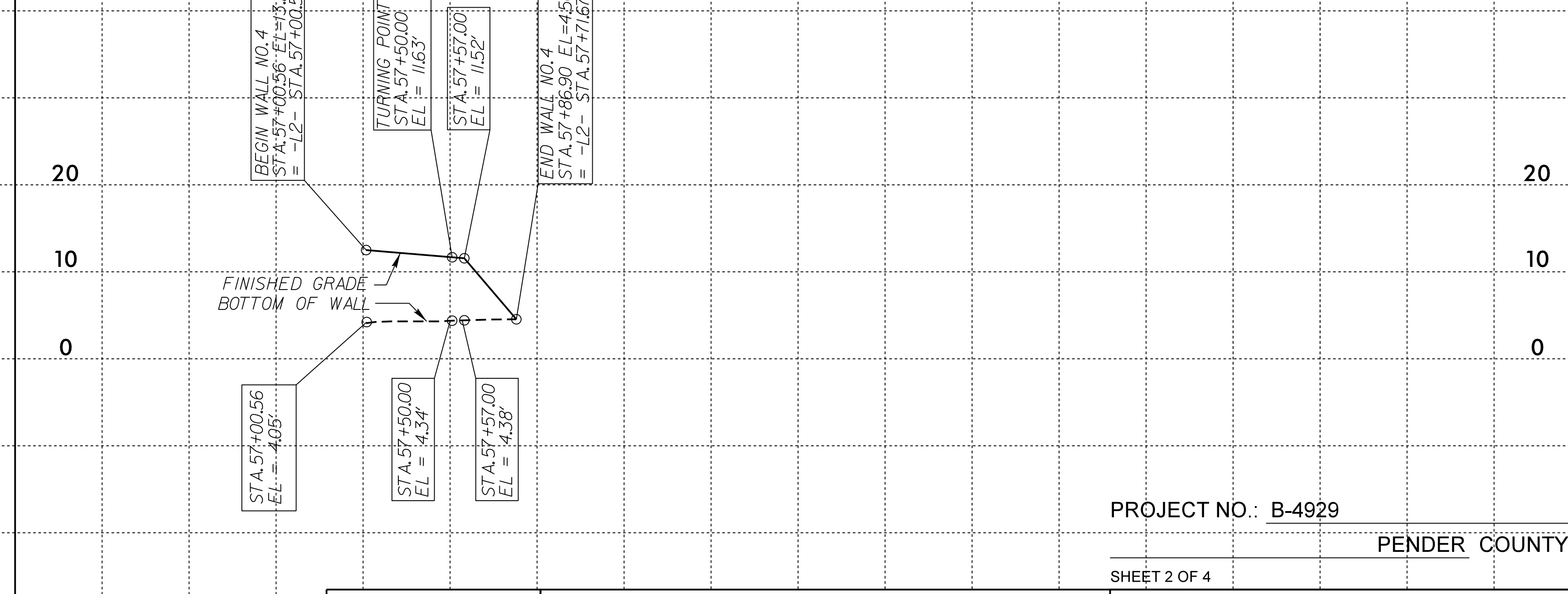

PROJECT NO.: B-4929
 PENDER COUNTY
 SHEET 2 OF 4

SINCE

**NORTH CAROLINA
 DEPARTMENT OF TRANSPORTATION
 DIVISION OF HIGHWAYS**

**GEOTECHNICAL
 ENGINEERING UNIT**

**MSE RETAINING WALLS
 PLAN AND PROFILES**

REVISIONS						SHEET NO.
NO.	BY	DATE	NO.	BY	DATE	
1			3			W-2
2			4			

PREPARED BY: DATE: 03 / 2016
 REVIEWED BY: DATE: 03 / 2016

56 + 00 57 + 00

57 + 00 58 + 00