

NOTES

FOR NOTES, SEE SHEET 1 OF 5.

FOR BAR TYPES, SEE SHEET 5 OF 5.

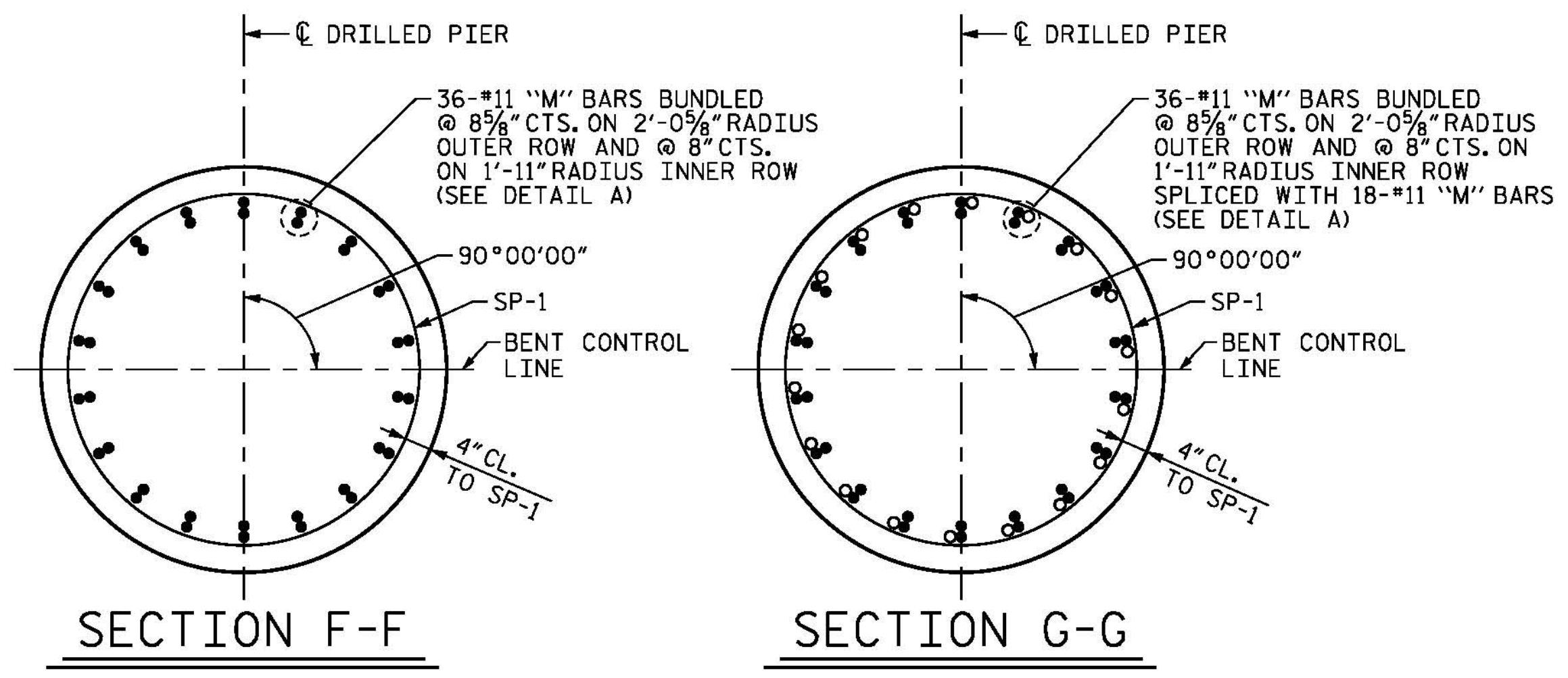
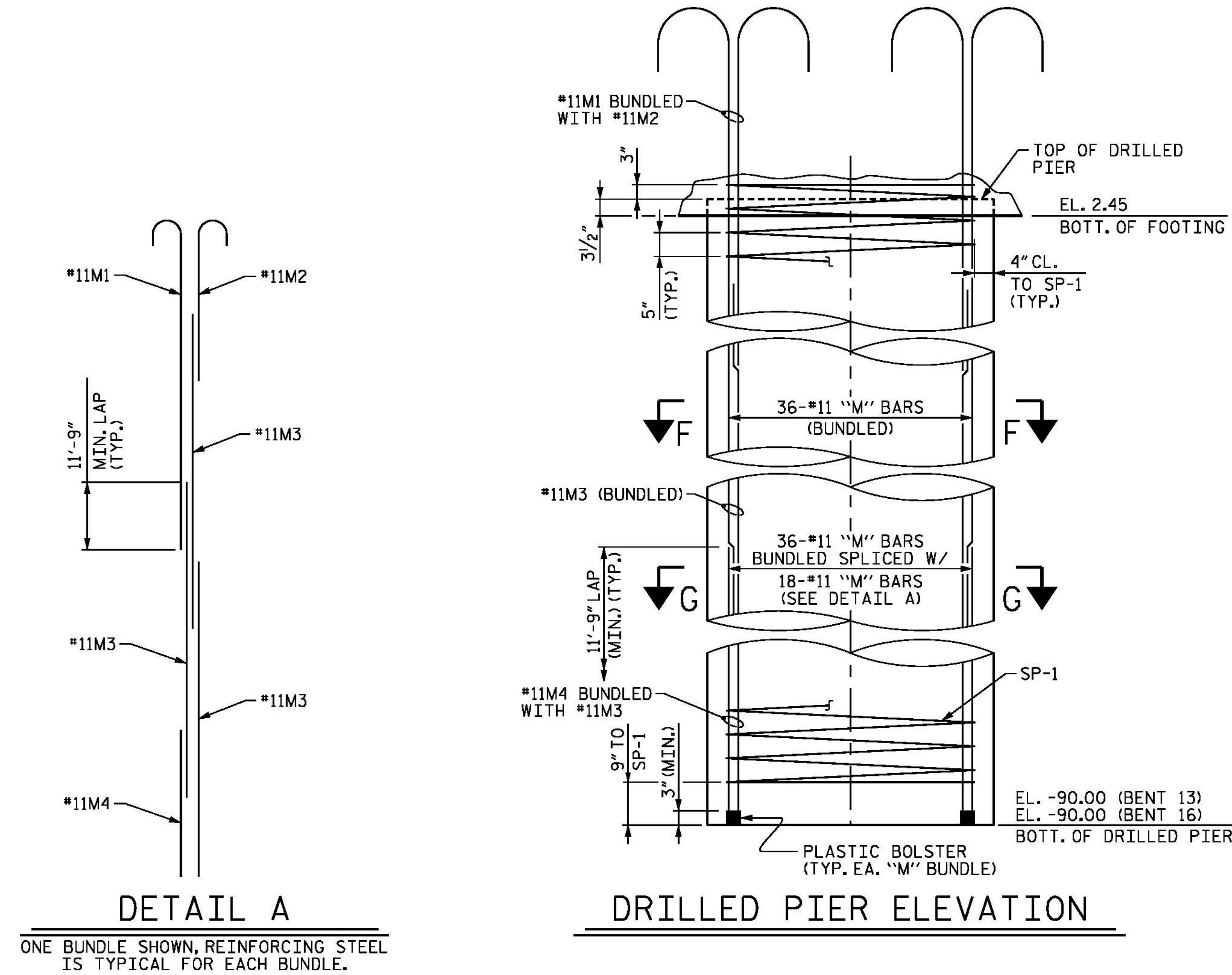

BILL OF MATERIAL

BENT 13

| BAR | NUMBER | SIZE | TYPE | LENGTH | WEIGHT | BAR | NUMBER | SIZE | TYPE | LENGTH | WEIGHT |
|---|--------|------|------|---------|--------|------|--------|------|------|-----------|--------|
| B1 | 10 | #11 | 1 | 53'-0" | 2816 | T1 | 93 | 9 | STR | 54'-4" | 17180 |
| B2 | 10 | #11 | STR | 49'-10" | 2648 | T2 | 134 | 9 | STR | 24'-4" | 11086 |
| B3 | 10 | #10 | STR | 40'-4" | 1736 | T3 | 83 | 6 | STR | 24'-4" | 3034 |
| B4 | 6 | #10 | STR | 42'-0" | 1084 | T4 | 20 | 6 | STR | 54'-4" | 1632 |
| B5 | 10 | #10 | 2 | 10'-0" | 430 | T5 | 138 | 5 | STR | 7'-2" | 1032 |
| B6 | 10 | #10 | 3 | 10'-0" | 430 | T6 | 316 | 5 | 9 | 8'-6" | 2801 |
| B7 | 14 | #7 | STR | 49'-10" | 1426 | | | | | | |
| B8 | 2 | #7 | STR | 47'-4" | 193 | U1 | 116 | 4 | 9 | 6'-5" | 497 |
| B9 | 2 | #7 | STR | 44'-8" | 183 | U2 | 10 | 4 | 9 | 8'-3" | 55 |
| B10 | 20 | #4 | STR | 6'-3" | 84 | U3 | 6 | 4 | 9 | 8'-2" | 33 |
| B11 | 10 | #4 | STR | 5'-2" | 35 | U4 | 6 | 4 | 9 | 8'-0" | 32 |
| B12 | 24 | #4 | STR | 5'-5" | 87 | | | | | | |
| B13 | 20 | #4 | STR | 12'-2" | 163 | V1 | 36 | 11 | 4 | 47'-5" | 9069 |
| | | | | | | V2 | 36 | 11 | 4 | 48'-3" | 9229 |
| D1 | 26 | #6 | STR | 39'-4" | 1536 | V3 | 72 | 11 | 8 | 21'-2" | 8097 |
| D2 | 48 | #5 | 9 | 10'-4" | 517 | | | | | | |
| M1 | 144 | #11 | 4 | 46'-2" | 35321 | | | | | | |
| M2 | 144 | #11 | 4 | 22'-10" | 17469 | | | | | | |
| M3 | 432 | #11 | STR | 50'-0" | 114761 | | | | | | |
| M4 | 144 | #11 | STR | 26'-8" | 20402 | | | | | | |
| S1 | 118 | #5 | 5 | 4'-9" | 585 | | | | | | |
| S2 | 74 | #5 | 6 | 19'-8" | 1518 | | | | | | |
| S3 | 2 | #5 | 6 | 19'-5" | 41 | | | | | | |
| S4 | 2 | #5 | 6 | 19'-0" | 40 | | | | | | |
| S5 | 2 | #5 | 6 | 18'-7" | 39 | | | | | | |
| S6 | 2 | #5 | 6 | 18'-1" | 38 | | | | | | |
| S7 | 2 | #5 | 6 | 17'-8" | 37 | | | | | | |
| S8 | 2 | #5 | 6 | 17'-3" | 36 | | | | | | |
| S9 | 2 | #5 | 6 | 16'-10" | 35 | | | | | | |
| S10 | 2 | #5 | 6 | 16'-4" | 34 | SP-1 | 8 | * | 10 | 3,019'-5" | 25,194 |
| S11 | 2 | #5 | 6 | 15'-11" | 33 | | | | | | |
| S12 | 2 | #5 | 6 | 15'-6" | 32 | | | | | | |
| S13 | 2 | #5 | 6 | 15'-1" | 31 | | | | | | |
| S14 | 2 | #5 | 6 | 19'-7" | 41 | | | | | | |
| S15 | 2 | #5 | 6 | 19'-3" | 40 | | | | | | |
| S16 | 2 | #5 | 6 | 18'-11" | 39 | | | | | | |
| S17 | 2 | #5 | 6 | 18'-5" | 38 | | | | | | |
| S18 | 2 | #5 | 6 | 18'-1" | 38 | | | | | | |
| S19 | 2 | #5 | 6 | 17'-8" | 37 | | | | | | |
| S20 | 2 | #5 | 6 | 17'-3" | 36 | | | | | | |
| S21 | 2 | #5 | 6 | 16'-11" | 35 | | | | | | |
| S22 | 2 | #5 | 6 | 16'-6" | 34 | | | | | | |
| S23 | 2 | #5 | 6 | 16'-1" | 34 | | | | | | |
| S24 | 2 | #5 | 6 | 15'-8" | 33 | | | | | | |
| S25 | 26 | #5 | 6 | 21'-3" | 576 | | | | | | |
| S26 | 530 | #5 | 7 | 14'-1" | 7785 | | | | | | |
| S27 | 1060 | #5 | 11 | 4'-6" | 4975 | | | | | | |
| EPOXY COATED REINFORCING STEEL LBS. 281,338 | | | | | | | | | | | |
| EPOXY COATED SPIRAL COLUMN REINFORCING STEEL LBS. 25,194 | | | | | | | | | | | |
| CLASS "AA" CONCRETE BREAKDOWN | | | | | | | | | | | |
| POUR #2 - FOOTING C.Y. 412.4 | | | | | | | | | | | |
| POUR #3 - STRUT C.Y. 61.5 | | | | | | | | | | | |
| POUR #4 - COLUMNS C.Y. 91.5 | | | | | | | | | | | |
| POUR #5 - CAP C.Y. 89.5 | | | | | | | | | | | |
| CLASS "AA" CONCRETE C.Y. 654.9 | | | | | | | | | | | |
| 5'-0" Ø DRILLED PIERS QUANTITIES: | | | | | | | | | | | |
| DRILLED PIER LIN. FT. 741.9 | | | | | | | | | | | |
| POUR 1 - DRILLED PIER C.Y. 539.6 | | | | | | | | | | | |
| PERMANENT STEEL CASING FOR 5'-0" Ø DRILLED PIERS LIN. FT. 245.9 | | | | | | | | | | | |
| CSL TUBES LIN. FT. 3,770 | | | | | | | | | | | |

* THE SP-1 SPIRAL REINFORCING STEEL SHALL BE W31 OR D-31 COLD DRAWN WIRE OR #5 PLAIN DEFORMED BAR.

PROJECT NO. B-4929

PENDER COUNTY

STATION: 38+13.81 -L2-

SHEET 4 OF 5 STEEL ALTERNATE

STATE OF NORTH CAROLINA
DEPARTMENT OF TRANSPORTATION
RALEIGH
SUBSTRUCTURE
BENTS 13 AND 16
BILL OF MATERIALS



PARSONS BRINCKERHOFF
434 FAYETTEVILLE STREET
SUITE 1500
RALEIGH, NC 27601
LICENSE NO. F-0165

DocuSigned by:
Jason R Doughty
00F1C96448274F7...

REVISIONS

| NO. | BY: | DATE: | NO. | BY: | DATE: |
|-----|-----|-------|-----|-----|-------|
| 1 | | | 3 | | |
| 2 | | | 4 | | |

SHEET NO.
S-262
TOTAL SHEETS
278

DOCUMENT NOT CONSIDERED FINAL UNLESS ALL SIGNATURES COMPLETED

5/12/2016
401_101_B4929_SMU_IB13_4s.dgn

DESIGNED BY: E. ULLMER DATE: APR 2016
DRAWN BY: M. HOBBS DATE: APR 2016
CHECKED BY: B. LOFLIN DATE: APR 2016
DESIGN ENGINEER OF RECORD: J. DOUGHTY DATE: MAY 2016