

**POURING SEQUENCE - UNIT 6 OR 7**

INDICATES THE NUMBER AND DIRECTION OF POUR

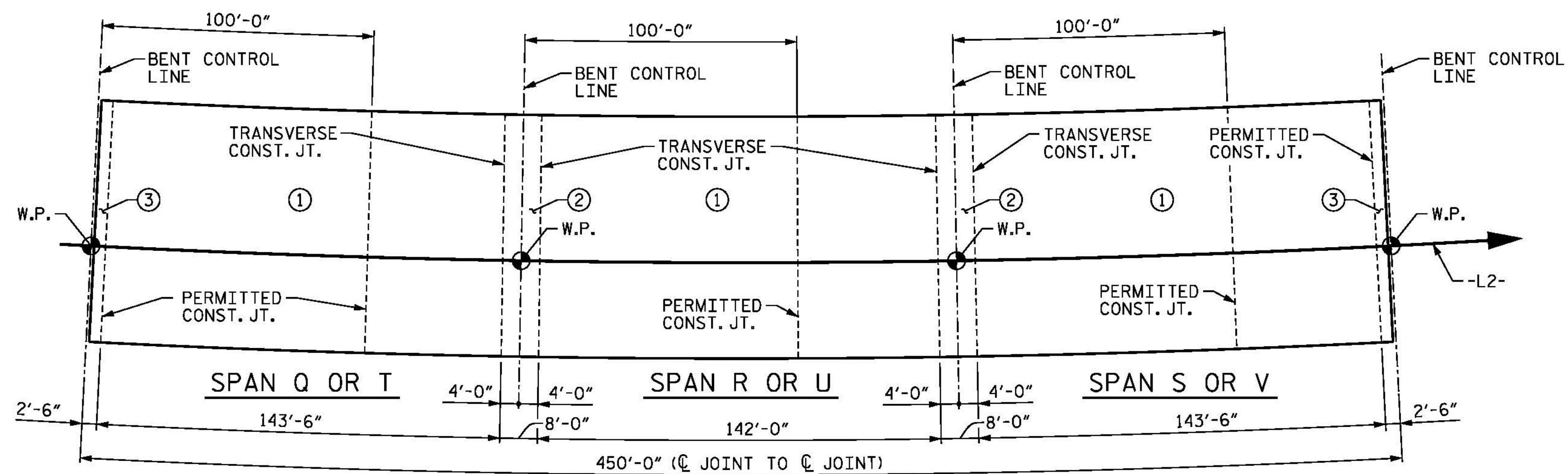

**OPTIONAL POURING SEQUENCE - UNIT 6 OR 7**

POUR ② CANNOT BE STARTED UNTIL BOTH ADJACENT POUR ①'S REACH A MINIMUM OF 3,000 PSI.

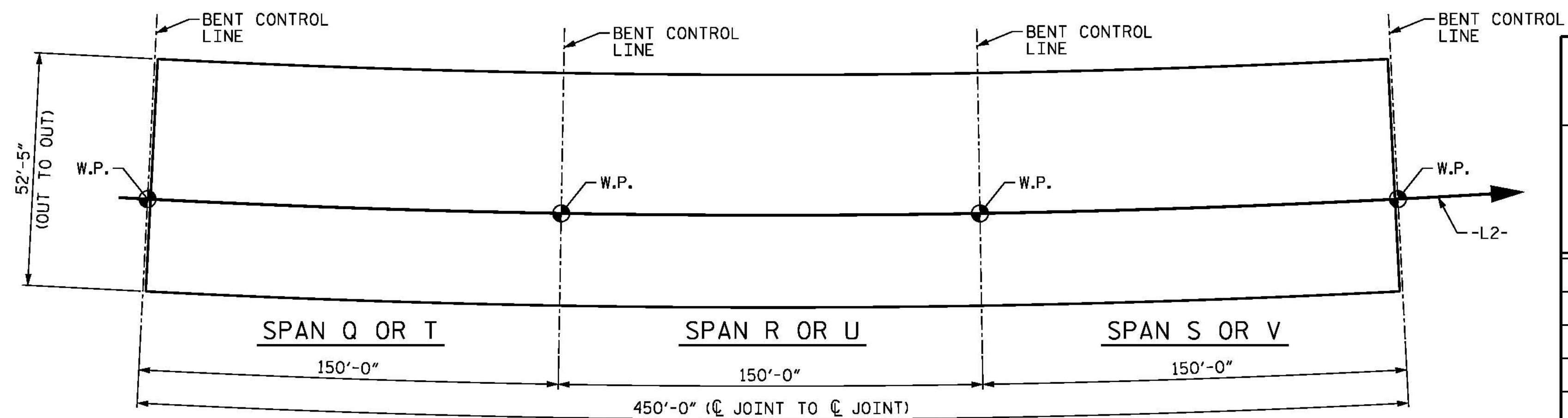

LAYOUT FOR COMPUTING AREA REINFORCED CONCRETE DECK SLAB (SQ. FT. = 23,494 SF)

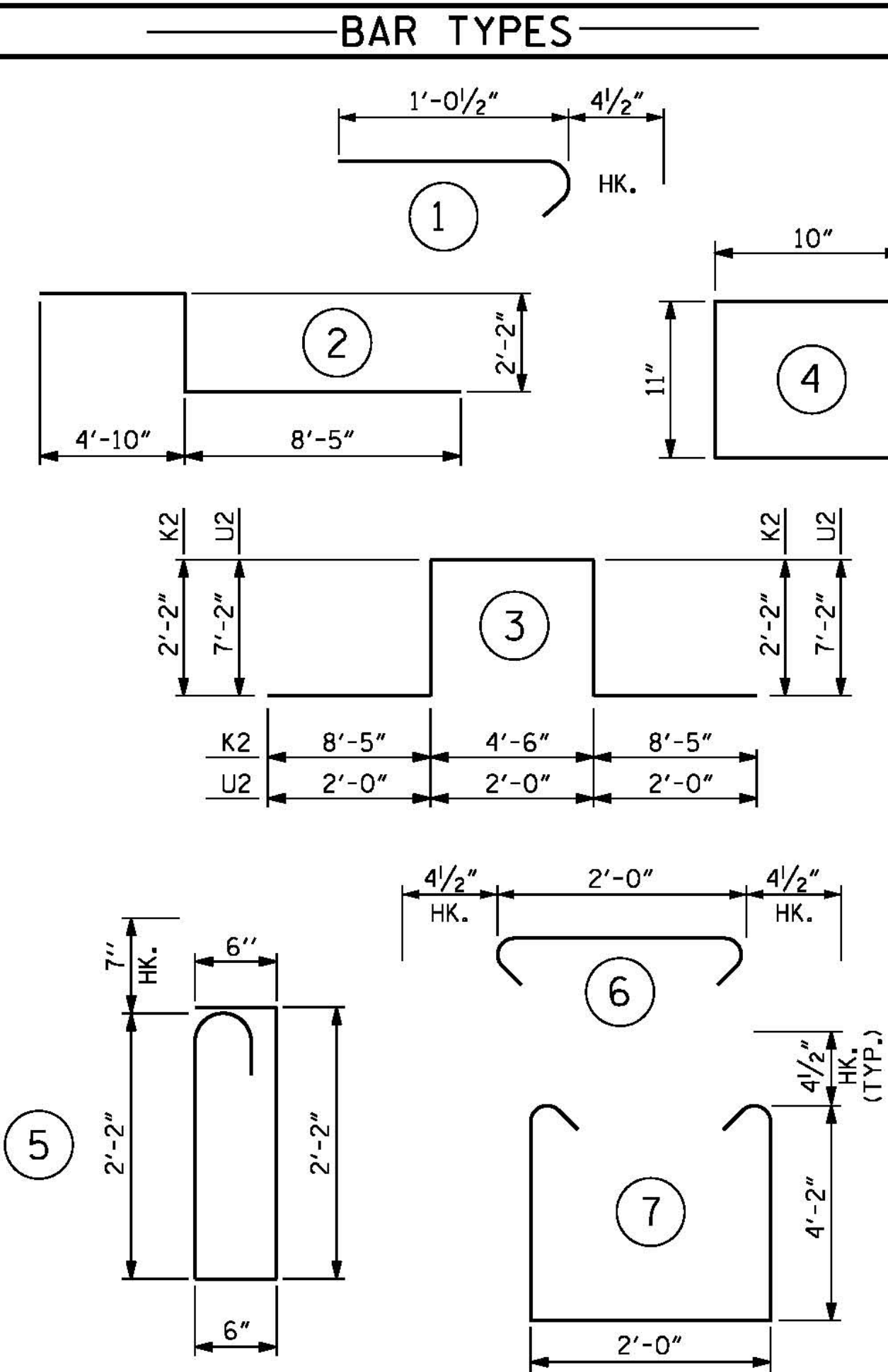

ALL BAR DIMENSIONS ARE OUT TO OUT

**SUPERSTRUCTURE BILL OF MATERIAL**

	CLASS AA CONCRETE (CU. YDS.)	EPOXY COATED REINFORCING STEEL (LBS.)
POUR 1	193.3	-
POUR 2	229.8	-
POUR 3	236.0	-
POUR 4	12.4	-
TOTALS**	671.5	141,863

**BILL OF MATERIAL**

FOR ONE UNIT

BAR	NO.	SIZE	TYPE	LENGTH	WEIGHT
* A1	842	#5	STR	52'-0"	45667
* A2	842	#5	STR	4'-0"	3513
* A3	842	#6	STR	15'-1"	19076
* B1	568	#4	STR	27'-7"	10466
* B2	142	#7	STR	40'-6"	11755
* B3	284	#7	STR	35'-0"	20317
* B4	136	#7	STR	47'-0"	13065
* B5	142	#4	STR	30'-0"	2846
* B6	152	#5	STR	59'-3"	9393
* B7	12	#5	STR	57'-6"	720
* B8	4	#5	STR	25'-0"	104
* B9	4	#5	STR	51'-0"	213
* G1	2	#5	STR	52'-0"	108
* J1	98	#4	1	1'-5"	93
* K1	8	#8	2	15'-5"	329
* K2	12	#8	3	25'-8"	822
* K3	16	#6	STR	6'-10"	164
* K4	32	#4	STR	6'-4"	135
* K5	16	#4	STR	9'-6"	102
* K6	64	#4	STR	10'-3"	438
* K7	28	#4	STR	23'-7"	441
* S1	56	#4	4	2'-7"	97
* S2	56	#5	5	5'-11"	346
* S3	416	#4	6	2'-9"	764
* U1	32	#4	7	11'-1"	237
* U2	48	#4	3	20'-4"	652

\* EPOXY COATED REINFORCING STEEL (LBS.) 141,863

\*\* QUANTITIES FOR BARRIER RAIL AND PARAPET ARE NOT INCLUDED. NOTE: QUANTITIES ARE FOR ONE UNIT ONLY

**SUPERSTRUCTURE REINFORCING STEEL LENGTHS ARE BASED ON THE FOLLOWING MINIMUM SPLICE LENGTHS**

BAR SIZE	SUPERSTRUCTURE EXCEPT APPROACH SLABS, PARAPET, AND BARRIER RAIL		APPROACH SLABS		PARAPET AND BARRIER RAIL
	EPOXY COATED	UNCOATED	EPOXY COATED	UNCOATED	
#4	2'-0"	1'-9"	2'-0"	1'-9"	2'-9"
#5	2'-6"	2'-2"	2'-6"	2'-2"	3'-5"
#6	3'-0"	2'-7"	3'-10"	2'-7"	4'-4"
#7	5'-3"	3'-6"			
#8	6'-10"	4'-7"			

**GROOVING BRIDGE FLOORS**

BRIDGE DECK	19315 SQ.FT.
TOTAL	19,315 SQ.FT.

**PARSONS BRINCKERHOFF**  
434 FAYETTEVILLE STREET  
SUITE 1500  
RALEIGH, NC 27601  
LICENSE NO. F-0165

DocuSigned by:  
*Jason R. Doughty*  
5/12/16  
00F1C8648274F7...

PROJECT NO. B-4929  
PENDER COUNTY  
STATION: 38+13.81 -L2-  
SHEET 6 OF 9

STATE OF NORTH CAROLINA  
DEPARTMENT OF TRANSPORTATION  
RALEIGH

STANDARD  
SUPERSTRUCTURE  
BILL OF MATERIAL  
UNITS 6 AND 7

REVISIONS						SHEET NO.
NO.	BY:	DATE:	NO.	BY:	DATE:	TOTAL SHEETS
1			3			278
2			4			278

STD. NO. BOM2

5/11/2016 400\_283\_B4929\_SMU\_BOM\_06.dgn

DESIGNED BY: J. SMITH DATE: FEB 2016  
DRAWN BY: M. HOBBS DATE: MAR 2016  
CHECKED BY: B. LOFLIN DATE: MAR 2016  
DESIGN ENGINEER OF RECORD: J. DOUGHTY DATE: MAY 2016

DRAWN BY: JMB 5/87 REV. 8/16/99 RWW/LES  
CHECKED BY: SJD 9/87 REV. 5/1/06 TLA/GM  
REV. 10/1/11 MAA/GM