

NOTES

STIRRUPS IN CAP MAY BE SHIFTED AS NECESSARY TO CLEAR ANCHOR BOLTS.

HOOKS ON "V" BARS MAY BE TURNED AS NECESSARY FOR PLACING REINFORCING STEEL.

ALL STEEL IN THE DRILLED PIERS IS INCLUDED IN THE PAY ITEMS FOR "REINFORCING STEEL" AND "SPIRAL COLUMN REINFORCING STEEL".

THE CONTRACTOR'S ATTENTION IS CALLED TO THE FACT THAT THE LONGITUDINAL REINFORCEMENT FOR THE DRILLED PIERS IS DETAILED WITH 3 FEET OF EXTRA LENGTH.

ANCHORAGE FOR LUMINAIRE BRACKETS NOT SHOWN FOR CLARITY. REINFORCING STEEL MAY BE SHIFTED SLIGHTLY TO AVOID INTERFERENCE WITH LUMINAIRE BRACKET ANCHORAGE. FOR LUMINAIRE BRACKET DETAILS, SEE "ARCHITECTURAL METAL FASCIA DETAILS" SHEETS.

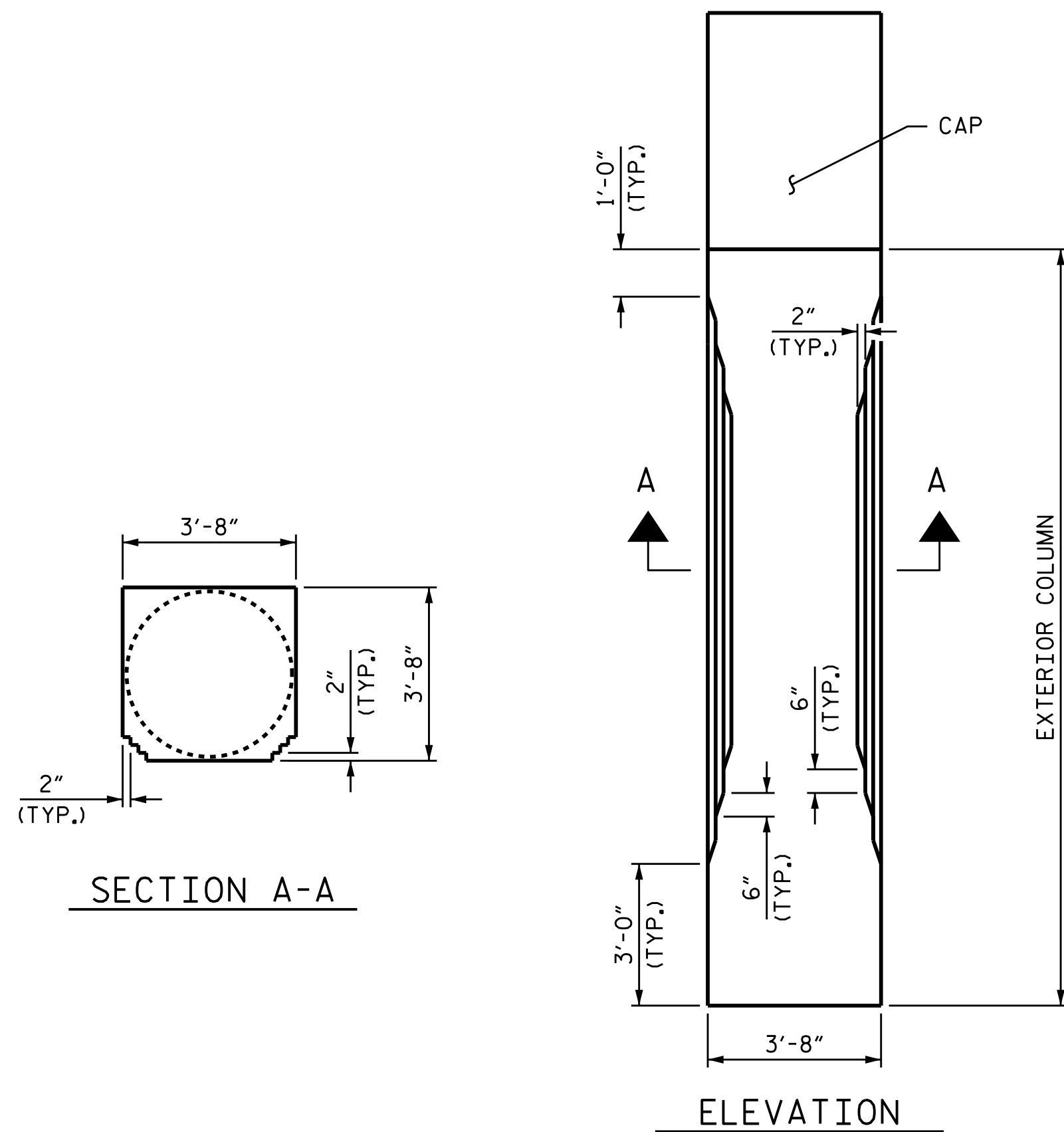

END VIEW OF EXTERIOR COLUMN

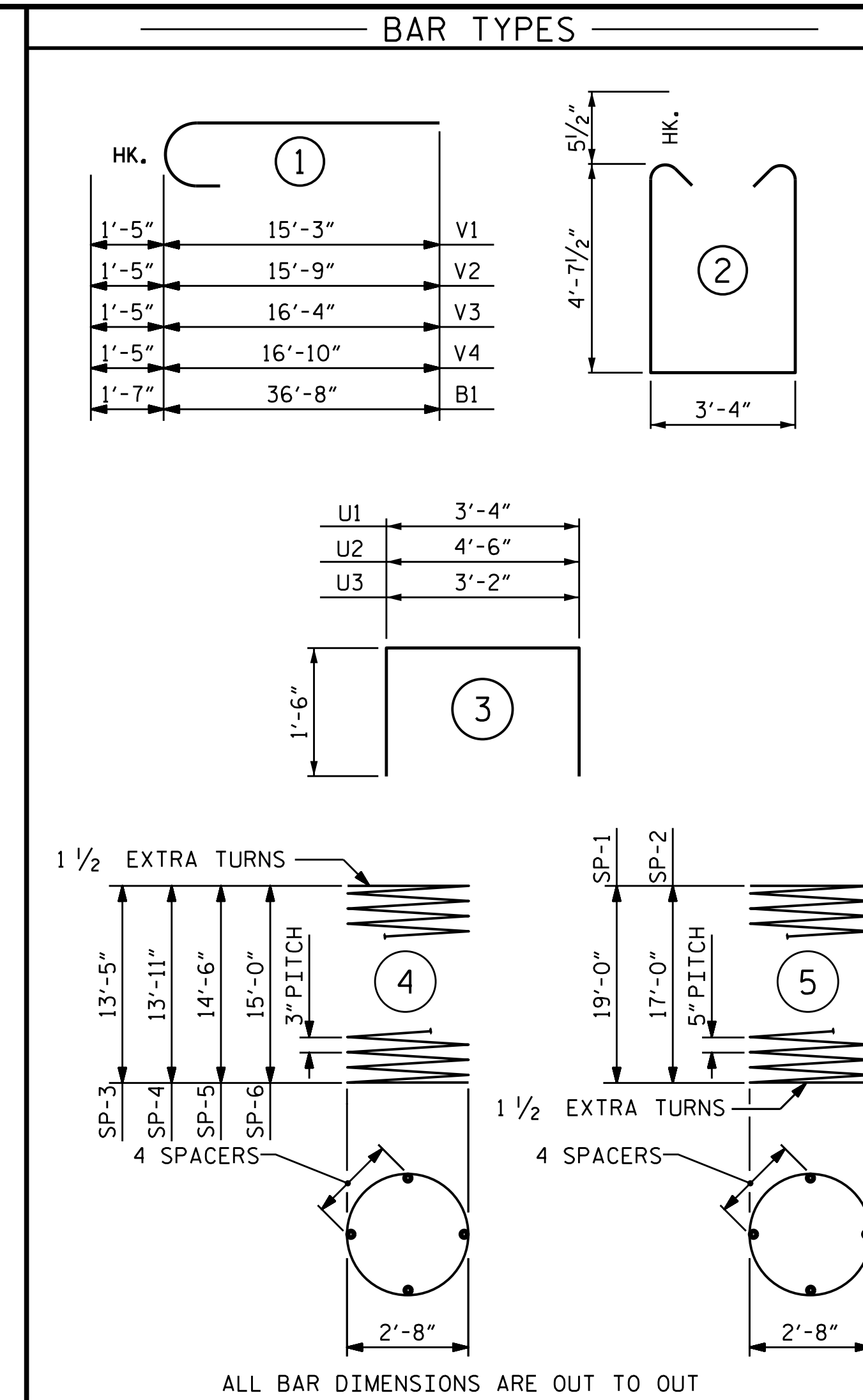

BILL OF MATERIAL

BENT 1

BAR	NO.	SIZE	TYPE	LENGTH	WEIGHT
B1	12	#11		38'-3"	2439
B2	6	#11	STR	59'-6"	1897
B3	18	#5	STR	59'-6"	1117
B4	30	#4	STR	3'-4"	67
B5	48	#4	STR	10'-10"	347
M1	24	#10	STR	28'-4"	2926
M2	24	#10	STR	26'-4"	2719
S1	53	#5	2	13'-6"	746
U1	45	#4	3	6'-4"	190
U2	6	#4	3	7'-6"	30
U3	8	#4	3	6'-2"	33
V1	12	#10	1	16'-8"	861
V2	12	#10	1	17'-2"	886
V3	12	#10	1	17'-9"	917
V4	12	#10	1	18'-3"	942
REINFORCING STEEL					16117 LBS.
SP-1	2	*	5	388'-8"	811
SP-2	2	*	5	349'-7"	729
SP-3	1	**	4	455'-11"	305
SP-4	1	**	4	472'-5"	316
SP-5	1	**	4	488'-11"	327
SP-6	1	**	4	507'-5"	339
SPIRAL COLUMN REINFORCING STEEL					2827 LBS.
CLASS A CONCRETE BREAKDOWN					
POUR #3 (CAP & ARCHES)					63.3 C.Y.
POUR #2 (COLUMNS)					14.5 C.Y.
TOTAL CLASS A CONCRETE					77.8 C.Y.
DRILLED PIER CONCRETE					
POUR #1 (DRILLED PIERS)					26.4 C.Y.
3'-6" Ø DRILLED PIER NOT IN SOIL					LIN. FT. 36.0
3'-6" Ø DRILLED PIER IN SOIL					LIN. FT. 38.0
CSL TUBES					LIN. FT. 320.0

** THE SP-3, SP-4, SP-5 AND SP-6 SPIRAL REINFORCING STEEL SHALL BE W20 OR D-20 COLD DRAWN WIRE OR #4 PLAIN OR DEFORMED BAR.

* THE SP-1 AND SP-2 SPIRAL REINFORCING STEEL SHALL BE W31 OR D-31 COLD DRAWN WIRE OR #5 PLAIN OR DEFORMED BAR.

PROJECT NO. B-5121/B-5317

WAKE COUNTY

STATION: 20+19.94 -FLYOVER-

SHEET 3 OF 3

STATE OF NORTH CAROLINA
DEPARTMENT OF TRANSPORTATION
RALEIGH

SUBSTRUCTURE
BENT 1

REVISIONS

NO.	BY:	DATE:	NO.	BY:	DATE:	SHEET NO.
1			3			S-93
2			4			TOTAL SHEETS 110

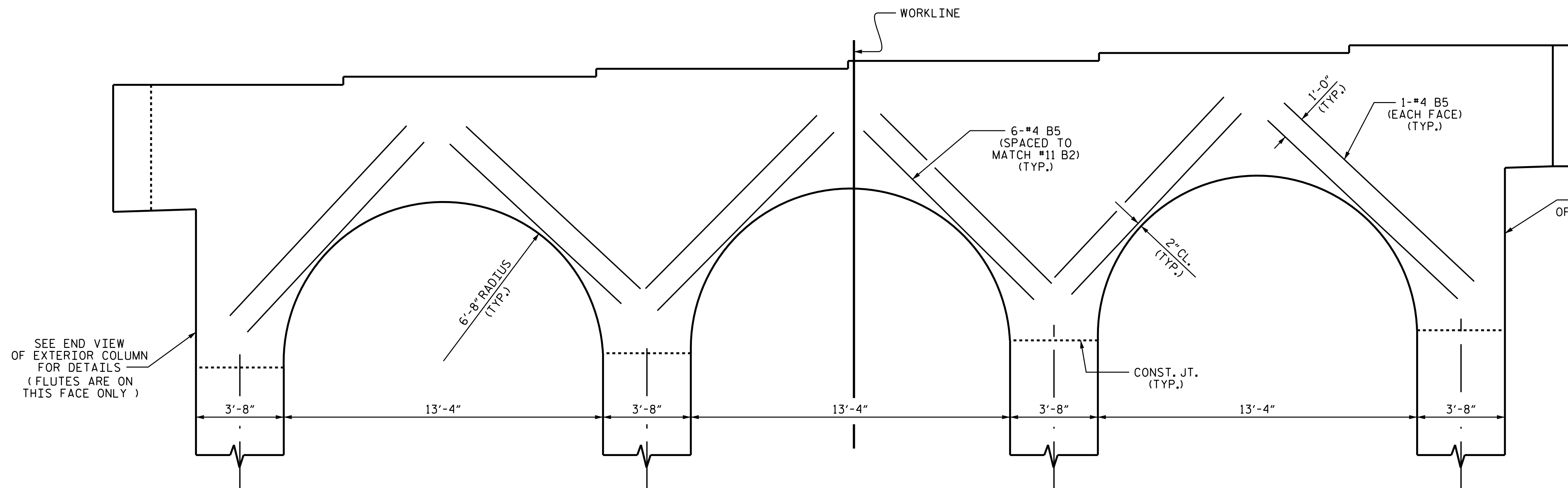

ARCH DETAILS

DRAWN BY : J.P. ADAMS DATE : 1/2016
CHECKED BY : I.L. AVERETTE DATE : 2/2016
DESIGN ENGINEER OF RECORD : R.L. CHESSON DATE : 2/2016

DOCUMENT NOT CONSIDERED FINAL UNLESS ALL SIGNATURES COMPLETED

