

OFF-SITE DETOUR WHEN FAIRVIEW RD. ON-RAMP TO SOUTHBOUND CAPITAL BLVD. IS CLOSED FOR ENTIRE PROJECT DURATION.

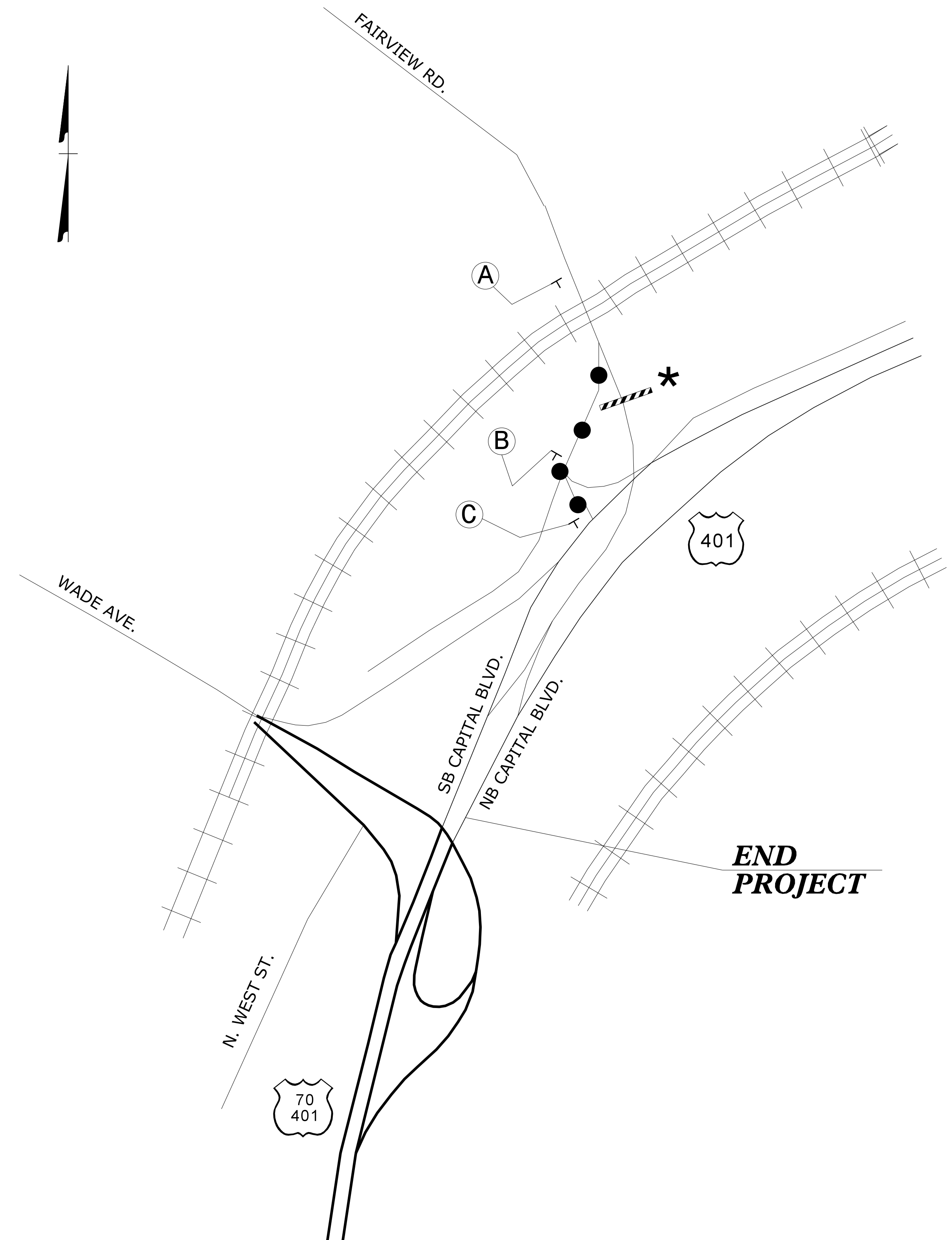

**DETOUR SIGNING**

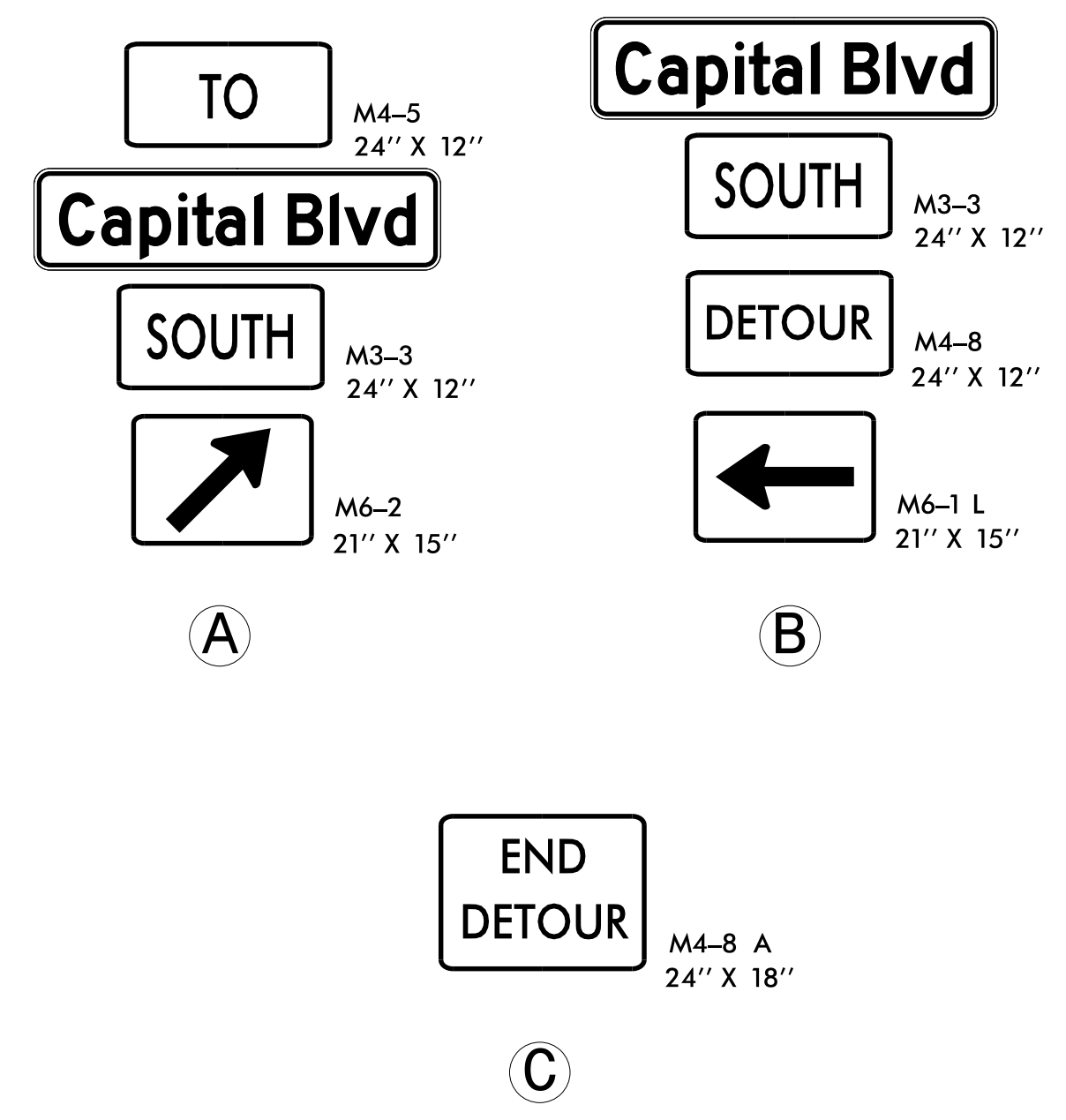

NOTES: SEE TMP-2B FOR "CAPITAL BLVD" SPECIAL SIGN DESIGN.  
 \* SEE RSD 1101.03, SHEET 2 OF 9, FOR TYPE III BARRICADE LOCATION WITH ATTACHED SIGNING & ADDITIONAL SIGNING FOR ROAD CLOSURE.

**DETOUR ROUTE** ● ● ●

2/1/2016 P:\2014\B-5121-B-5317\TrafficControl\Top\Current TMP Files\LANE'S CURRENT\B5121L5317\_TC\_TMP\_Wade\_psh17.dgn User:skennedy

**WETHERILL ENGINEERING**

TRANSPORTATION PLANNING/DESIGN - BRIDGE/STRUCTURE DESIGN  
 CIVIL/SITE DESIGN - GIS/GPS - CONSTRUCTION OBSERVATION

1223 Jones Franklin Rd.  
 Raleigh, N.C. 27606  
 License No. F-0377  
 Bus: 919 851 8077  
 Fax: 919 851 8107

**DOCUMENT NOT CONSIDERED FINAL  
 UNLESS ALL SIGNATURES COMPLETED**

APPROVED: \_\_\_\_\_ DATE: \_\_\_\_\_

SEAL

**TEMPORARY TRAFFIC CONTROL DETAIL**