

BEGIN CONSTRUCTION
-Y1- POT Sta. 10+20.00

-Y1- STA. 14+00
TIE TO EXIST.
PAVEMENT MARKINGS

COMPLETE WEDGING USING A TEMPORARY
LANE CLOSURE AND ONE LANE, TWO WAY
FLAGGER OPERATIONS

MATCHLINE -Y1- STA 17+50.00 (SHEET TMP-05)

-Y1- SR-2648 (OLD WINSTON RD)

-Y1- STA. 15+50
BEGIN WEDGING

BEGIN CONSTRUCTION
-L- POT Sta. 14+23.00

MATCHLINE -L- STA 17+50.00 (TMP-05 SHEET)

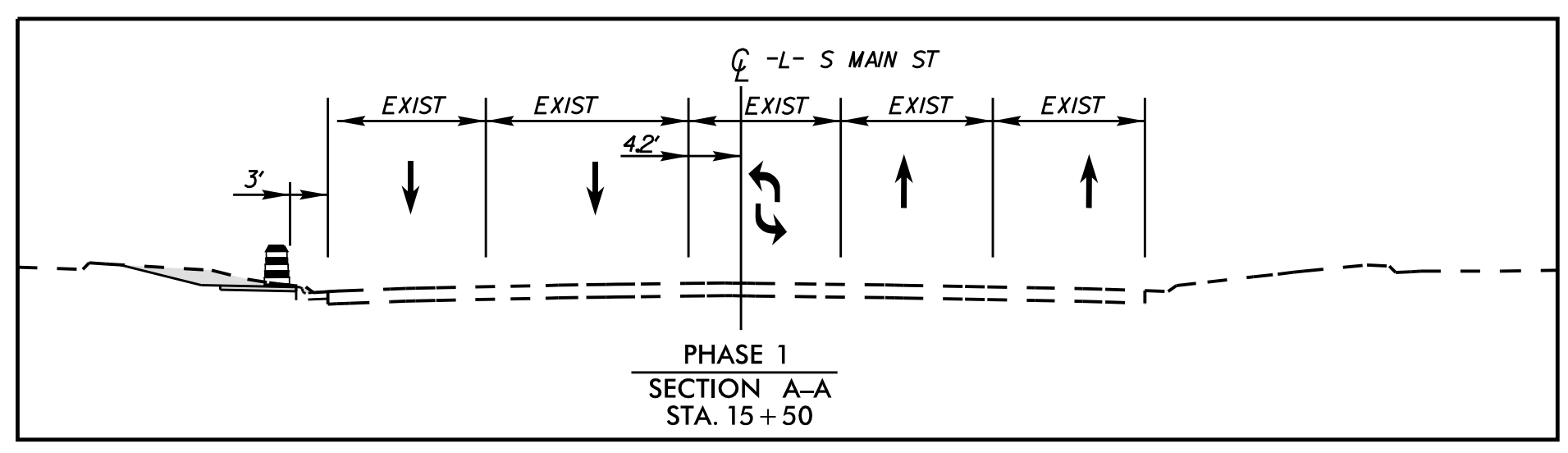

- WORK AREA
- PAVEMENT REMOVAL
- WEDGING

-L- SR-4315 (S MAIN ST)

DOCUMENT NOT CONSIDERED FINAL
UNLESS ALL SIGNATURES COMPLETED

APPROVED: _____ DATE: _____

SEAL

DocuSigned by:
Matt West
3/15/2016

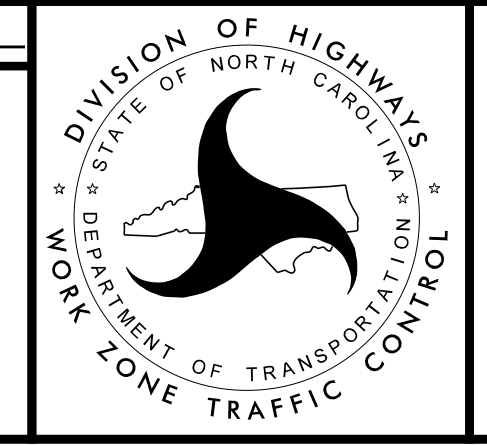

**TRAFFIC CONTROL
PHASE I**

K:\RAL_Roadway\01036245 - Kernersville\TrafficControl\TMP\W5510_TMP_PSH04.dgn 3/14/2016

