

**CIP GRAVITY WALL - TYPICAL SECTION (N.T.S.)**

\*\*SEE ROADWAY PLANS FOR FINISHED GRADE DETAILS.

ESTIMATED CAST-IN-PLACE GRAVITY RETAINING WALL QUANTITIES	
RETAINING WALL NO.	CAST-IN-PLACE GRAVITY RETAINING WALLS
2	1,375 SF
3A	175 SF
3B	190 SF
<b>TOTAL QUANTITY = 1,740 SF</b>	

**NOTES:**

- FOR CAST-IN-PLACE (CIP) GRAVITY RETAINING WALLS, SEE CAST-IN-PLACE GRAVITY RETAINING WALLS PROVISION.
- FOR HANDRAILS ON TOP OF WALLS, SEE ROADWAY PLANS FOR HANDRAIL ATTACHMENT DETAILS.
- FOR SUBSURFACE DRAINAGE AT WEEP HOLES, SEE ARTICLE 414-8 OF THE STANDARD SPECIFICATIONS.
- BEFORE BEGINNING CIP GRAVITY WALL CONSTRUCTION, SURVEY WALL LOCATIONS AND SUBMIT WALL PROFILE VIEWS (WALL ENVELOPES) FOR REVIEW. FOR WALL ENVELOPES, INCLUDE BOTTOM OF WALL, EXISTING GROUND AND GRADE ELEVATIONS AND OTHER ELEVATIONS AS NEEDED AT INTERVALS OF 25' OR LESS ALONG WALLS. DO NOT START WALL CONSTRUCTION UNTIL WALL ENVELOPES ARE ACCEPTED.
- FACE FOR RETAINING WALL NO. 2, 3A AND 3B SHALL BE SMOOTH CONCRETE WITH NO ADORNMENT.
- DO NOT PLACE CONCRETE FOR FOOTINGS UNTIL EXCAVATION DIMENSIONS AND FOUNDATION MATERIAL ARE APPROVED.
- WHEN CONSTRUCTING CIP GRAVITY WALLS WITH A CONSTRUCTION JOINT AS SHOWN IN DETAIL "A", PROVIDE A MINIMUM OF 3 EQUALLY SPACED #4 DOWELS AT INTERVALS OF 1'-6" ALONG WALLS.

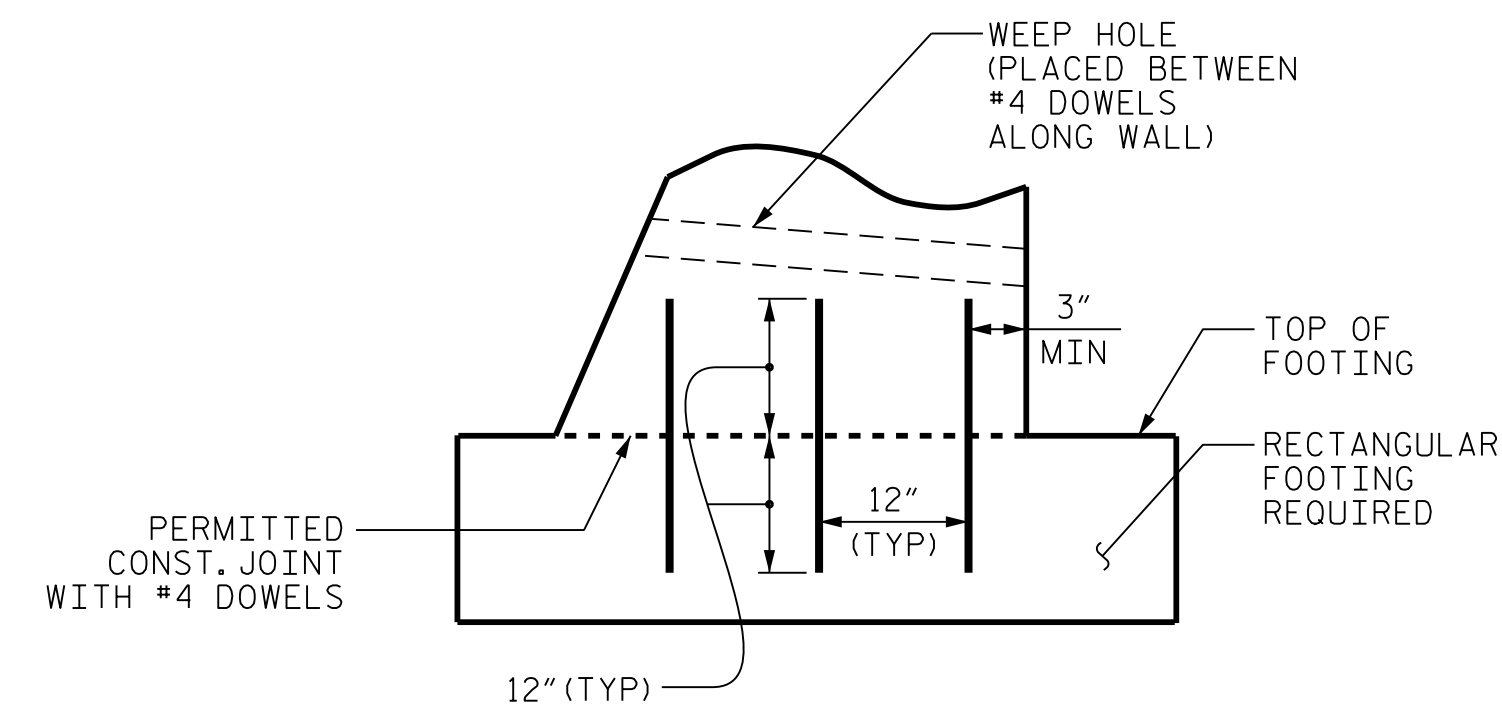

**DETAIL "A" (N.T.S.)**

RETAINING WALL NO.	H < 6 FT	H > 6 FT
2	.80	.75*
3A, 3B	.60	.60

**B/H RATIO (B = 2'-6" MIN)**

\*KEY IS REQUIRED WHEN H IS 6' OR GREATER FOR RETAINING WALL NO. 2.

PROJECT NO.: U-3308 (34915.1.1)  
 DURHAM COUNTY  
 STATION: SEE WALL NO. 2, 3A AND 3B  
 SHEET 8 OF 8

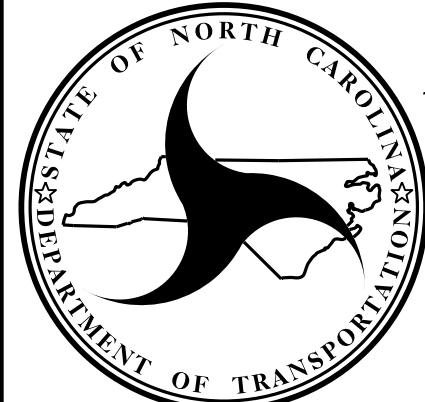

**NORTH CAROLINA  
DEPARTMENT OF TRANSPORTATION  
DIVISION OF HIGHWAYS**

**GEOTECHNICAL  
ENGINEERING UNIT**

NOTES AND DETAILS OF CAST-IN-PLACE (CIP) GRAVITY RETAINING WALL					
REVISIONS					
NO.	BY	DATE	NO.	BY	DATE
1	-	-	3	-	-
2	-	-	4	-	-

SHEET NO. W-8