

NSR BRIDGE MP H-56.10
CSXT BRIDGE MP SB-154.61

PROJECT REFERENCE NO. U-3308	SHEET NO. RR-9DET
RW SHEET NO.	
RAIL DESIGN ENGINEER	HYDRAULICS ENGINEER

DETOUR TRACK PLANS

FOR -NSD2- PROFILE SEE SHEETS RR-22 THROUGH RR-24

CURVE 6	
PI Sta. 26+50.68	PIs Sta. 27+58.66
$\Delta = 3^{\circ}00'00.0''$ (LT)	$\Theta_s = 1^{\circ}23'41.7''$
$D = 2^{\circ}15'00''$ (CHORD)	$L_s = 124.00'$
$L = 133.33'$	$LT = 82.67'$
$T = 66.69'$	$ST = 41.34'$
$R = 2546.64'$	
$V = 55\text{mph}$ PASSENGER	
$V = 50\text{mph}$ FREIGHT	
$SE_{N/C} = 2''$	

MATCH LINE SHEET RR-8DET

MATCH LINE SHEET RR-10DET

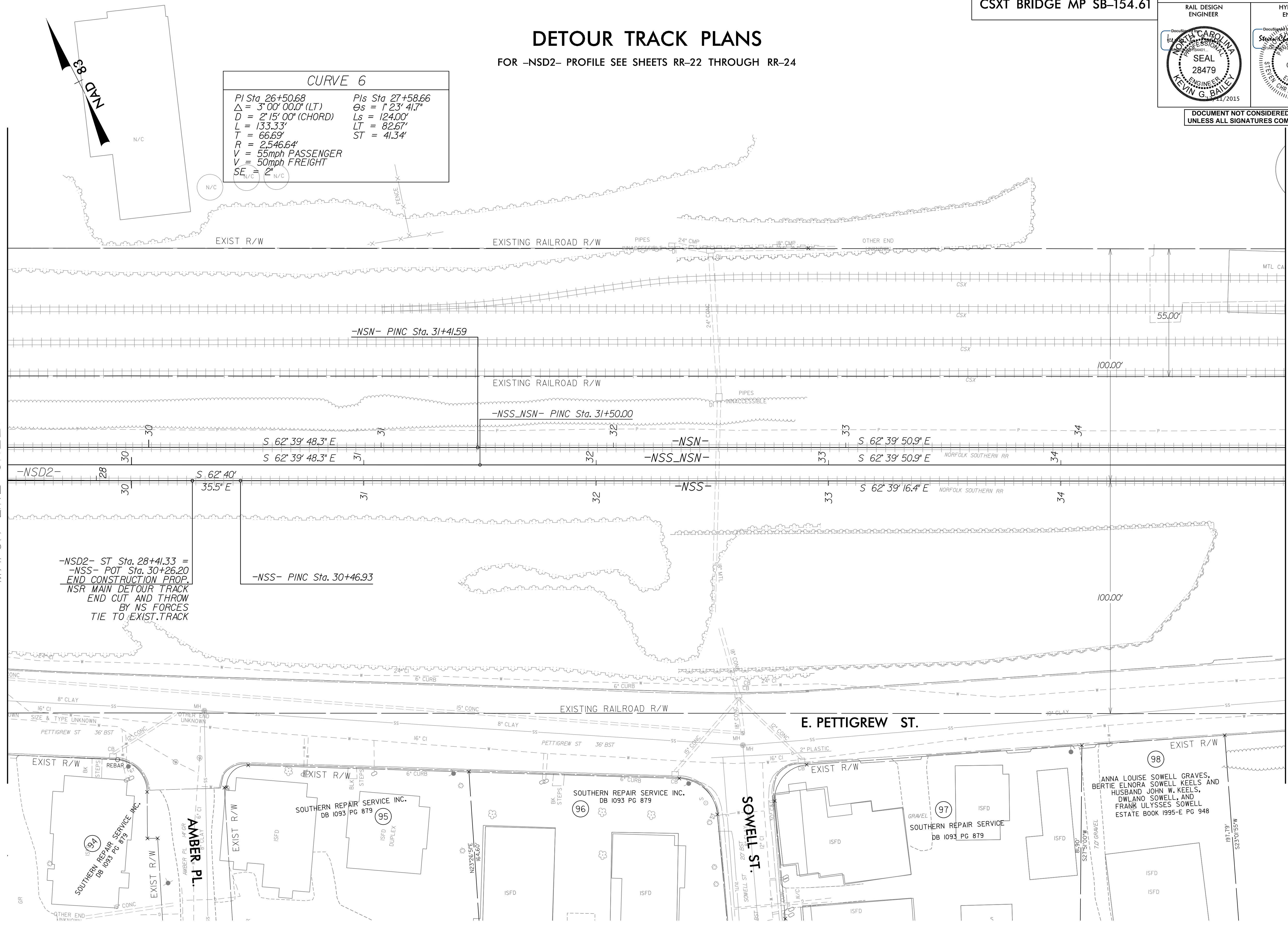

-NSD2- ST Sta. 28+41.33 =
-NSS- POT Sta. 30+26.20
END CONSTRUCTION PROP.
NSR MAIN DETOUR TRACK
END CUT AND THROW
BY NS FORCES
TIE TO EXIST. TRACK

-NSS- PINC Sta. 30+46.93

-NSN- PINC Sta. 31+41.59

-NSS-NSN- PINC Sta. 31+50.00

13/1/2015 2:51:32 PM \\station\track\RAWA_u3308_r.dwg_r.r.rr-9A.dgn
 11/18/2015 10:55:00 AM

ANNA LOUISE SOWELL GRAVES,
BERTIE ELNORA SOWELL KEELS AND
HUSBAND JOHN W. KEELS,
DWLANO SOWELL, AND
FRANK ULYSSES SOWELL
ESTATE BOOK 1995-E PG 948

SOUTHERN REPAIR SERVICE INC.
DB 1093 PG 879

SOUTHERN REPAIR SERVICE INC.
DB 1093 PG 879

SOUTHERN REPAIR SERVICE INC.
DB 1093 PG 879

SOUTHERN REPAIR SERVICE
DB 1093 PG 879