

8/17/99

PROJECT REFERENCE NO. U-3308		SHEET NO. RR-2	
RW SHEET NO.			
RAIL DESIGN ENGINEER		HYDRAULICS ENGINEER	
DOCUMENT NOT CONSIDERED FINAL UNLESS ALL SIGNATURES COMPLETED			

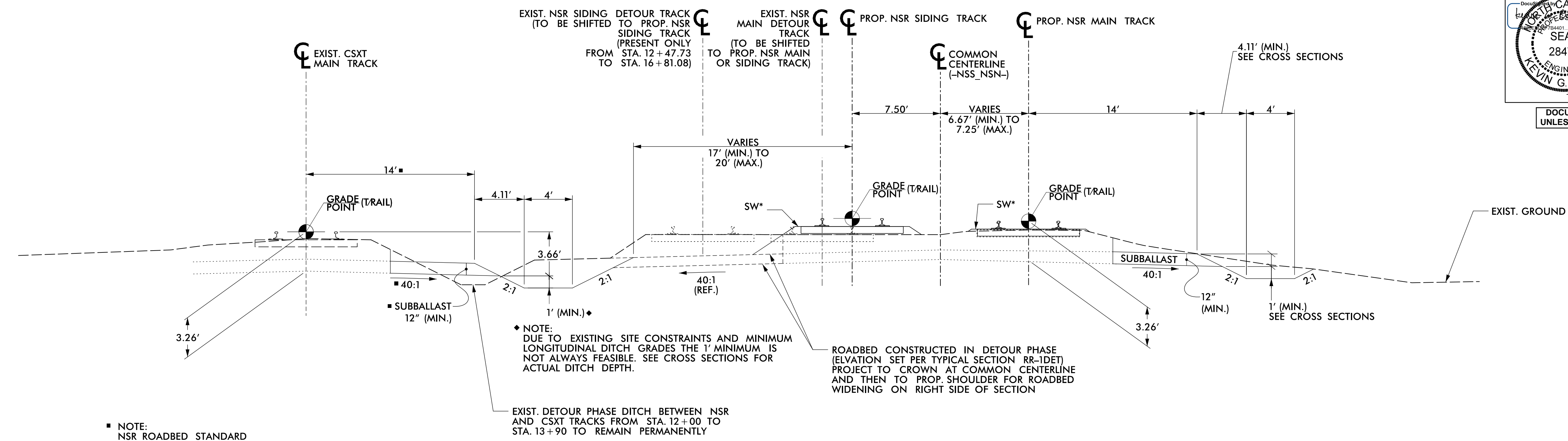

NOTE:
NSR ROADBED STANDARD
USED FOR CONSISTENCY SINCE
SATISFIES CSXT ROADBED STANDARDS

NOTE:
DUE TO EXISTING SITE CONSTRAINTS AND MINIMUM
LONGITUDINAL DITCH GRADES THE 1' MINIMUM IS
NOT ALWAYS FEASIBLE. SEE CROSS SECTIONS FOR
ACTUAL DITCH DEPTH.

ROADBED CONSTRUCTED IN DETOUR PHASE
(ELEVATION SET PER TYPICAL SECTION RR-IDET)
PROJECT TO CROWN AT COMMON CENTERLINE
AND THEN TO PROP. SHOULDER FOR ROADBED
WIDENING ON RIGHT SIDE OF SECTION

EXIST. DETOUR PHASE DITCH BETWEEN NSR
AND CSXT TRACKS FROM STA. 12+00 TO
STA. 13+90 TO REMAIN PERMANENTLY

TYPICAL SECTION RR-1
-NSS_NSN- STA. 11+90.00 TO STA. 18+00.00 (BK)
-NSS_NSN- STA. 25+00.00(AH) TO STA. 30+26.00

SHOULDER WIDTH (SW)

NS SW (INSIDE OF CURVE)	6"
NS SW (OUTSIDE OF CURVE)	12"
NS SW (TANGENT BOTH SIDES)	6"
CSXT SW	12"

NOTE:
1. ALL PROP. TRACK CONSTRUCTION SHALL EMPLOY
136 RE CONTINUOUSLY WELDED RAIL (CWR)

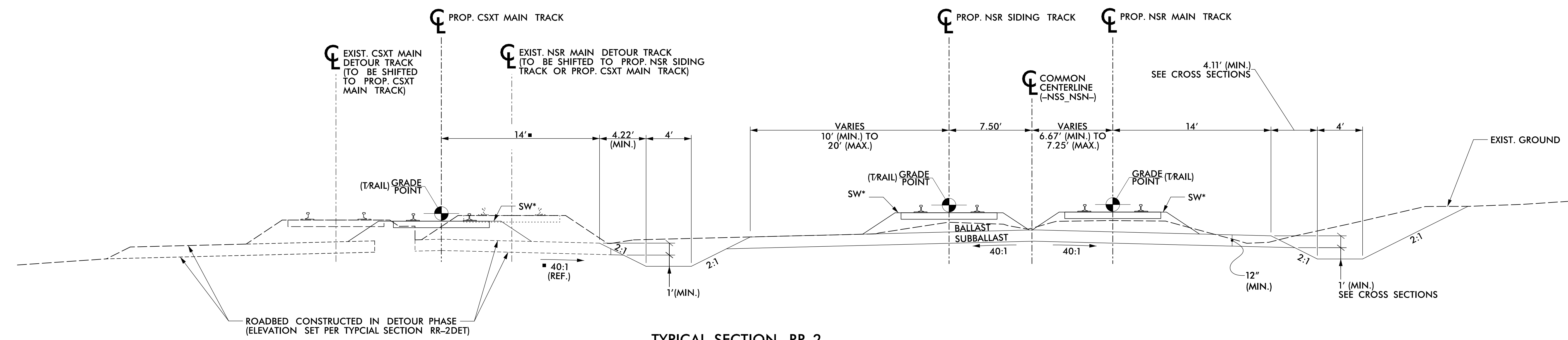

TYPICAL SECTION RR-2
STA. 18+00.00(AH) TO BRIDGE ABUTMENT #1
BRIDGE ABUTMENT #2 TO STA. 25+00.00(BK)

I:\5\2016\1\YFRO\2513251\station\track\NSR\NSR_u3308_rdy.ps_RR-2.dgn