

POURING SEQUENCE
(STAGE I)

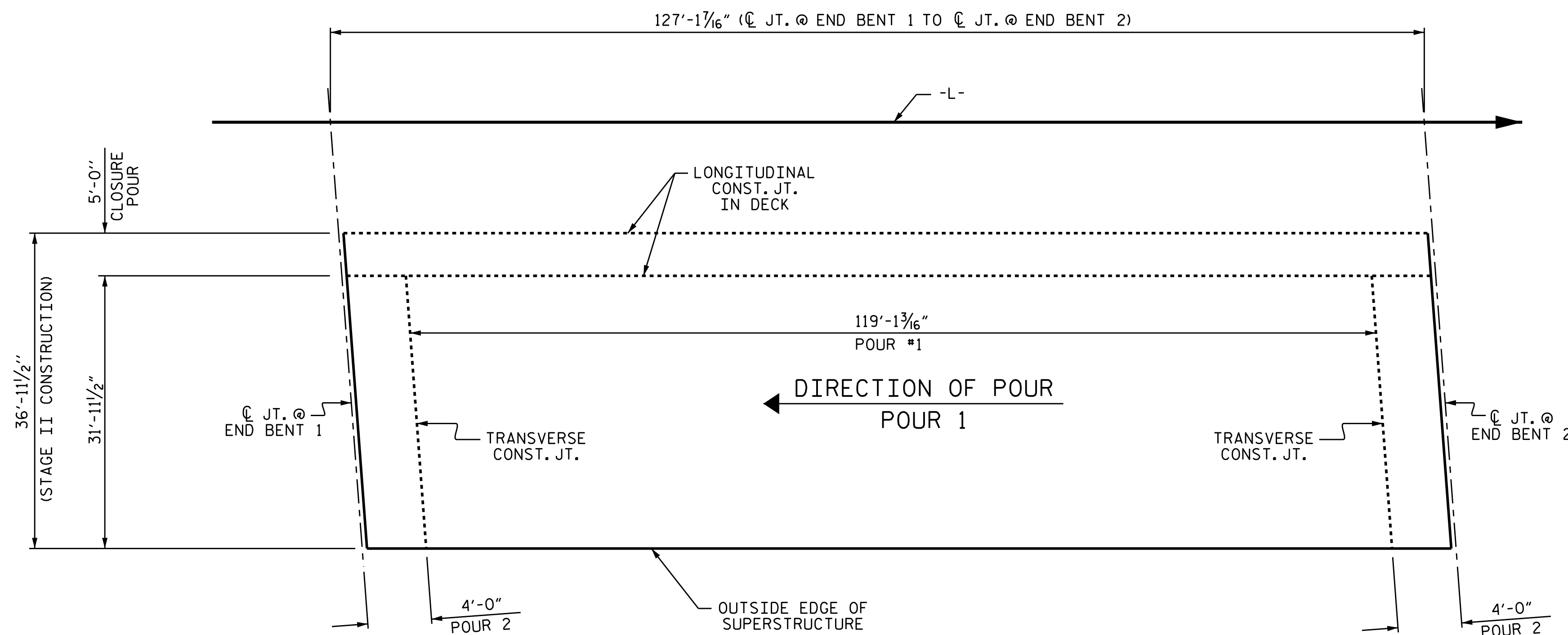

POURING SEQUENCE
(STAGE II)

CLASS AA CONCRETE BREAKDOWN	
STAGE I	
POUR 1	235.0 C.Y.
POUR 2	19.0 C.Y.
SIDEWALK	12.7 C.Y.
TOTAL	266.7 C.Y.
STAGE II	
POUR 1	120.2 C.Y.
POUR 2	9.5 C.Y.
5'-0" CLOSURE POUR	22.6 C.Y.
SIDEWALK	15.6 C.Y.
TOTAL	167.9 C.Y.
STAGE III	
CONCRETE MEDIAN	7.0 C.Y.

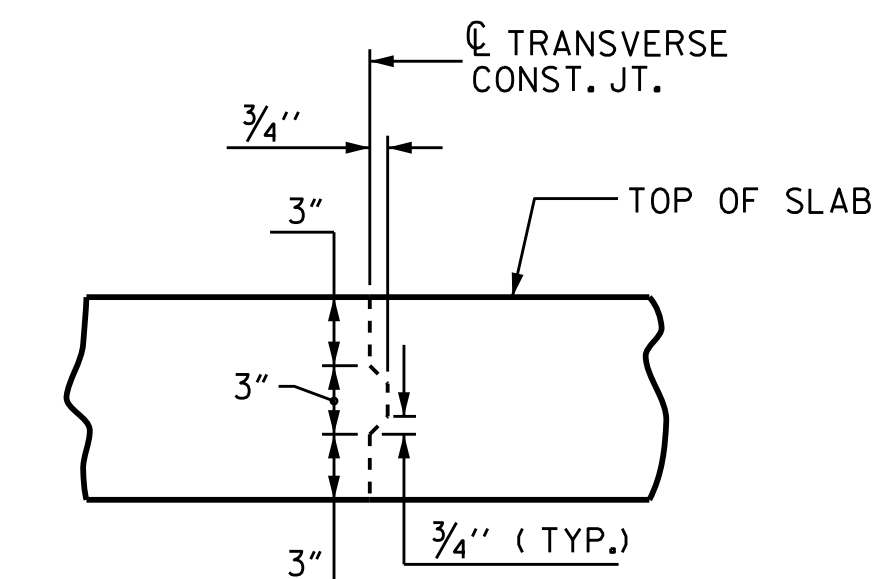

TRANSVERSE CONSTRUCTION JOINT DETAIL

NOTE: REINFORCING STEEL IN SLAB NOT SHOWN.
LONGITUDINAL REINFORCING STEEL SHALL BE CONTINUOUS THRU JOINT.

PROJECT NO. B-4490
CUMBERLAND COUNTY
STATION: 35+23.40 -L-



DocuSigned by:
F24583890BF40E
3/29/2016

STATE OF NORTH CAROLINA
DEPARTMENT OF TRANSPORTATION
RALEIGH
SUPERSTRUCTURE
CONCRETE DECK
POUR DETAILS

DRAWN BY : I.L. AVERETTE DATE : 02-15
CHECKED BY : J.P. ADAMS DATE : 07-15
DESIGN ENGINEER OF RECORD: I.L. AVERETTE DATE : 09-15

DOCUMENT NOT CONSIDERED
FINAL UNLESS ALL
SIGNATURES COMPLETED

REVISIONS						SHEET NO.
NO.	BY:	DATE:	NO.	BY:	DATE:	S-72
1			3			TOTAL SHEETS
2			4			84