

NOTES

GROOVED CONTRACTION JOINTS, 1/2" IN DEPTH, SHALL BE TOOLED IN ALL EXPOSED FACES OF THE MEDIAN IN ACCORDANCE WITH ARTICLE 825-10(B) OF THE STANDARD SPECIFICATIONS. THE CONTRACTION JOINTS SHALL BE LOCATED AT A SPACING OF 8 FT. TO 10 FT. BETWEEN EXPANSION JOINTS. NO CONTRACTION JOINT WILL BE REQUIRED FOR SEGMENTS LESS THAN 10 FT. IN LENGTH.

ALL REINFORCING STEEL IN THE CONCRETE MEDIAN SHALL BE EPOXY COATED.

FOR CONCRETE MEDIAN REINFORCING STEEL AND CONCRETE QUANTITIES, SEE SUPERSTRUCTURE "BILL OF MATERIAL."

FOR CONCRETE MEDIAN ON APPROACH SLAB, SEE APPROACH SLAB SHEETS.

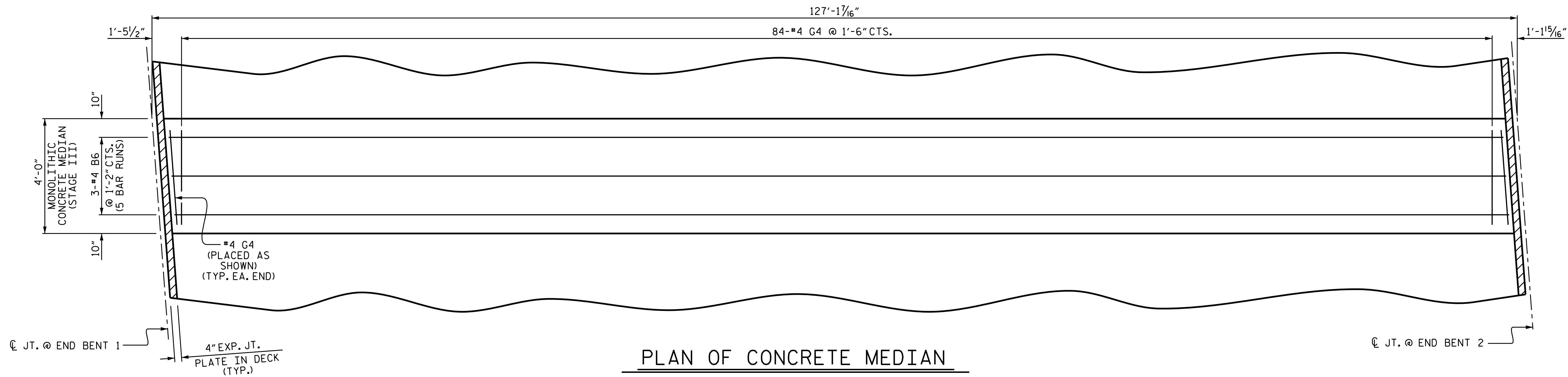

PLAN OF CONCRETE MEDIAN

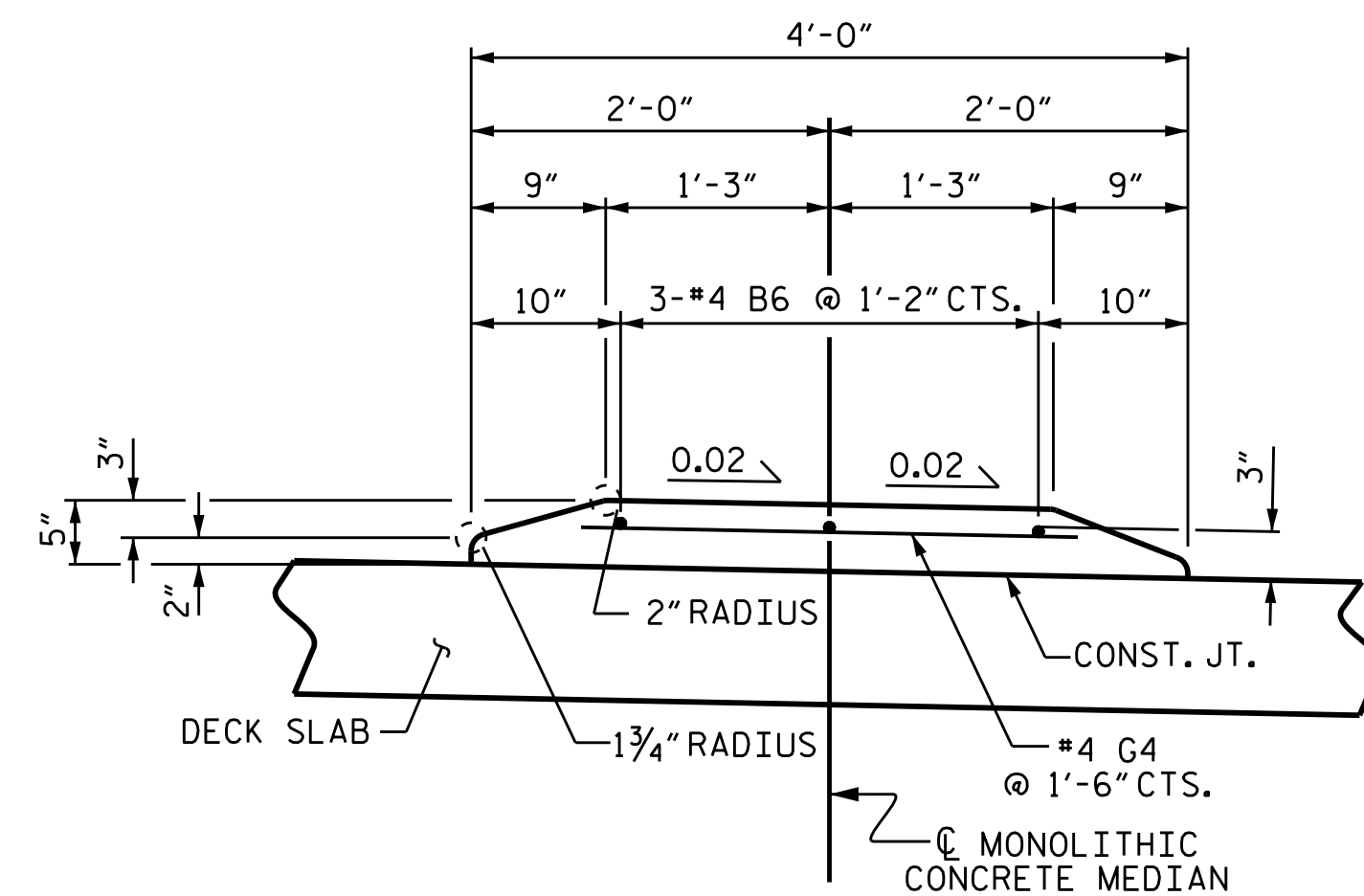

REINFORCING STEEL DETAILS

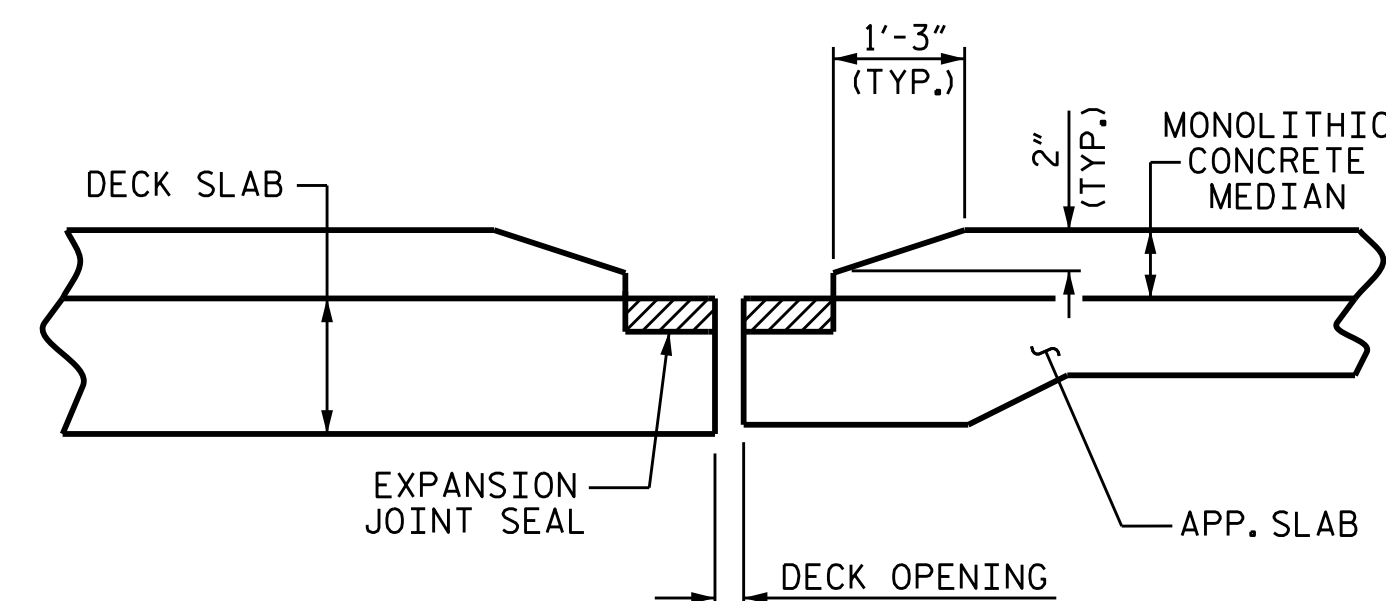

SECTION AT EXPANSION JOINT

PERMANENT CONCRETE MEDIAN DETAILS

PROJECT NO. B-4490  
CUMBERLAND COUNTY  
 STATION: 35+23.40 -L-



DocuSigned by: *[Signature]*  
 F2458389308F40E...

3/29/2016

STATE OF NORTH CAROLINA  
 DEPARTMENT OF TRANSPORTATION  
 RALEIGH  
 SUPERSTRUCTURE  
 MONOLITHIC  
 CONCRETE MEDIAN  
 STAGE III

DRAWN BY : I.L. AVERETTE DATE : 11-14  
 CHECKED BY : J.P. ADAMS DATE : 07-15  
 DESIGN ENGINEER OF RECORD: I.L. AVERETTE DATE : 09-15

DOCUMENT NOT CONSIDERED  
 FINAL UNLESS ALL  
 SIGNATURES COMPLETED

REVISIONS						SHEET NO.
NO.	BY:	DATE:	NO.	BY:	DATE:	S-68
1			3			TOTAL SHEETS
2			4			84