

PHASING DIAGRAM

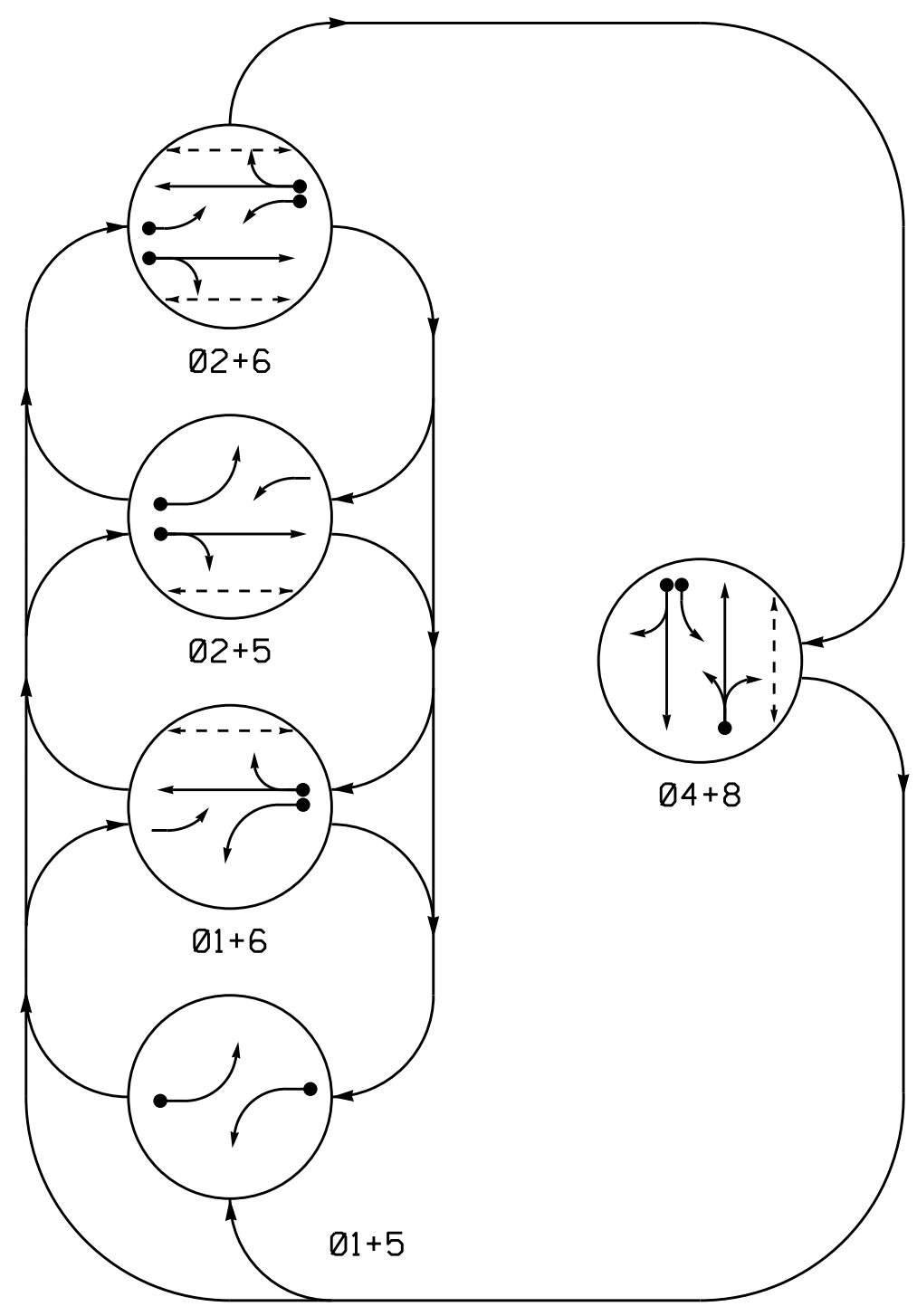

PHASING DIAGRAM DETECTION LEGEND
 ● DETECTED MOVEMENT
 ○ UNDETECTED MOVEMENT (OVERLAP)
 - - - UNSIGNALIZED MOVEMENT
 - - - PEDESTRIAN MOVEMENT

TABLE OF OPERATION

SIGNAL FACE	PHASE					
	01+5	01+6	02+5	02+6	04+8	FL HSD
11	←	←	←	←	←	←
21,22	R	R	G	G	R	Y
41,42	R	R	R	R	G	R
51	←	←	←	←	←	←
61,62	R	G	R	G	R	Y
81,82	R	R	R	R	G	R
P21,P22	DW	DW	W	W	DW	DRK
P41,P42	DW	DW	DW	DW	W	DRK
P61,P62	DW	W	DW	W	DW	DRK
P81,P82*	DW	DW	DW	DW	W	DRK

* Disconnect and Bag
SIGNAL FACE I.D.
 All Heads L.E.D.

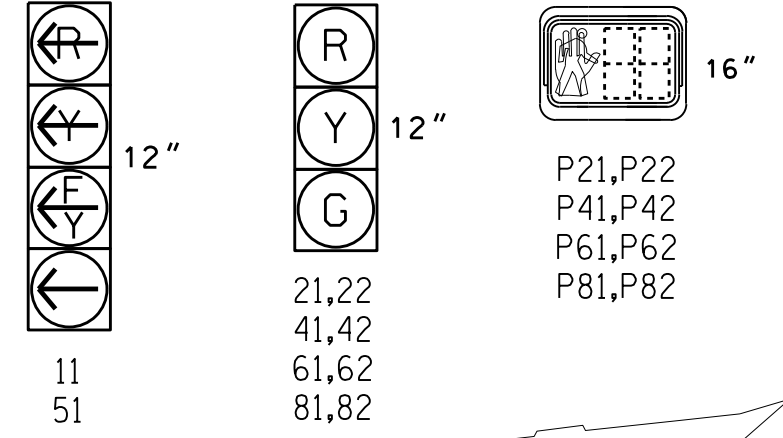

OASIS 2070 LOOP & DETECTOR INSTALLATION CHART

LOOP	SIZE (FT)	DISTANCE FROM STOPBAR (FT)	TURNS	NEW LOOP	DETECTOR PROGRAMMING						
					PHASE	CALLING	EXTENSION	STRETCH TIME	DELAY TIME	SYSTEM LOOP	NEW CARD
1A	6X40	0	2-4-2	-	1	Y	Y	-	15	-	-
					6	Y	Y	-	-	-	-
2A	6X6	70	4	-	2	Y	Y	-	-	-	-
2B	6X6	70	4	-	2	Y	Y	-	-	-	-
4A	6X50	0	*	-	4	Y	Y	-	10	-	-
5A	6X40	0	2-4-2	Y	5	Y	Y	-	15	-	-
					2	Y	Y	-	-	-	-
6A	6X6	70	4	-	6	Y	Y	-	-	-	-
6B	6X6	70	4	-	6	Y	Y	-	-	-	-
8A	6X40	+5	2-4-2	-	8	Y	Y	-	3	-	-
8B	6X40	+14	2-4-2	-	8	Y	Y	-	10	-	-

* Video Detection Zone

5 Phase Fully Actuated Fayetteville Signal System

NOTES

- Refer to "Roadway Standard Drawings NCDOT" dated January 2012 and "Standard Specifications for Roads and Structures" dated January 2012.
- Do not program signal for late night flashing operation unless otherwise directed by the Engineer.
- Phase 1 and/or phase 5 may be lagged.
- Set all detector units to presence mode.
- Omit "WALK" and flashing "DON'T WALK" with no pedestrian calls.
- Program pedestrian heads to countdown the flashing "Don't Walk" time only.
- Reposition heads 21,22,61, and 62.
- Maximum times shown in timing chart are for free-run operation only. Coordinated signal system timing values supersede these values.

PHASING DIAGRAM DETECTION LEGEND
 ● DETECTED MOVEMENT
 ○ UNDETECTED MOVEMENT (OVERLAP)
 - - - UNSIGNALIZED MOVEMENT
 - - - PEDESTRIAN MOVEMENT

OASIS 2070 TIMING CHART

FEATURE	PHASE					
	1	2	4	5	6	8
Min Green 1 *	7	10	7	7	10	7
Extension 1 *	2.0	3.0	2.0	2.0	3.0	2.0
Max Green 1 *	20	45	25	20	45	25
Yellow Clearance	3.0	4.1	3.3	3.0	4.1	3.3
Red Clearance	3.2	2.3	3.1	3.1	2.3	3.1
Walk 1 *	-	7	7	-	7	7
Don't Walk 1	-	11	18	-	19	21
Seconds Per Actuation *	-	-	-	-	-	-
Max Variable Initial *	-	-	-	-	-	-
Time Before Reduction *	-	-	-	-	-	-
Time To Reduce *	-	-	-	-	-	-
Minimum Gap	-	-	-	-	-	-
Recall Mode	-	MIN RECALL	-	-	MIN RECALL	-
Vehicle Call Memory	-	YELLOW	-	-	YELLOW	-
Dual Entry	-	-	ON	-	-	ON
Simultaneous Gap	ON	ON	ON	ON	ON	ON

* These values may be field adjusted. Do not adjust Min Green and Extension times for phases 2 and 6 lower than what is shown. Min Green for all other phases should not be lower than 4 seconds.

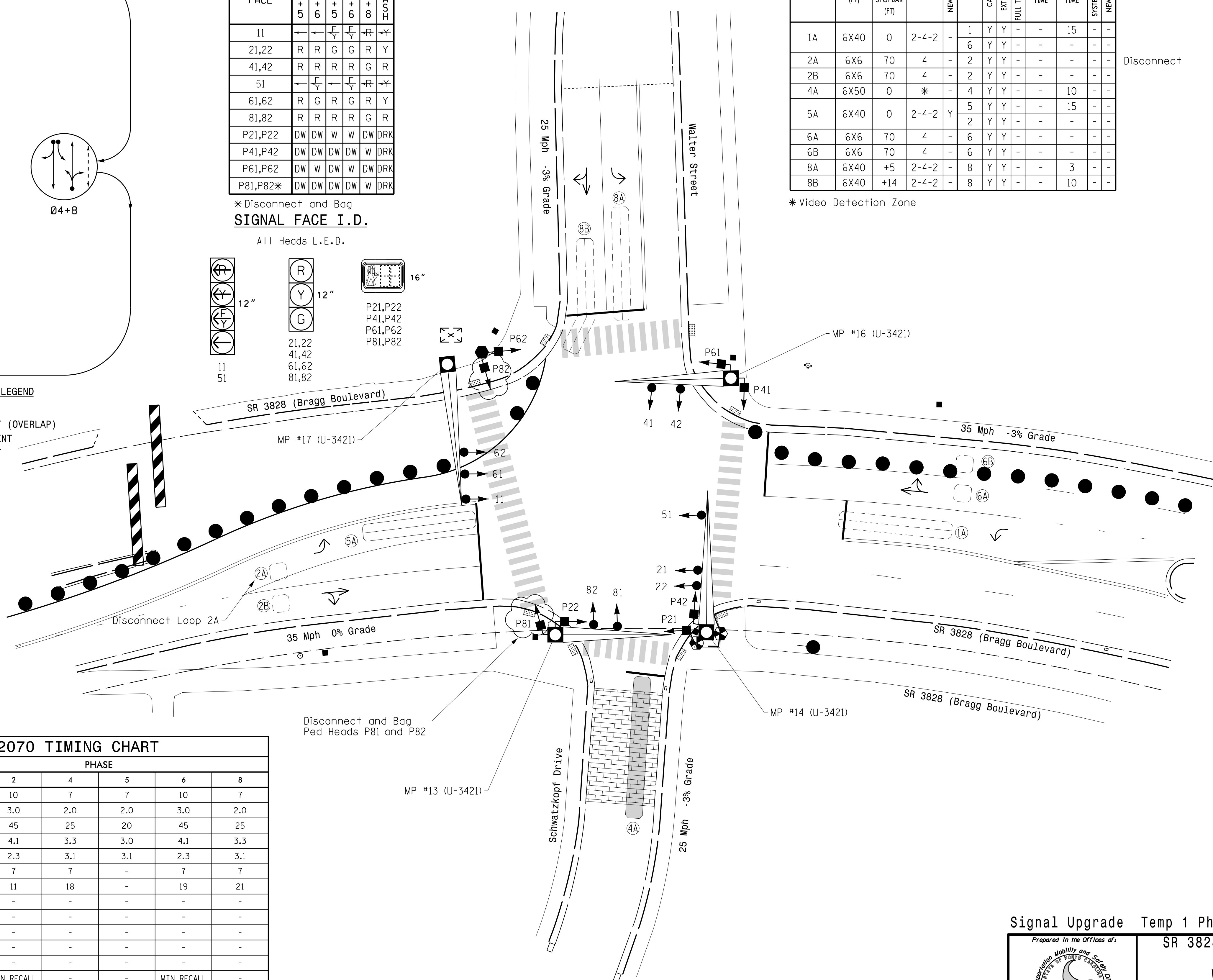

LEGEND

PROPOSED	EXISTING
○ Traffic Signal Head	● N/A
● Modified Signal Head	○ N/A
⊥ Sign	⊥ N/A
⊥ Pedestrian Signal Head With Push Button & Sign	⊥ N/A
⊥ Signal Pole with Guy	⊥ N/A
⊥ Signal Pole with Sidewalk Guy	⊥ N/A
○ Inductive Loop Detector	○ N/A
○ Video Detection Zone	○ N/A
⊠ Controller & Cabinet	⊠ N/A
□ Junction Box	□ N/A
⊠ 2-in Underground Conduit	⊠ N/A
- - - Right of Way	- - - N/A
→ Directional Arrow	→ N/A
⊠ Metal Pole with Mastarm	⊠ N/A
○ Type II Signal Pedestal	○ N/A
○ Out of Pavement Detector	○ N/A

Signal Upgrade Temp 1 Phase 2 Step 3

SR 3828 (Bragg Boulevard) at Walter Street

Division 6 Cumberland County Fayetteville

PLAN DATE: July 2015 REVIEWED BY: PLA

PREPARED BY: JPG REVIEWED BY:

750 N. Greenfield Pkwy, Garner, NC 27529

SCALE 1"=20'

SEAL NORTH CAROLINA PROFESSIONAL ENGINEER SEAL 029904 JASON P. GALLOWAY

DocuSigned by: Jason P. Galloway 8/27/2015

SIG. INVENTORY NO. 06-1210T1

27-AUG-2015 09:59
 R:\Projects\4490\Drawings\Signal\06-1210T1_11.dwg
 J:\11.dwg