

8.17.799

-L- CURVE DATA	-Y3- CURVE DATA
PI Sta 16+18.86	PI Sta 17+09.63
$\Delta = 20^\circ 07' 11.6"$ (LT)	$\Delta = 43^\circ 13' 24.1"$ (RT)
D = 3' 34' 51.6"	D = 8' 48' 53.1"
L = 561.85'	L = 490.35'
T = 283.85'	T = 257.51'
R = 1,600.00'	R = 650.00'
DS = 27 MPH	DS = 40mph
SE = 2.0 % *	SE = 4.0%
RO = 100'	RO = 124'

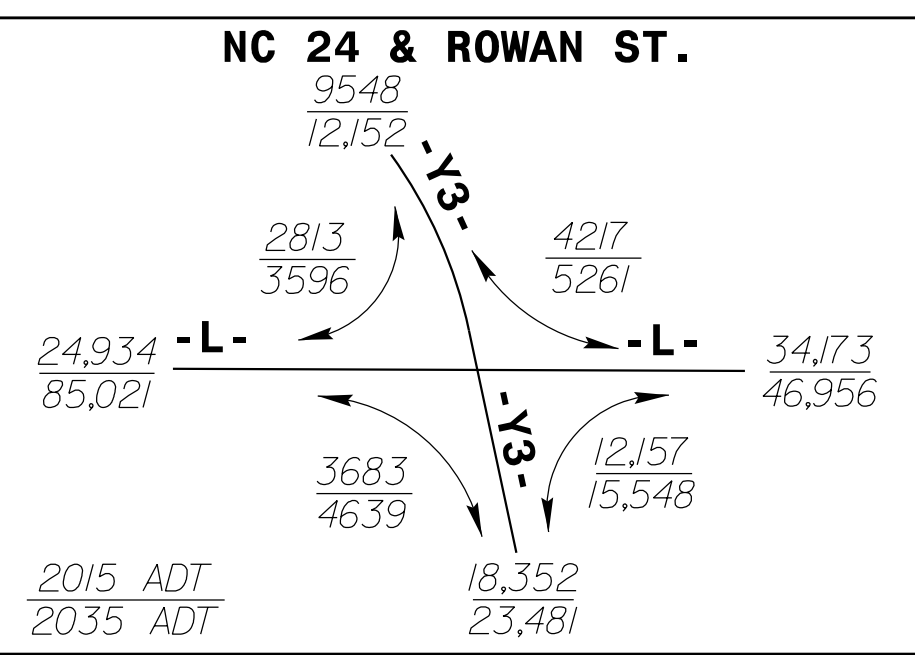

PLANS PREPARED BY:
PARSONS BRINCKERHOFF
 434 FAYETTEVILLE STREET
 SUITE 1500
 RALEIGH, NC 27601
 LICENSE NO. F-1065

*** DESIGN EXCEPTION
 REQUIRED FOR
 SUPERELEVATION**

PROJECT REFERENCE NO. B-4490	SHEET NO. 6
ROADWAY DESIGN ENGINEER SEAL 19563 JAMES SCOTT	HYDRAULICS ENGINEER SEAL 039785 C. J. [unreadable]
DOCUMENT NOT CONSIDERED FINAL UNLESS ALL SIGNATURES COMPLETED	

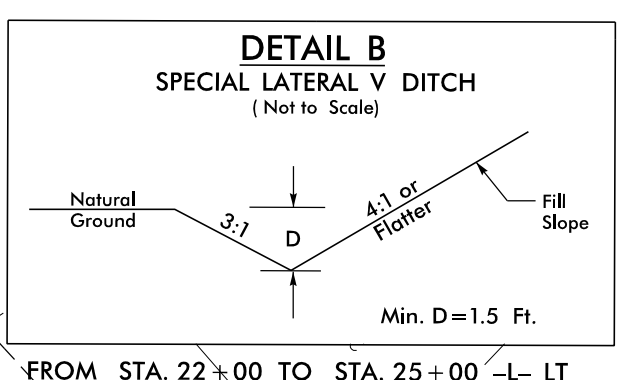

CITY OF FAYETTEVILLE
 DB 9742 PG 379
 +95.10
 EX. R/W

NAD
 82 NSRS
 2007

MATCH LINE SEE SHEET 5
 -L- STA. 18+50.00

MATCH LINE SEE SHEET 7
 -L- STA. 23+50.00

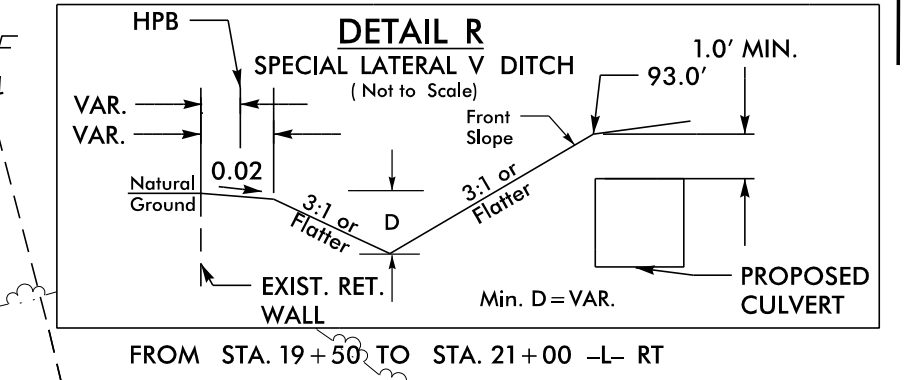
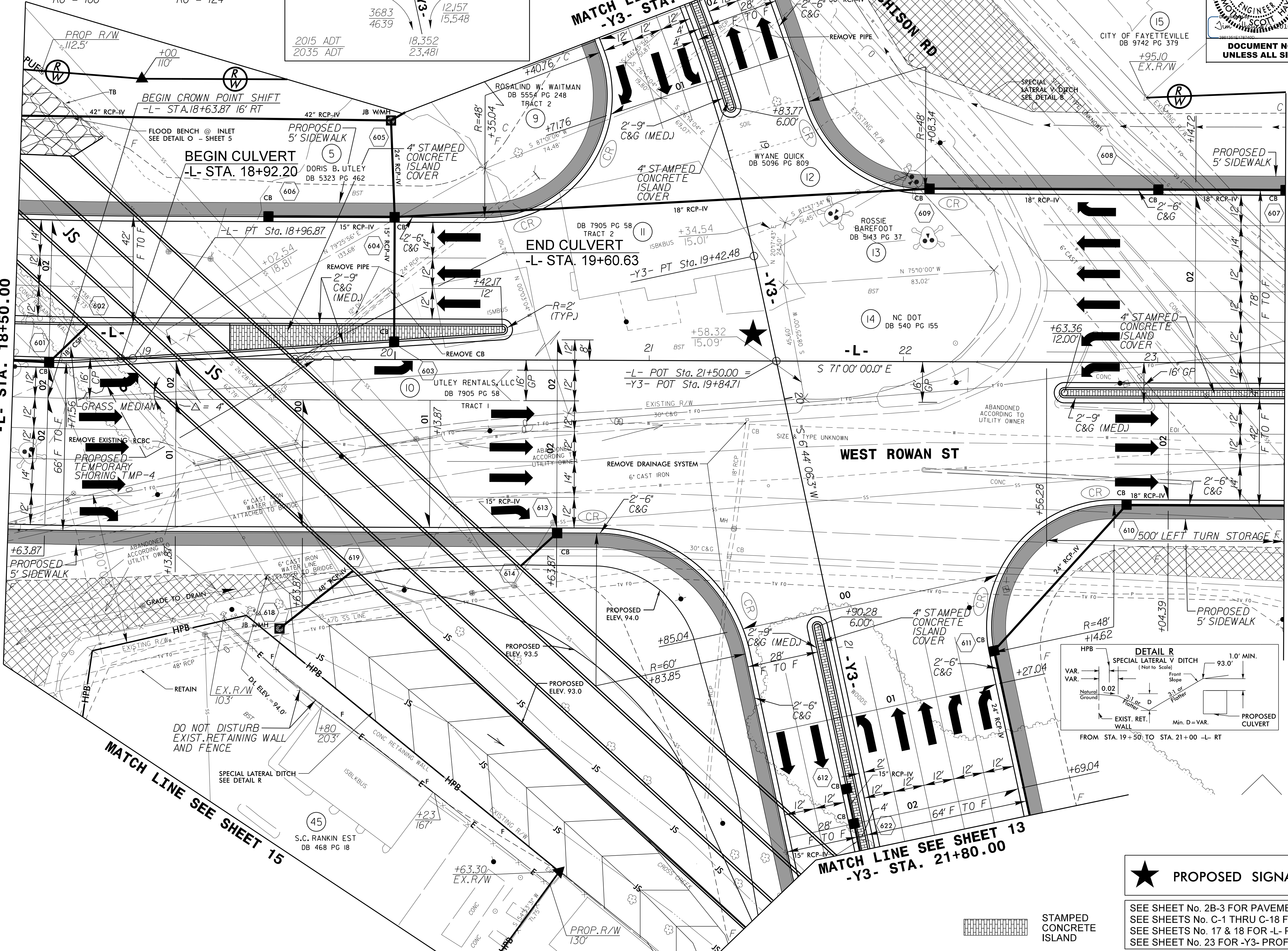

★ PROPOSED SIGNAL

SEE SHEET No. 2B-3 FOR PAVEMENT REMOVAL DETAIL
 SEE SHEETS No. C-1 THRU C-18 FOR CULVERT PLANS
 SEE SHEETS No. 17 & 18 FOR -L- PROFILE
 SEE SHEET No. 23 FOR -Y3- PROFILE

STAMPED
 CONCRETE
 ISLAND

REVISIONS

8.5.14.8 AM
 8.22.2016
 [unreadable]