

**This electronic collection of documents is provided
for the convenience of the user
and is Not a Certified Document –**

**The documents contained herein were originally issued
and sealed by the individuals whose names and license
numbers appear on each page, on the dates appearing
with their signature on that page.**

**This file or an individual page
shall not be considered a certified document.**

GENERAL NOTES

CHANGES MAY BE REQUIRED WHEN PHYSICAL DIMENSIONS IN THE DETAIL DRAWINGS, STANDARD DETAILS, AND ROADWAY DETAILS ARE NOT ATTAINABLE TO MEET FIELD CONDITIONS OR RESULT IN DUPLICATE OR UNDESIRE OVERLAPPING OF DEVICES. MODIFICATION MAY INCLUDE: MOVING, SUPPLEMENTING, COVERING, OR REMOVAL OF DEVICES AS DIRECTED BY THE ENGINEER.

THE FOLLOWING GENERAL NOTES APPLY AT ALL TIMES FOR THE DURATION OF THE CONSTRUCTION PROJECT EXCEPT WHEN OTHERWISE NOTED IN THE PLAN OR DIRECTED BY THE ENGINEER.

TRAFFIC PATTERN ALTERATIONS

- A) NOTIFY THE ENGINEER THIRTY (30) CALENDAR DAYS PRIOR TO ANY TRAFFIC PATTERN ALTERATION.

SIGNING

- B) PROVIDE SIGNING AND DEVICES REQUIRED TO CLOSE THE ROAD ACCORDING TO THE ROADWAY STANDARD DRAWINGS AND TRAFFIC CONTROL PLANS.

PROVIDE SIGNING REQUIRED FOR THE OFF-SITE DETOUR ROUTE AS SHOWN IN THE TRAFFIC CONTROL PLANS.

- C) COVER OR REMOVE ALL SIGNS AND DEVICES REQUIRED TO CLOSE THE ROAD WHEN ROAD CLOSURE IS NOT IN OPERATION.

COVER OR REMOVE ALL SIGNS REQUIRED FOR THE OFF-SITE DETOUR WHEN THE DETOUR IS NOT IN OPERATION.

- D) ENSURE ALL NECESSARY SIGNING IS IN PLACE PRIOR TO ALTERING ANY TRAFFIC PATTERN.

TRAFFIC CONTROL DEVICES

- E) PLACE TYPE III BARRICADES, WITH "ROAD CLOSED" SIGN R11-2 ATTACHED, OF SUFFICIENT LENGTH TO CLOSE ENTIRE ROADWAY.

PAVEMENT MARKINGS AND MARKERS

- F) INSTALL PAVEMENT MARKINGS AND PAVEMENT MARKERS ON THE FINAL SURFACE AS SHOWN IN THE PAVEMENT MARKING PLAN.



- G) TIE PROPOSED PAVEMENT MARKING LINES TO EXISTING PAVEMENT MARKING LINES.

PHASING

- STEP 1:
USING RSD 1101.03, SHEET 1 OF 9, AND SHEET TMP-3, INSTALL DETOUR SIGNS, PLACE TYPE III BARRICADES TO CLOSE SR 1002 (TOWN CREEK RD) TO THROUGH TRAFFIC, AND DETOUR TRAFFIC OFF-SITE.

- STEP 2:
AWAY FROM TRAFFIC, COMPLETE THE FOLLOWING:
1) REMOVE EXISTING STRUCTURE AND CONSTRUCT PROPOSED STRUCTURE. (SEE ROADWAY AND STRUCTURE PLANS)
2) CONSTRUCT PROPOSED ROADWAY UP TO AND INCLUDING FINAL LAYER OF SURFACE COURSE. (SEE ROADWAY PLANS)
3) PLACE FINAL PAVEMENT MARKINGS AND TIE INTO EXISTING PAVEMENT MARKINGS. (SEE PAVEMENT MARKING PLANS)

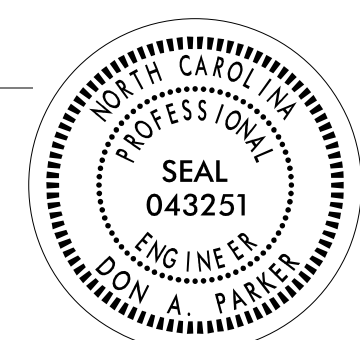
- STEP 3:
REMOVE ALL TRAFFIC CONTROL DEVICES, ALL DETOUR SIGNING AND OPEN SR 1002 (TOWN CREEK RD) TO PROPOSED TRAFFIC PATTERN.

APPROVED: <i>Don A. Parker</i> <small>404482862618410</small> DATE: 3/22/2016			<h1 style="margin: 0;">TRANSPORTATION OPERATIONS PLAN</h1>
DOCUMENT NOT CONSIDERED FINAL UNLESS ALL SIGNATURES COMPLETED			

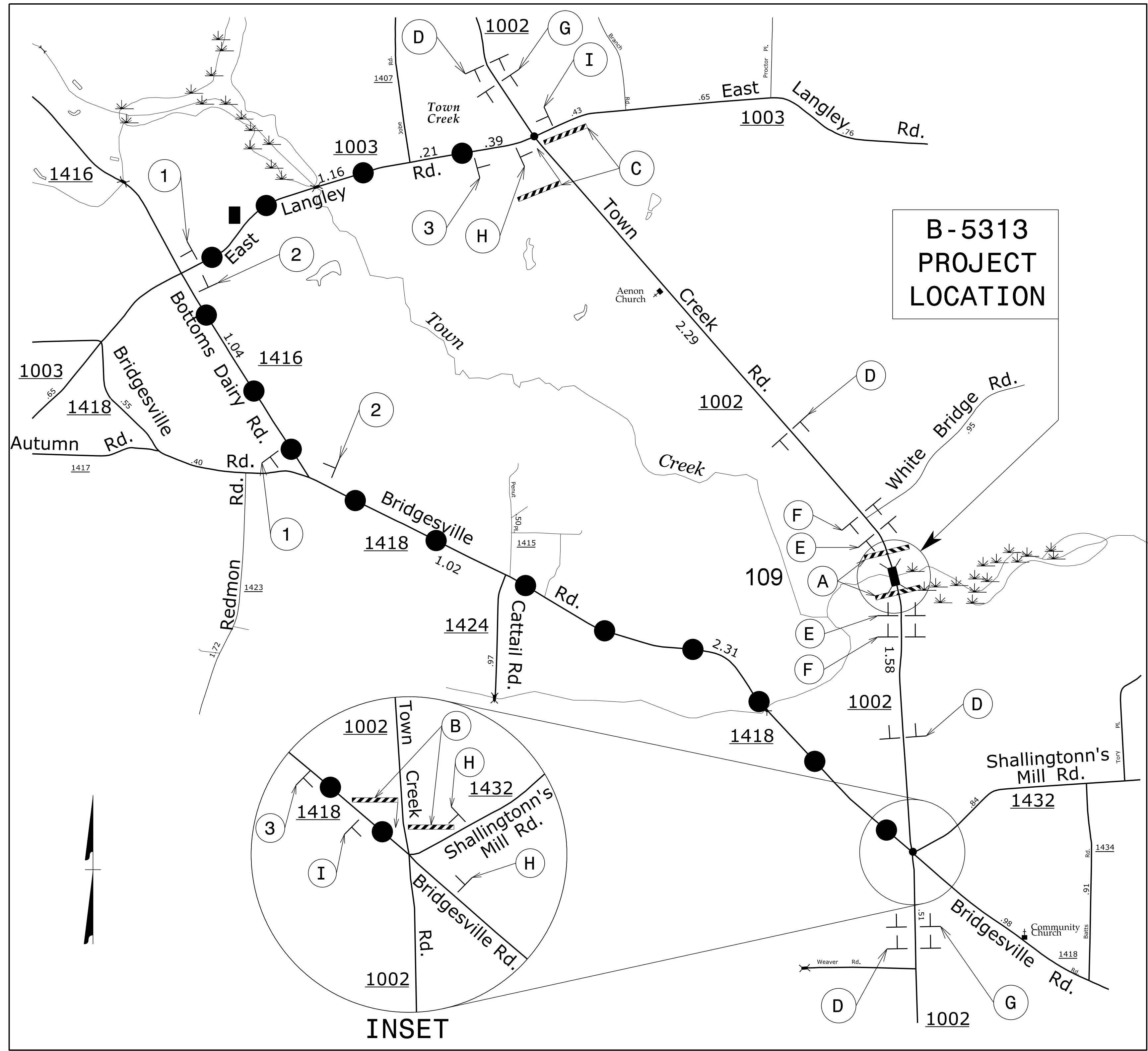

**B-5313
PROJECT
LOCATION**

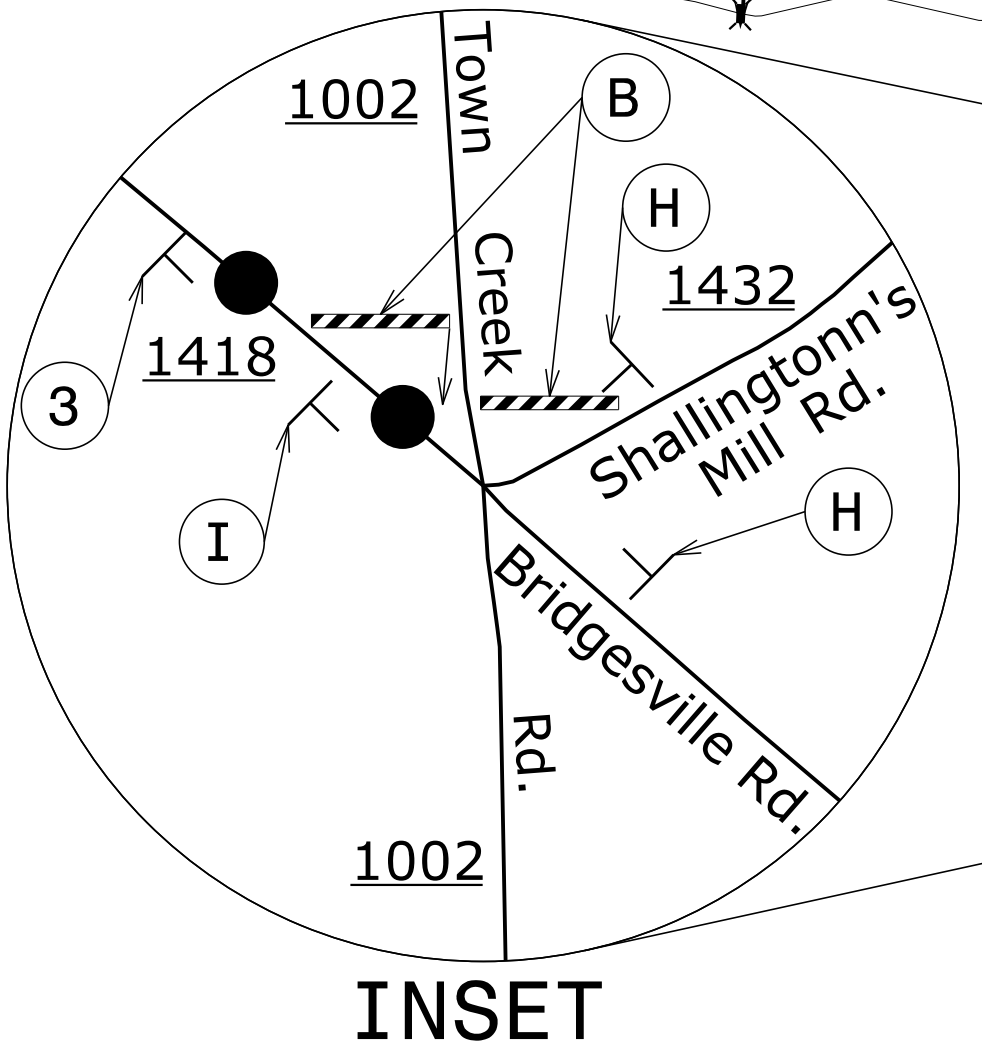

LEGEND

TRAFFIC CONTROL DEVICES

BARRICADE (TYPE III)

TEMPORARY SIGNING

STATIONARY SIGN

NOTES:
TRAFFIC CONTROL DEVICES (A) THROUGH (I) SHALL BE INSTALLED ACCORDING TO RSD 1101.03, SHEET 1 OF 9.

TRAFFIC CONTROL DEVICES (1) THROUGH (3) SHALL BE INSTALLED AS SHOWN ON PLAN OR AS DIRECTED BY THE ENGINEER.

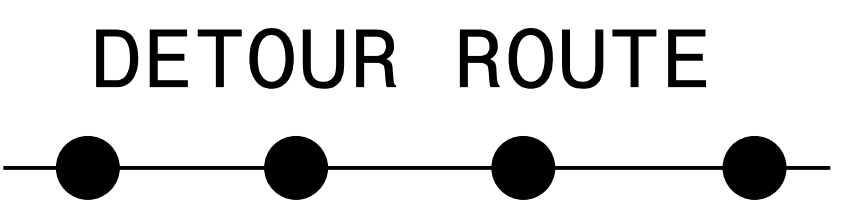
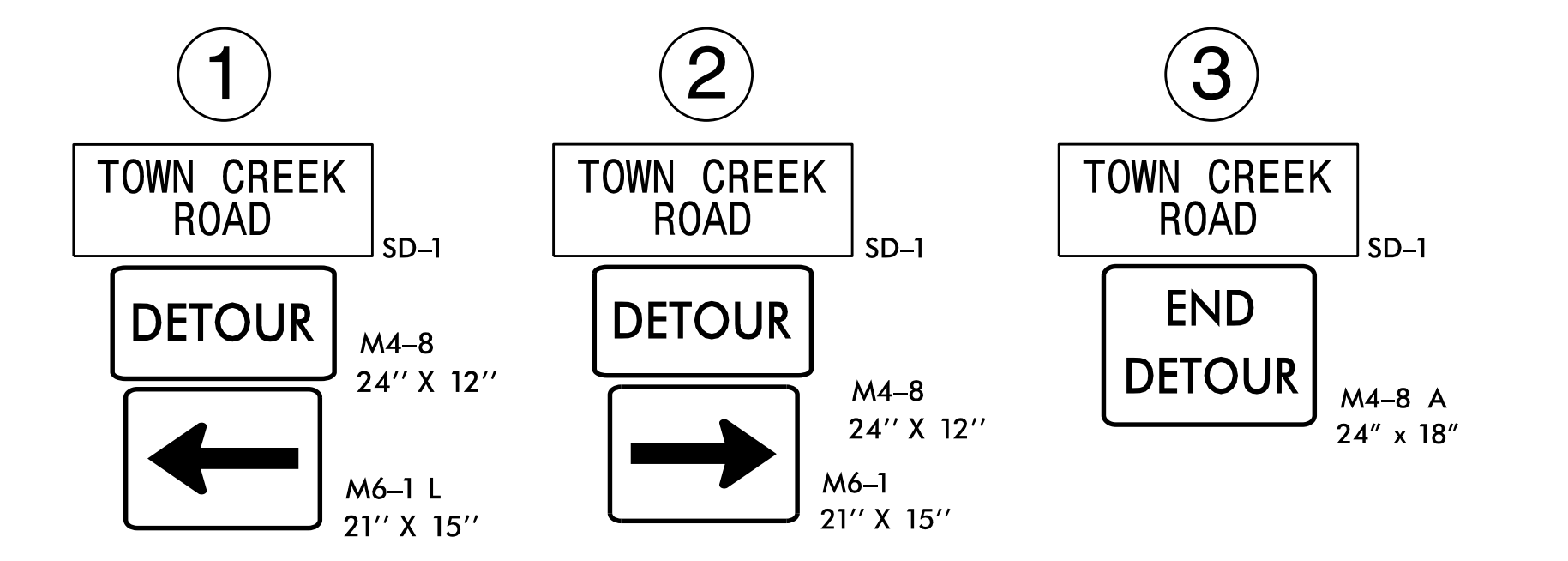
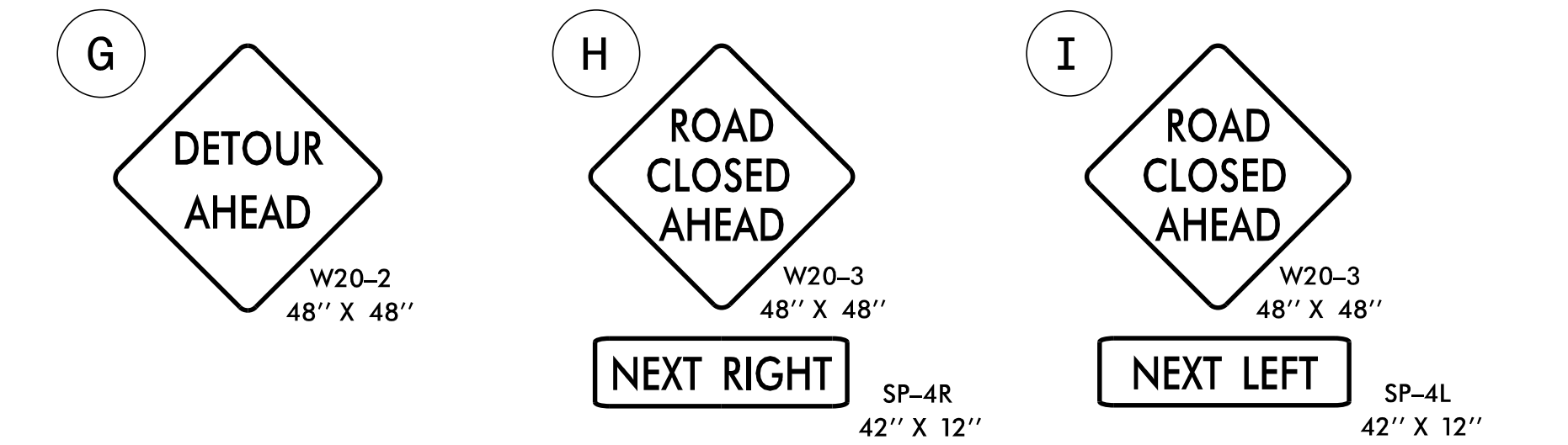
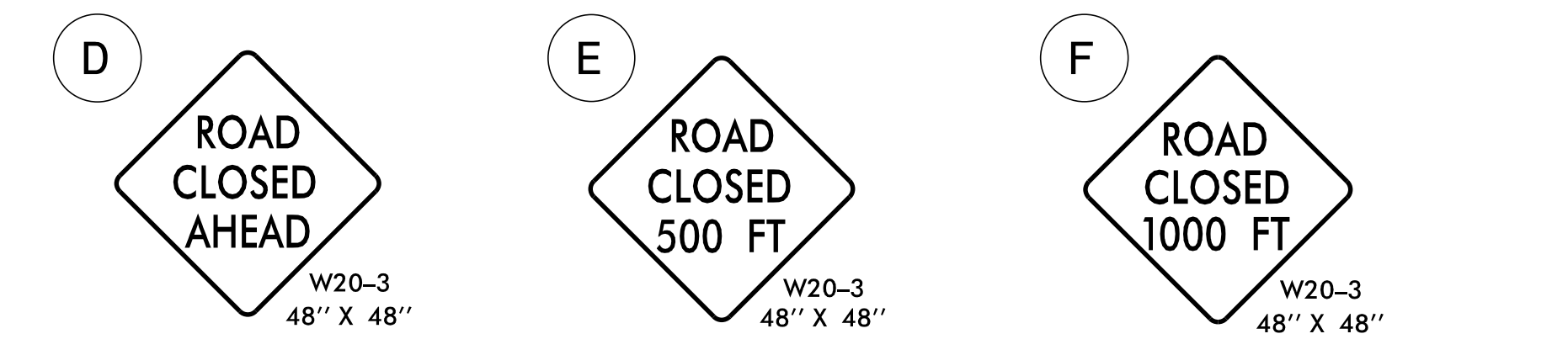
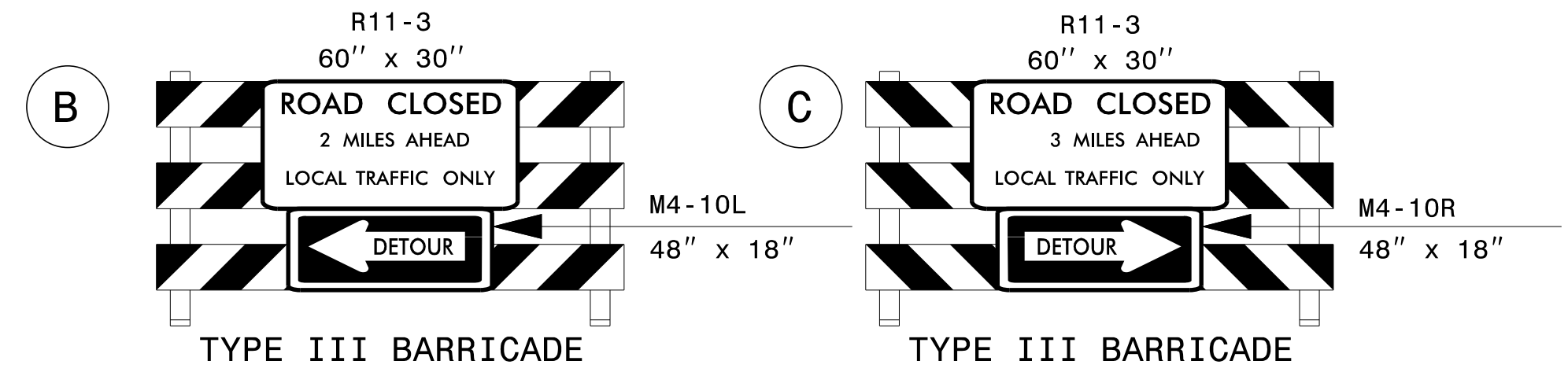
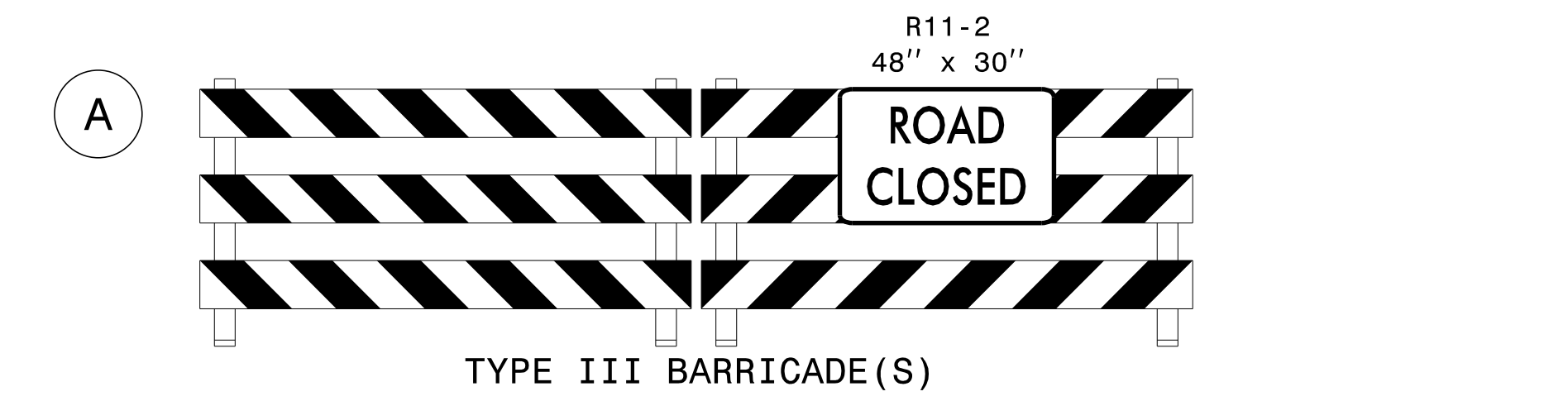

APPROVED:
DATE: 1/28/2016

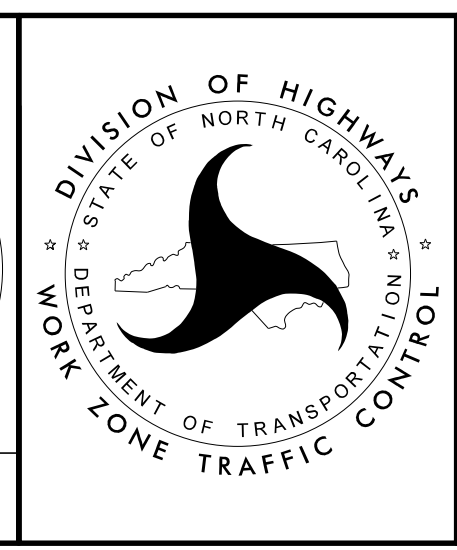

**ROAD CLOSURE
AND
OFF-SITE DETOUR**

I:\26\2016\RA\TrafficControl\CPA\B-5313_TC_TMP_3.dgn User:tabjennings