

**B-5313
PROJECT
LOCATION**

INSET

LEGEND

TRAFFIC CONTROL DEVICES

BARRICADE (TYPE III)

TEMPORARY SIGNING

STATIONARY SIGN

NOTES:
TRAFFIC CONTROL DEVICES (A) THROUGH (I) SHALL BE INSTALLED ACCORDING TO RSD 1101.03, SHEET 1 OF 9.

TRAFFIC CONTROL DEVICES (1) THROUGH (3) SHALL BE INSTALLED AS SHOWN ON PLAN OR AS DIRECTED BY THE ENGINEER.

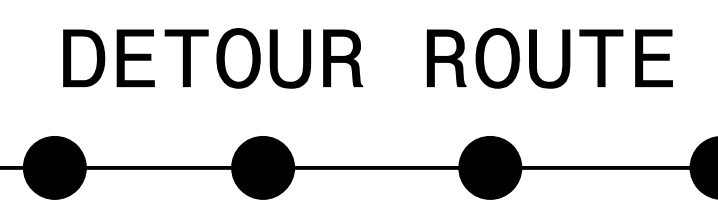
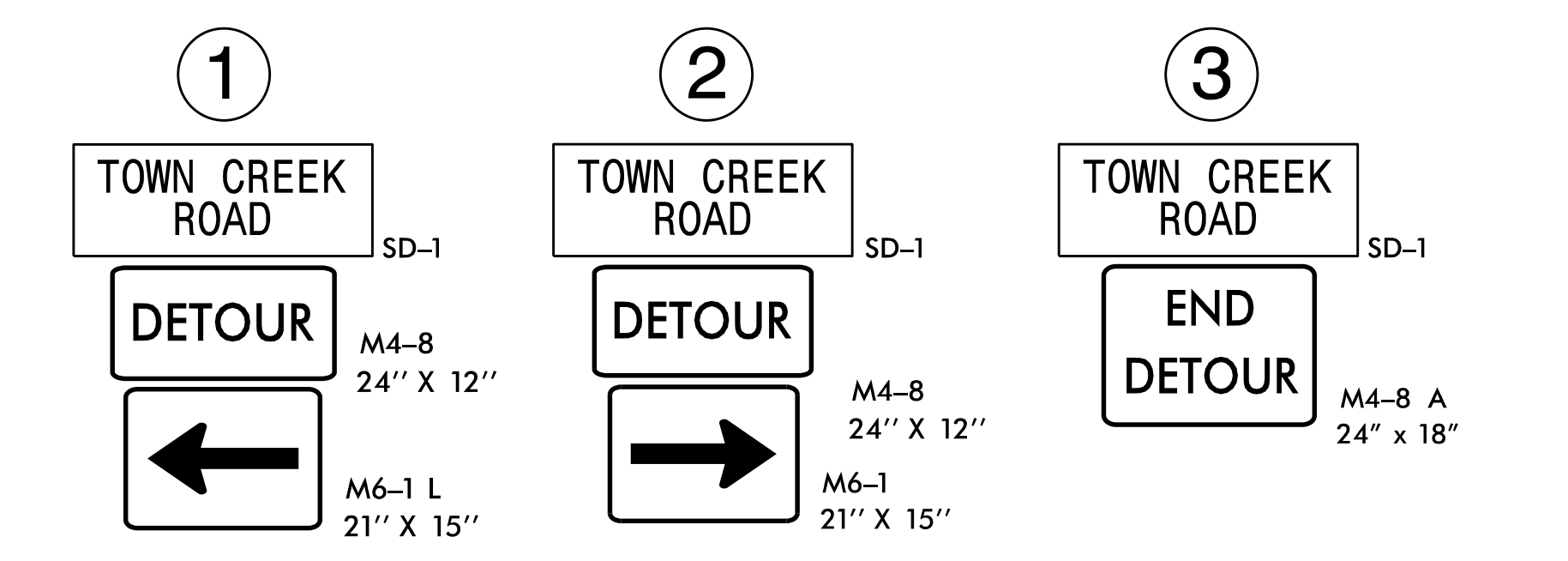
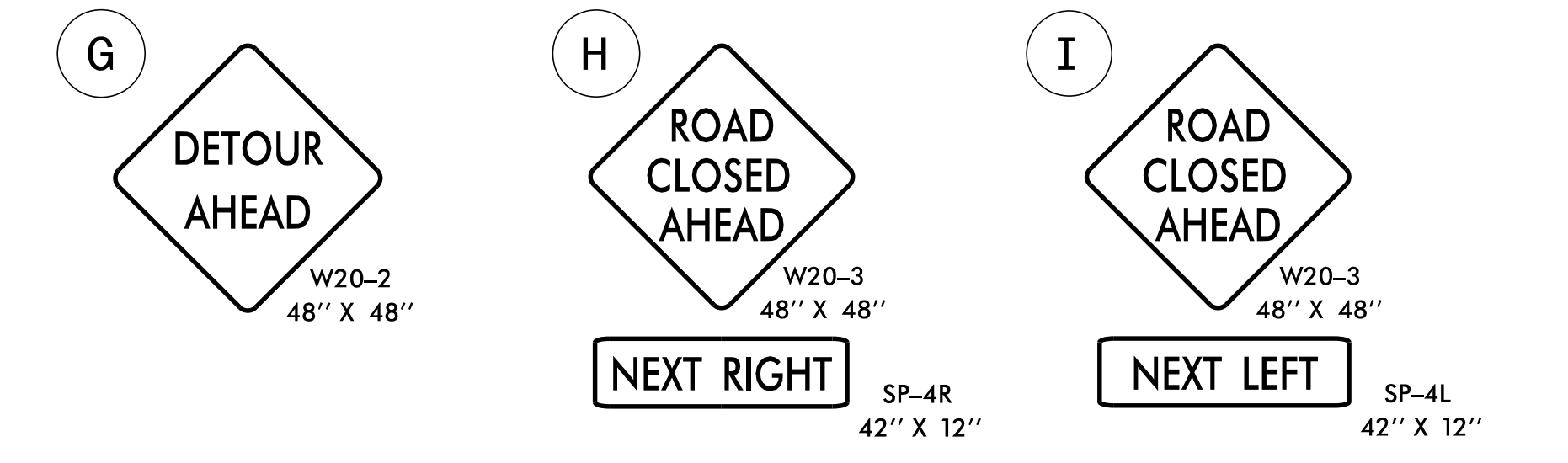
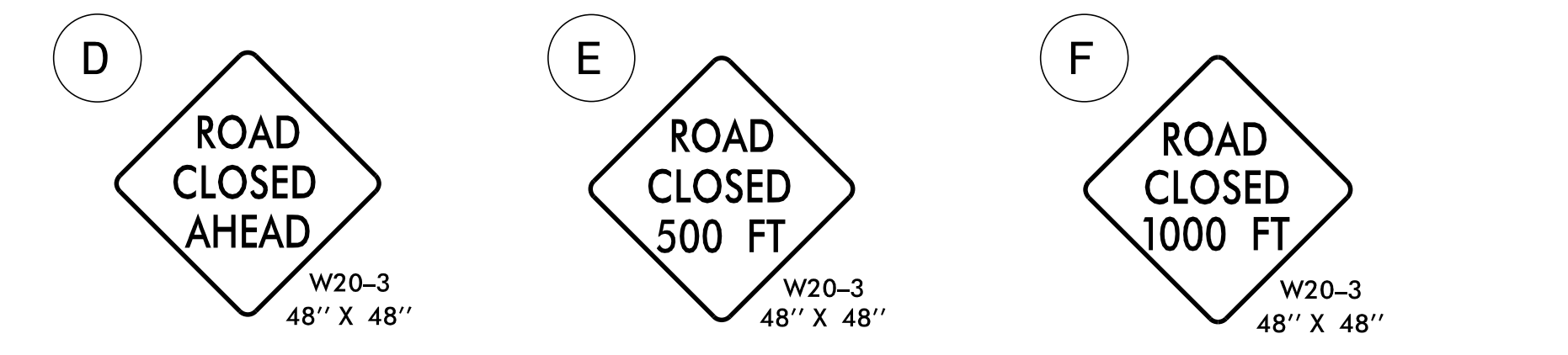
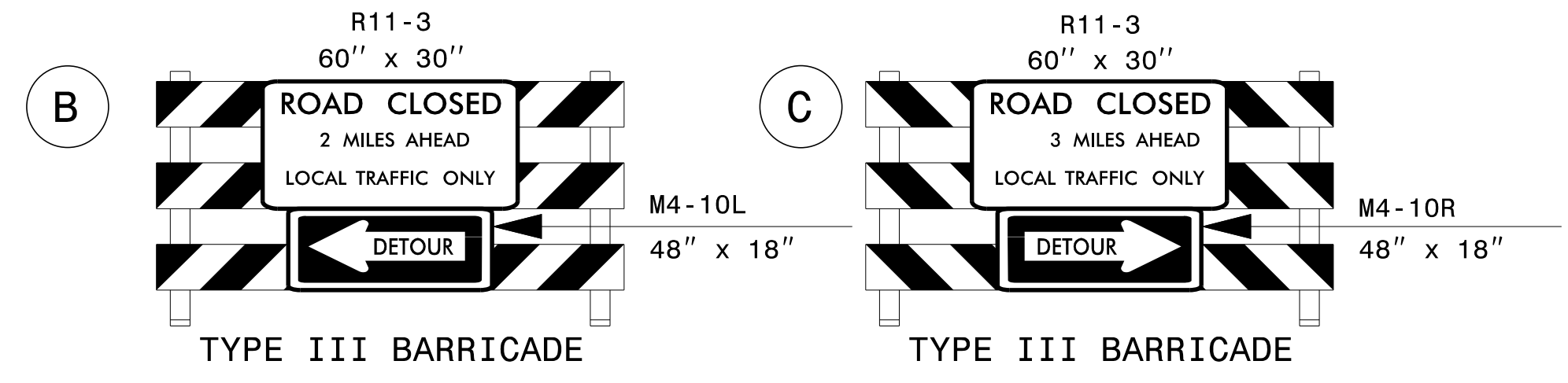
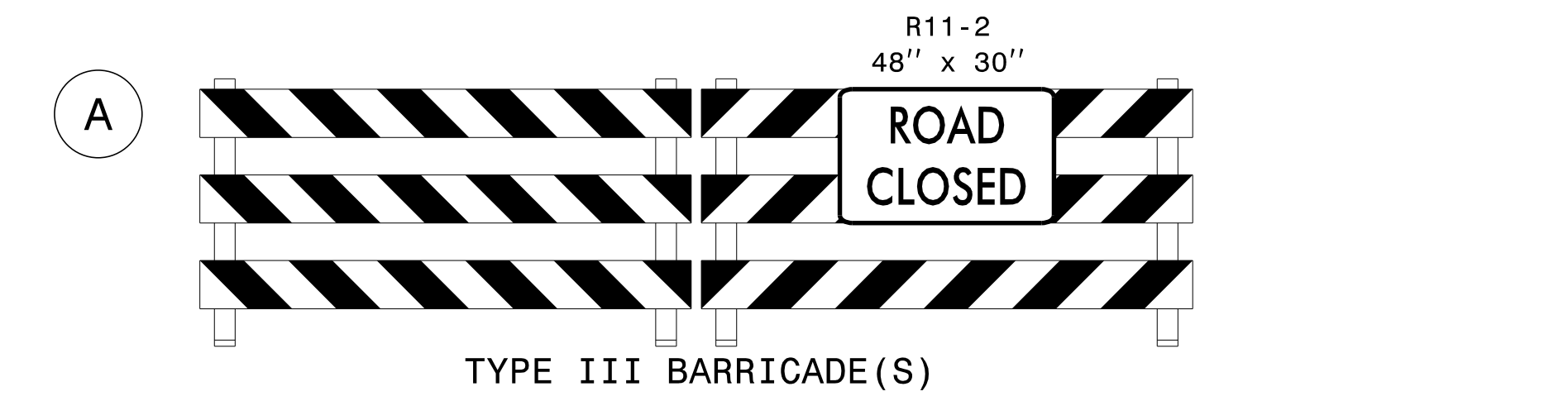

APPROVED: *Don A. Parker*

DATE: 1/28/2016

**DOCUMENT NOT CONSIDERED FINAL
UNLESS ALL SIGNATURES COMPLETED**

**ROAD CLOSURE
AND
OFF-SITE DETOUR**

I:\26\2016\RA\TrafficControl\CPA\B-5313_TC_TMP_3.dgn
User: tabjennings