



STA. 10+00 -L-
BEGIN PROJECT

10+00

NOTE: MAINTAIN A MINIMUM 12' CLEAR PATHWAY
DURING CONSTRUCTION FOR EMERGENCY VEHICLES

STA. 13+50 -L-
END PROJECT

GR R11-2
48" x 30"

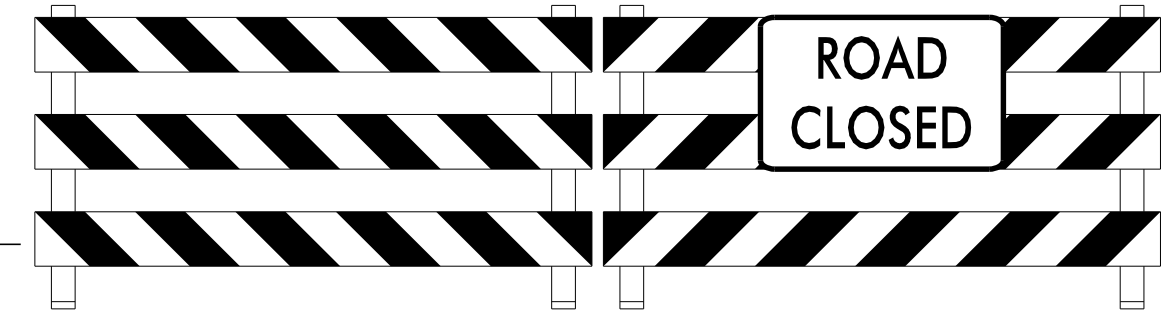

TYPE III BARRICADE(S)
(LOCATIONS DETERMINED BY THE ENGINEER)

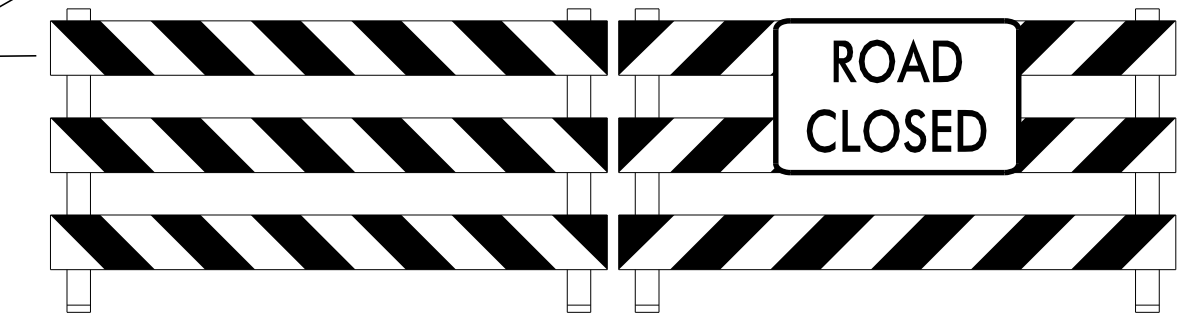

TYPE III BARRICADE(S)
(LOCATIONS DETERMINED BY THE ENGINEER)

EMERGENCY
VEHICLES
ONLY *

NO PUBLIC
ACCESS *

EMERGENCY
VEHICLES
ONLY *

NO PUBLIC
ACCESS *

NOTE: MAINTAIN A MINIMUM 12' CLEAR PATHWAY
DURING CONSTRUCTION FOR EMERGENCY VEHICLES

* — SEE SHEET TMP-2 FOR
SPECIAL SIGN DESIGNS

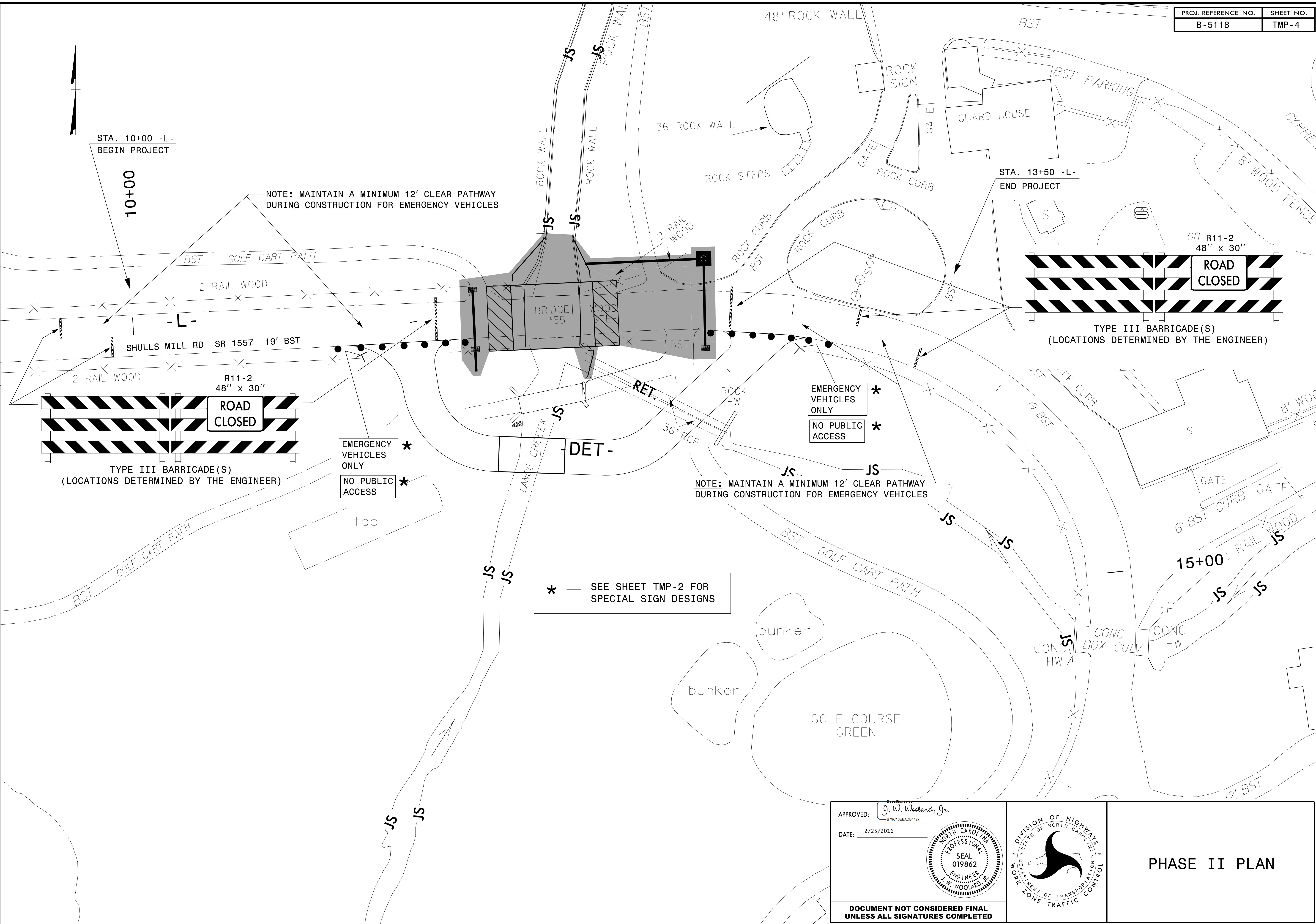

2/25/2016
 P:\TIP\Projects-B\B5118\TrafficControl\TCP\B5118.TC_TMP_04.dgn
 User:kbroadwell

APPROVED: *J. W. Woolard, Jr.*
879C18E6AD8427

DATE: 2/25/2016

**DOCUMENT NOT CONSIDERED FINAL
UNLESS ALL SIGNATURES COMPLETED**

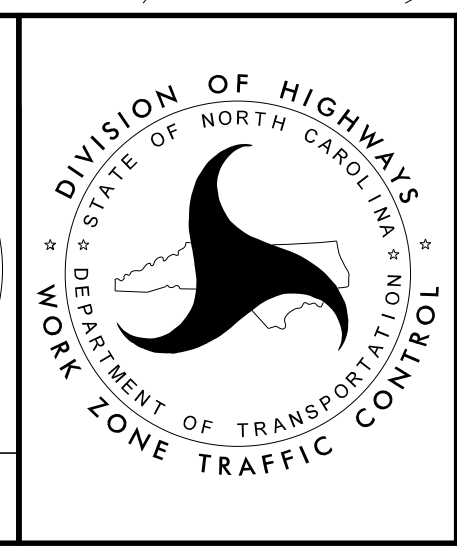

PHASE II PLAN